

KEYED NOTES:

- ① EXISTING ROW OF "ARBOR VITAE" EVERGREEN TREES ALONG EAST EDGE OF PROPERTY LINE TO REMAIN
- ② EXISTING DECORATIVE WROUGHT IRON METAL FENCE TO REMAIN

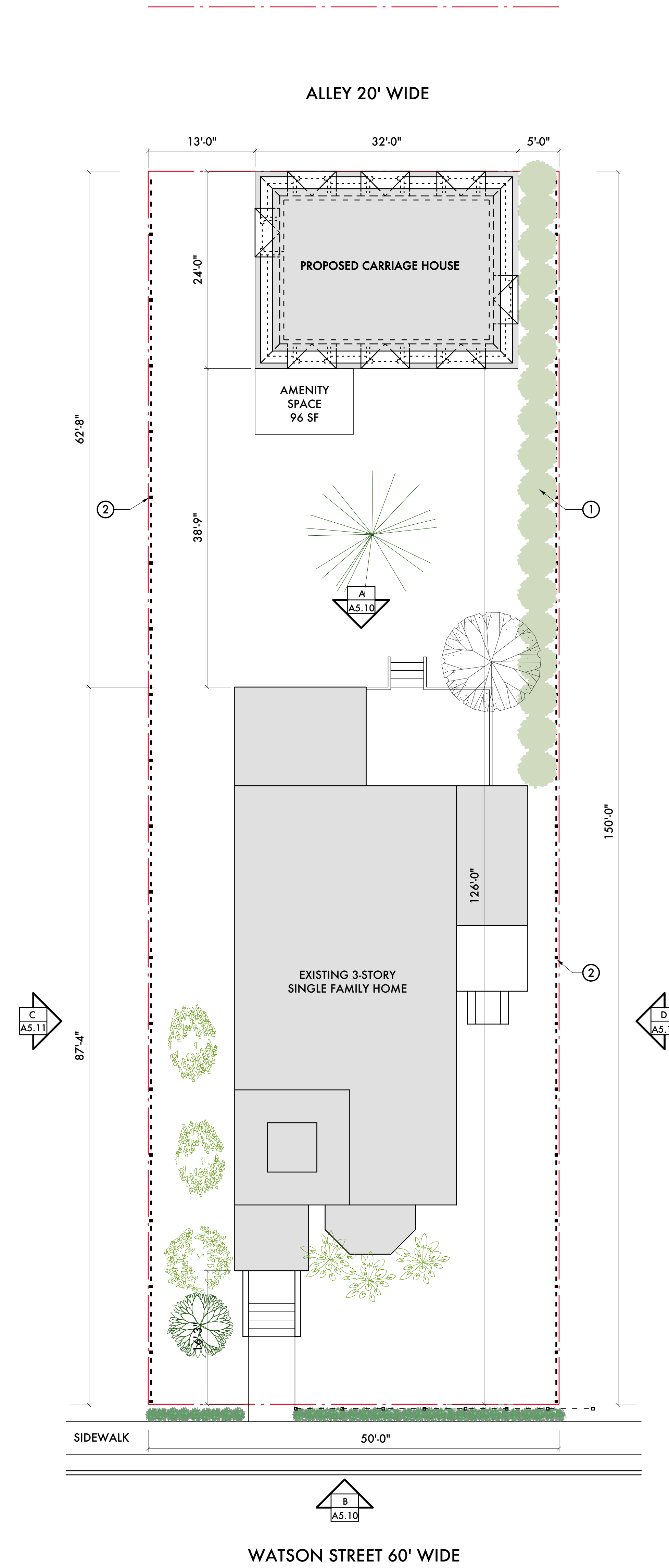

PROPERTY DESCRIPTION:

LEGAL DESCRIPTION
 N WATSON 2BLK 8 BRUSH SUB L3 P24 PLATS, WCR
 1/48 50 X 150

SITE AREA:
 50' WIDE X 150' DEEP = 7,500 SF TOTAL LOT AREA

SITE COVERAGE:
 MAIN HOUSE (EXISTING) = 1,845 SF
 % COVERAGE (EXISTING) = 24.6%

CARRIAGE HOUSE (PROPOSED) = 768 SF
 % COVERAGE (PROPOSED) = 10.0%

TOTAL (EXISTING + CARRIAGE HOUSE) = 2,613 SF
 % COVERAGE (EXISTING + PROPOSED) = 34.8%



09/03/24 Zoning Approval
 08/23/24 Zoning Approval
 07/09/24 Historic Commission

Date: Issued For:

**Waldhorn Residence
 Historic Home**
 311 E Watson
 Detroit, Michigan 48201

studiozONE : DETROIT
 architectural | urban | interior DESIGN
 350 Madison Avenue 4th Floor Detroit, Michigan 48226
 studiozonedetroit.com 313.549.2790 jpb@waldhornhome.com

Project Number: 2024

Sheet Title:

SITE PLAN

Sheet Number:

A2.10

© 2024 studiozONE, llc



1 SITE PLAN

1/8" = 1'-0"

