

4 SECTION @ SOUTH BERM  
A1.1 1" = 1'-0"

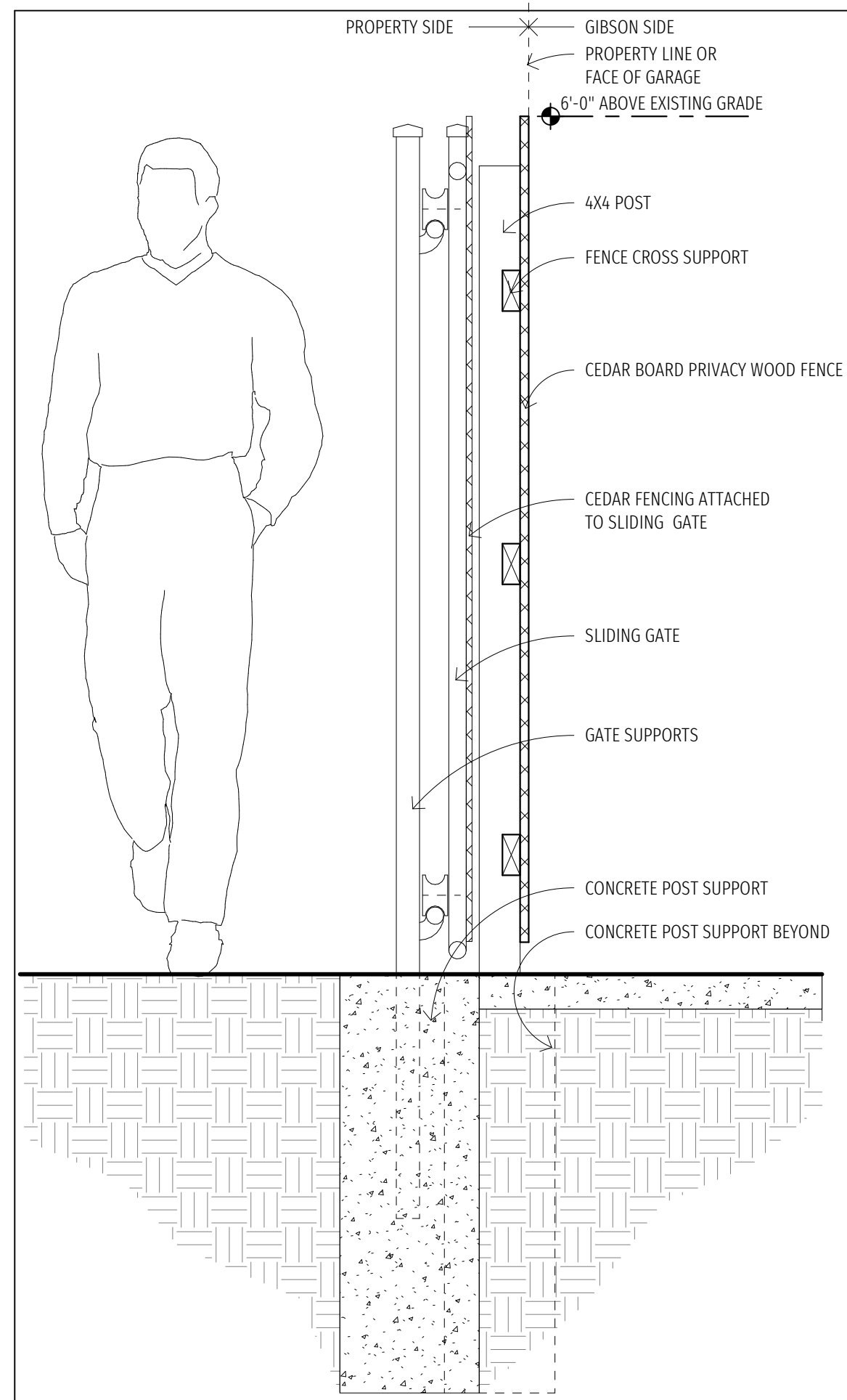

3 GATE @ REAR PARKING  
A1.1 1" = 1'-0"

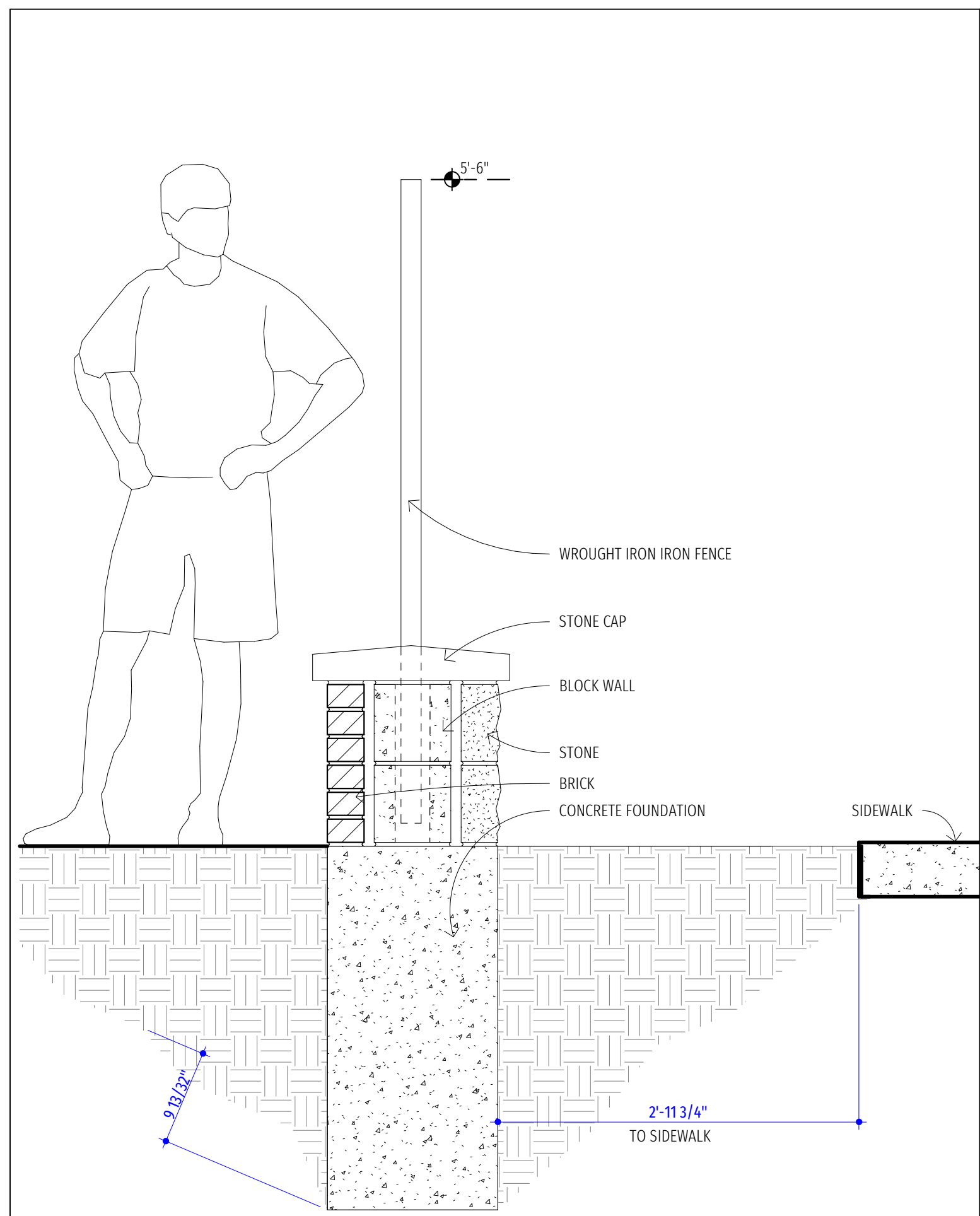

2 FENCE LINE @ SIDEWALK  
A1.1 1" = 1'-0"

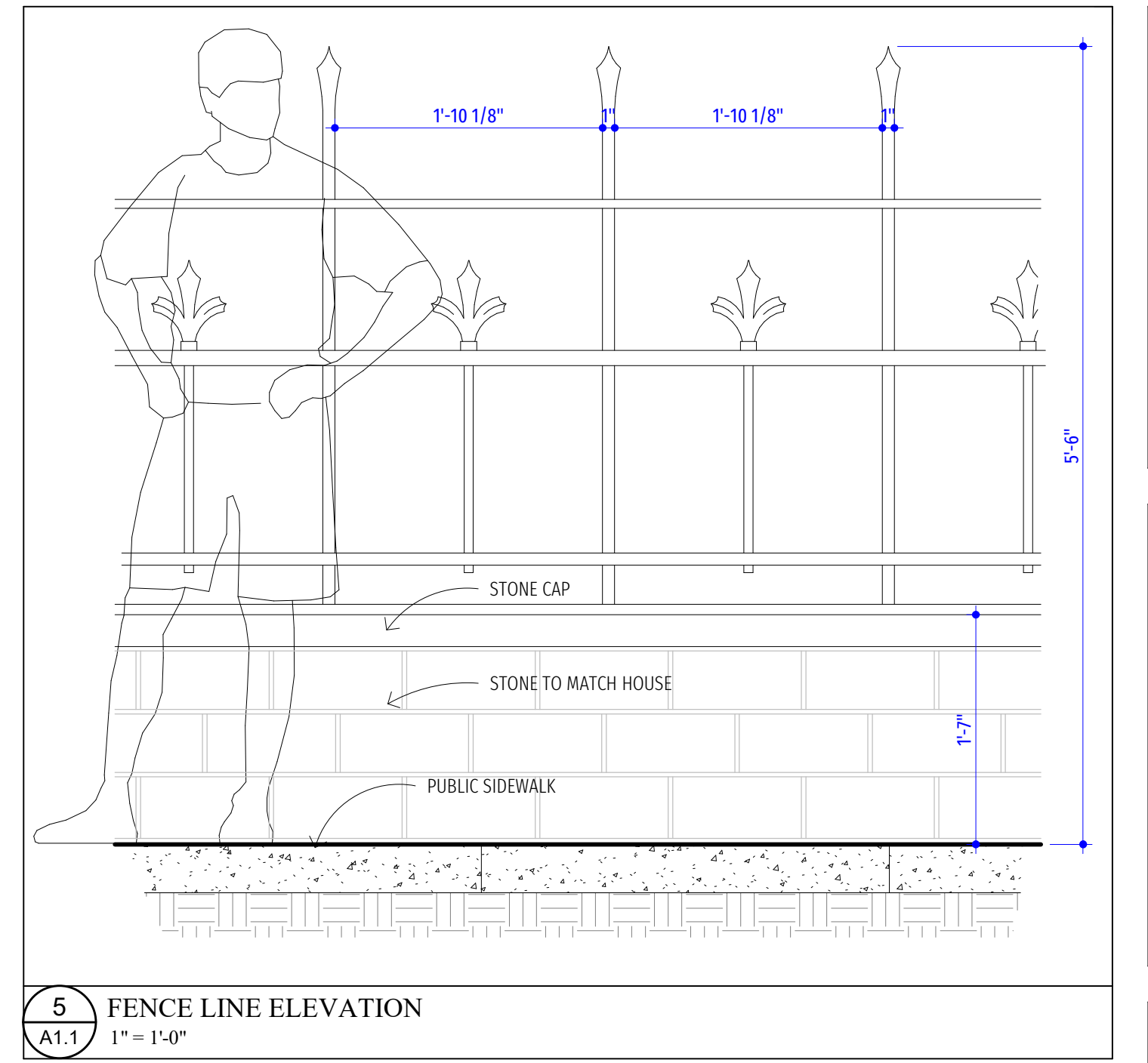

5 FENCE LINE ELEVATION  
A1.1 1" = 1'-0"

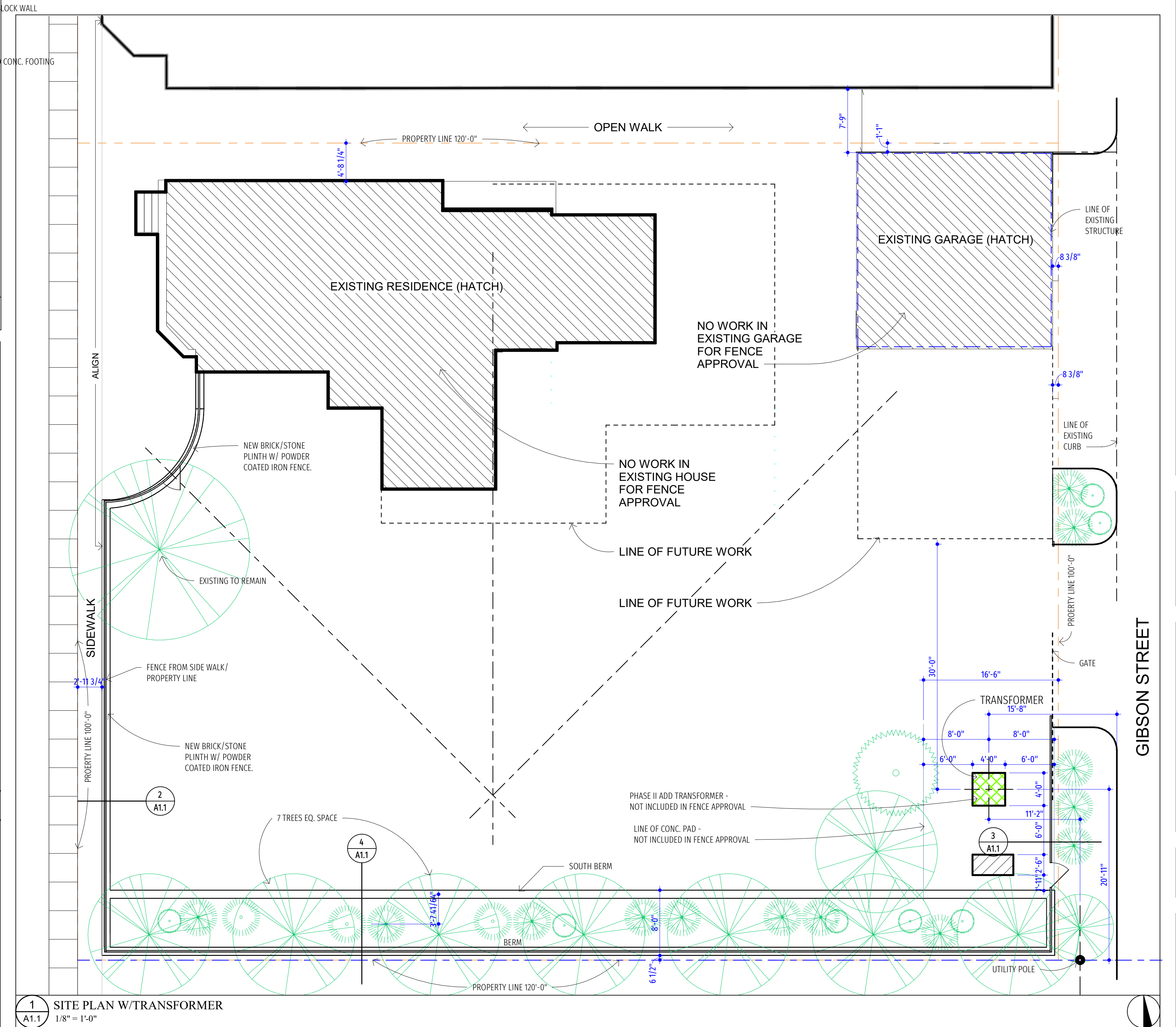

1 SITE PLAN W/ TRANSFORMER  
A1.1 1/8" = 1'-0"

**Mark Johnson and Associates**  
7318 Kingswood Drive, Bloomfield Hills, MI 48301  
Phone: 248-543-5411 Fax: 248-543-5118

THESE DRAWINGS ARE FOR BIDDING AND CONSTRUCTION OF THE FOLLOWING ITEMS, WHICH INCLUDE: FOUNDATIONAL, STRUCTURAL, STEEL, ROUGH CARPENTRY, EXTERIOR COMPONENTS / DOORS, ROOFING, CHIMNEYS AND ALL OTHER COMPONENTS OF THE EXTERIOR ENVELOPE OF A BUILDING. PRELIMINARY REVIEW AND COORDINATION OF ALL OTHER DISCIPLINES.

**LINCOLN AVE.  
REMODEL**  
3644 LINCOLN AVE.  
DETROIT, MICHIGAN 48208

SEAL:

DATE:

REVISIONS:

PROJECT NUMBER:  
**22007**

SHEET TITLE:  
**ARCHITECTURAL  
SITE PLAN**

**A1.1**

SHEET NUMBER:

DO NOT SCALE DRAWINGS