

2 FLOOR 01 - PROPOSED  
1/8" = 1'-0"

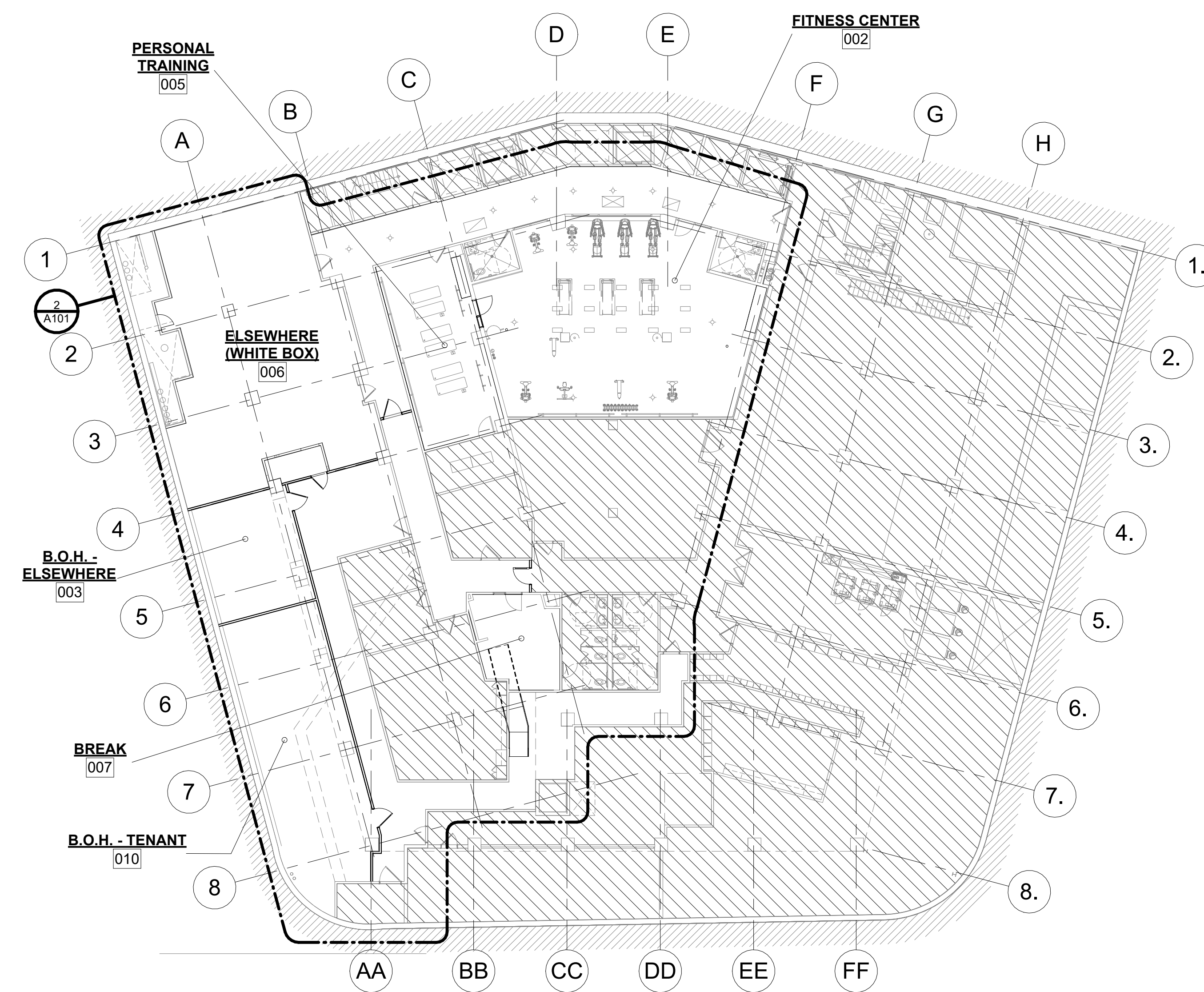

1 FLOOR 00 - PROPOSED  
1/8" = 1'-0"

**GENERAL FRAMING NOTES:**

1. EXTEND ALL INTERIOR PARTITIONS UP TO CEILING STRUCTURE @ MIN. 8' O.C. U.N.O.
2. COORDINATE OPENINGS AND VERTICAL SHAFTS WITH INTERIOR DESIGNER, M/E/P, AND FIRE TRADES.
3. ALL GYP. BD. TO BE 5/8" AT CEILINGS AND MIN. 1/2" AT WALLS U.N.O.
4. ALL DEMISING WALLS TO BE SECURED TO STRUCTURE ABOVE. SEALING ALL PENETRATIONS PROVIDE AND INSTALL SOUND BATT INSULATION ABOVE CEILING ALONG DEMISING PARTITION.

**WALL CONSTRUCTION NOTES:**

1. PROVIDE DENSE OR FIBER REINFORCED GYPSUM INTERIOR PANELS TO BE USED AT ALL CORRIDOR AND HIGH IMPACT AREAS.
2. WHERE EXISTING C.M.U. OR TERRA COTTA BLOCK WALLS ARE TO BE FURRED FOR GYP. BD. FINISH, PROVIDE PROPER FURRING DEPTH FOR FLUSH TRANSITIONS TO ADJACENT WALLS.
3. WHERE EXISTING C.M.U. WALLS ARE TO BE RENOVATED, TOOTH IN NEW AREAS AND PROVIDE CONSISTENT FINISH.
4. MOISTURE RESISTENT GYP. BD. IN WET AREAS.
5. TILE BACKER BOARD IN AREAS SPECIFIED FOR TILE FINISH.

**LIGHT GAUGE METAL FRAMING:**

1. ALL LIGHT GAUGE FRAMING MEMBERS SHALL BE DESIGNED, FABRICATED AND ERECTED IN ACCORDANCE WITH THE AISI "SPECIFICATIONS FOR DESIGN OF COLD-FORMED STEEL STRUCTURAL MEMBERS" AND IN ACCORDANCE WITH MANUFACTURERS WRITTEN INSTRUCTIONS.
2. ALL MATERIAL SHALL CONFORM TO ASTM A446, WITH MINIMUM YIELD POINT OF 33 KSI FOR 18 GAUGE, AND 50 KSI FOR 16 GAUGE AND HEAVIER MATERIAL AND SHALL HAVE GALVANIZED COATING TO ASTM A525-G90.
3. ALL WELDING SHALL CONFORM TO AWS D1.3 SPECIFICATIONS FOR WELDING SHEET STEEL STRUCTURES, AND AWS D19.0 WELDING ZINC COATED STEEL.
4. ALL MATERIAL SHALL BE OF A MINIMUM 20 GAUGE THICKNESS, AND SHALL MEET THE DEFLECTION REQUIREMENTS OF THE FINISH MATERIALS TO BE ATTACHED TO THE LIGHT GAUGE FRAMING WORK.
5. ALL STUDS AND JOISTS SHALL BE INSTALLED AT SPACING INDICATED ON THE DRAWINGS.
6. EACH SIDE OF OPENINGS SHALL BE FRAMED WITH DOUBLE STUDS.
7. ALL STUDS AND JOISTS SHALL HAVE A BRIDGING LINE INSTALLED AT A MAXIMUM SPACING OF 4'-0" AND 5'-0" RESPECTIVELY.
8. ALL JOISTS SHALL HAVE WEB STIFFENERS AT REACTION POINTS AND CONCENTRATED LOADS.
9. STRUCTURAL CONNECTIONS OF LIGHT GAUGE METAL FRAMING MEMBERS SHALL BE MADE PER MANUFACTURERS RECOMMENDATIONS, ADEQUATE TO CARRY THE IMPOSED LOADS, AND CONFORMING TO THE AISI AND AWS SPECIFICATIONS.
10. CONNECTION DESIGN TO BE BASED ON REACTIONS GIVEN ON THE DRAWINGS OR AS LISTED IN THE MANUFACTURERS UNIFORM LOADING CAPACITY TABLES, WHICHEVER IS GREATER.
11. SUSPENDED CEILING GRID SYSTEM SHALL COMPLY WITH THE LATEST MICHIGAN BUILDING CODE AND GRID WORK SHALL BE SUPPORTED WITH A MINIMUM OF 2-12 GA. HANGER WIRES ATTACHED TO STRUCTURE ABOVE.
12. ALL LIGHT GAUGE MTL. FRAMING TO FOLLOW PROCEDURES AND PRACTICES AS RECOMMENDED BY THE STEEL STUD MANUFACTURERS ASSOCIATION.

**FIRE STOPPING:**

FIRE STOPPING SHALL BE PROVIDED TO CUT OFF ALL CONCEALED DRAFT OPENING (BOTH VERTICAL AND HORIZONTAL) AND TO FORM AN EFFECTIVE FIRE BARRIER BETWEEN STORIES, AND BETWEEN A TOP STORY AND THE ROOF SPACE. FIRE STOPPING SHALL BE PROVIDED IN WOOD-FRAME CONSTRUCTION IN THE FOLLOWING LOCATIONS.

1. CONCEALED WALL SPACES - FIRE BLOCKING SHALL BE PROVIDED IN CONCEALED SPACES OF STUD WALLS AND PARTITIONS, INCLUDING FURRED SPACES, AT THE CEILING AND FLOOR LEVELS AND AT 10 FOOT INTERVALS BOTH VERTICAL AND HORIZONTAL.
2. CONNECTIONS BETWEEN HORIZONTAL AND VERTICAL SPACES - FIRE BLOCKING SHALL BE PROVIDED AT INTERCONNECTIONS BETWEEN CONCEALED VERTICAL STUD WALL OR PARTITION SPACES AND CONCEALED HORIZONTAL SPACES CREATED BY AN ASSEMBLY OF FLOOR JOISTS OR TRUSSES, AND BETWEEN CONCEALED VERTICAL AND HORIZONTAL SPACES SUCH AS OCCUR AT SOFFITS, DROP CEILINGS, COVE CEILINGS AND SIMILAR LOCATIONS.
3. STAIRWAYS - FIRE BLOCKING SHALL BE PROVIDED IN CONCEALED SPACES BETWEEN STRINGERS AT THE TOP AND BOTTOM OF THE RUN AND BETWEEN STUDS ALONG AND IN LINE WITH THE RUN OF STAIRS IF THE WALLS UNDER THE STAIRS ARE UNFINISHED.
4. ARCHITECTURAL TRIM - FIRE BLOCKING SHALL BE INSTALLED WITHIN CONCEALED SPACES OF EXTERIOR WALL FINISH AND OTHER EXTERIOR ARCHITECTURAL ELEMENTS AT MAXIMUM INTERVALS OF 20 FEET, IF NON-CONTINUOUS, SUCH ELEMENTS SHALL HAVE CLOSED ENDS, WITH AT LEAST 4 INCHES OF SEPARATION BETWEEN SECTIONS.

**LEGEND**

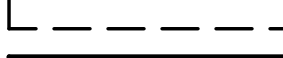
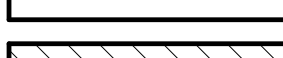
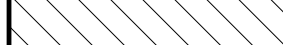
-  EXISTING
-  DEMOLISHED
-  PROPOSED
-  AREA NOT IN CONTRACT



PROJECT NORTH

**GENERAL CONTRACTOR**

**O'BRIEN CONSTRUCTION**  
966 Livernois, Troy, MI 48063  
Phone: 248.334.2470  
Fax: 248.334.0210

Unauthorized use of this drawing set without written permission from Inluz Ltd is in violation of U.S. COPYRIGHT LAWS and will be subject to civil damages and prosecution.

**Revision Schedule**

#	Description	Date
1	DD SET	03.31.2023
2	PERMIT SET	04.14.2023

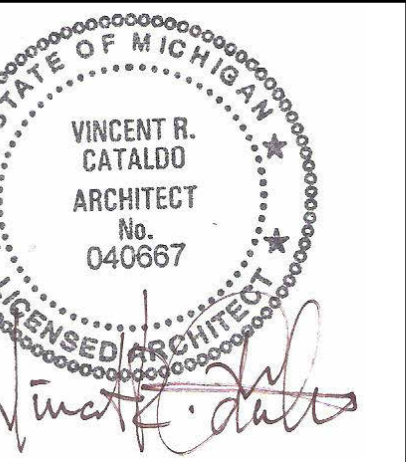

**THE DAVID WHITNEY**  
PROJECT NUMBER: Z71157  
1 PARK AVENUE  
DETROIT, MI 48226  
an AUTOGRAPH COLLECTION  
SHEET TITLE  
**OVERALL FLOOR PLANS**

SHEET NUMBER

**A100**