

# GRAND CIRCUS PARK MASTER PLAN

NOVEMBER 2022

# AGENDA

NOVEMBER 30, 2022

- Grand Circus Park background
- Previous project engagement feedback
- Preliminary concepts
- Park Master Plan

# A PUBLIC PARK AT THE CENTER OF THE CITY

A PLACE OF ORIENTATION & CIVIC PRIDE, A RESPITE FROM THE BUSY CITY

- Envisioned by Judge Augustus Woodward in 1805
- Established after 1850 as quiet, green respite
- Demolished for underground parking in 1957 and recreated
- Parking deck ramps and access points fragmented plan with fewer entrance points and pathways
- 1990's park improvements placed monuments at the Woodward Corners, further blocking clear access into the park
- The district around the park was added to the National Register of Historic Places 1983



# HISTORIC TRANSITION

OVER TIME, THE PARK HAS BECOME FRAGMENTED AND DISCONNECTED

PRE 1950's

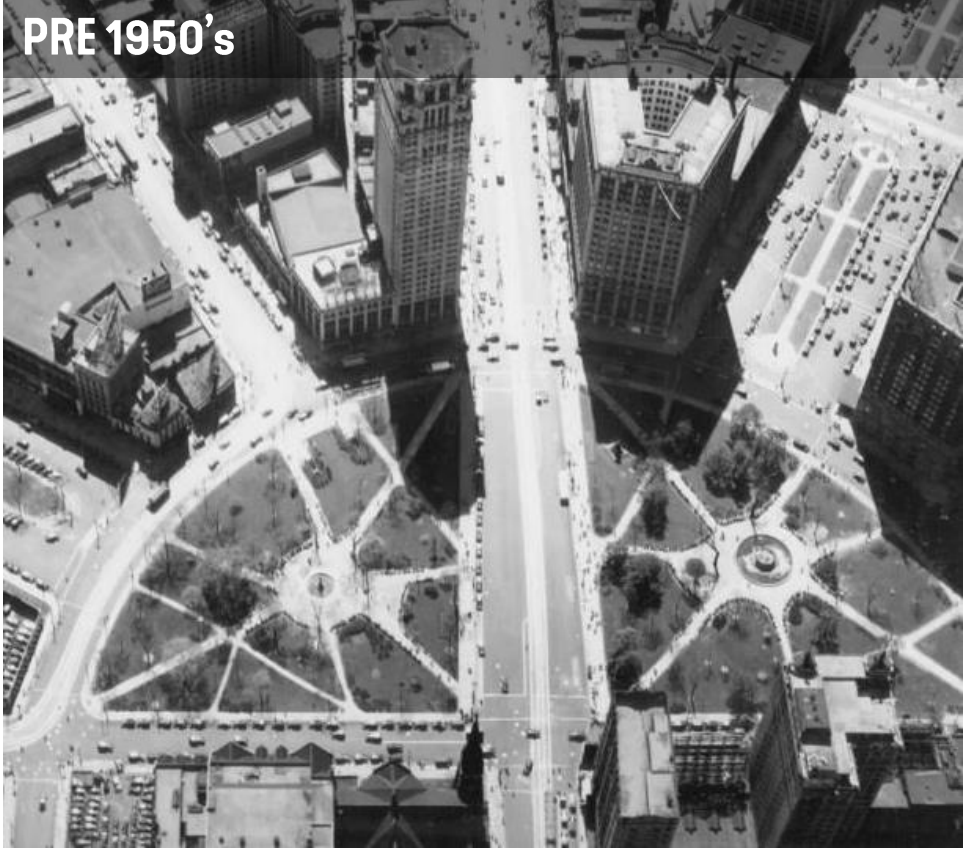

TRANSITION

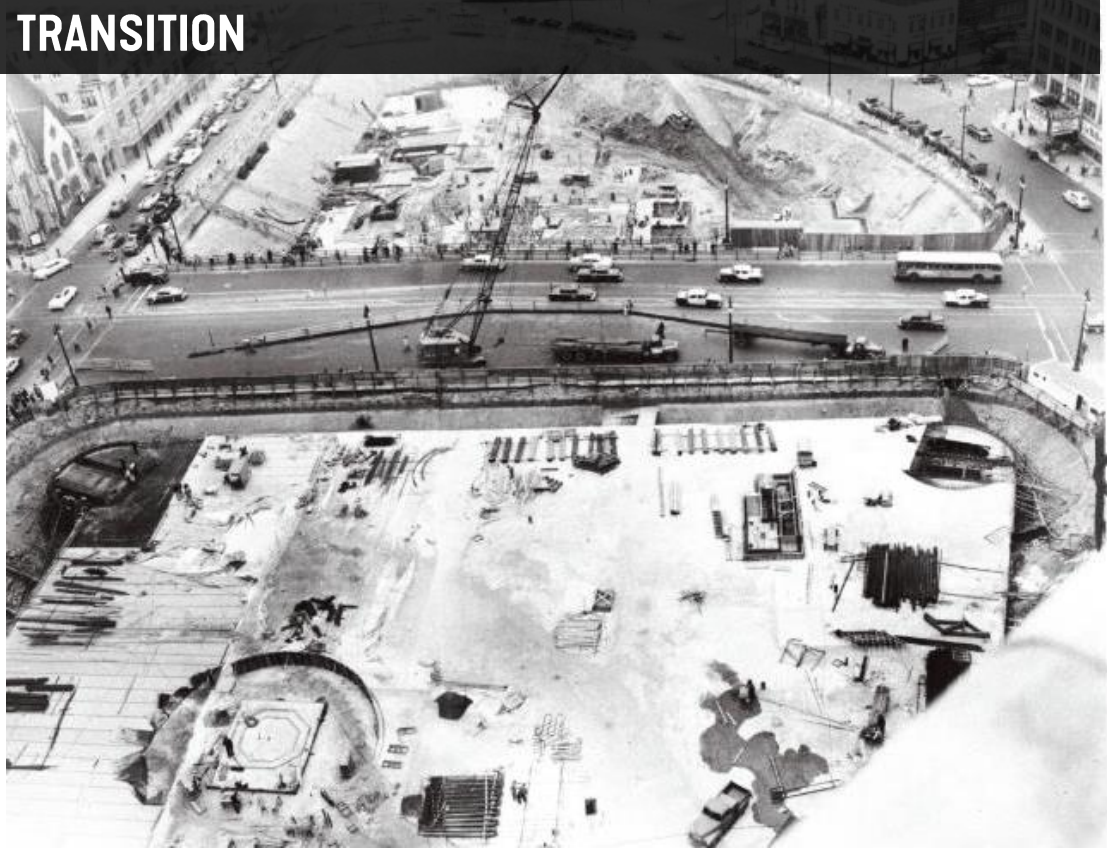

# HISTORIC TRANSITION

OVER TIME, THE PARK HAS BECOME FRAGMENTED AND DISCONNECTED

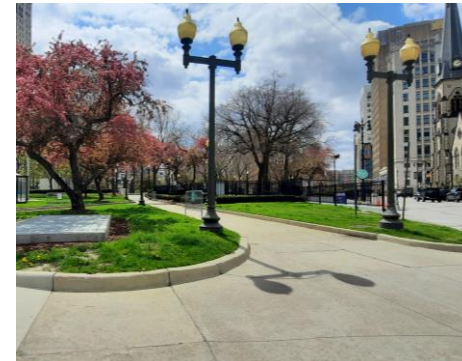
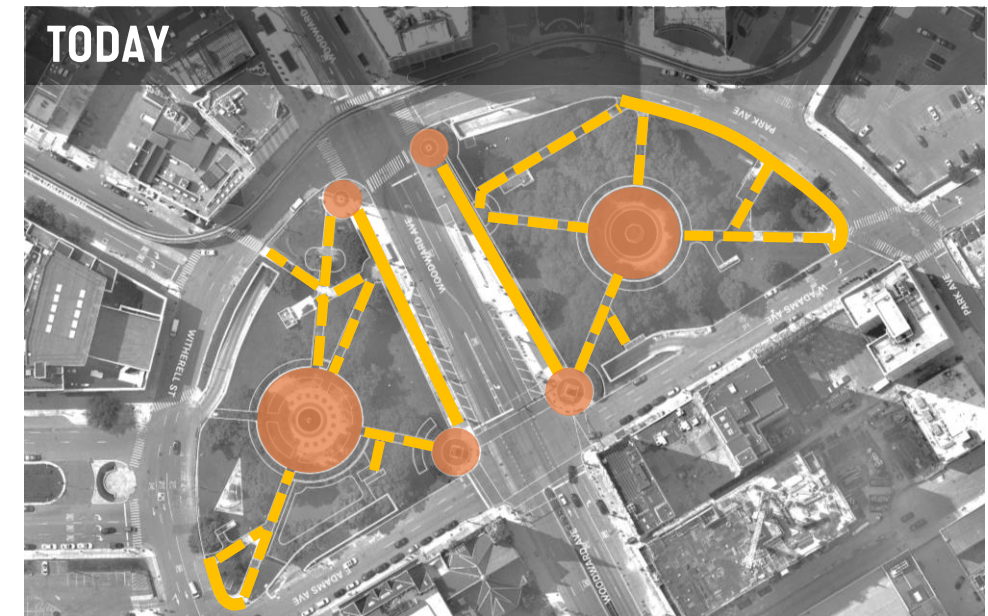
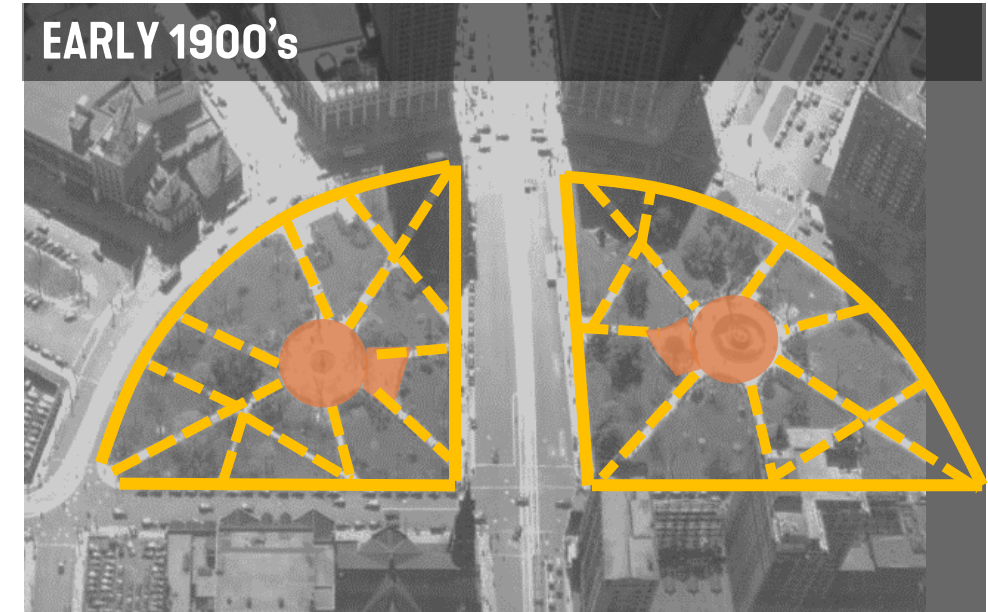
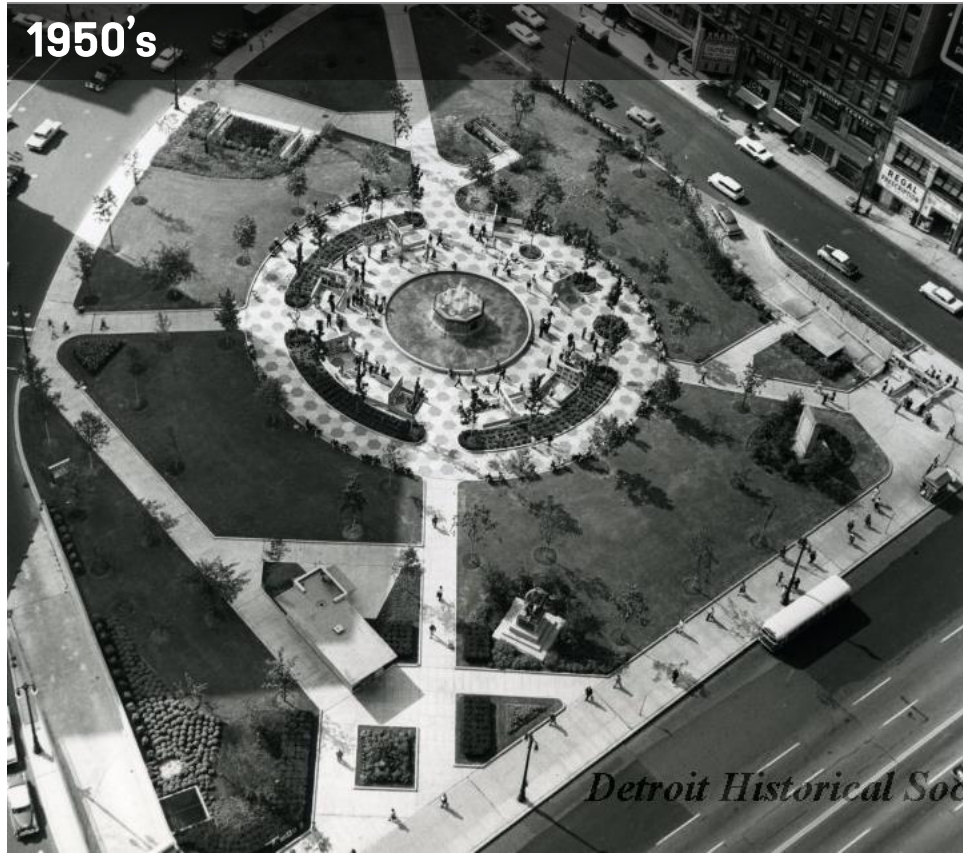

# GUIDING PRINCIPLES



## CIRCULATION + SAFETY

- Create a sense of arrival and entry at key crossing points
- Facilitate ease of movement to and through the park, supporting pedestrian desire lines for a better experience moving through and around the park
- Improve edges for pedestrians with perimeter walks
- Calm traffic on Woodward and reduce road width dedicated to vehicles

## FUNCTION

- Support downtown's most significant and growing residential district creating a park environment that can support an ever-evolving set of everyday experiences
- Ensure flexibility of the spaces in the design
- Provide inclusive space for all users, engaging a full spectrum of users from young to old
- Support activity active year-round
- Design for programming and events that are smaller scale for residents and downtown visitors, but also support the special gatherings of Detroit's theatre and entertainment/sports district
- Create a network of intimate daily use spaces and larger event spaces to support small performances, informal socializing, and enjoying the outdoors

- Support the role of food and beverage cafes as a strong community desire, a way to activate the park year-round and a key park revenue source
- Ensure there is adequate, well-designed and maintainable infrastructure for including park and event power, lighting, audio, water, waste management, snow removal etc.

## HISTORY + CHARACTER

- Reflect and celebrate the unique history of Grand Circus Park and the Grand Circus Park district in the park's design and incorporate the historic fountains and statues
- Continue to include a significant presence of green spaces and trees, with some hardscape/plaza areas for small gatherings, and spaces to sit in both sun and shade
- Enhance and support connections and key views of both the west side and east sides of the park, district storefronts, Grand Circus Park architecture and the Detroit skyline
- Respect the historic framework - multiple points of entry and clear paths through the park
- Make it a comfortable place where people want to visit often, including café areas, improved seating and landscape

# RECAP - ENGAGEMENT MEETING 1

## WHAT DO YOU THINK?

What do you like most about the park?  
What do you dislike?

Place dots or leave comments with sticky notes on below map.

I love it! It bothers me. I have a comment.

**GRAND CIRCUS PARK**

## PARK OVER TIME

What should we keep, restore, or remove?

### 1920s

### 1950s (After Underground Parking Construction)

### Current

## WHAT MATTERS MOST TODAY?

Place dots on what you think matters most to the park. This matters to me!

### History + Identity

- Respect historic character
- Restore as a neighborhood park
- Maintain existing sculptures
- Introduce new sculptures/art

### Form + Function

- Install new sidewalks around the park perimeter
- Install additional sidewalks through the park
- Unify the park as one
- Create spaces for small events
- Provide additional recreational amenities
- Modify the dog park
- Provide additional seating options

### Infrastructure

- Improve lighting and security
- Manage traffic between the two parks
- Manage traffic around the two parks

## HOW SHOULD THE PARK LOOK?

Place dots on images of features you like. I love it!

## WHAT NEEDS TO BE CONSIDERED?

Place sticky notes with your responses below. I think we should consider...

- Install new perimeter walks and multiple entries
- Unify the park as one / reduce Woodward impact
- Respect historic character
- Improve lighting and security
- Calm and manage traffic
- Create spaces for small events

# PARK CONCEPTS

## CONCEPT 1 - BUTTERFLY

Place dots or leave comments with sticky notes on below map.

😊 I love it! 😞 It bothers me. 📝 I have a comment



## CONCEPT 2 - CENTRAL GREEN

Place dots or leave comments with sticky notes on below map.

😊 I love it! 😞 It bothers me. 📝 I have a comment

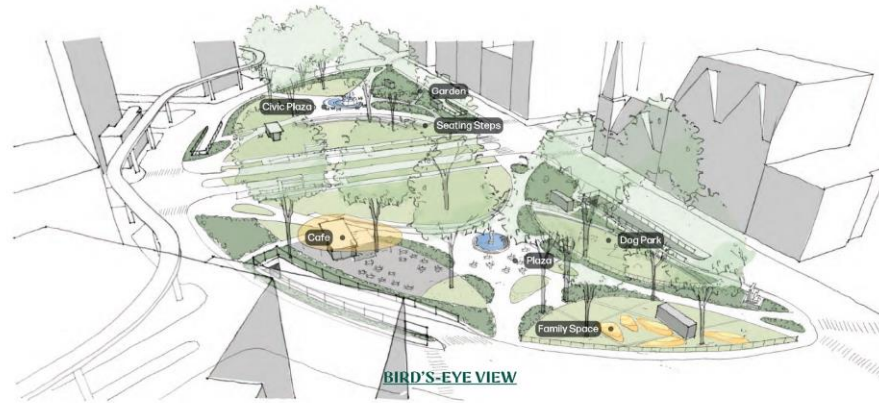

## CONCEPT 3 - PATHWAYS

Place dots or leave comments with sticky notes on below map.

😊 I love it! 😞 It bothers me. 📝 I have a comment





# RECAP – ENGAGEMENT MEETING 2

## HANDOUT SURVEY SUMMARY

- Consider design with **multiple entries and path options** for everyday users passing through the park
- **Clean, simple, and practical design** to activate the park in the most immediate sense
- Provide **perimeter sidewalk** to improve access
- Park programming and informal daily uses attract frequent use
- Night lighting enhances safety and security

Grand Circus Park Guiding Design Principles	Butterfly	Central Green	Pathways
<b>Circulation + Safety</b>	<b>3.3</b>	<b>3.5</b>	<b>4.7</b>
• Create a sense of arrival and entry at key crossing points	3.2	3.3	4.7
• Enhance key connections and views within and surrounding the park	2.8	3.5	4.8
• Facilitate ease of movement with multiple entries and clear paths through and around the park	3.3	3.4	4.9
• Calm traffic on Woodward and reduce road width dedicated to vehicles	3.8	3.8	4.4
<b>Function</b>	<b>3.8</b>	<b>3.9</b>	<b>4.0</b>
• Prioritize park function for surrounding residents by supporting daily needs	3.7	3.8	3.8
• Provide inclusive opportunities for all ages and abilities	3.9	3.8	3.8
• Ensure flexibility for smaller daily events and special district gatherings, year-round	3.9	4.1	3.7
• Accommodate cafés for year-round activity and a key source of revenue	4.1	3.9	4.4
• Accommodate the needs of dogs and their owners by maintaining or improving infrastructure.	3.9	4.0	4.3
• Incorporate event infrastructure to facilitate maintenance and event operations	3.6	4.0	4.0
• Improve lighting and security	3.5	4.0	4.5
<b>History + Character</b>	<b>3.7</b>	<b>4.0</b>	<b>4.2</b>
• Reflect and celebrate the history of the park and surrounding district	3.2	3.4	4.4
• Incorporate historic fountains and statues	4.0	4.0	4.5
• Maintain significant green space and trees as well as plazas for small gatherings	4.0	4.3	3.9
• Visually unify the park across Woodward and improve connections between each side	3.2	4.5	3.7
• Provide seating in sun, shade, and a variety of environments	4.1	4.0	4.3
• Create an environment that supports an ever-evolving set of everyday experiences	3.8	3.8	4.2
<b>Total Scoring</b>	<b>3.6</b>	<b>3.9</b>	<b>4.3</b>

# PRELIMINARY PARK CONCEPT

- Direct paths of travel from crossings and entry points
- Draws users into and through the park from all directions.
- Paths skirt past fountains, creating plazas and outdoor rooms
- Street corners open for clear sight lines to destinations within and across the park
- Daily park programming activates more areas of the park
- Design clarity creates a sense of unity
- Path views to surrounding buildings anchor them to the park experience

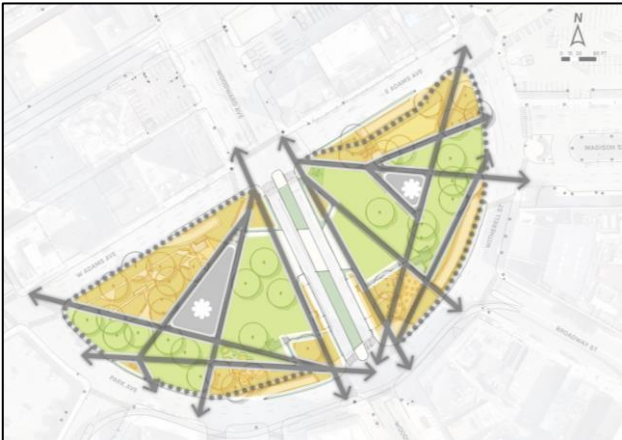
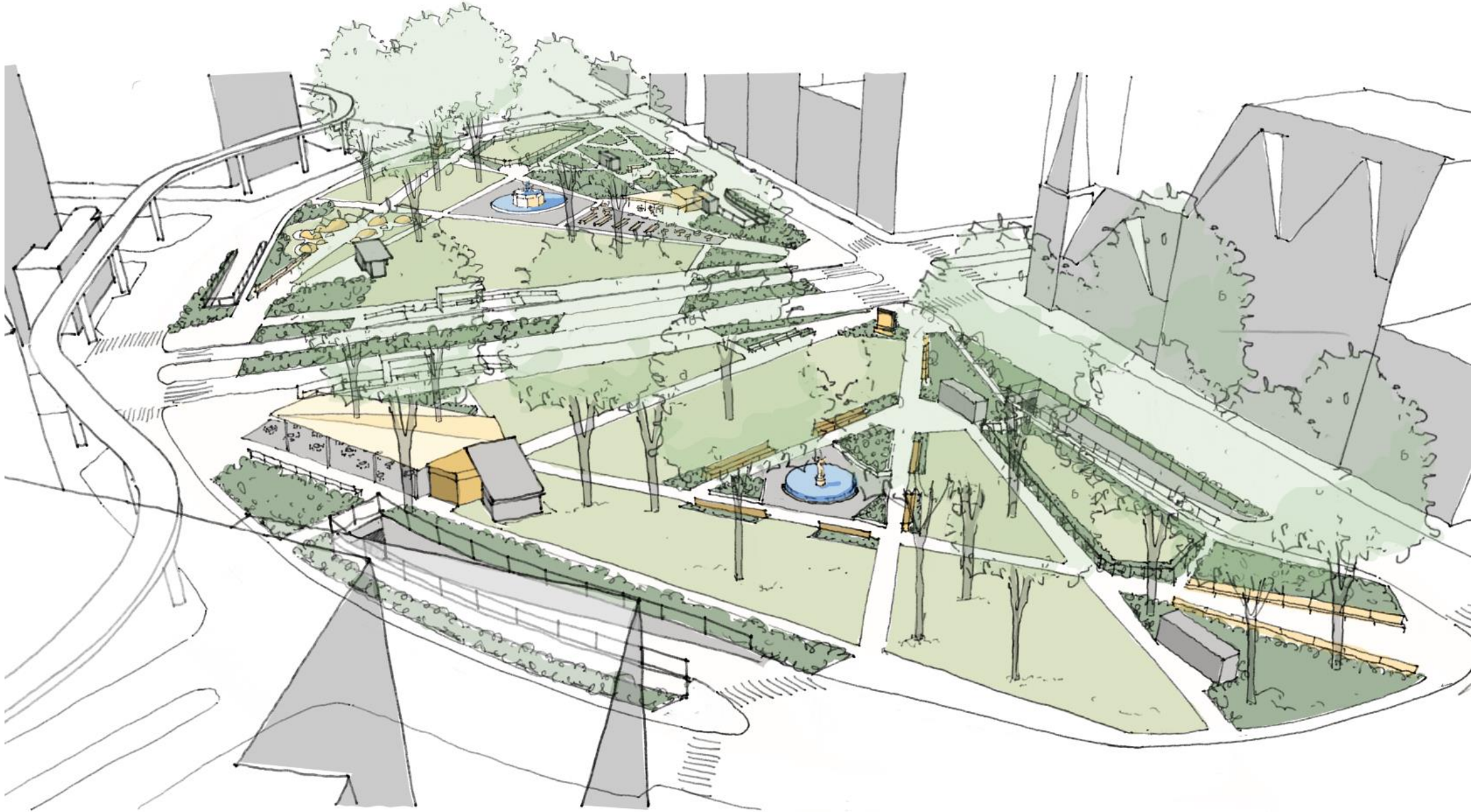

# PARK MASTER PLAN

- The master plan creates direct physical and visual connections across the park
- Park edges are buffered by street landscaping
- Open spaces are improved for events and programming
- Diversity of outdoor spaces allow for vary daily experience
- Traffic is calmed by a new median in Woodward Ave, road diet in Adams, widening crosswalks, and street trees

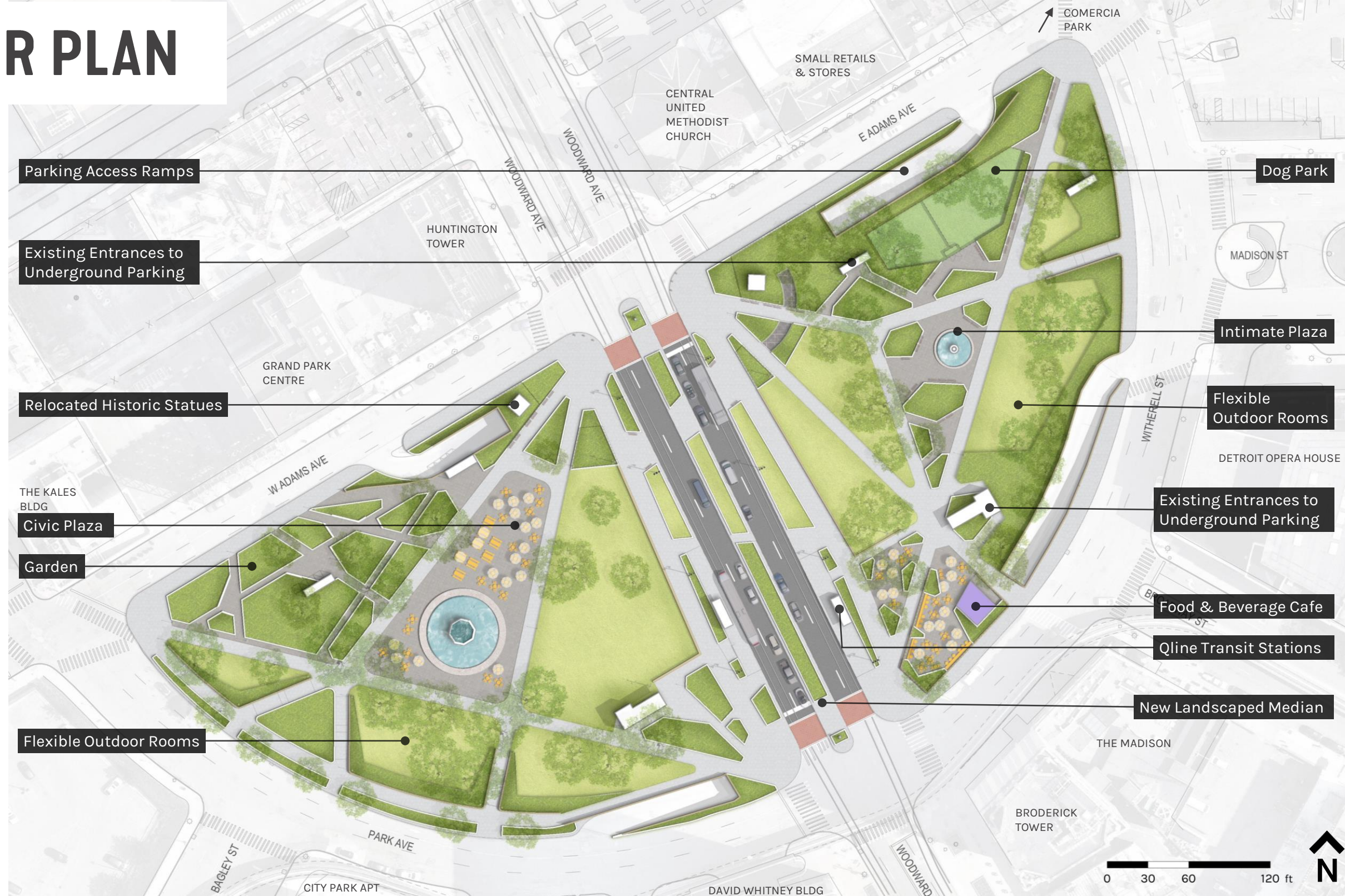

# VIEW SOUTH EAST

PARK IS UNIFIED BY A NEW MEDIAN AND REDUCED ROAD WIDTHS IN WOODWARD AVENUE

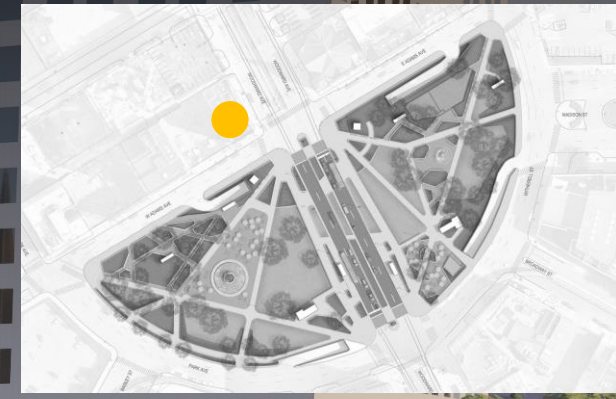

# VIEW SOUTHWEST

CORNERS ARE WELCOMING, WITH WOODWARD MEDIAN AND WIDE CROSSINGS

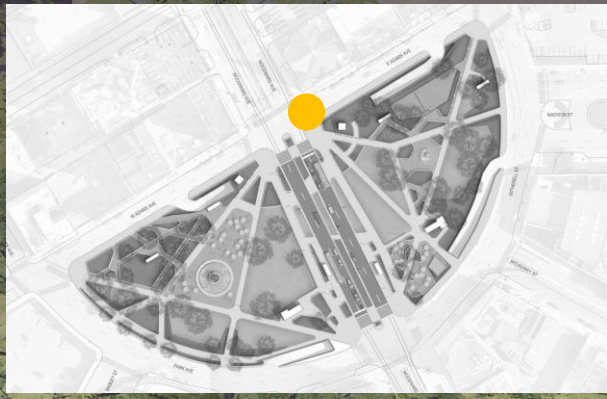

# VIEW SOUTHWEST

PATHS LEAD TO SURROUNDING DESTINATIONS AND FORM THE EDGES OF USABLE SPACES

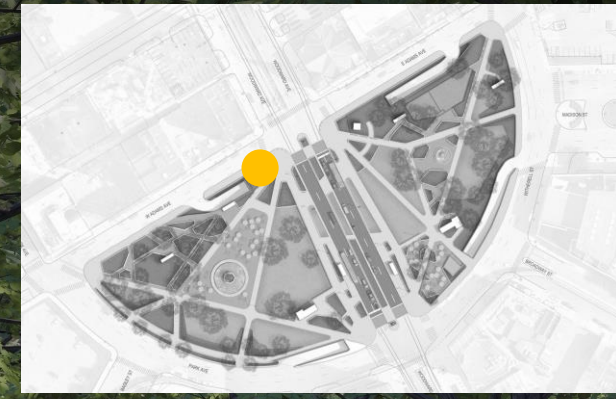

# DAILY EXPERIENCES

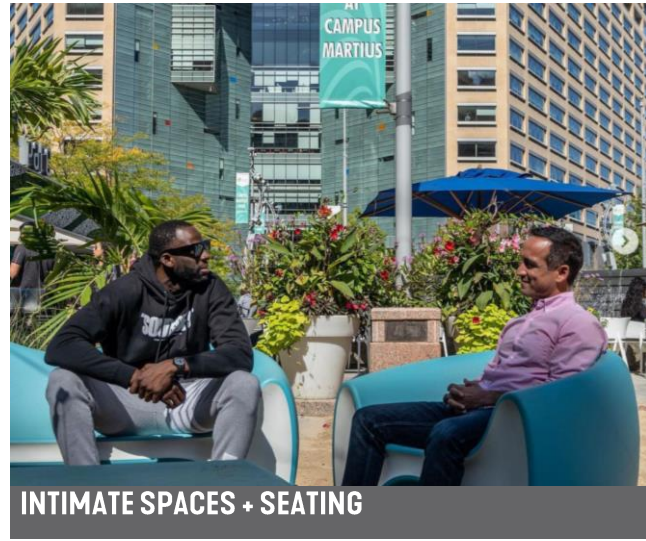
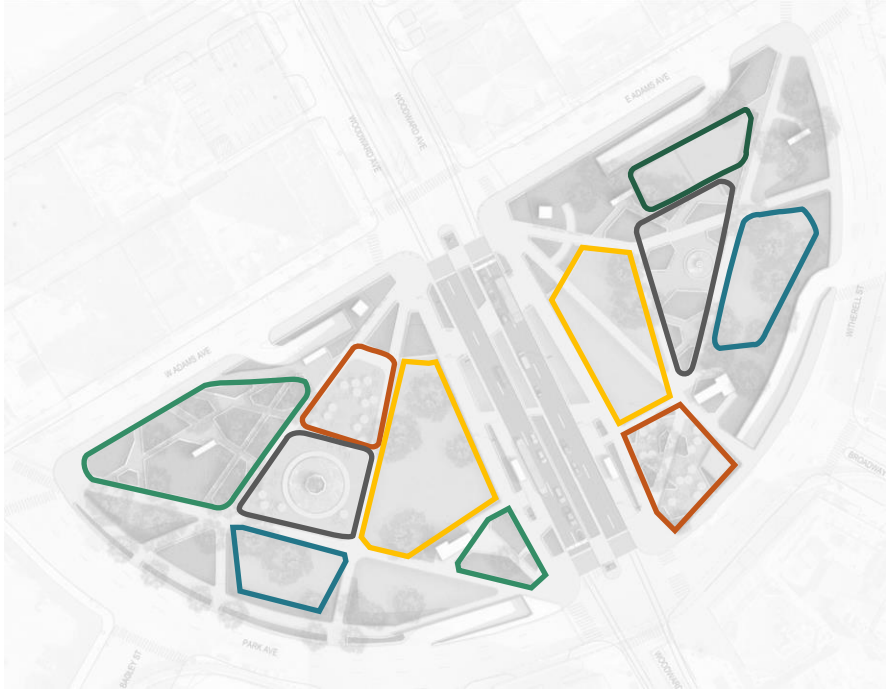

INTIMATE SPACES + SEATING



NATURE + GARDENS



ORGANIZED ACTIVITIES



DOG PARK



FAMILY-FRIENDLY SPACES



OUTDOOR CAFE

# VIEW NORTHEAST

A CAFÉ SERVES AS THE FRONT PORCH, EXTENDING VIBRANCY TO THE PARK'S EDGES

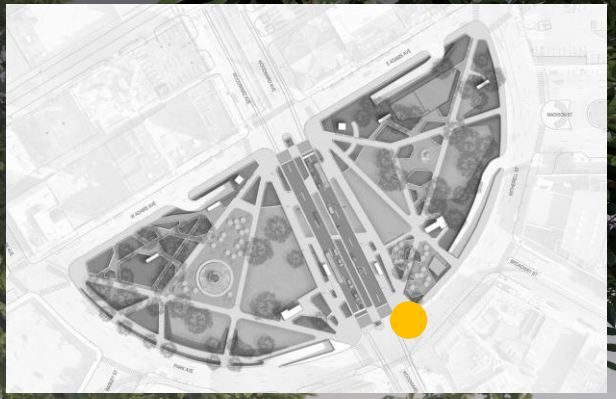

GRAND CIRCUS PARK BUILT 1867



# VIEW WEST

LAWNS ARE LIFTED UP TO PROVIDE FLAT, USABLE, CONNECTED SPACES

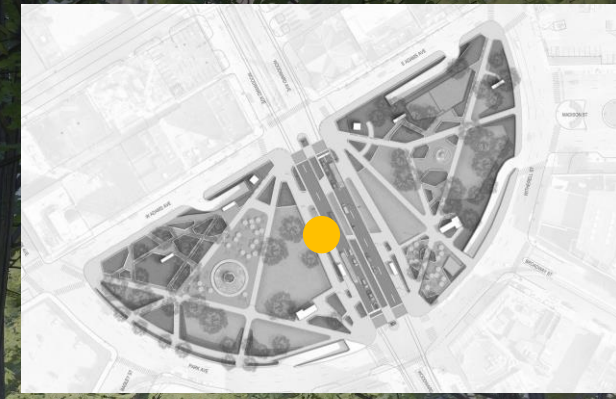

# VIEW NORTHEAST

## PEDESTRIAN GATEWAYS ALONG PERIMETER PATH

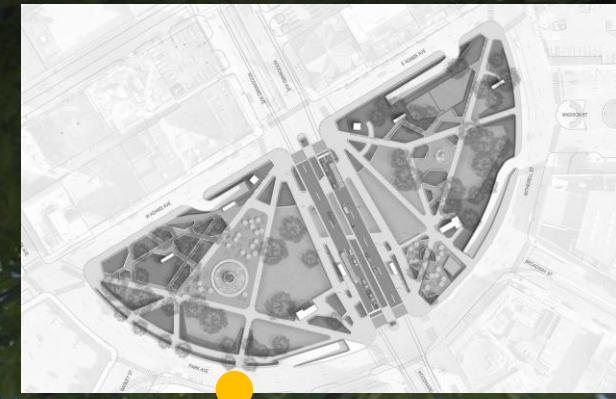

# VIEW SOUTHEAST

WALKABLE, BUFFERED STREET EDGE

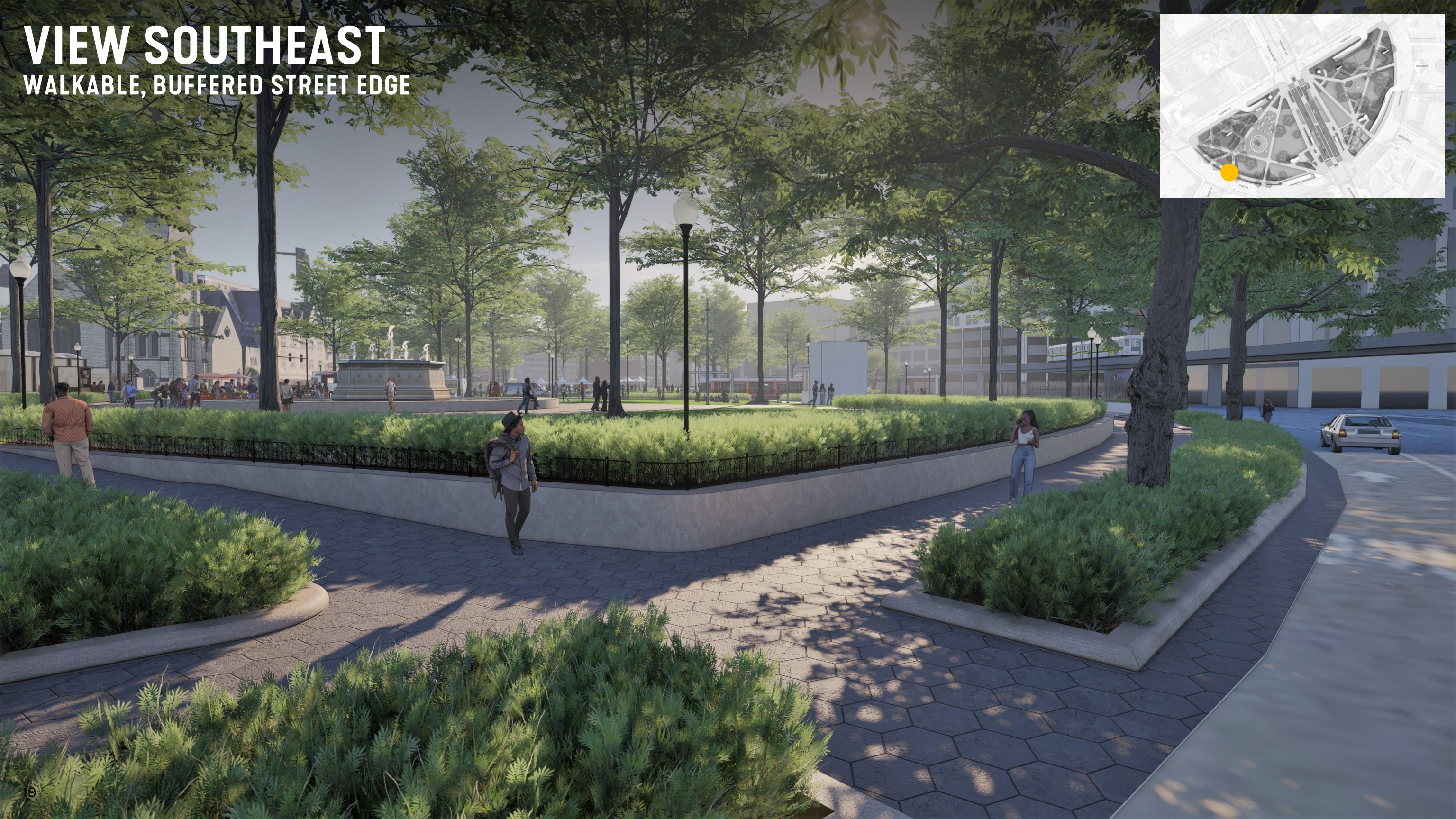

# VIEW SOUTH

FLEXIBLE LAWNS AND OPEN SPACES FOSTER COMMUNITY PROGRAMMING

