

PORCH RE-DO

DATE: 9/21/22
PAGE 1 of 2

1531 PARKER - EXISTING HOUSE

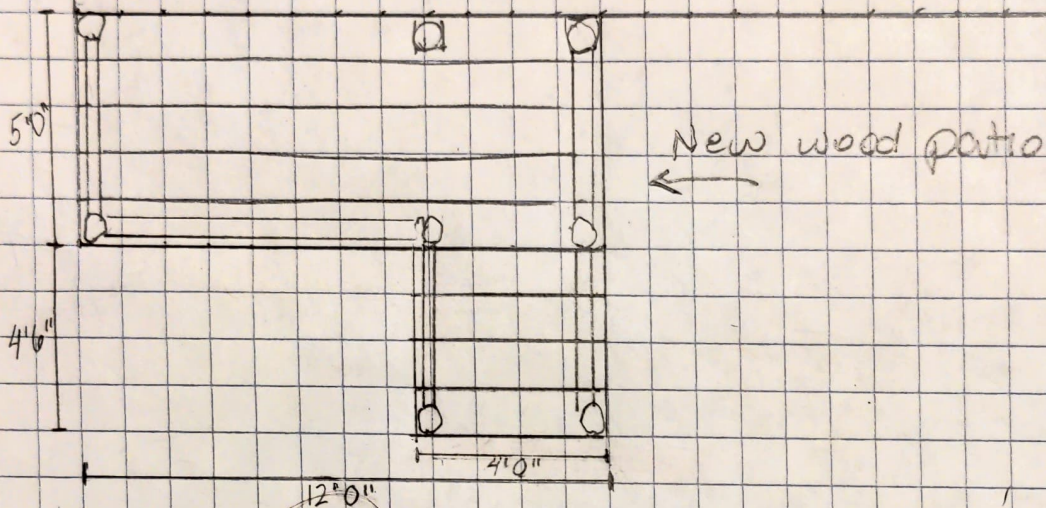

FRONT ELEVATION

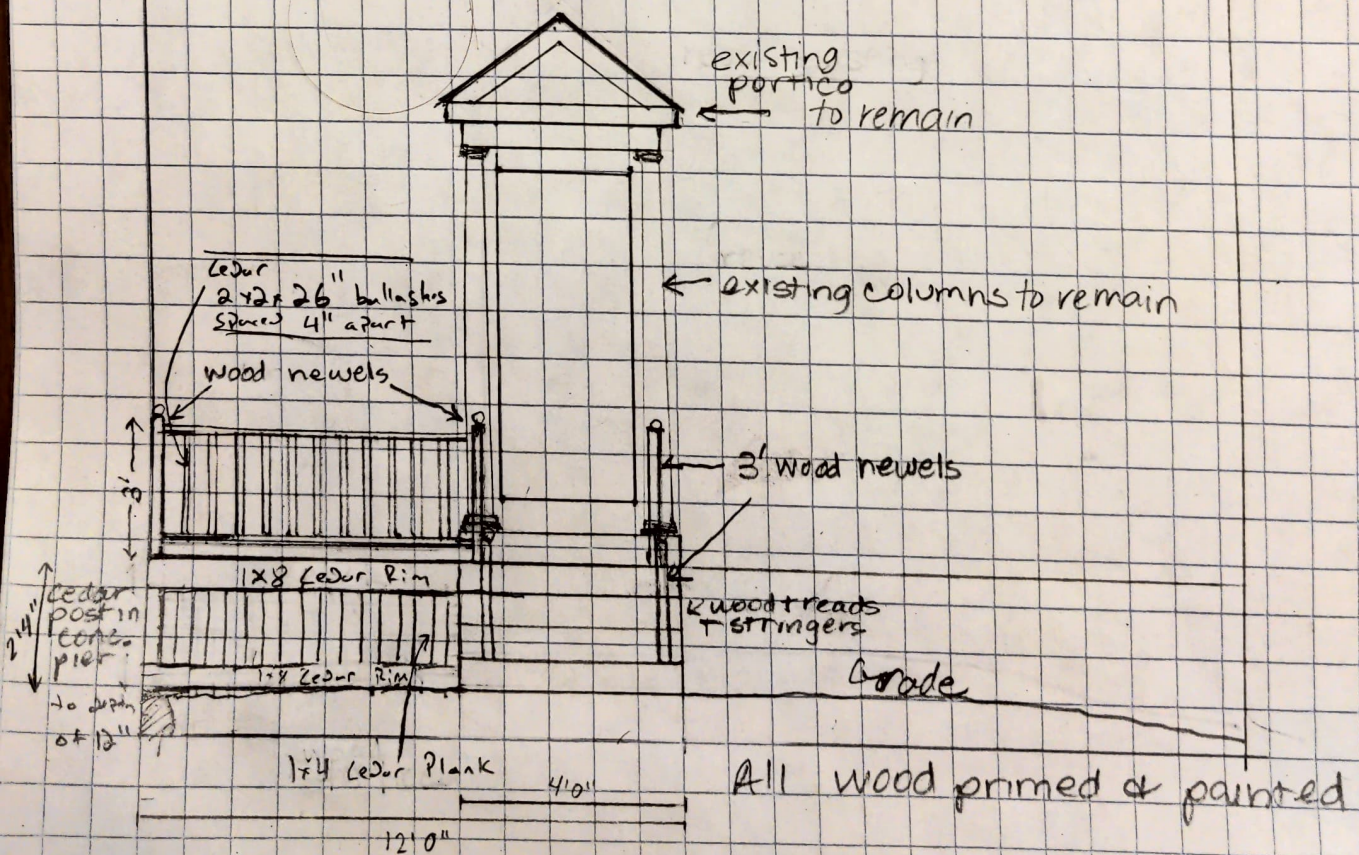

HOUSE

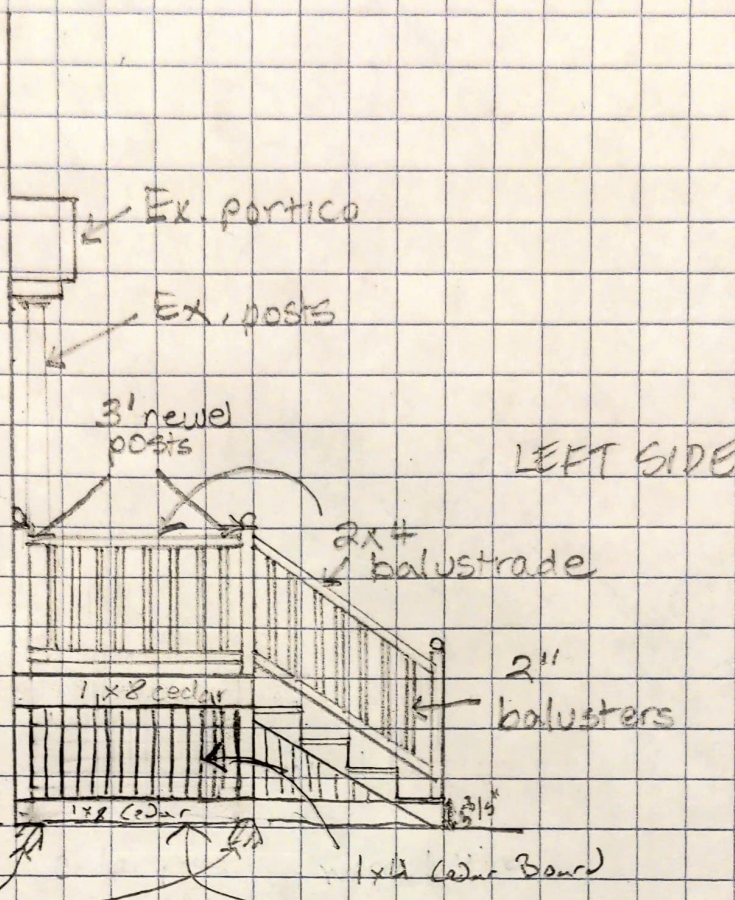

LEFT SIDE VIEW

Cedar Post
in footing
to depth of
12"

5'10" 4'6"

Sub-grade
Vapor Barrier
2" Pen gravel below
entire porch

Right side view

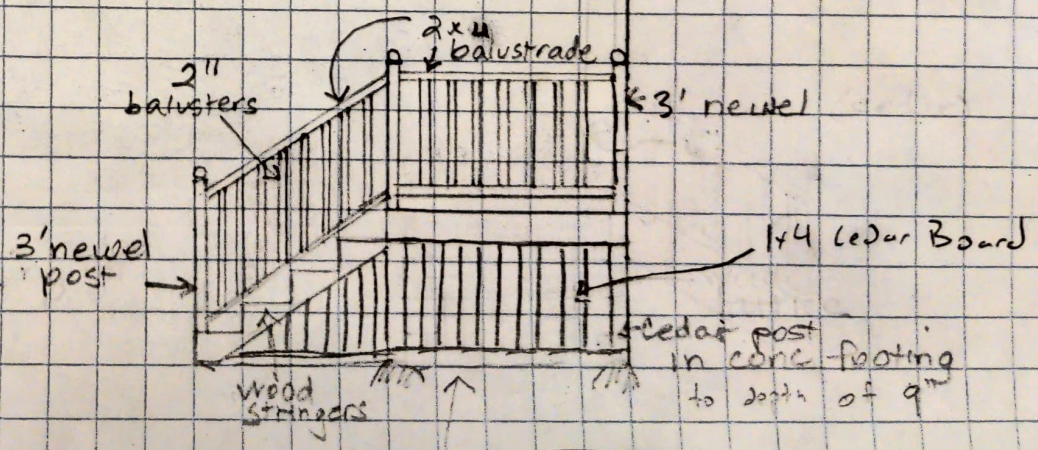

Sub-grade
vapor barrier
2" Pen gravel below entire porch