

ENTRANCE DOORS GENERAL NOTES

1. THE ENTRANCE/EXIT DOORS ARE TO OPERATE AS FOLLOWS: THE ENTRANCE DOORS NO. 102 ARE TO SERVE THE SECOND FLOOR SPACE. THE ENTRANCE DOOR NO. 103 IS TO SERVE THE NEW SIDEWALK LEVEL BAR. ALL THREE DOORS SWING IN THE OUTWARD DIRECTION. ALL THREE DOORS ARE TO HAVE PANIC AND FIRE EXIT DOOR HARDWARE PER THE 2015 MICHIGAN BUILDING CODE.

2. THESE THREE DOORS ARE TO BE 1.75" THICK (VERIFY WITH OWNER THE OPTION OF A 2.25" THICKNESS), MADE OF OAK HARDWOOD. DIMENSIONS SHOWN ON THE DRAWING ARE NOMINAL. VERIFY WITH OWNER IF DOORS ARE TO BE SHOP- OR SITE-FITTED FOR HARDWARE. DOOR FRAMES ARE TO BE ALUMINUM TUBING, NOMINAL 2" FACE x 5.5" DEPTH.

3. ALL DOOR GLAZING IS TO BE FULLY HEAT-TEMPERED 1" THICK THERMOPANE GLASS, ABSOLUTELY CLEAR. DO NOT USE low-e GLASS. REPEAT: NO low-e COATING.

4. DOOR HARDWARE: IT IS THE OWNER'S INTENT TO USE VINTAGE DOOR HARDWARE, IF POSSIBLE:

DOORS NO. 102 (PAIR)

- 4 PAIR 4.5" x 4.5" BALLBEARING HINGES
- 2 EXTERIOR PULL - SUPPLIED BY OWNER
- 2 INTERIOR HORIZONTAL PANIC BAR - SUPPLIED BY OWNER
- 2 POLISHED BRASS KICK PLATES 30" x 14"
- 1 DOOR CLOSER - VERIFY SIZE AND TYPE
- 1 MORTISE DEAD BOLT, KEYED AT EXTERIOR, THUMB-TURN AT INTERIOR - VERIFY DEAD BOLT WITH FIRE MARSHAL; SUPPLIED BY OWNER.

DOOR NO. 103

- 2 PAIR 4.5" x 4.5" BALLBEARING HINGES
- 1 EXTERIOR PULL - SUPPLIED BY OWNER
- 1 INTERIOR HORIZONTAL PANIC BAR - SUPPLIED BY OWNER
- 1 POLISHED BRASS KICK PLATE 30" x 14"
- 1 MORTISE DEAD BOLT, KEYED AT EXTERIOR, THUMB-TURN AT INTERIOR - VERIFY DEAD BOLT WITH FIRE MARSHAL;; SUPPLIED BY OWNER.

ON BOTH DOORS, VERIFY WITH OWNER THE TYPE OF HOLD-OPEN DEVICES, ANY ASTRAGAL AT THE DOORS' MEETING, AND DOOR WEATHERSTRIPPING.

5. VERIFY WITH OWNER TYPE AND SIZE OF THRESHOLD PLATE AT BASE OF ENTRANCE DOORS.

6. DOOR FINISH TO BE "PRAIRIE WHEAT" GEL STAIN, AS MANUFACTURED BY GENERAL FINISHES, WITH SATIN FINAL COATING; VERIFY WITH ARCHITECT.

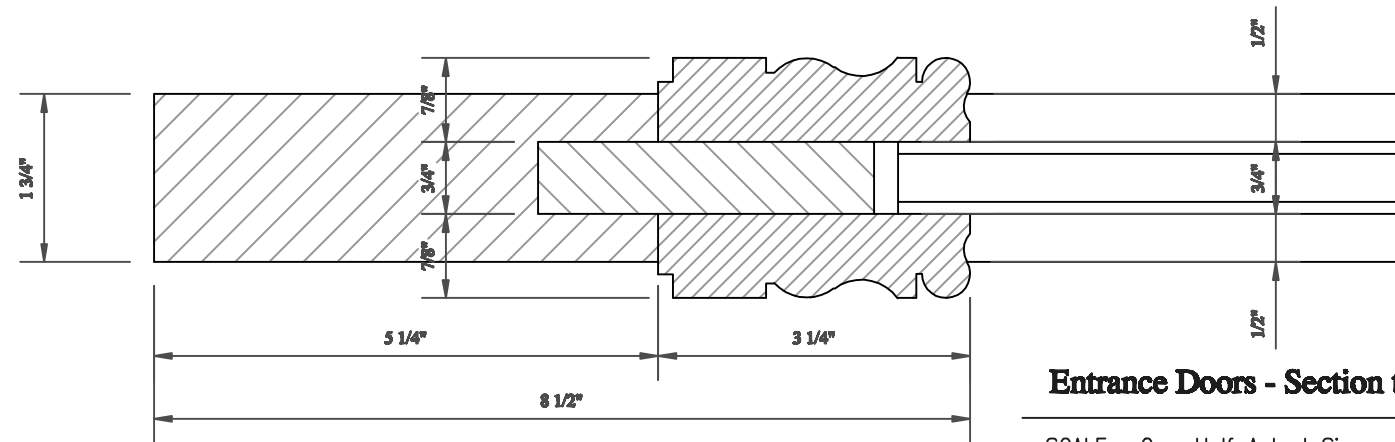

Entrance Doors - Section through Stile

SCALE: One-Half Actual Size

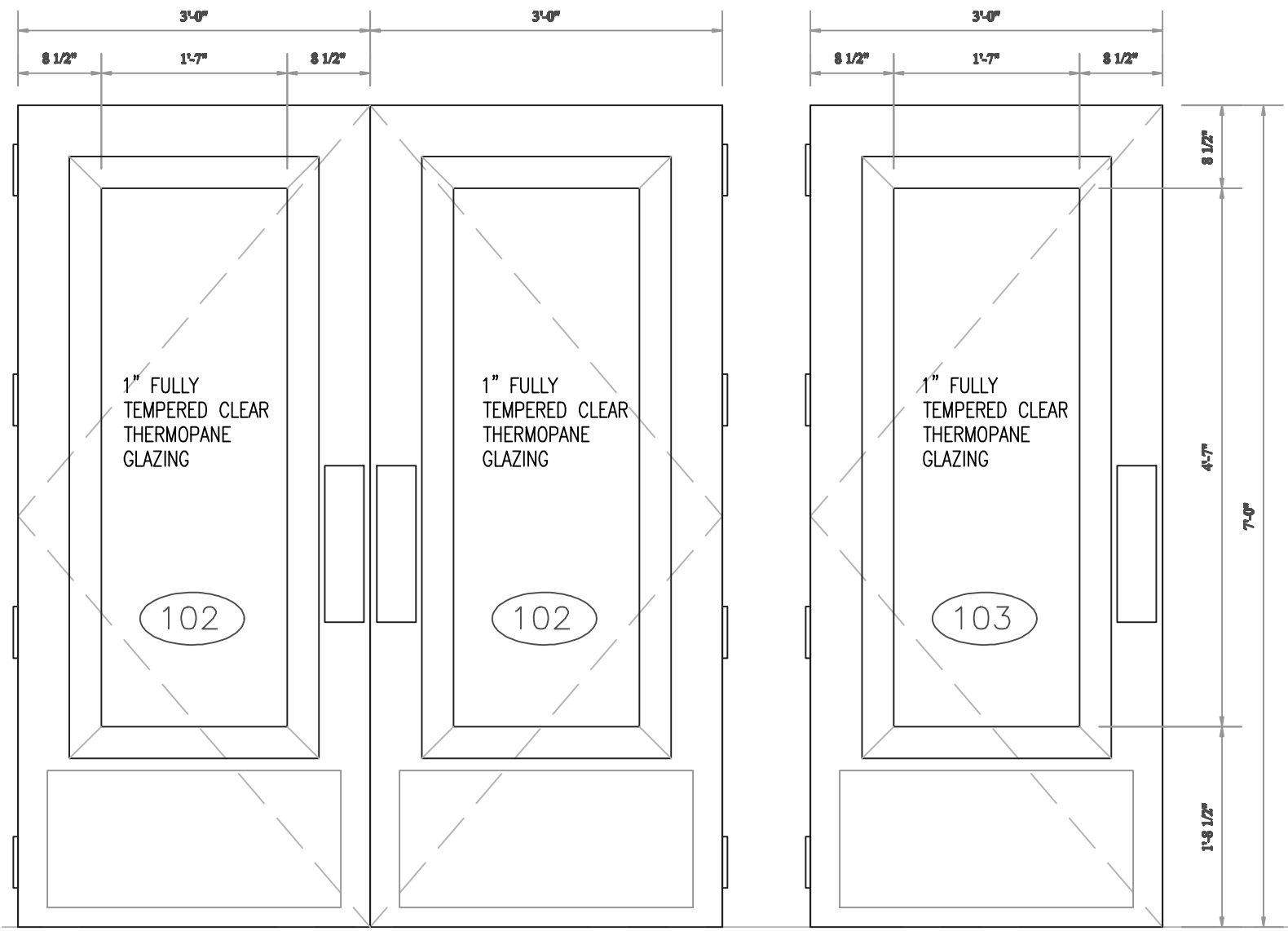

Entrance Doors - Exterior Elevation

SCALE: 3/4" = 1' - 0"

**McCleer
Architetto**

4736 Avery
Detroit, Michigan 48208
(313) 831 8116
mccarch@flash.net

© Copyright 2022
Michael J McCleer

Renovations to the Campau Building - Bar
Southeast Corner of Park and Elizabeth Streets Detroit Michigan
Architectural Floor Plan

- Review: 05.13.2022
- Review: 05.16.2022
- Review: 07.18.2022
- Review: 08.22.2022
- Review: 09.02.2022