

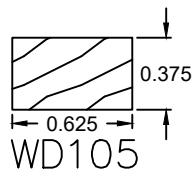

Please contact us toll free at
855-318-5022 or
orders@bigbluwindow.com
for additional help.

Wood Grille Profiles

5/8" Profiles

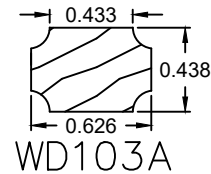
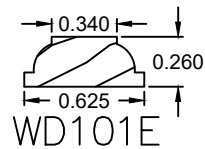
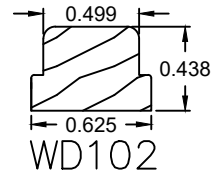
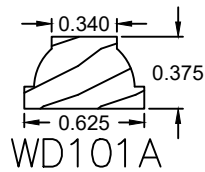



Wood Grille Profiles

Please contact us toll free at
855-318-5022 or
orders@bigbluewindow.com
for additional help.

7/8" Profiles

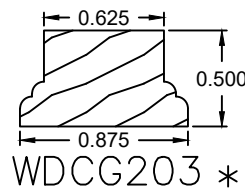
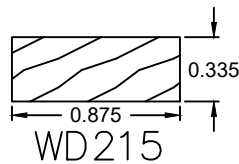
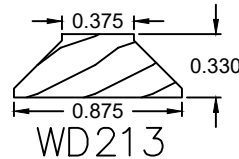
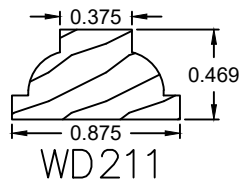
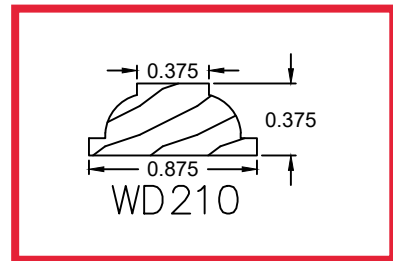
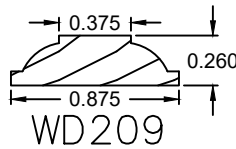
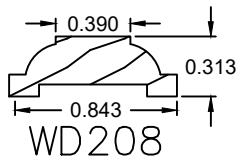
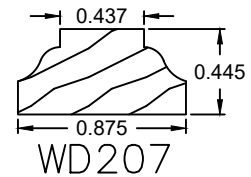
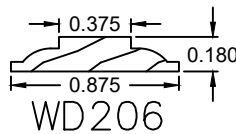
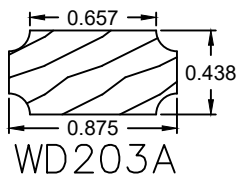

* Currently no radius bars are available for this profile.



Wood Grille Profiles

Please contact us toll free at
855-318-5022 or
orders@bigbluwindow.com
for additional help.

1" Profiles

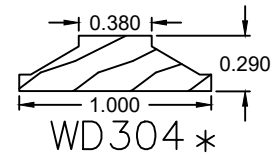
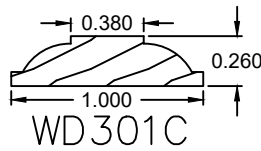
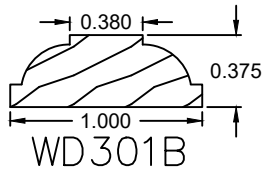

1-1/8" Profiles

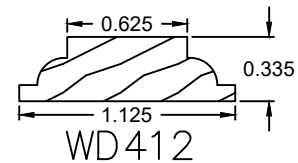
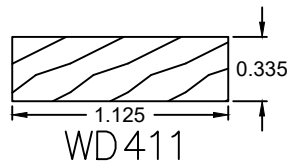
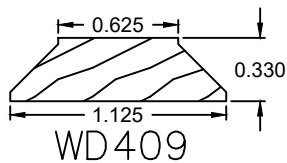
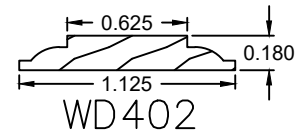
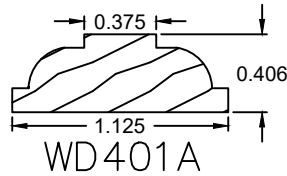
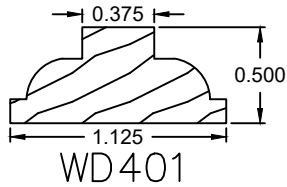

* Currently no radius bars are available for this profile.



Wood Grille Profiles

Please contact us toll free at
855-318-5022 or
orders@bigbluwindow.com
for additional help.

1-1/4" Profiles

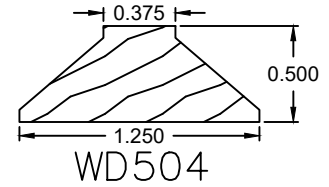
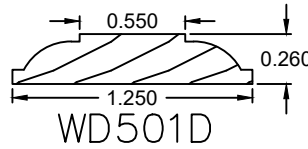
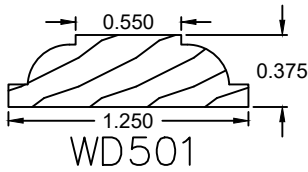

2" Profiles

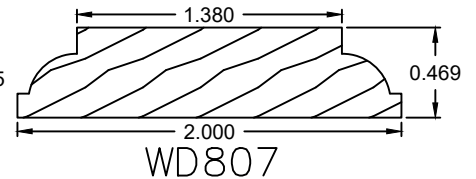
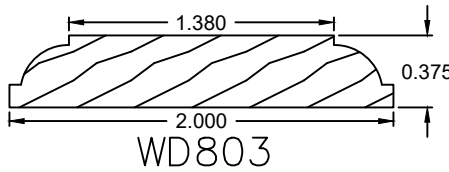
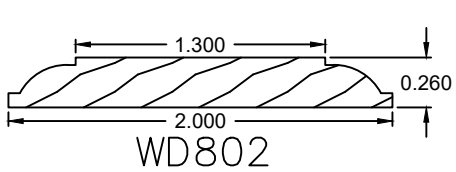

Miscellaneous Profiles

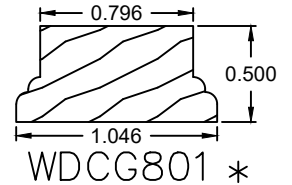
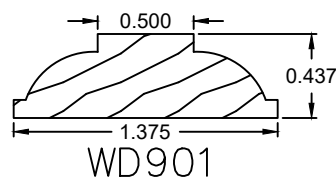
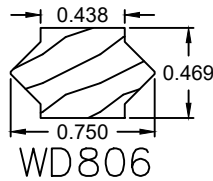
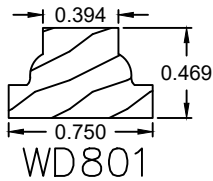

* Currently no radius bars are available for this profile.

Fastening Systems

Concealed Clips



For use with surround wood grilles

Metal clips that insert between the glass and the glazing bead (interior stop) and reveal a tension-mount clip designed to receive the surround profile of a full surround grille. The clips are completely concealed from view once the grille is installed.

Push Pins & Grommets



For use with surround wood grilles

Grommets are pre-drilled and installed into the surround perimeter at the factory. The push pins fit through the grommets. The grille is secured by pushing the pins into the wood sash or glazing bead.

Slide Pins



For use with non-surround wood grilles

Slide pins travel in channels that are pre-cut into the ends of each grille bar. The pin is pushed into the wood sash or glazing bead to secure the grille. For interior grilles only.

3M™ Dual Lock™

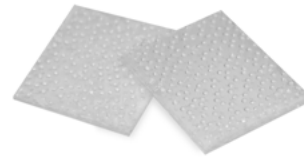

For use with surround and non-surround wood grilles

Pre-cut interlocking tabs are applied by sticking the tabs to both the grille and glass. Specially designed mushroom heads keep the grille in place.

Double-Sided Tape



For use on SDL (Simulated Divided Lite) grilles

The tape is pre-applied to the grilles. The grilles are then applied directly (and permanently) to the glass. *Black only.*

DOUBLE-SIDED VBH TAPE IS RECOMMENDED - THIS IS WHAT WINDOW MANUFACTURERS USE TO AFFIX SIMULATED DIVIDED LITES TO GLASS

Replacement fasteners are available for individual purchase on our website.



Please contact us toll free at
855-318-5022 or
orders@bigbluewindow.com
for a additional help.

How to Measure

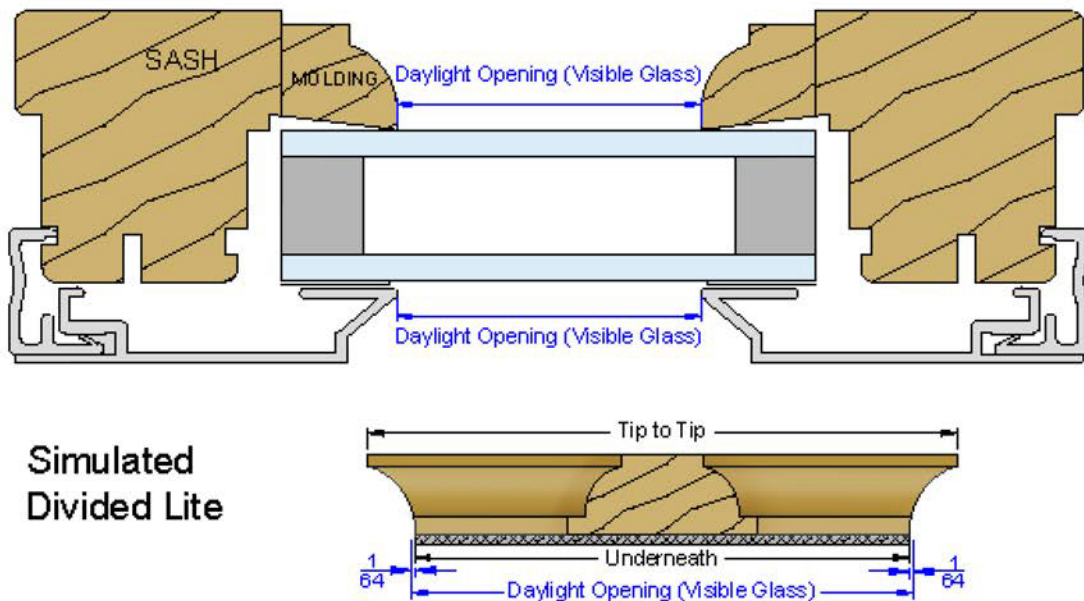

How to Measure for Simulated Divided Lite (SDL) Grilles

Measurements must be taken on the inside and the outside of the glass.

- To measure **Daylight Opening (DLO)**, measure the visible glass, from stop to stop.
- To measure the **Tip-to-Tip** dimension, measure the longest part of the grille on the top of the profile (the portion that faces outward from the glass).
- To measure the **Underneath** dimension, measure the shortest part of the grille bar, on the bottom of the profile (the portion that touches the glass).