



1814-1820 Church, South/Front





1814-1820 Church, North/Back





1814-1820 Church, East





1814-1820 Church, East



1814-1820 Church, West





1814-1820 Church, NW Corner





1814 Church, Old Double Hung Top Sash





1814 Church, Old Double Hung Bottom Sash





1814 Church, Old Double Hung Sashes





1814 Church, Old Alum. Storm Style East





1814-1820 Church, Double-Hung Marvin Clad  
Interior





1814-1820 Church, Double Hung Marvin Clad  
Exterior

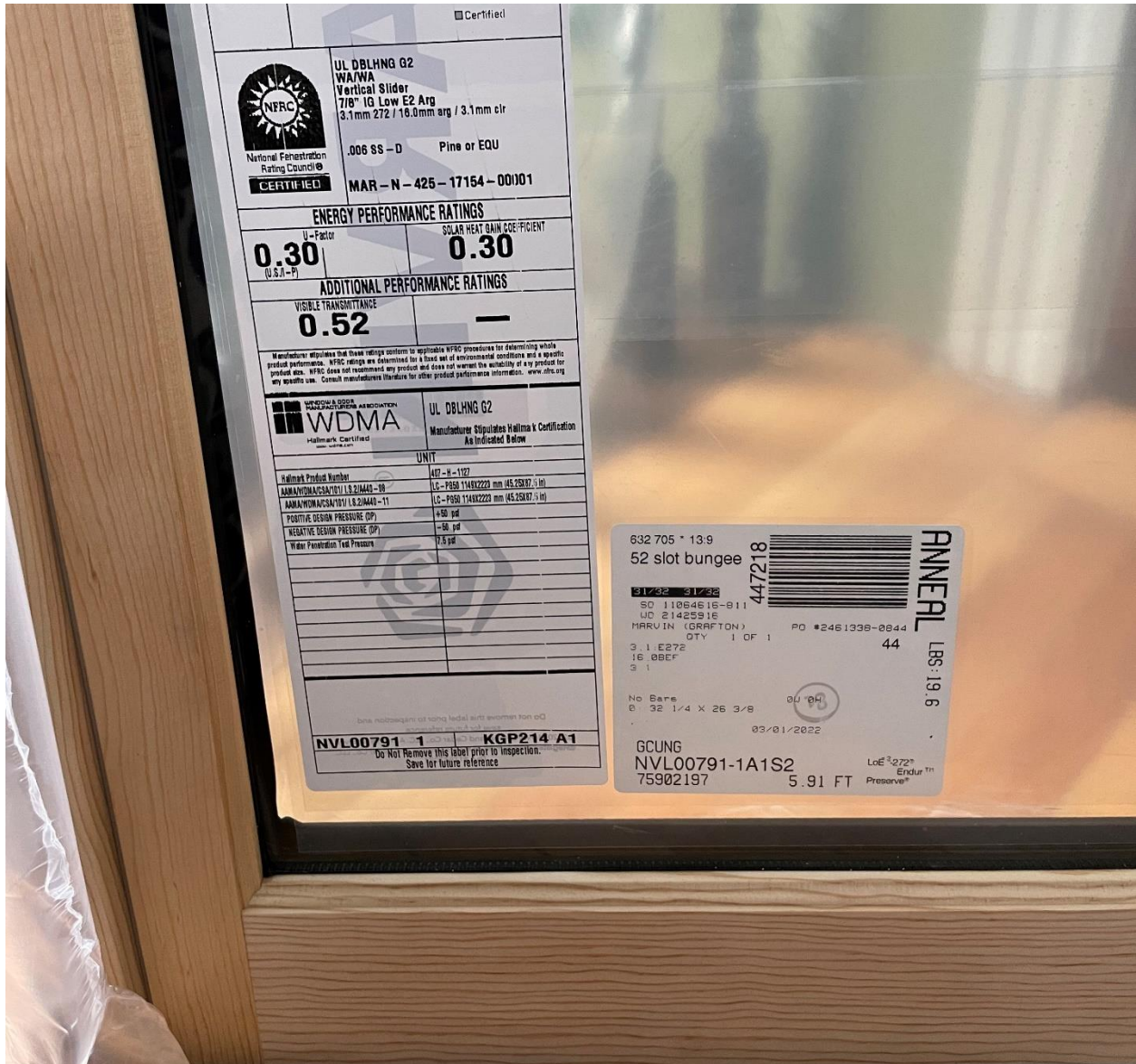

1814-1820 Church, Energy Specs





1814 Church, newly installed, east wall



1820 Church, Current Interior,  
3<sup>rd</sup> floor, NW dormer



## Important Safety Information

### Factory Applied WOCD Ultimate Double Hung G2

#### ATTENTION

INSTALLER: Leave this safety information for the current or future occupant.

*NOTE: This safety information is for Ultimate Double Hung and Single Hung G2 product. When installed and used as directed, the Window Opening Control Device meets the requirements of ASTM F2090-17.*

#### IMPORTANT

When the window opening control device (WOCD) is properly installed and engaged, no space shall exist at the lowest opening portion of the window that would permit the passage of a rigid sphere measuring 4.0 in. (102 mm) in diameter. See Figure 1.

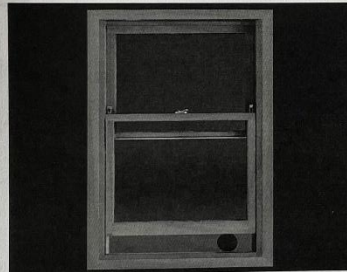

Figure 1

#### WARNING!

##### No Window Rescue Above 75 Feet (6th Floor)

- Fire rescue ladder may not reach beyond 75 feet (6th Floor).
- Do not rely on being rescued from windows above 75 feet (6th Floor). Follow building fire escape plan.

#### WARNING!

##### Blocks Escape in Fire and Emergency Unless Released

- Need to properly operate release mechanism to open the window opening control device by:
- To disengage the window opening control device, push orange dots to depress levers. Both devices on the sash must be depressed to open window for egress. See Figure 2.
- To reset the window opening control device, close the window sash fully. The control device will automatically reset itself once the window sash has been opened past the control device and closed. See Figure 3.
- Never apply padlocks or devices that require a key or tool to unlock them to the release mechanism of the window opening control device(s) (WOCD(s)).

#### WARNING!

##### Possible Fall Hazard

- This window opening control device(s) (WOCD(s)) is designed to protect against accidental operation of windows by children five years and younger.
- This window opening control device(s) (WOCD(s)) is not a substitute for attentive supervision of all young children.
- Keep window opening control device(s) (WOCD(s)) properly engaged unless needed for use in an emergency.

#### WARNING!

##### Possible Fall Hazard

- Young children may fall out of the window if the opening control device (WOCD) is not installed correctly.
- Install the device so that a rigid 4 inch (102mm) diameter sphere does not pass through any space at the lowest opening portion in the window opening after the window opening control device (WOCD) is in place.

MARVIN 

2019-08-26  
19915409

Marvin Brochure



## FEATURES OF THE ULTIMATE WOOD DOUBLE HUNG WINDOW

- Available in heights up to 8 feet or widths up to 4 feet
- Multiple design options and woods available to match historical aesthetics and design requirements
- Also available as a round top, single hung, stationary transom or picture window
- Unique wash mode allows cleaning of both sides of glass from indoors
- Available with IZ3 coastal/hurricane certification
- CE certified

Marvin Brochure



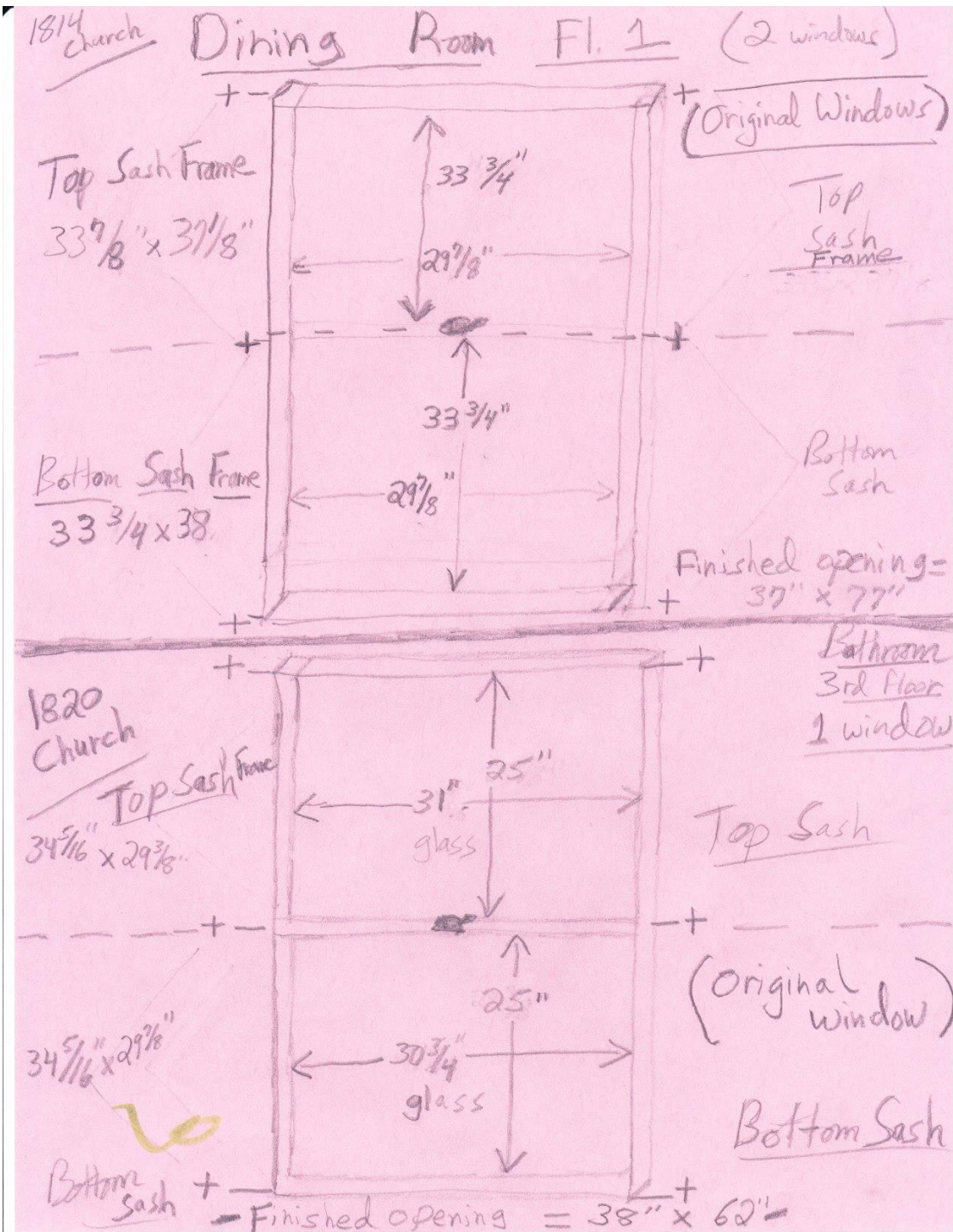

1814-1820 Church Original Dimensions

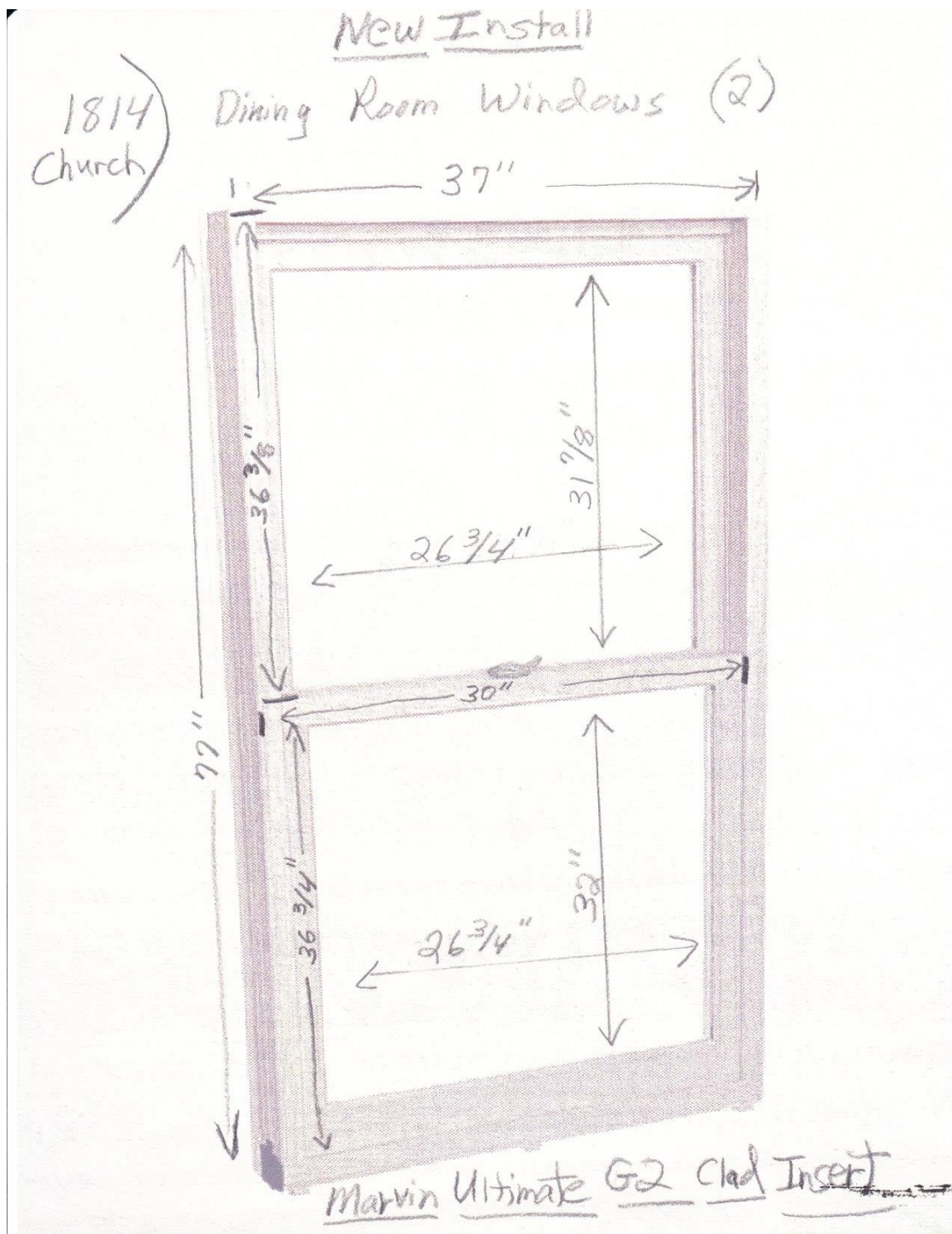

1814 Church, East Wall Replacement  
 Dimensions



New Install  
1820 Church) F13 Bathroom Window (1)

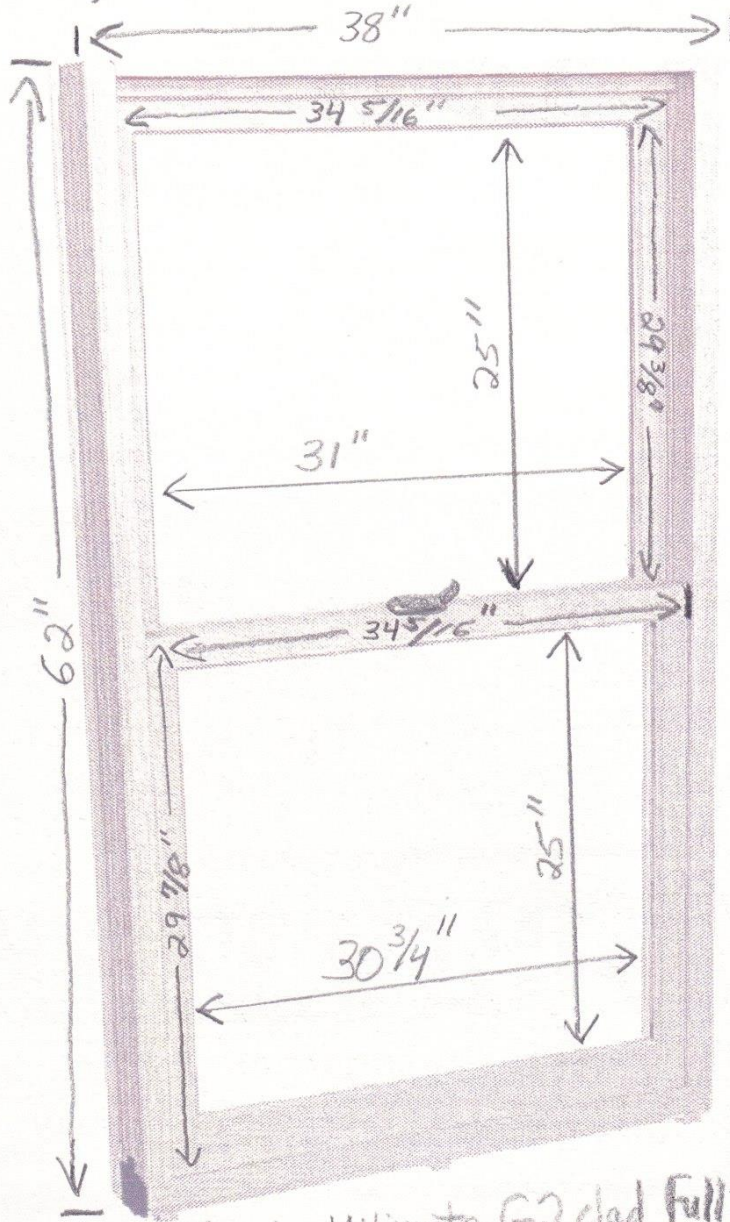

Marvin Ultimate G2 clad Full Frame

1820 Church, Third Floor NW Dormer  
Replacement Dimensions