

**ASSA ABLOY**

D1-1

**1-3/4" REGENT (RI) HONEYCOMB CORE DOORS**

FLUSH AND EMBOSSED PANEL STEEL DOORS  
BEVELED LOCK EDGE, HANDED

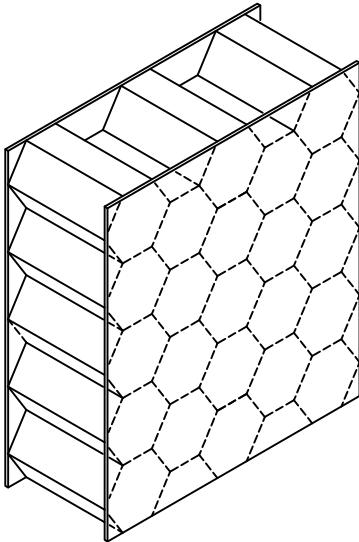

*Kraft fiber honeycomb slab,  
bonded to the inside of both  
face sheets with a water  
resistant, contact adhesive.*

**Suggested Use:**

*Interior or Exterior ...  
Office, Motel/Hotel, Apartment,  
Urban Renewal, Health Care,  
Institutional, Mercantile,  
Public Utility, Factory, or Warehouse.*

**DOOR DESIGNS**

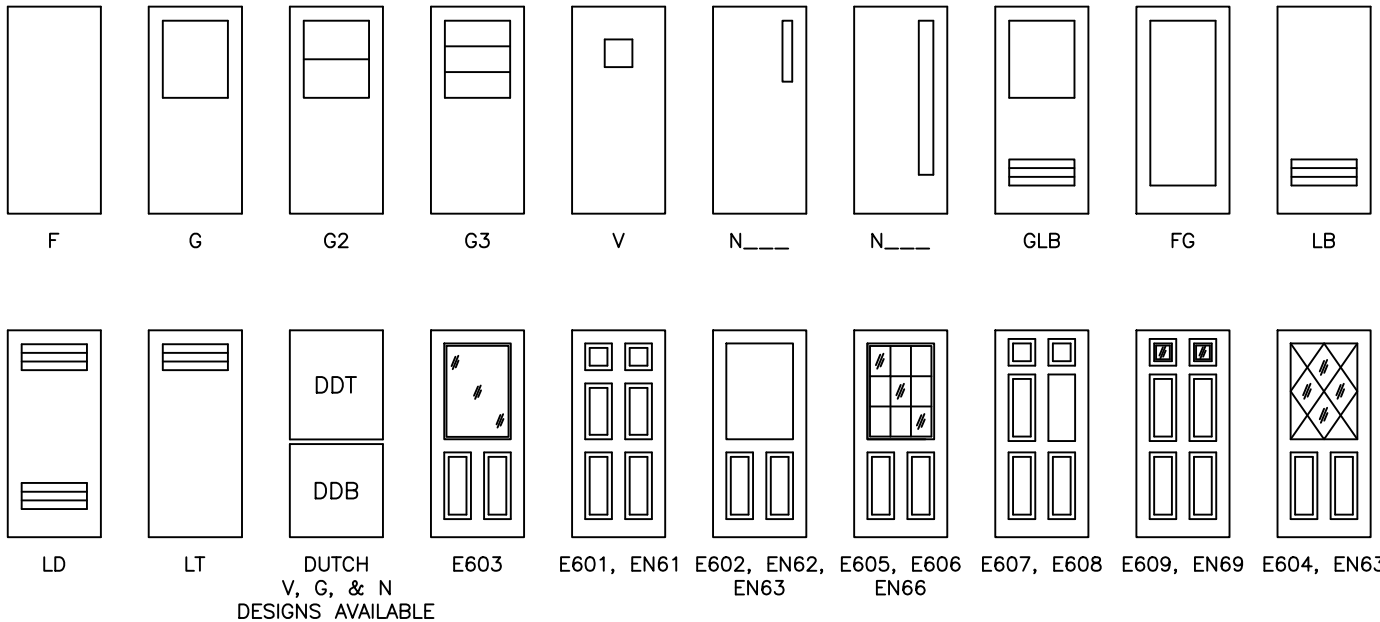

EMBOSSSED 6 PANEL ORDER CODES AND DOOR WIDTHS	
2'6", 2'8" NARROW 6 PANEL	2'8", 3'0" STD. 6 PANEL
EN61	E603
EN62	E601
EN63	E602
EN66	E605
E607	E606
E608	E607
EN69	E608
EN63	E609
E603	E604

6 PANEL	
MAX. SIZE	3'0"x7'0"
MIN. SIZE	2'6"x6'8"

ALL 6 PANEL EMBOSSED DESIGNS WILL  
BE CENTER EDGE SEAM CONSTRUCTION.

07/14/20

D1-2

Hardware locations shown match Ceco standard frames.

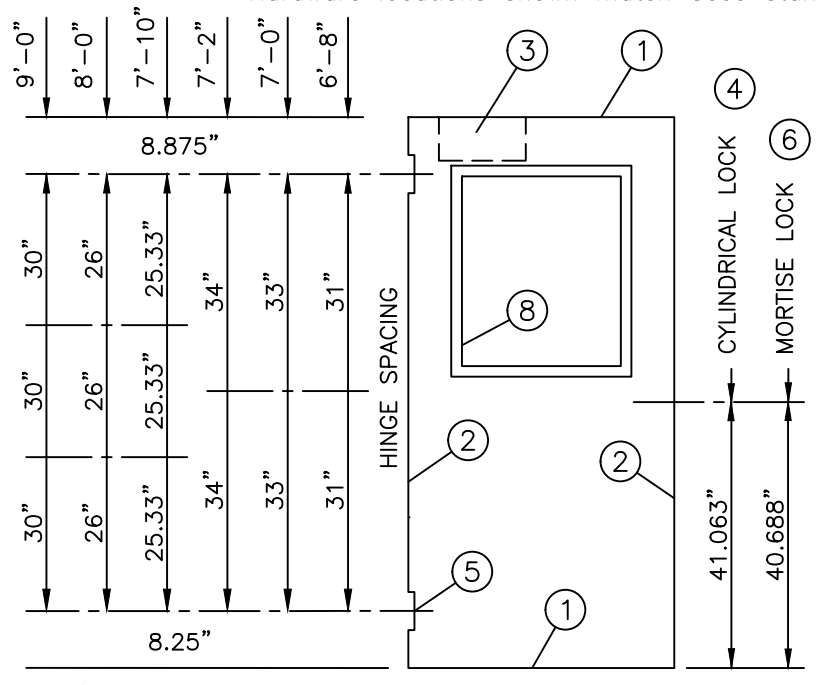

**DOOR ELEVATION**

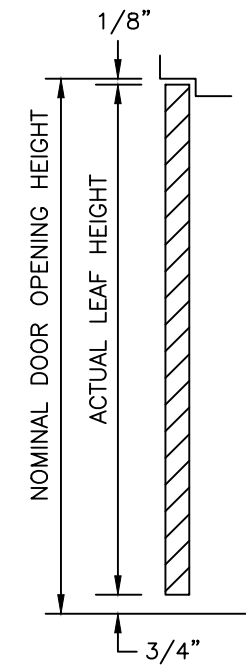

**VERTICAL SECTION**

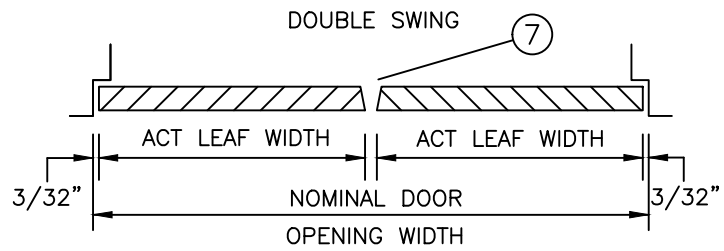
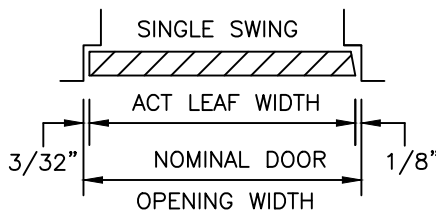

**HORIZONTAL SECTIONS**

(Conversion: 1" = 25.4 mm, e.g., 1-3/4" = 44.45 mm)

OVERLAPPING ASTRAGAL 7 7  
**4441**  
 FOR 1-3/4" THICK  
 DOORS

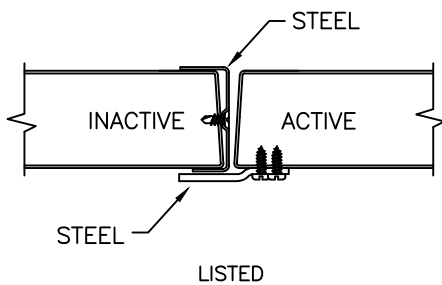

OVERLAPPING ASTRAGAL 7 7  
**4471**  
 FOR 1-3/4" THICK  
 DOORS

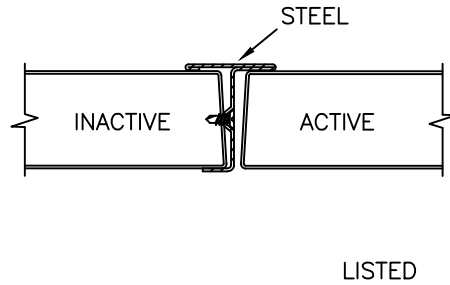

07/13/20

D1-3

### 16 GAGE STEEL END CHANNELS

WELDED  
TO BOTH  
FACE SHEETS

INVERTED  
TOP AND  
BOTTOM

OPTIONAL TOP AND  
BOTTOM CAPS ARE AVAILABLE

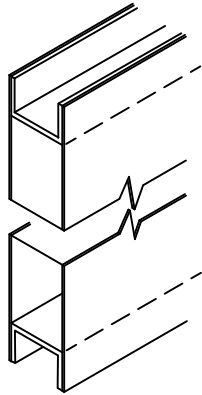

①

### VERTICAL EDGES

MECHANICALLY  
INTERLOCKED  
HEMMED EDGES

14 GAGE DOORS WILL BE  
CENTER EDGE SEAM  
CONSTRUCTION

OPTIONAL:  
SEAMLESS (WELDED  
OR BODY FILLER)

ALL 6 PANEL EMBOSSED DESIGNS  
WILL BE CENTER EDGE SEAM CONSTRUCTION.

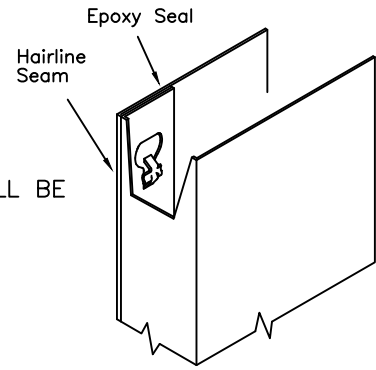

②

### CLOSER REINFORCEMENT (OPTIONAL)

14 GAGE STEEL  
CHANNEL 20" LONG

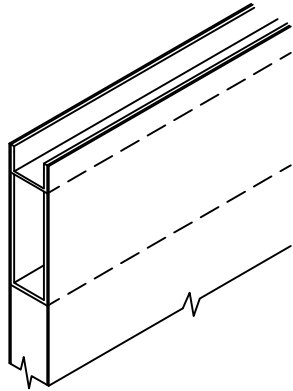

③

### LOCK PREPARATION GOV. 160/161 CYLINDRICAL TYPE

(LC1)  
(ANSI A115.2)  
2-3/4"  
BACKSET

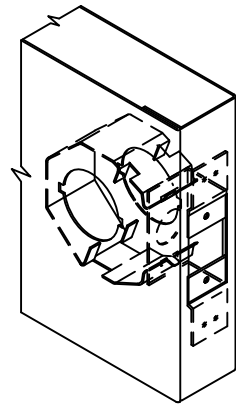

④

### HINGE PREPARATION

4-1/2 OR 5 IN.  
HIGH, STANDARD  
OR HEAVY WEIGHT,  
FULL MORTISE  
HINGES

HINGE EDGE IS HANDED  
AND NOT BEVELED.

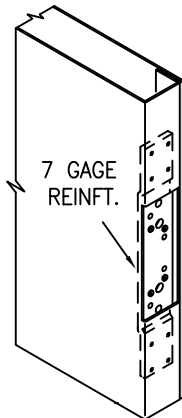

ANSI A156.7  
TEMPLATE

⑤

### LOCK PREPARATION GOV. 86, ANSI/BHMA A115.1 MORTISE TYPE

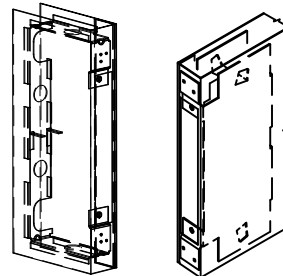

(LMO)

LOCK EDGE IS BEVELED  
1/8" in 2" (1:16)

⑥

NOTE: EITHER OF THE LOCK  
REINFORCEMENTS/  
GUARDS SHOWN MAY  
BE INSTALLED WITH  
ANY MORTISE LOCK  
PREPARATION.

### VERTICAL EDGES

ALL 6 PANEL  
DESIGNS ARE  
CENTER EDGE  
SEAM CONSTRUCTION  
14 GAGE WILL BE  
CENTER EDGE SEAM  
CONSTRUCTION

WELD SEAMLESS AND  
BODY FILLER  
SEAMLESS  
IS OPTIONAL

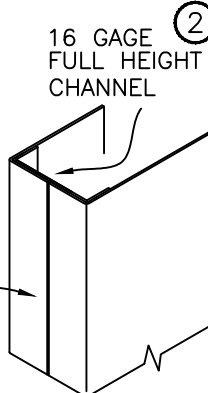

⑦

### GLAZING TRIM SlimTrim

FOR ALL  
FIRE DOORS

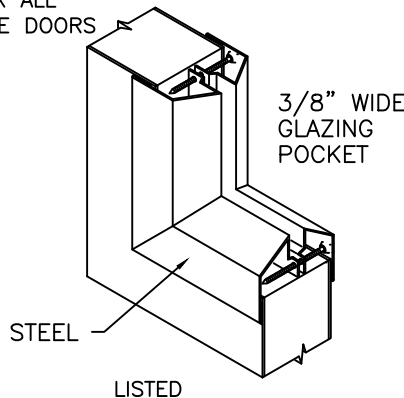

STEEL

LISTED

⑧

### FIXED SLAT TYPE LOUVER 4634

FOR 1-3/4" THICK  
DOORS

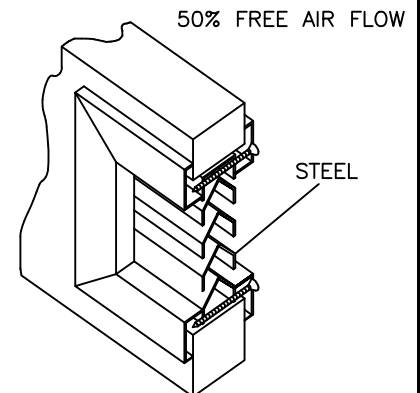

50% FREE AIR FLOW

STEEL

⑨

07/14/20



(Conversion: 1" = 25.4 mm, e.g., 1-3/4" = 44.45 mm)

Experience a safer  
and more open world

D1-4

### STANDARD SIZES NOMINAL DOOR OPENING

WIDTH		HEIGHT
SINGLE	DOUBLE	
2'-0"	4'-0"	
2'-4"	4'-8"	
2'-6"	5'-0"	6'-8"
2'-8"	5'-4"	7'-0"
2'-10"	5'-8"	7'-2"
3'-0"	6'-0"	7'-10"
3'-4"	6'-8"	8'-0"
3'-6"	7'-0"	9'-0"
3'-8"	7'-4"	
3'-10"	7'-8"	
4'-0"	8'-0"	

### FIRE DOORS

#### LABELING AGENCIES:

- UNDERWRITERS LABORATORY
- WARNOCK HERSEY
- FACTORY MUTUAL

TEST: UL10C, UL10B, UL1784,  
& NFPA 252

- RATING: 20 MIN, 3/4 HR, 1 HR, 1-1/2 HR, OR 3 HR
- MAX. SIZE: 4'0" x 9'0" SINGLE  
8'0" x 9'0" PAIR
- DESIGNS: F, FG, G, N, & V

Not all ratings are available  
in all sizes, designs and  
materials.

### PRODUCT SPECIFICATIONS:

1-3/4" Thick steel doors shall be as manufactured by Ceco Door Products. Doors shall conform to the Steel Door Institute guide specification, ANSI A250.8; see chart below for performance classifications.

**REGENT** doors are made full-flush or (optional) seamless style. Face sheets are commercial quality cold rolled steel conforming to ASTM A1008 ...or (optional) hot-dipped galvanized or galvanized steel conforming to ASTM A924 and A653 -- see chart below.

**Regent full-flush doors** have mechanically interlocked, hemmed, hairline seams on vertical edges and have no visible seams on faces. Embossed 6 panel doors will have center edge seam construction. Doors specified "seamless" have no visible seams on faces or vertical edges (S.D.I. Model 2). A one piece, kraft honeycomb core is securely bonded to both face sheets under pressure with contact adhesive. The top and bottom door edges are closed with 16 gage steel channels welded to both face sheets.

**Hardware Provisions:** Hinge preparations are handed. Hinge edges are mortised for 4-1/2" or 5" high, standard and heavy weight hinges (specify which). 7 gage steel hinge reinforcements are welded inside the door edge and are drilled and tapped for fasteners in accordance with ANSI A156.7. The lock edge has a standard bevel (1:16) and is prepared for Gov. series 86, 160/161, or 90 locks in accordance with ANSI A115 (specify which). Optional closer reinforcement is a 14 gage steel channel.

**Paint:** 1-3/4" steel doors shall be provided with one coat of oven-cured neutral color primer paint. Primer coat shall conform with ANSI A250.10. The primer coat is a preparatory base for necessary finish painting. "Colorstyle" finish coat is also available from a selection of standard colors (optional). Colorstyle finish is electrostatically applied, oven-cured urethane enamel, and shall conform to ANSI A250.3. For accurate color selectors ask for a Ceco Colorstyle chart.

### MATERIAL

DOOR FACE SHEETS	LEVEL	C.R.	GALV		RECOMMENDED DOOR FRAME MATERIAL
			A60	G90	
20 Gage Steel (4080 max.)	Standard Duty	N/A	STD	N/A	16 Gage Steel
18 Gage Steel	Heavy Duty	STD	OPT	OPT	16 Gage Steel
16 Gage Steel	Extra Heavy Duty	STD	OPT	OPT	16 or 14 Gage Steel
14 Gage Steel	Maximum Duty	STD	OPT	OPT	14 or 12 Gage Steel

### PERFORMANCE

Sound Transmission Class:	STC 32 (F Design, 18 Gage Face Sheets, ASTM E90 & E413 [Fully Operable])
Physical Endurance /Level:	Meets ANSI A250.4 Performance Test, 20 GAGE: Level B (500,000 Cycles); 18 and 16 Gage: Level A (1,000,000 Cycles)

(Conversion: 1" = 25.4 mm, e.g., 1-3/4" = 44.45 mm)



07/13/20