

# ZONING MAP

WOODWARD AVENUE

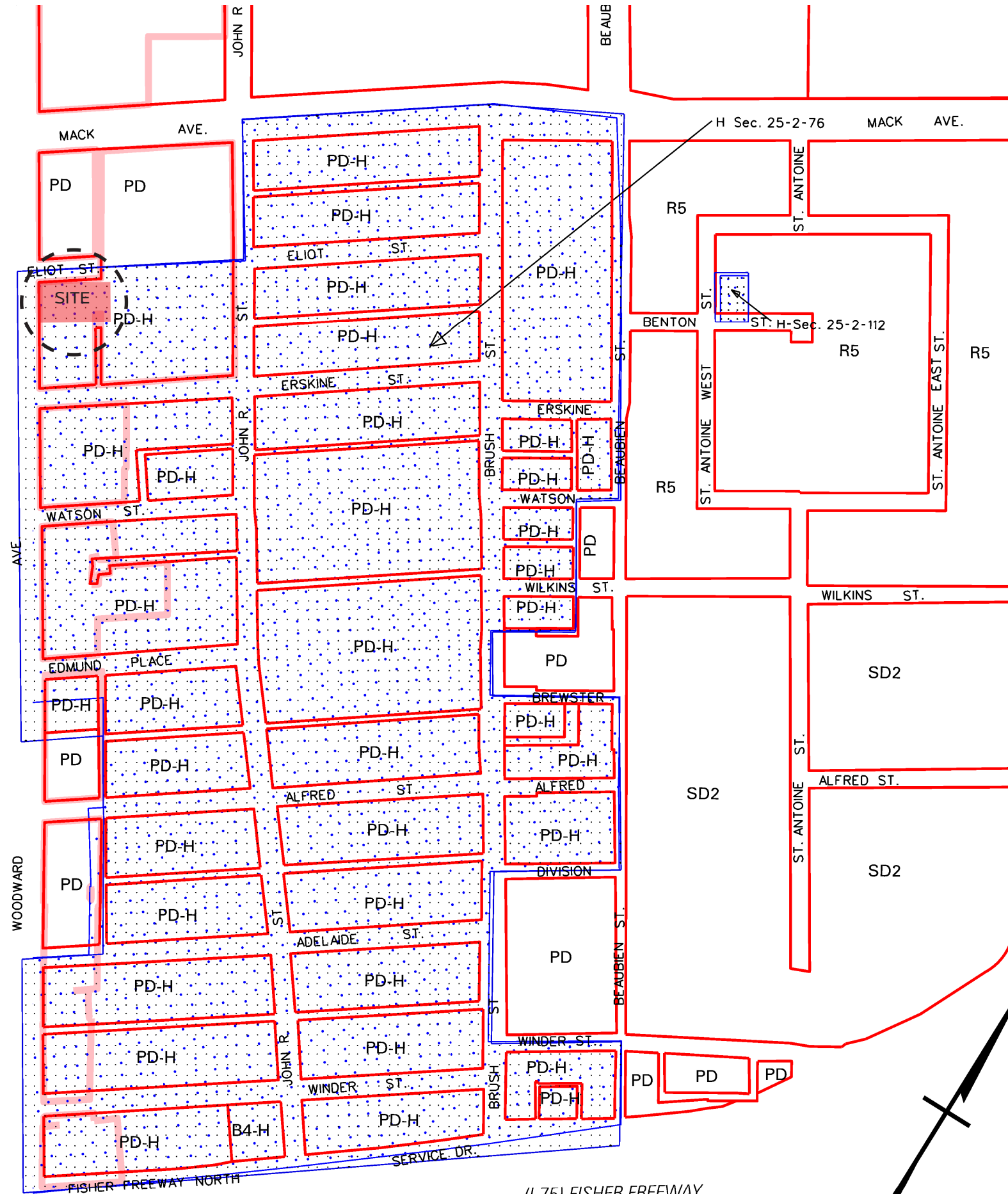

(I-75) FISHER FREEWAY

SITE AERIAL



EXISTING CONDITIONS



VIEW LOOKING SOUTH



VIEW LOOKING EAST

EXISTING CONDITIONS

STAIR TO BE REMOVED AND REPLACED



BRICK FACADE TO BE CLEANED

HISTORIC LIMESTONE FACADE

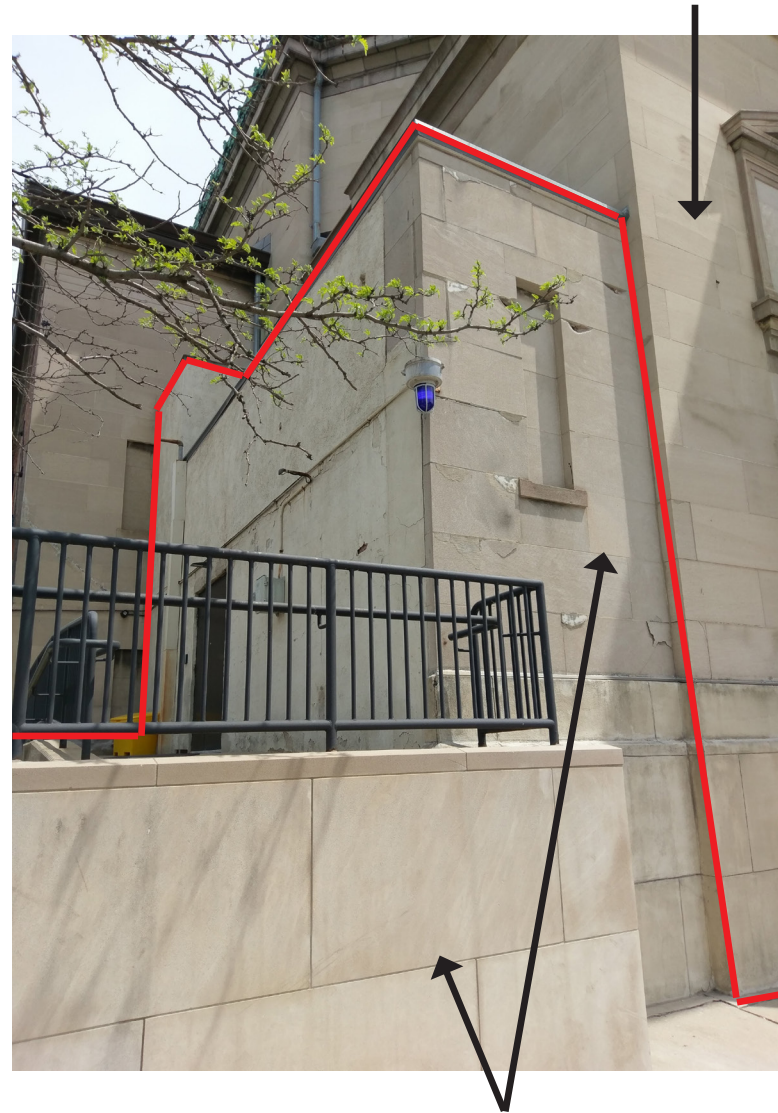

ACCESS RAMP TO BE DEMOLISHED. LATER ADDITION TO BE INTEGRATED INTO NEW ENTRY



RAMP TO BE REMOVED AND REPLACED BY LIFT



Schematic Design - West Elevation



Permit Set - West Elevation