



**Note Key**

1. Scored Concrete Paving with Paver Inlay and Border
2. Pavers
3. Concrete Paving
4. Existing Sidewalk to Remain
5. Asphalt Parking Lot and Drive Aisle
6. 4" Depth Decomposed Granite
7. 4" Depth Crushed Aggregate Mulch
8. 4'-0" Ht. Ornamental Aluminum Fence
9. Ornamental Aluminum Gate
10. 12" Ht. X 6" Wide Concrete Planter Curb
11. 18" Ht. Ornamental Aluminum Garden Fence
12. 6'-0" Ht. Ornamental Aluminum Fence
13. Tot Lot Playground - Surface to Be 12" Depth Engineered Wood Mulch
14. 8'-0" ht. Masonry Screen Wall
15. Dumpster
16. Existing Building Porch
17. Barrier Free Porch Lift
18. Bike Rack
19. 6'-0" Ht. Ornamental Aluminum Fence with 1.5" Picket Spacing

INTERNATIONAL TRANSMISSION  
CO. HIGH VOLTAGE  
CABLE IN HIGH PRESSURE  
GAS FILLED PIPE (R) NOTE:  
DRAWINGS ARE SCHEMATIC  
LOCATION IS APPROXIMATE

**PRELIMINARY DOCUMENT - NOT FOR CONSTRUCTION**



Issued for \_\_\_\_\_

**11.20.2020 HISTORIC DISTRICT COMMISSION**

Drawn	<input checked="" type="checkbox"/> Preliminary
AEP	<input type="checkbox"/> Construction
Checked	<input type="checkbox"/> Record
RKM	
Approved	<b>Do not scale</b>
RKM	Use figured dimensions only
Bitpak Number	

Job Number  
**2020078**  
Title  
**Rendered Landscape Plan**

Sheet  
**L100**

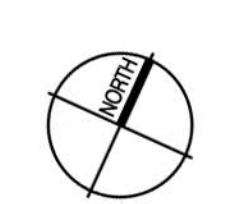
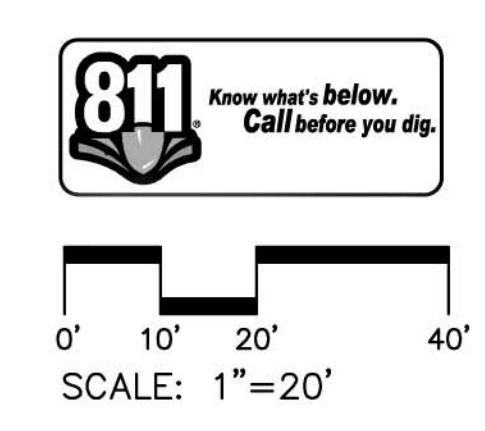

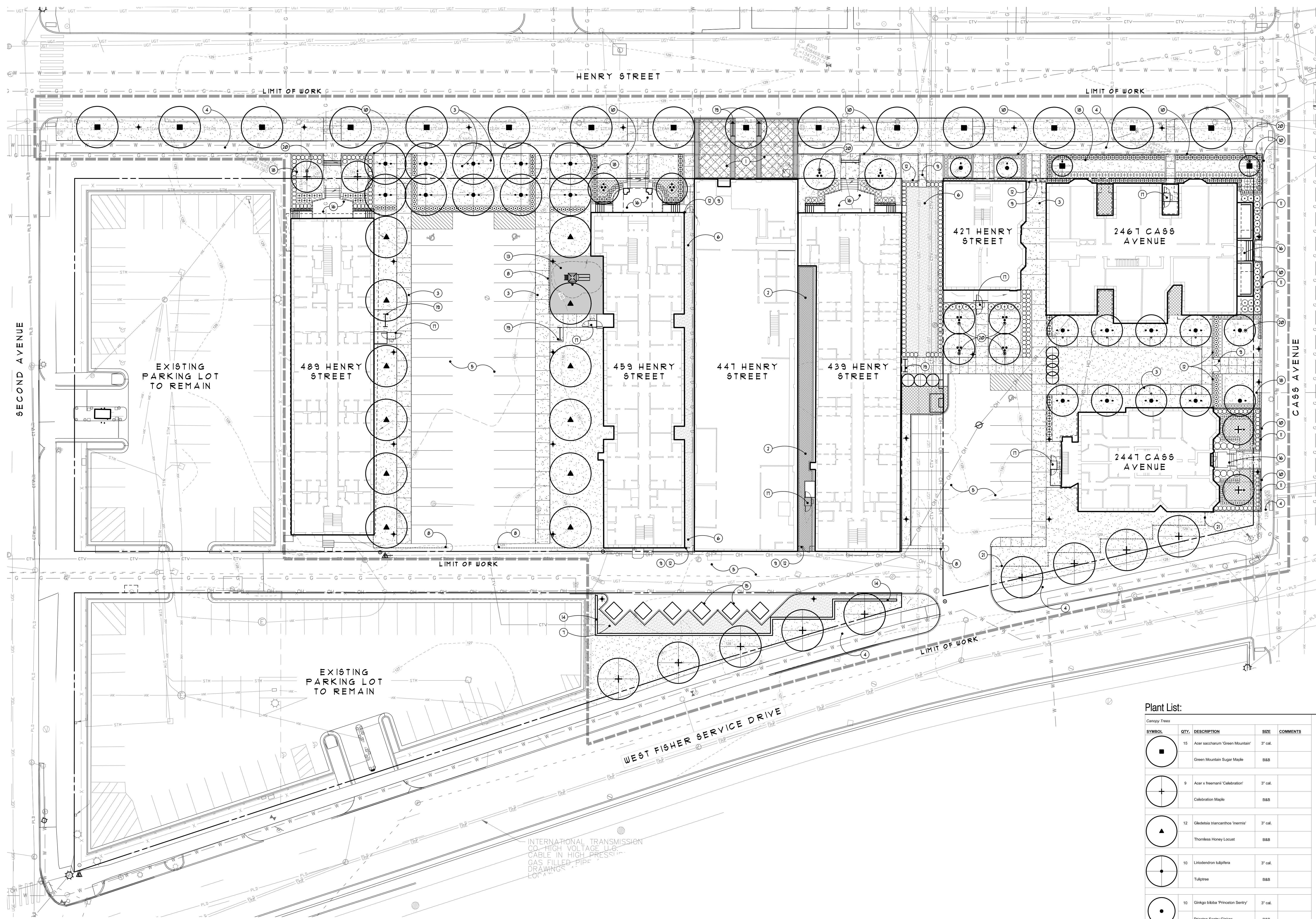

- Legend:**
- LIMIT OF WORK
  - W WATER MAIN
  - G GAS LINE
  - OH OVERHEAD ELECTRIC WIRE
  - SD STORY DRAIN
  - + PEDESTRIAN LIGHT POLE - REFER TO SITE ELECTRICAL DRAWINGS
  - ⊙ EXISTING COBRA HEAD STREET LIGHTS TO REMAIN
  - IRRIGATED BODDED LAWN
  - RIGHT OF WAY
- Note Key:**
- 1 SCORED CONCRETE PAVING WITH PAVER INLAY AND BORDER
  - 2 PAVERS
  - 3 CONCRETE PAVING - REFER TO CIVIL PLANS
  - 4 EXISTING SIDEWALK TO REMAIN
  - 5 ASPHALT PARKING LOT AND DRIVE AILE - REFER TO CIVIL PLANS
  - 6 4" DEPTH DECOMPOSED GRANITE
  - 7 4" DEPTH CRUSHED AGGREGATE MULCH
  - 8 4"-0" HT. ORNAMENTAL ALUMINUM FENCE - REFER TO DETAIL ON SHEET L201
  - 9 ORNAMENTAL ALUMINUM GATE
  - 10 2" HT. x 6" WIDE CONCRETE PLANTER CURB
  - 11 30" HT. ORNAMENTAL ALUMINUM GARDEN FENCE - REFER TO DETAIL ON SHEET L201
  - 12 6"-0" HT. ORNAMENTAL ALUMINUM FENCE WITH 3/4" PICKET SPACING - REFER TO DETAIL ON SHEET L201
  - 13 TOT LOT PLAYGROUND - SURFACE TO BE 12" DEPTH ENGINEERED WOOD MULCH
  - 14 MASONRY SCREEN WALL - REFER TO DETAIL ON SHEET L201
  - 15 DUMPSTER, TYP.
  - 16 EXISTING BUILDING PORCH - REFER TO ARCHITECTURAL DRAWINGS
  - 17 BARRIER FREE PORCH LIFT - REFER TO ARCHITECTURAL DRAWINGS
  - 18 STEEL EDGING BETWEEN LAWN AND PLANT BEDS, TYP.
  - 19 BIKE RACK
  - 20 TREE UPLIGHT, TYP.
  - 21 6"-0" HT. ORNAMENTAL ALUMINUM FENCE WITH 1/2" PICKET SPACING - REFER TO DETAIL ON SHEET L201

- General Notes:**
- 1 PROVIDE 4" DEPTH TOPSOIL AT ALL BODDED LAWN AREAS
  - 2 PROVIDE SHREDDED BARK MULCH AT ALL PLANT BEDS PER DETAILS
  - 3 REFER TO TYPICAL PLANTING DETAILS, SHEET L201
  - 4 IRRIGATION SYSTEM IS TO BE PROVIDED FOR ALL PLANTING BEDS AND LAWN AREAS.

**Plant List:**

SYMBOL	QTY.	DESCRIPTION	SIZE	COMMENTS
■	15	Acer saccharum 'Green Mountain'	3" cal.	
●		Green Mountain Sugar Maple	B&B	
+	9	Acer x freemari 'Celebration'	3" cal.	
○		Celebration Maple	B&B	
▲	12	Gleditsia triacanthos 'nervis'	3" cal.	
●		Thornless Honey Locust	B&B	
●	10	Liquidambar styraciflua	3" cal.	
●		Tulipree	B&B	
●	10	Ginkgo biloba 'Princeton Sentry'	3" cal.	
●		Princeton Sentry Ginkgo	B&B	
+	2	Mikus 'Royal Raindrops'	3" cal.	
●		Royal Raindrops Crabapple	B&B	
●	2	Cercis canadensis	10" ht.	multi-stem
●		Eastern Redbud	B&B	3 trunk min.
+	4	Magnolia soulangeana	10" ht.	multi-stem
●		Saucer Magnolia	B&B	3 trunk min.
+	2	Cornus florida	10" ht.	multi-stem
●		Flowering Dogwood	B&B	3 trunk min.
+	2	Prunus serotina 'Wenzelii'	3" cal.	
●		Kwanan Cherry	B&B	
●	2	Carpinus betulus 'Frans Fontaine'	3" cal.	
●		Franc Fontaine Hornbeam	B&B	
+	2	Mikus 'Prairiefire'	2.5' cal.	tree form
●		Prairie Fire Crabapple	B&B	
+	7	Quercus x water 'Nutter'	3" cal.	
●		Knotted Spill Oak	B&B	

SYMBOL	QTY.	DESCRIPTION	SIZE	COMMENTS
○	88	Buxus 'Green Mountain'	18" ht. min.	Plant 18" o.c.
●		Green Mountain Boxwood	B&B	
⊕	140	Ilex glabra 'Shamrock'	24" ht. min.	Plant 24" o.c.
●		Isleberry	B&B	
○	10	Ilex x meserioides 'Blue Prince'	30" ht. min.	Plant 30" o.c.
●		Blue Prince Holly	B&B	
⊗	14	Rhododendron 'Dorchester Valley'	30" ht. min.	Plant 30" o.c.
●		Dorchester Valley Azalea	B&B	
○	213	Taxus x media 'Densiformis'	24" ht. min.	Plant 24" o.c.
●		Dense Yew	B&B	
○	86	Taxus x media 'Nicksal'	30" ht. min.	Plant 24" o.c.
●		Nicksal Yew	B&B	
⊕	12	Thuja occidentalis 'Emerald Green'	6" ht.	Plant 30" o.c.
●		Emerald Green Arborvitae	B&B	Hedge to 5' ht.
<b>Deciduous Shrubs, Groundcover, and Perennials</b>				
SYMBOL	QTY.	DESCRIPTION	SIZE	COMMENTS
⊕	49	Ilex verticillata 'Henry's Garnet'	#3	Plant 24" o.c.
●		Virginia Sweetgum	cont.	
⊕	35	Hydrangea macrophylla 'Pae Wae'	#5	Plant 30" o.c.
●		Pae Wae Oakleaf Hydrangea	cont.	
⊕	16	Hydrangea paniculata 'Tumbo'	#5	Plant 30" o.c.
●		Bobo Hydrangea	cont.	
○	21	Syringa patula 'Miss Kim'	#5	Plant 30" o.c.
●		Miss Kim Lilac	cont.	
○	10	Illegals florida 'Sonic Bloom'	#5	Plant 30" o.c.
●		Sonic Bloom Weigela	cont.	
○	21	Hosta x Patriot	1 gal.	Plant 18" o.c.
●		Planet Hosta	cont.	
1100		Pachysandra terminalis	1 gal.	Plant 12" o.c.
		Japanese pachysandra	cont.	

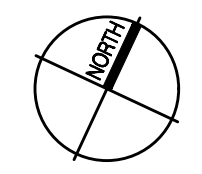
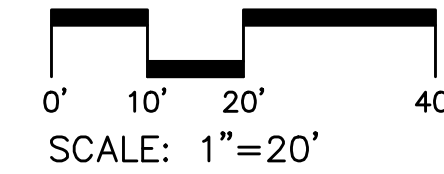

**architecture**  
**NEUMANN SMITH**  
SOUTHFIELD • DETROIT  
400 Galleria Office Centre  
Suite 555  
Southfield, Michigan 48034  
phone 248.352.8310  
fax 248.352.1821  
www.neumannsmith.com

**GRISSIM METZ ANDRIESE**  
Associates  
Landscape Architects

**OLYMPIA DEVELOPMENT OF MICHIGAN**

**HENRY STREET REDEVELOPMENT**

**PRELIMINARY DOCUMENT - NOT FOR CONSTRUCTION**

Issued for:   
Alyson K. Hanson

11.20.2020 HISTORIC DISTRICT COMMISSION

Drawn:  Preliminary  
 AEP  Construction  
 Checked:  Record  
**RKM**  
 Approved:  Do not scale  
**RKM** Use figured dimensions only  
 Bidpak Number

Job Number: 2020078  
Title: Landscape Plan

Sheet: L101

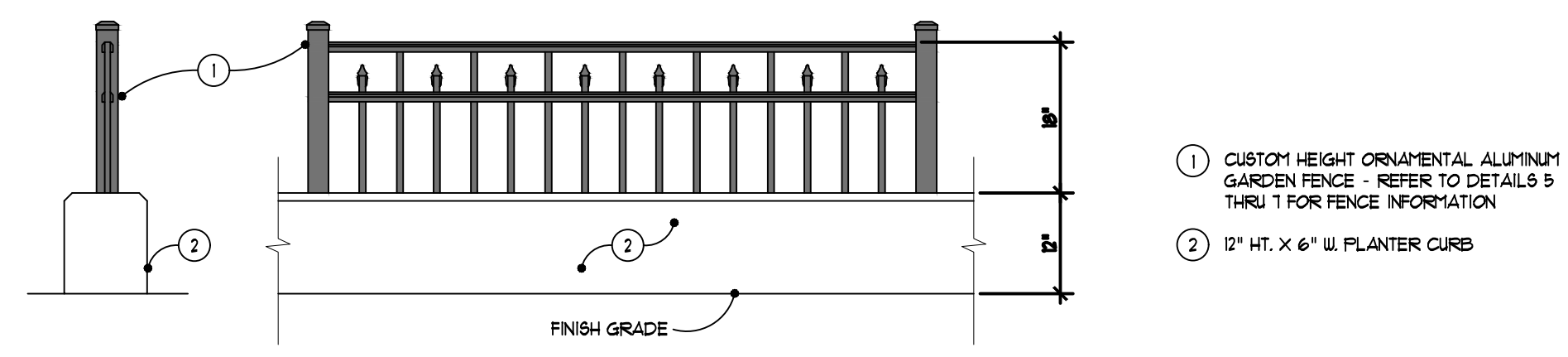

**8** 18' ht. Ornamental Garden Fence  
 NOT TO SCALE

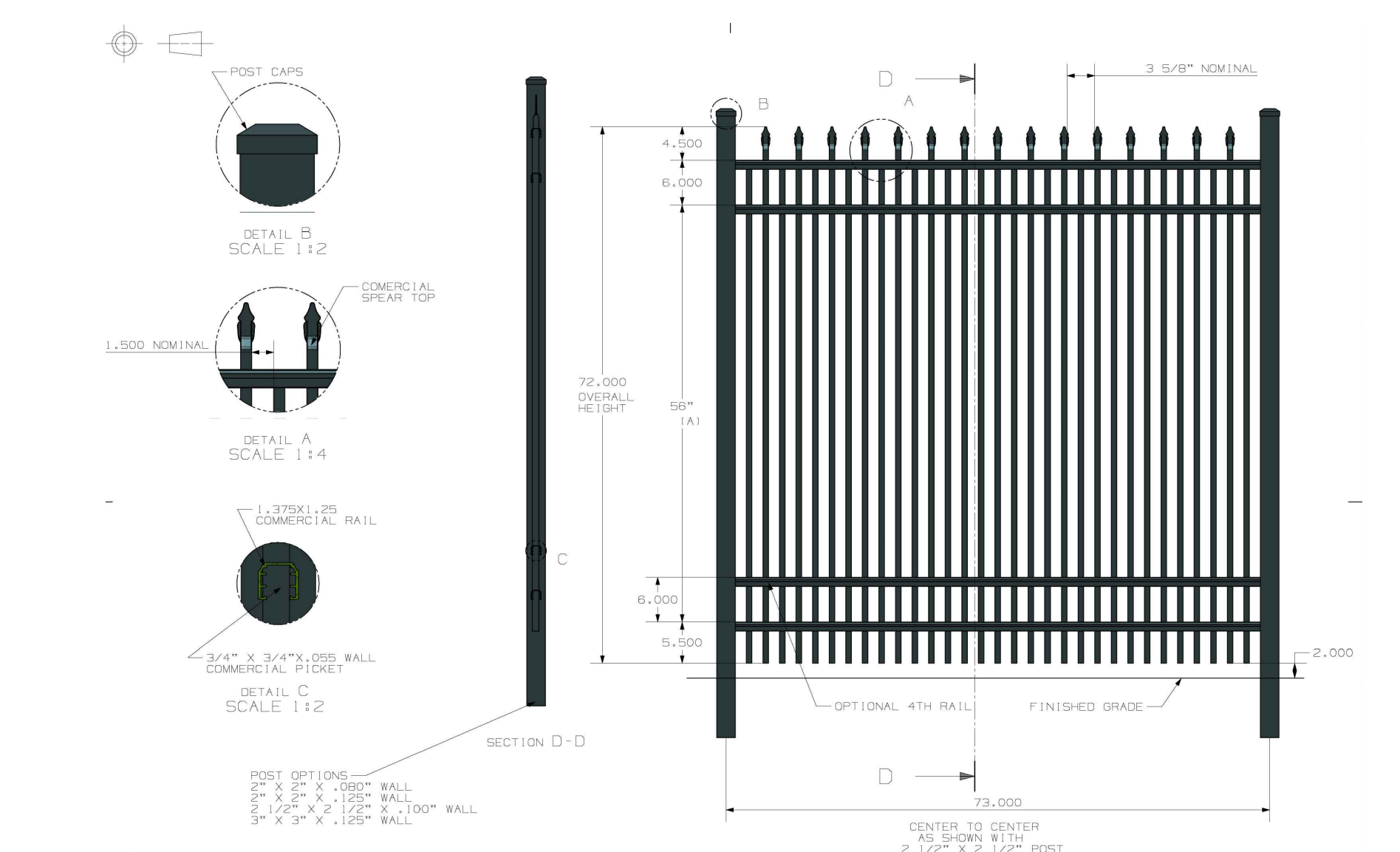

**7** 6'-0" ht. Ornamental Fence with 1.5" Picket Spacing Detail  
 NOT TO SCALE

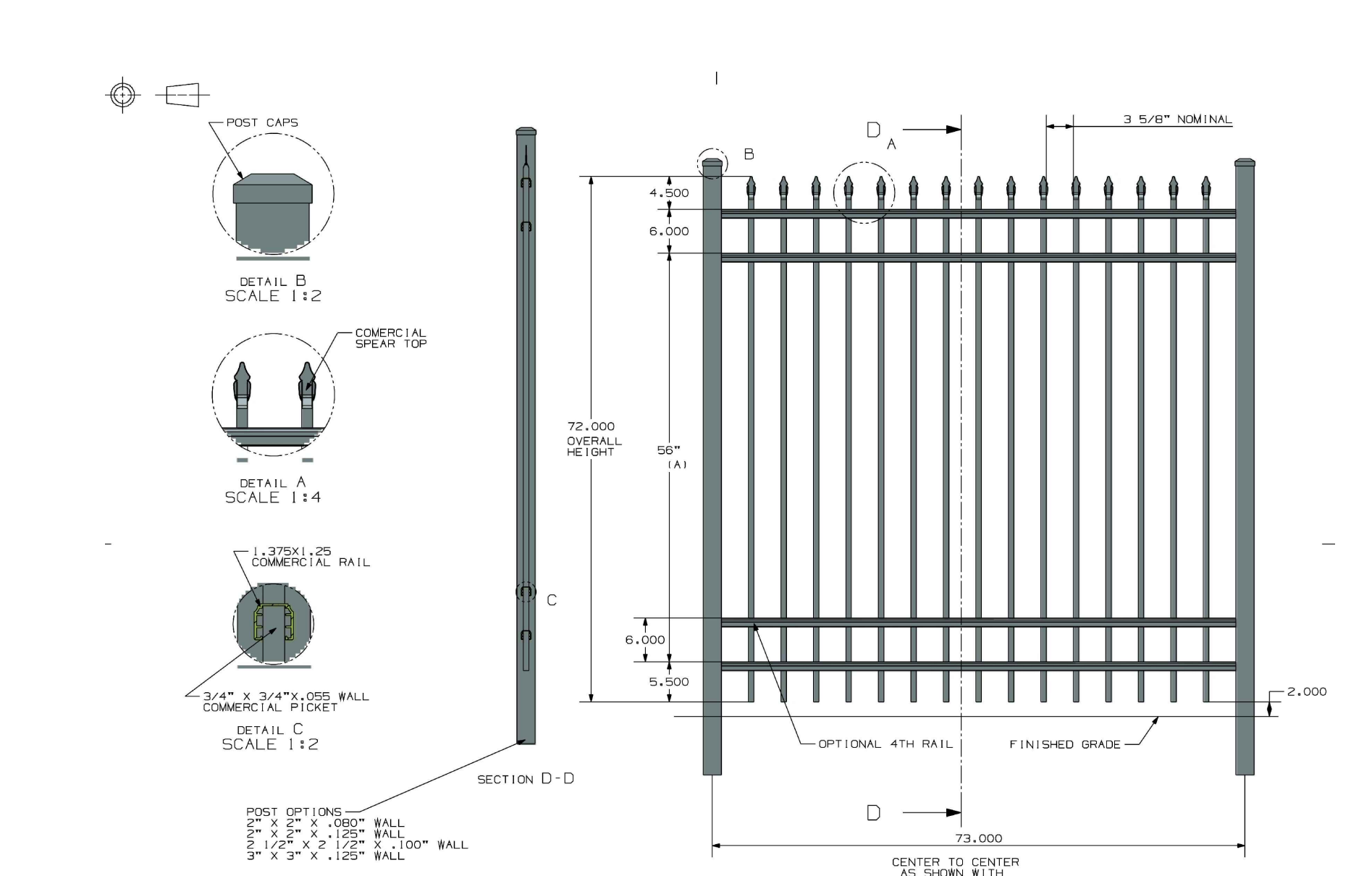

**6** 6'-0" ht. Ornamental Fence Detail  
 NOT TO SCALE

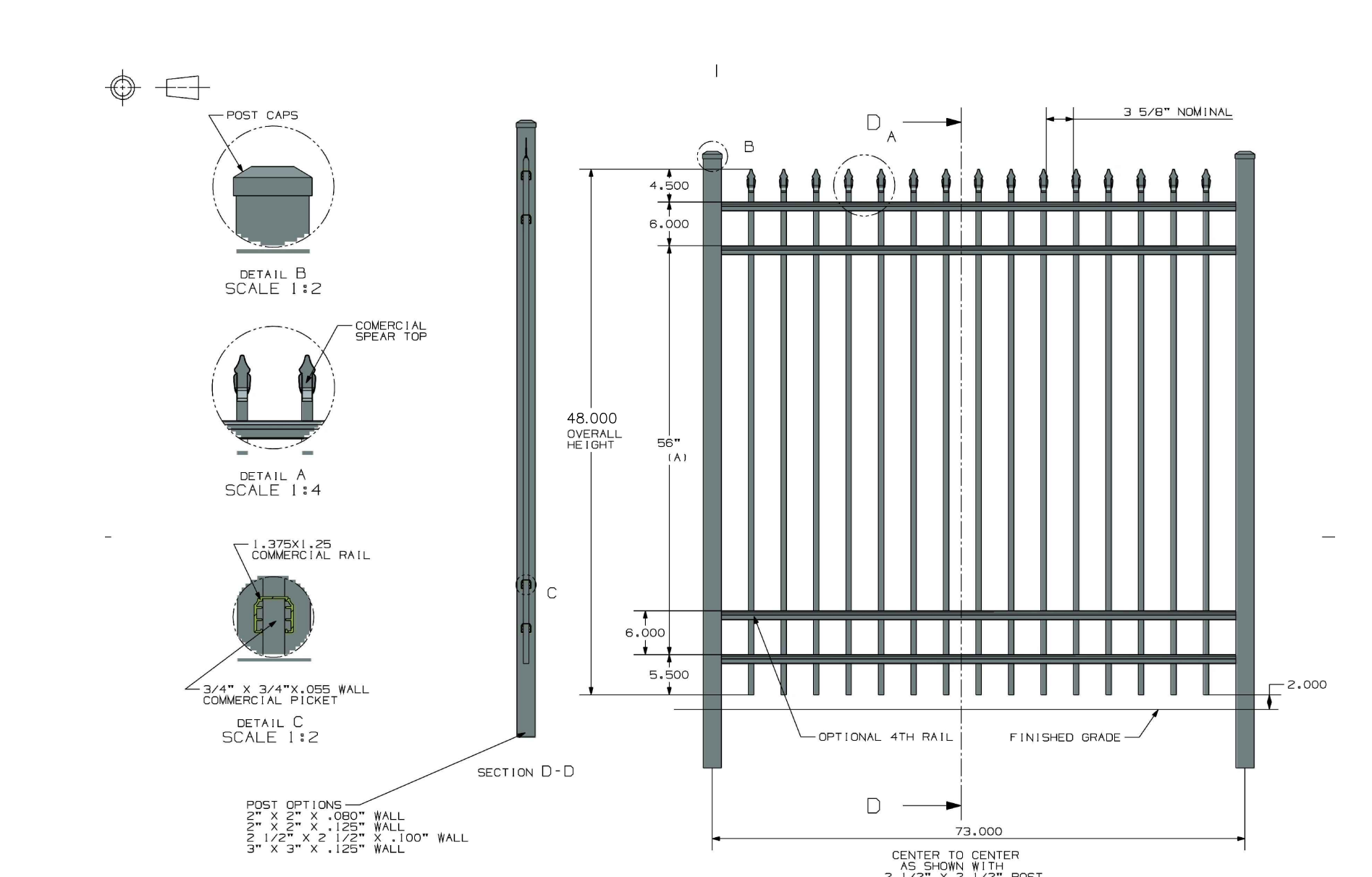

**5** 4'-0" ht. Ornamental Fence Detail  
 NOT TO SCALE

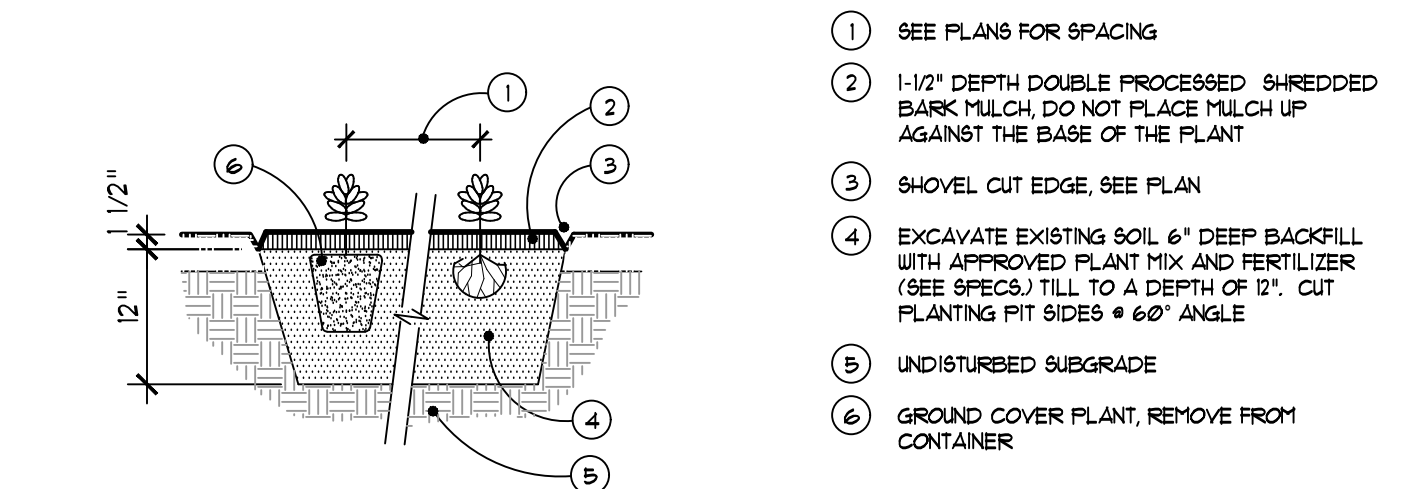

**4** Typical Perennial / Groundcover Planting Detail  
 NOT TO SCALE

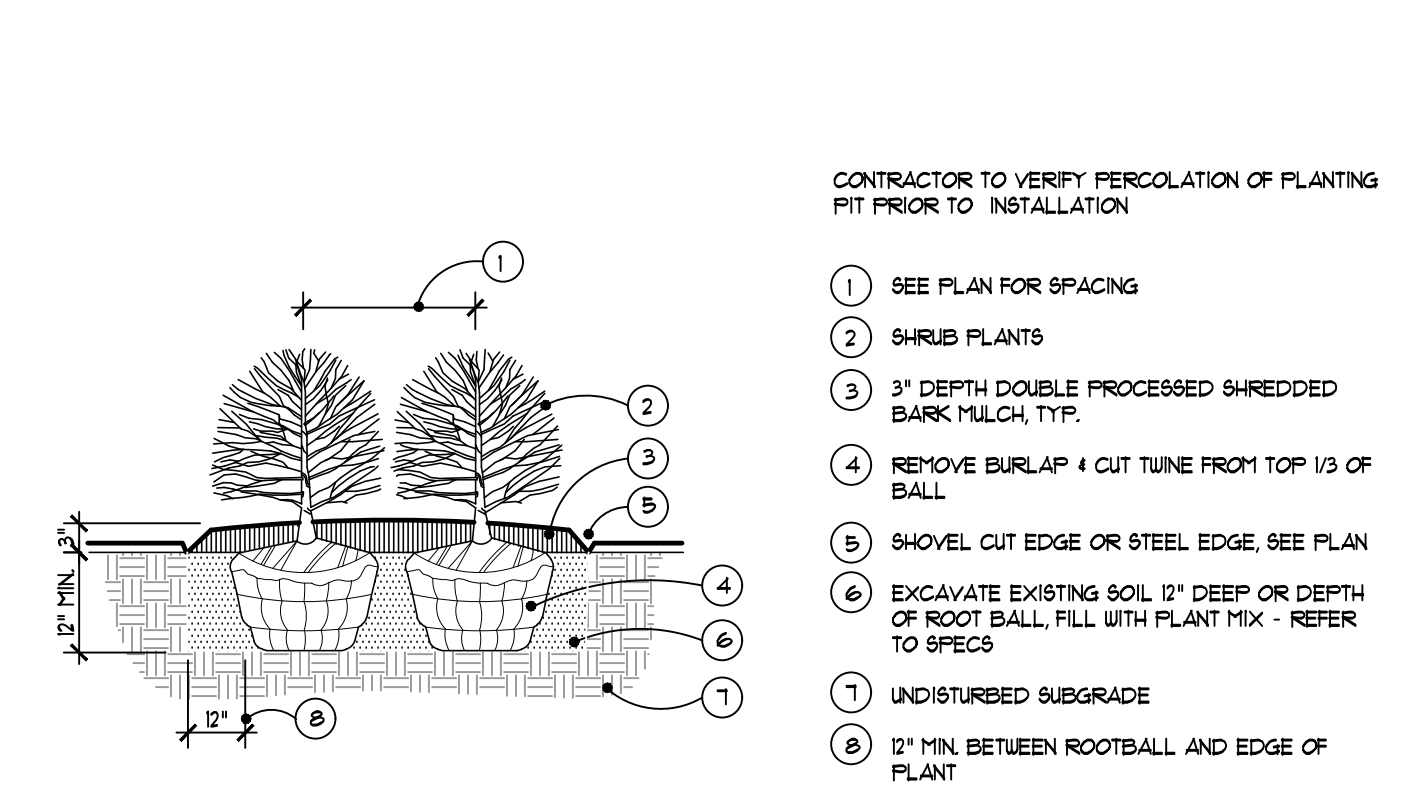

**3** Typical Shrub Planting Detail  
 NOT TO SCALE

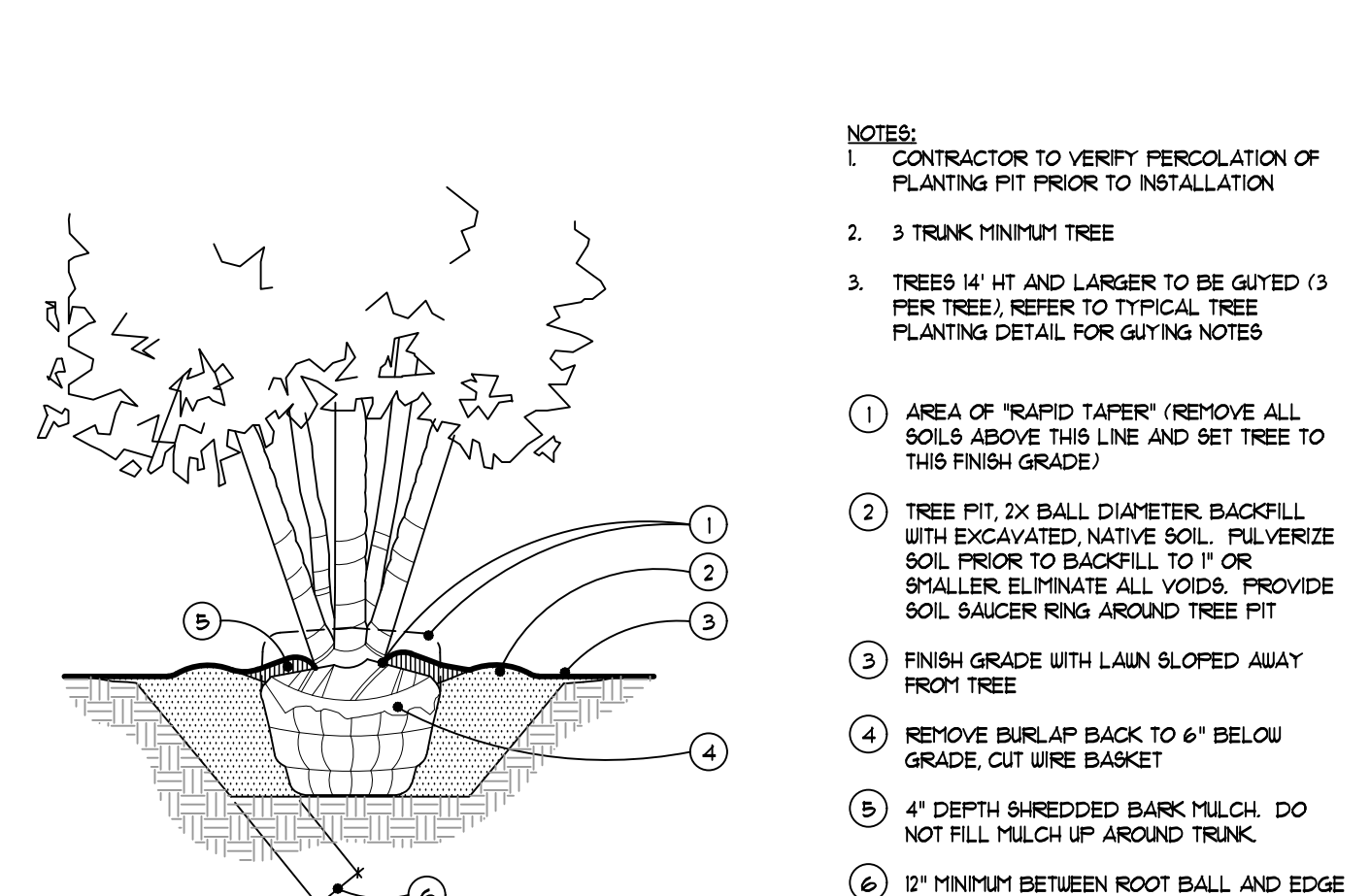

**2** Typical Multi-Stem Tree Planting Detail  
 NOT TO SCALE

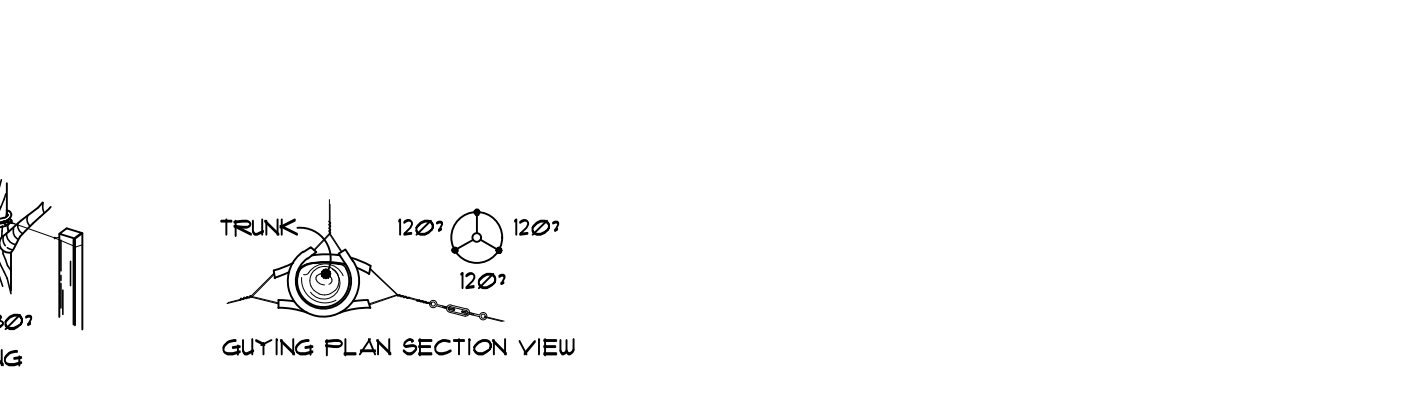

**1** Typical Deciduous Tree Planting Detail  
 NOT TO SCALE

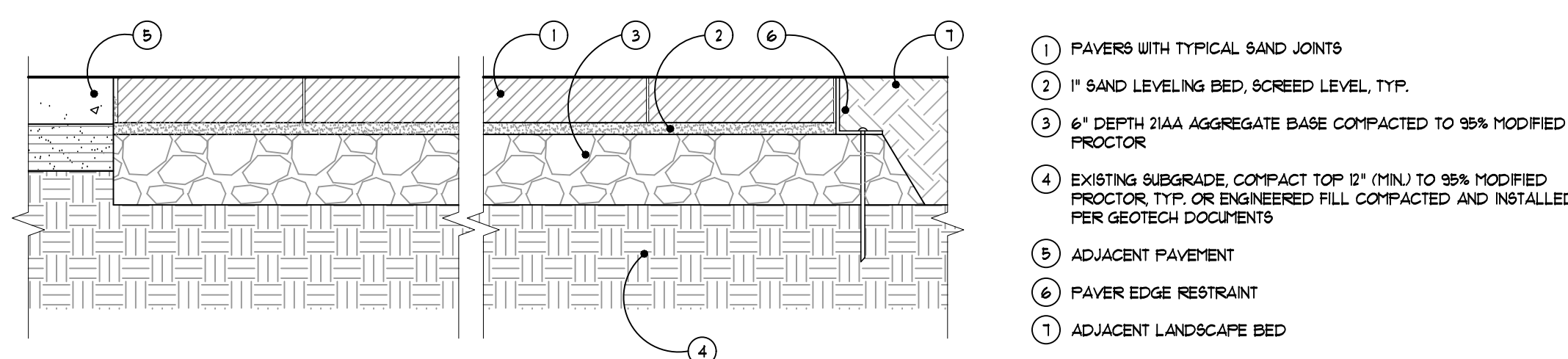

**10** Typical Pedestrian Paver Detail  
 NOT TO SCALE

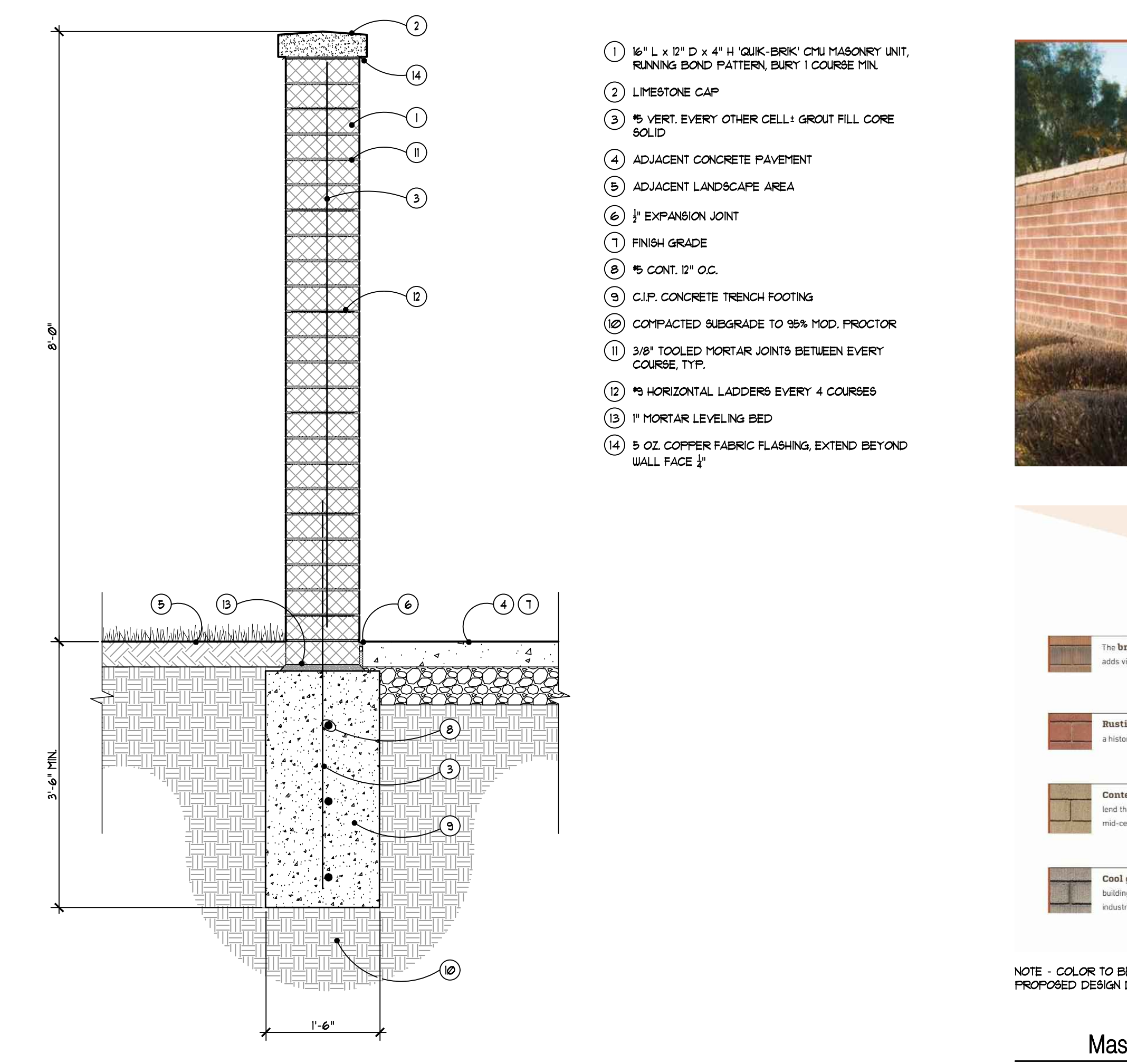

**9** Masonry Screen Wall Detail  
 NOT TO SCALE

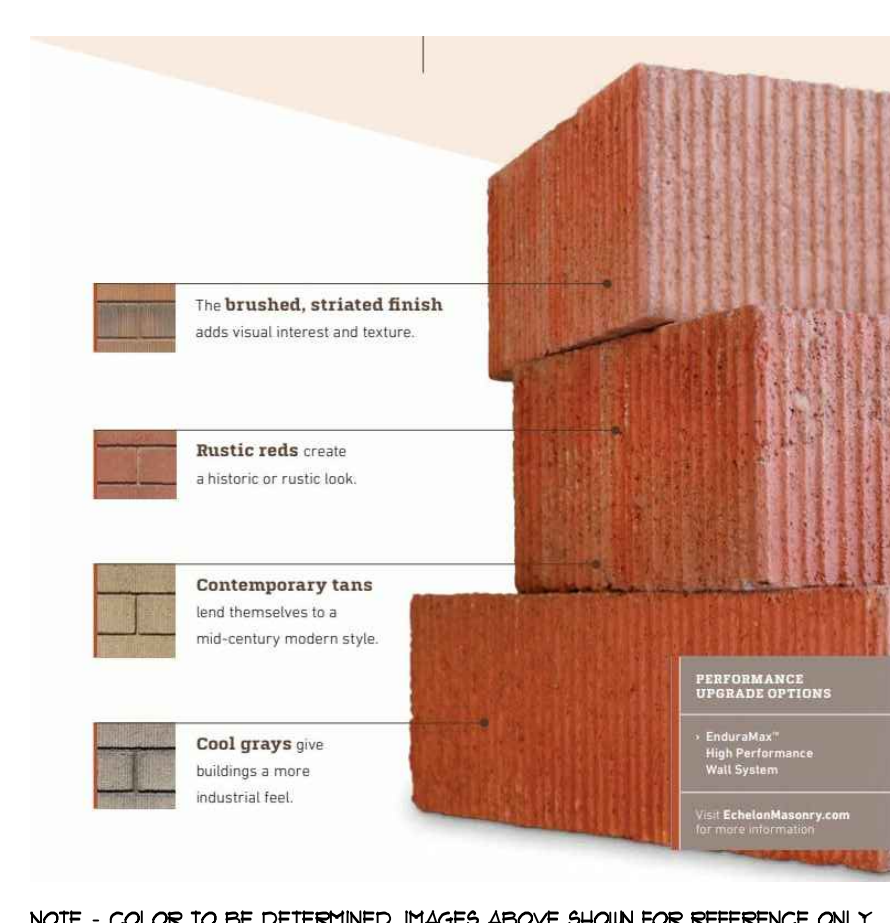

Masonry Block Precedent Images

- NOTES:
1. ALL PLANTING ENTIRE BED SHALL BE EXCAVATED
  2. CONTRACTOR TO VERIFY PERCOLATION OF PLANTING PIT PRIOR TO INSTALLATION AND PROVIDE RESULTS TO LANDSCAPE ARCHITECT FOR APPROVAL.
  3. SEE PLANS FOR SPACING
  4. 1 1/2" DEPTH DOUBLE PROCESSED SHREDDED BARK MULCH, DO NOT PLACE MULCH UP AGAINST THE BASE OF THE PLANT
  5. SHOVEL CUT EDGE, SEE PLAN
  6. EXCAVATE EXISTING SOIL 6" DEEP BACKFILL WITH APPROVED PLANT MIX AND FERTILIZER (SEE SPECS), FILL TO A DEPTH OF 2". CUT PLANTING PIT SIDES @ 60° ANGLE
  7. UNDISTURBED SUBGRADE
  8. GROUND COVER PLANT, REMOVE FROM CONTAINER

- CONTRACTOR TO VERIFY PERCOLATION OF PLANTING PIT PRIOR TO INSTALLATION
1. SEE PLAN FOR SPACING
  2. SHRUB PLANTS
  3. 3" DEPTH DOUBLE PROCESSED SHREDDED BARK MULCH, TYP.
  4. REMOVE BURLAP 4" CUT TUNE FROM TOP 1/3 OF BALL
  5. SHOVEL CUT EDGE OR STEEL EDGE, SEE PLAN
  6. EXCAVATE EXISTING SOIL 2" DEEP OR DEPTH OF ROOT BALL, FILL WITH PLANT MIX - REFER TO SPECS
  7. UNDISTURBED SUBGRADE
  8. 2" MIN. BETWEEN ROOTBALL AND EDGE OF PLANT

- NOTES:
1. CONTRACTOR TO VERIFY PERCOLATION OF PLANTING PIT PRIOR TO INSTALLATION
  2. 3 TRUNK "MINIMUM TREE
  3. TREES 1 1/2" AND LARGER TO BE GUYED (3 PER TREE) REFER TO TYPICAL TREE PLANTING DETAIL FOR GUYING NOTES
  4. AREA OF "RAPID TAPER" REMOVE ALL SOILS ABOVE THIS LINE AND SET TREE TO THIS FINISH GRADE
  5. TREE PIT 2X BALL DIAMETER BACKFILL WITH EXCAVATED NATIVE SOIL, PULVERIZE SOIL PRIOR TO BACKFILL TO IT OR SMALLER ELIMINATE ALL VOIDS, PROVIDE SOIL SAUCER RING AROUND TREE PIT
  6. FINISH GRADE WITH LAWN SLOPED AWAY FROM TREE
  7. REMOVE BURLAP BACK TO 6" BELOW GRADE, CUT WIRE BASKET
  8. 4" DEPTH SHREDDED BARK MULCH, DO NOT FILL MULCH UP AROUND TRUNK
  9. 2" MINIMUM BETWEEN ROOT BALL AND EDGE OF PLANT PIT

- GENERAL NOTES:
1. STAKE TREES 4" CALIBER AND UNDER 2 PER TREE.
  2. GUY TREES OVER 4" CALIBER, 3 PER TREE.
  3. CONTRACTOR TO VERIFY PERCOLATION AND CONTRACTION OF PLANTING PIT PRIOR TO INSTALLATION.
  4. SEE SPECIFICATIONS FOR ADDITIONAL INFORMATION REGARDING PLANTING STANDARDS AND PROCEDURES.
  5. POLYPROPYLENE GUYING FABRIC, LOCATE ABOVE FIRST BRANCH, TYP. - REFER TO SPECS
  6. 2" x 2" x 12" LONG UNTREATED HARDWOOD STAKES, STAKES TO EXTEND 18" BELOW TREE PIT IN UNDISTURBED SOIL, SET VERTICALLY FLUSH AND EVENLY SPACED, TYP.
  7. INSTALL TREE WRAP FOR THIN SKINNED TREES, REMOVE AFTER FIRST YEAR, TYP. - REFER TO SPECS
  8. ROOT FLARE - (AREA OF RAPID TAPER) REMOVE ALL SOILS ABOVE THIS LINE AND SET BOTTOM OF ROOT FLARE FLUSH TO ADJACENT FINISH GRADE - ROOT FLARE SHOULD NOT HAVE MULCH OVER TOP OF IT AND SHOULD REMAIN VISIBLE AT THE COMPLETION OF PLANTING, TYP.
  9. BACKFILL WITH PULVERIZED EXCAVATED NATIVE SOIL UNTIL 1/3 OF THE TREE PIT IS FILLED HAND COMPACT BY FOOT OR TAMPER TO STABILIZE AND FLUSH TREE - REFER TO SPECS
  10. 2" MINIMUM BETWEEN ROOT BALL AND EDGE OF PLANT PIT, CUT PIT SIDES @ 60° ANGLE, TYP.
  11. ADJACENT FINISH GRADE - ENSURE BOTTOM OF ROOT FLARE IS SET FLUSH TO THIS ELEVATION, TYP.
  12. CUT AND REMOVE BURLAP TO 6" BELOW GRADE OR 1/3 OF THE ROOT BALL WHICHEVER IS GREATER AND REMOVE TUNE FROM ROOT FLARE IF PRESENT CUT WIRE BASKET AND REMOVE 6"-8" BELOW GRADE, DISPOSE OF LEGALLY NOT IN PIT, TYP.
  13. 3" DEPTH DOUBLE PROCESSED SHREDDED BARK MULCH - MULCH SHALL NOT COVER ROOT FLARE, PROVIDE 1" DEPTH MULCH OVER THE ROOT BALL - WHEN PLANTED IN LAWN AREAS, EXTEND MULCH CIRCLE TO A 60° RADIUS AROUND THE TREE UNLESS NOTED OTHERWISE, TYP.
  14. PROVIDE 3"-4" HIGH SOIL SAUCER RING AROUND TREE PIT IF NO IRRIGATION IS PRESENT, HAND WATER TO PREVENT DROUGHT, TYP.
  15. COMPACT BOTTOM OF PLANTING PIT TO PREVENT SETTLING, TYP.
  16. DIG TREE PIT 2X BALL DIA. MIN. LIGHTLY SCARRIFY THE SIDES OF THE TREE PIT TO ALLOW FOR ROOT GROWTH INTO ADJACENT SOILS, TYP.
  17. SHOVEL CUT EDGE OR EDGING AROUND TREE, TYP. - REFER TO PLANS
  18. BACKFILL TOP 2/3 OF TREE PIT WITH APPROVED TOPSOIL - WATER IN AND REMOVE AIR ROCKETS, CONTINUE TO FILL WITH TOPSOIL IF SETTLEMENT HAS OCCURRED UNTIL CORRECT ELEVATIONS ARE ACHIEVED, DO NOT FILL ON ROOT FLARE - REFER TO SPEC.

PRELIMINARY DOCUMENT - NOT FOR CONSTRUCTION



Issued for

11.20.2020 HISTORIC DISTRICT COMMISSION

Drawn	<input checked="" type="checkbox"/> Preliminary
AEP	<input type="checkbox"/> Construction
Checked	<input type="checkbox"/> Record
RKM	<input type="checkbox"/> Approved
RKM	<input type="checkbox"/> Do not scale
Bidpak Number	<input type="checkbox"/> Use figured dimensions only

Job Number  
**2020078**  
 Title  
**Landscape Details**

Sheet  
**L201**

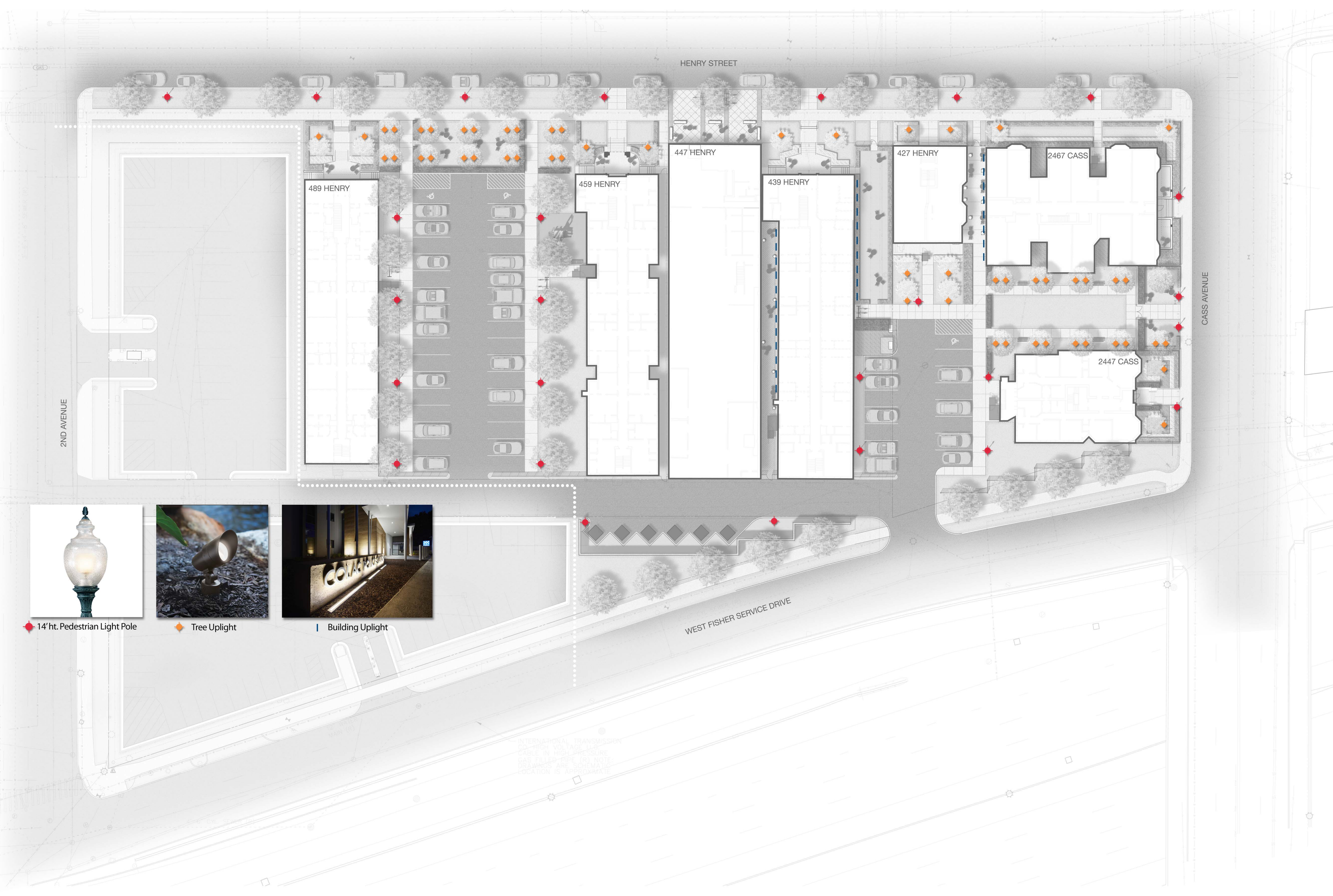

◆ 14'ht. Pedestrian Light Pole



◆ Tree Uplight



| Building Uplight

**PRELIMINARY DOCUMENT - NOT FOR CONSTRUCTION**



Alexander Pearson

Issued for

11.20.2020 HISTORIC DISTRICT COMMISSION

Drawn	■ Preliminary
AEP	□ Construction
Checked	□ Record
RKM	
Approved	Do not scale
RKM	Use figured dimensions only
Bitpak Number	

Job Number  
**2020078**

Title  
**Site Lighting Design Intent**

Sheet  
**L301**



0' 10' 20' 40'  
 SCALE: 1"=20'

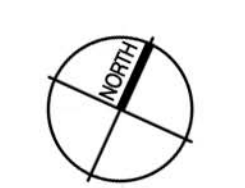



**ELECTRICAL GENERAL NOTES**

1. REFER TO LANDSCAPE ARCHITECT PLANS AND ELEVATIONS TO VERIFY LOCATION OF DEVICES.
2. FIELD VERIFY LOCATIONS OF EXISTING UNDERGROUND SERVICES TO COORDINATE ALL POLE BASE LOCATIONS AND UNDERGROUND SERVICES BEING INSTALLED UNDER THIS CONTRACT WITH CIVIL AND LANDSCAPE DRAWINGS PRIOR TO INSTALLATION OF POLES BASES AND CONDUIT.
3. LIGHT FIXTURES ARE LOOPED TOGETHER TO INDICATE CONTROL ZONE GROUPS. CONNECTED FIXTURES ARE TO BE CONTROLLED TOGETHER. CIRCUITS MAY BE SHARED AMONG SEPARATE CONTROL ZONE GROUPS. MULTIPLE ZONES ZONES MAY BE COMBINED IN SOFTWARE TO FORM SCENES. SEE LIGHTING CONTROL MATRIX: SCENE SCHEDULE (IF PROVIDED), AND PANEL SCHEDULES FOR ADDITIONAL INFORMATION.

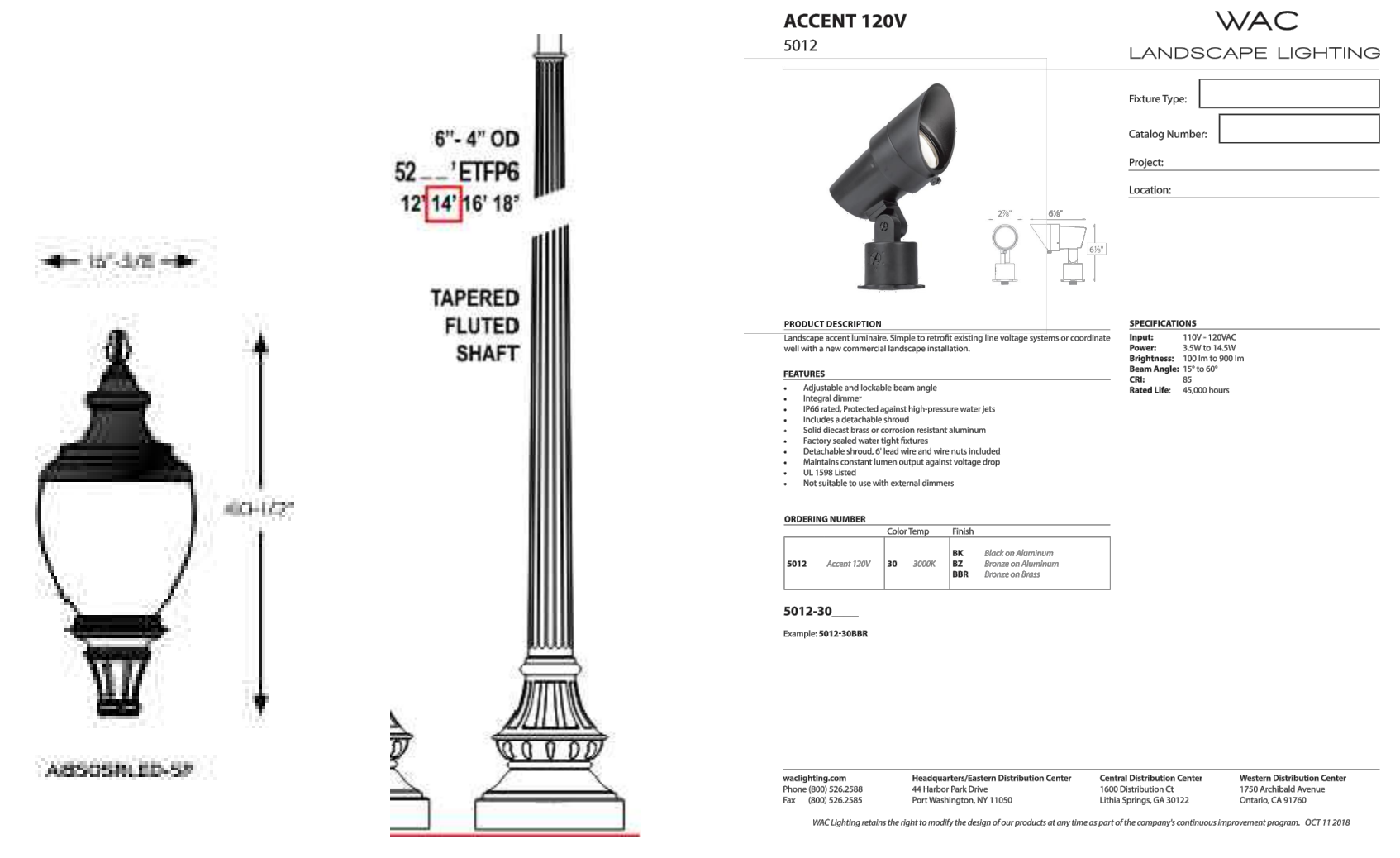

FIXTURE TYPE S1A/S1B/S2      FIXTURE TYPE 'S3'

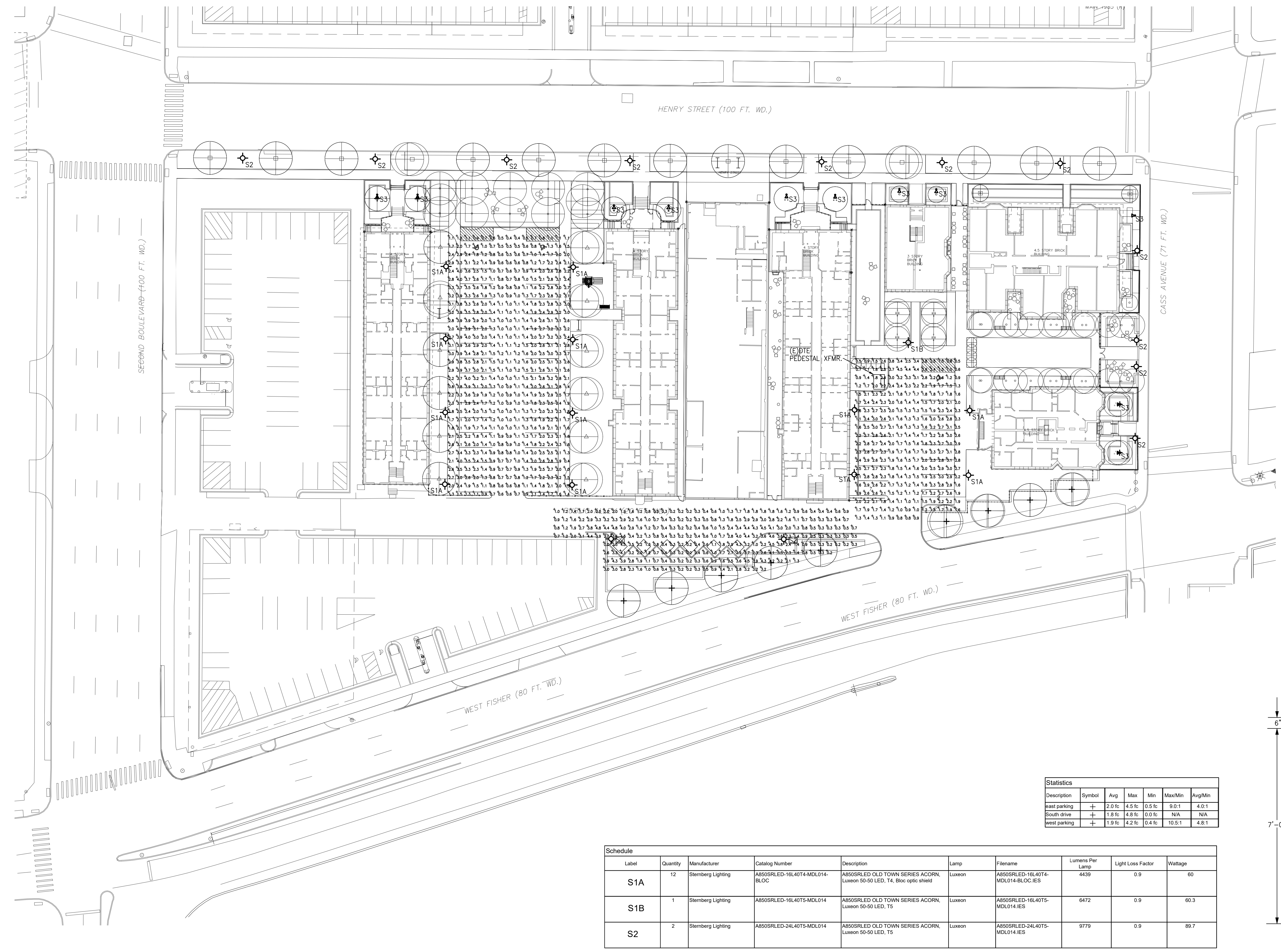

Statistics									
Description	Symbol	Avg	Max	Min	Max/Min	Avg/Min			
West parking	+	2.0%	4.5%	0.5%	9.0%	4.0%			
South drive	+	1.8%	4.8%	0.0%	N/A	N/A			
West parking	+	1.9%	4.2%	0.4%	10.5%	4.8%			

Schedule									
Label	Quantity	Manufacturer	Catalog Number	Description	Lamp	Filename	Lumens Per Lamp	Light Loss Factor	Wattage
S1A	12	Sternberg Lighting	ABS05RLED-16.40T4-MDL014-BLOC	ABS05RLED OLD TOWN SERIES ACCORN, Luxecon 50-60 LED, T4, 180c optic aimed	Luxecon	ABS05RLED-16.40T4-MDL014-BLOC-IES	4439	0.9	60
S1B	1	Sternberg Lighting	ABS05RLED-16.40T5-MDL014	ABS05RLED OLD TOWN SERIES ACCORN, Luxecon 50-60 LED, T5	Luxecon	ABS05RLED-16.40T5-MDL014-IES	6472	0.9	60.3
S2	2	Sternberg Lighting	ABS05RLED-24.40T5-MDL014	ABS05RLED OLD TOWN SERIES ACCORN, Luxecon 50-60 LED, T5	Luxecon	ABS05RLED-24.40T5-MDL014-IES	9779	0.9	89.7

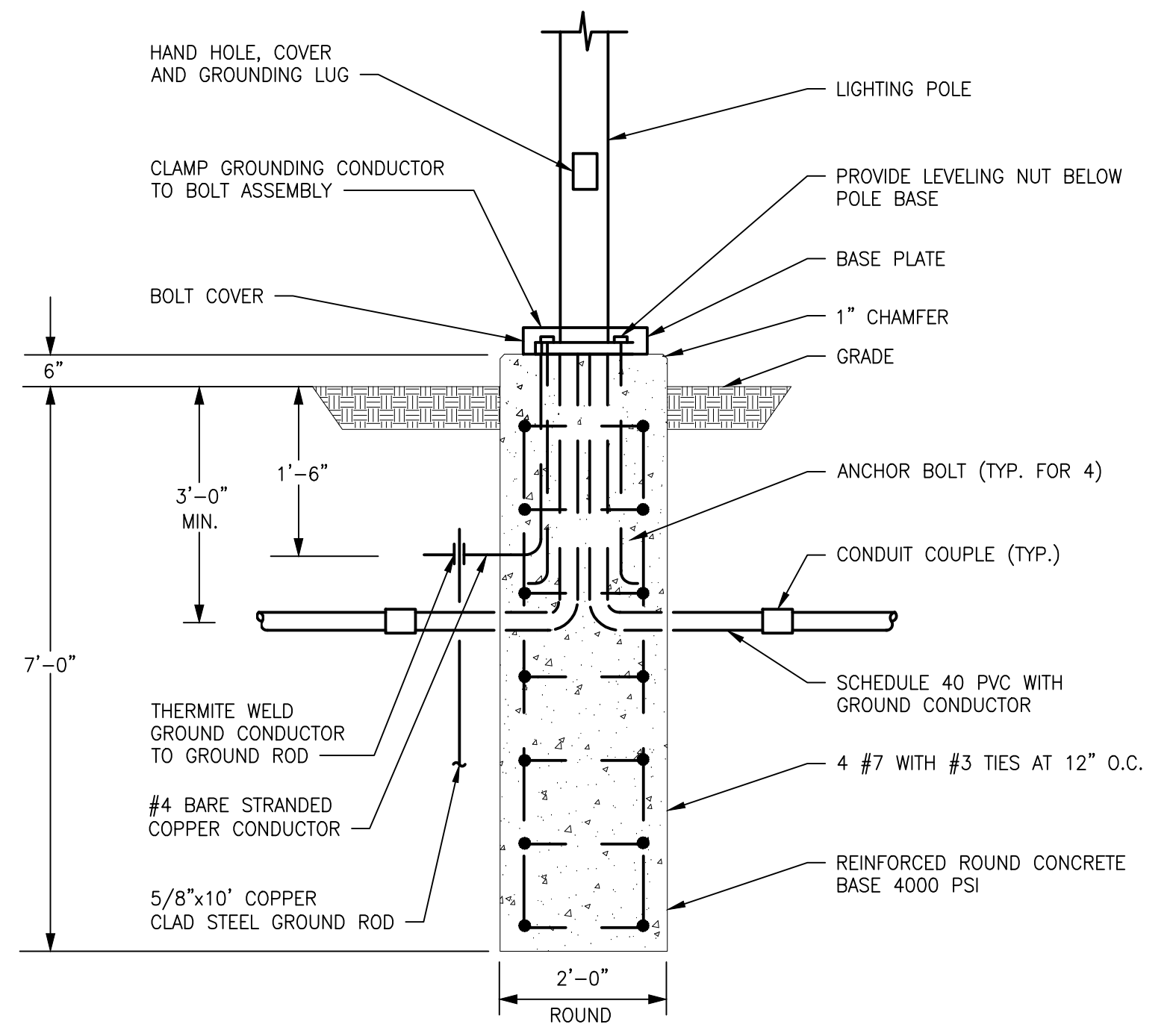

LIGHTING POLE BASE DETAIL (6" BASE)  
NO SCALE

PRELIMINARY DOCUMENT - NOT FOR CONSTRUCTION

Issued for

11.20.2020 HISTORIC DISTRICT COMMISSION

Drawn:  Preliminary  
**DAD**  Construction  
Checked:  Construction  
**SET**  Record  
Approved:  Construction  
**SES**  Record  
Bidpak Number: \_\_\_\_\_

Job Number: **2020078**  
Title: **ELECTRICAL SITE PLAN**

Sheet **ES101**