

10/18/22

**NOTICE OF DENIAL**

Mario Mongini  
2011 Longfellow  
Detroit, MI 48206

**RE: Application Number 22-8066; 2011 Longfellow; Boston-Edison Historic District**

Dear Applicant,

At the Regular Meeting that was held on October 12, 2022, the Detroit Historic District Commission (“DHDC”) reviewed the above-referenced application. Pursuant to Section 5(1) and 9(1) of the Michigan Local Historic District Act, as amended, being MCL 399.205 (1), MCL 399.209 (9) and Sections 21-2-78 and 21-2-80 of the 2019 Detroit City Code; the DHDC hereby issues a Denial for the following work, effective on October 18, 2022, as it will be inappropriate according to the Secretary of Interior’s Standards for Rehabilitation and the district’s Elements of Design:

- *The replacement of original wood windows with fiberglass windows,*
- *The installation of new muntins attached to fiberglass windows,*
- *The alteration to the front porch steps and installation of step wingwalls and railings,*
- *The installation of security lights at the front elevation*

The reasons for the denial are a failure to meet the following specific Standards or Elements:

- 2) *The historic character of a property shall be retained and preserved. The removal of historic materials or alteration of features and spaces that characterize a property shall be avoided.*
- 5) *Distinctive features, finishes, and construction techniques or examples of craftsmanship that characterize a historic property shall be preserved.*
- 6) *Deteriorated historic features shall be repaired rather than replaced. Where the severity of deterioration requires replacement of a distinctive feature, the new feature shall match the old in design, color, texture, and other visual qualities and, where possible, materials. Replacement of missing features shall be substantiated by documentary, physical, or pictorial evidence.*
- 9) *New additions, exterior alterations, or related new construction shall not destroy historic materials that characterize the property. The new work shall be differentiated from the old and shall be compatible with the massing, size, scale, and architectural features to protect the historic integrity of the property and its environment*

The application may be resubmitted for the Historic District Commission's review when suggested changes have been made that address the cited reasons for denial, if applicable.

Please be advised that, in accordance with MCL 399. 211 and Section 21-2-81 of the 2019 Detroit City Code, an applicant aggrieved by a decision of the DHDC may file an appeal with the State Historic Preservation Review Board. Within sixty (60) days of your receipt of this notice, an appeal may be filed with:

Jon Stuckey, Michigan Department of Attorney General  
2<sup>nd</sup> Floor, G. Mennen Williams Building  
525 West Ottawa Street  
P.O. Box 30754  
Lansing, MI 48909  
Phone: 517-335-0665  
E-mail: stuckeyj@michigan.gov

If you have any questions regarding the foregoing, please contact staff at 313-224-1762 or hdc@detroitmi.gov.  
For the Commission:



Daniel Rieden  
Detroit Historic District Commission

# DHDC 22-8066

## APPROVAL DOCUMENT – POST AT WORK LOCATION

CITY OF DETROIT  
HISTORIC DISTRICT COMMISSION

2 WOODWARD, SUITE 808  
DETROIT, MICHIGAN 48226

10/18/22

### CERTIFICATE OF APPROPRIATENESS

Mario Mongini  
2011 Longfellow  
Detroit, MI 48206

**RE: Application Number 22-8066; 2011 Longfellow; Boston-Edison Historic District**

Dear Applicant,

At the Regular Meeting that was held on October 12, 2022, the Detroit Historic District Commission (“DHDC”) reviewed the above-referenced application. Pursuant to Section 5(1) of the Michigan Local Historic District Act, as amended, being MCL 399.205 (1) and Sections 21-2-73/21-2-78 of the 2019 Detroit City Code; the DHDC hereby issues a Certificate of Appropriateness (“COA”) for the following work, effective on October 18, 2022, as it meets the Secretary of Interior’s Standards for Rehabilitation and the district’s Elements of Design:

- *Installation of the proposed aluminum-clad wood windows to restore the design, operation, and configuration of the original windows per the attached window schedule*
- *The removal of the planter boxes, and the proposed treatment and concealment of remaining scarring with foundation plantings per the attached descriptions and drawings*

*The Certificate of Appropriateness is issued with the following conditions:*

- *Applicant supplies HDC staff with a planting plan that identifies the evergreen species to screen the scarring of the house where the planters once stood.*
- *The applicant provides HDC staff with the product and description of method to safely attempt to remove the scarring from the brick face of the house.*
- *HDC staff shall review and approve these submissions before their application/installation.*

Please retain this COA for your files and post it at the subject property until work is complete. It is important to note that approval by the DHDC does not waive the applicant's responsibility to comply with any other applicable ordinances or statutes. If you have any questions regarding the foregoing, please contact staff at 313-224-1762 or [hdc@detroitmi.gov](mailto:hdc@detroitmi.gov).

For the Commission:



Daniel Rieden  
Detroit Historic District Commission

November 16, 2021

**NOTICE OF DENIAL**

Mr. Mario Mongini  
2011 Longfellow  
Detroit, MI 48206

**RE: Application Number 21-7577; 2011 Longfellow; Boston-Edison Park Historic District**

Dear Mr. Mongini:

At the regular meeting that was held on November 10, 2021, the Detroit Historic District (“Commission”) reviewed the above-referenced application for building permit. Pursuant to Section 21-2-80 of the 2019 Detroit City Code, the Commission hereby issues a **Notice of Denial for the below outlined items** which is effective as of November 16, 2021. Specifically, the Commission reviewed the permit for **the below-described work**, and determined that it *does not* qualify for a Certificate of Appropriateness because it does not meet the Secretary of the Interior Standards for Rehabilitation, Standards:

- 2) The historic character of a property shall be retained and preserved. The removal of historic materials or alteration of features and spaces that characterize a property shall be avoided.*
- 5) Distinctive features, finishes, and construction techniques or examples of craftsmanship that characterize a property shall be preserved.*
- 6) Deteriorated historic features shall be repaired rather than replaced. Where the severity of deterioration requires replacement of a distinctive feature, the new feature shall match the old in design, color, texture, and other visual qualities and, where possible, materials. Replacement of missing features shall be substantiated by documentary, physical, or pictorial evidence.*

- The replacement of the original windows with fiberglass sash

Please be advised that a permit applicant that is aggrieved by a decision of the Detroit Historic District Commission concerning a permit application may file an appeal with the Michigan Department of Attorney General. Within sixty (60) days of your receipt of this notice, an appeal may be filed with:

Jon Stuckey  
Michigan Department of Attorney General  
2<sup>nd</sup> Floor G. Mennen Williams Building  
525 West Ottawa Street  
P.O. Box 30754  
Lansing, MI 48909  
P: 517-335-0665, F: 517-335-3088, Email: [stuckeyj@michigan.gov](mailto:stuckeyj@michigan.gov)

If you have any questions regarding the foregoing, please contact Taylor Leonard, Counsel for the Commission at (313) 237-3006.

For the Commission:



Daniel Rieden  
Staff  
Detroit Historic District Commission



September 16, 2022

Ms. Jennifer Ross  
City of Detroit  
Historic District Commission  
Coleman A. Young Municipal Center  
2 Woodward Avenue, Suite 808  
Detroit, Michigan 48226

RE: 2011 Longfellow Avenue – Request for Rehabilitation Approval  
2011 Longfellow Avenue, on the south side of Longfellow between Rosa Parks Blvd. and 14th Avenues  
Violation #500

Dear Ms. Ross:

Mario Mongini, the owner of the residence at 2011 Longfellow, requests that the Historic District Commission grant approval for a replacement of forty-eight (48) original wood windows. The owner replaced these original wood windows with new fiberglass windows. The owner is seeking to mitigate damage to the historic character of the building by replacing select windows with new wood windows and adding exterior grids to the fiberglass windows proposed to remain to improve their appearance. Following approval, the Owners intend to proceed with construction work per the approved certificate of appropriateness for the exterior work.

### **Background**

The building is a 2 1/2 story center entrance colonial structure, measuring approximately 40 feet along Longfellow avenue, by 40 feet in depth. The dominant roof is a side-facing gable roof covered in brown asphalt shingles. The center of the roof over the front door features a street-facing gable, which is flanked on either side by arch-topped dormers. The eaves feature modillions, and the house retains its original integral gutter system. Pilasters frame the center entrance. The house is clad in red brick with decorative quoins at the corners. The symmetrically placed original windows featured true divided light mullions, which were replaced with fiberglass windows, except for the remaining original windows on the third floor.

Mario Mongini, the owner of the residence, is seeking to make improvements to mitigate the fiberglass window replacement work that has occurred, and issuance of a Certificate of Appropriateness for the following work.

The building sits within the Boston-Edison Local historic district.

### **Scope of Work**

The following describes proposed modifications to the previous application based on the Commission's comments and feedback at the November 10, 2021 Historic District Commission Meeting, Notice of

Denial, dated November 16, 2021, and comments and feedback at the August 10, 2022 Commission meeting, where the client withdrew his application prior to a vote so it could be revised.

The following is a detailed description of the scope of work regarding the work at each facade:

### **North (Front) Facade**

Removal and replacement of eleven (11) non-approved double hung fiberglass windows with eleven (11) double hung wood windows with simulated divided lites in a pattern to match the historic windows that were removed. Four (4) windows are located at the first story, and seven (7) windows are located at the second story. Two (2) historic era double hung windows will be retained at the third story.

Removal of aluminum cladding from eleven (11) window openings and restoration of original wood brick moulds or replacement in-kind with new brick moulds to match the historic if the underlying condition is discovered to be too deteriorated to salvage.

The owner is also seeking retroactive approval for the removal of the original front porch, steps, and planter boxes that were completed by the prior owner. The current front porch, steps and wings walls that were constructed prior to his ownership of the property will be retained. Two new black metal handrails will be installed at the porch steps for safety reasons. New foundation plantings will be added to mask the brickwork that was patched in where the planter boxes were removed, and the new gas service location, which exists at the location where the east planter was located.

### **West (Right Side) Facade**

Fourteen (14) historic era wood windows were replaced with new white fiberglass windows with grilles between the glass in a divided lites in a pattern to match the historic windows.

At the first story, six (6) windows were replaced with five (5) windows, with two (2) window openings at the sun room being combined into one (1) picture window. The picture window and the windows that flank it at each side will be removed and be replaced with four (4) wood double hung windows with simulated divided lites in a pattern to match the windows that were removed.

At the second story, six (6) windows were replaced with five (5) windows, with two (2) window openings at the sleeping porch being combined into one (1) picture window. The picture window and the windows that flank it at each side will be removed and be replaced with four (4) wood double hung windows with simulated divided lites in a pattern to match the windows that were removed.

At the third story, two (2) windows were replaced in existing openings.

In total, eight (8) wood double hung windows will be installed to match the original configuration of the windows prior to the replacement. At the six (6) fiberglass windows proposed to remain, external wood grids in a profile to mimic the muntin profile of the historic windows will be installed at the exterior surface of the glass to replicate the historic muntin pattern and provide additional depth and shadow lines. All wood trim and wood grids to be painted white to match fiberglass windows.

### **South (Rear) Facade**

Twelve (12) historic era wood windows were replaced in existing openings with new white fiberglass windows with grilles between the glass in a divided lites in a pattern to match the historic windows. Where the existing fiberglass windows are to remain, external wood simulated divided lite grids will be installed.

At the first story, eight (8) windows were replaced with six (6) windows, with the two (2) smaller openings either side of the sunroom doors combined into one (1) picture window at each side of the door. The two (2) picture windows will be removed and replaced with four (4) wood double hung windows with simulated divided lites in a pattern to match the windows that were removed.

At the second story, four (4) windows were replaced with three (3) windows, with two (2) window openings at the sleeping porch being combined into one (1) picture window. The picture window and the windows that flank it at each side will be removed and be replaced with four (4) wood double hung windows with simulated divided lites in a pattern to match the windows that were removed.

Three (3) historic era double hung windows will be retained in the stairwell landing at the second floor.

Four (4) historic era double hung windows will be retained at the third floor.

In total, eight (8) wood double hung windows will be installed to match the original configuration of the windows prior to the replacement. At the four (4) fiberglass windows proposed to remain, external wood grids in a profile to mimic the muntin profile of the historic windows will be installed at the exterior surface of the glass to replicate the historic muntin pattern and provide additional depth and shadow lines. All wood trim and wood grids to be painted white to match fiberglass windows.

### **East (Left Side) Facade**

Eleven (11) historic era wood windows were replaced in existing openings with new white fiberglass windows with grilles between the glass in a divided lites in a pattern to match the historic windows.

At the first story, four (4) windows were replaced in existing openings. Three (3) historic era windows will be retained.

At the second story, five (5) windows were replaced in existing openings.

At the third story, two (2) windows were replaced in existing openings.

All eleven (11) fiberglass windows are to be retained, and external wood grids in a profile to mimic the muntin profile of the historic windows will be installed at the exterior surface of the glass to replicate the historic muntin pattern and provide additional depth and shadow lines. All wood trim and wood grids to be painted white to match fiberglass windows.



## Conclusion

The items listed above and attached exhibits provide a synopsis of the Owner's proposed scope of work for the rehabilitation of the residence at 2011 Longfellow Avenue. We believe that this plan effectively mitigates the outstanding violations at the property and should be approved.

Sincerely,  
Infuz Architects Ltd.

A handwritten signature in black ink, appearing to read 'Allan Machielse'.

Allan Machielse, RA, NCARB  
Architect



## Scope of Work - 2011 Longfellow Avenue

2011 Longfellow; Boston-Edison Historic District; as follows:

- Replacement of twenty-two (22) non-approved fiberglass windows with twenty-seven (27) new wood double hung windows with simulated divided lites in a pattern to match the historic windows that were removed.
- At the eleven first and second story windows at the north elevation, remove associated aluminum wrapping and restore original brick moulds or replace in-kind as required.
- Replacement of Twenty-one (21) historic era wood windows with fiberglass double hung windows with grilles between the glass in a divided lite pattern to match the historic windows and installation of external, wood grids, in a profile to mimic the muntin profile of the historic windows at the exterior surface of the glass to replicate the historic muntin pattern and provide additional depth and shadow lines.
- Retention of existing front porch and wing walls; installation of two (2) black metal handrails at porch steps.
- Installation of new foundation plantings at either side of the front porch to mask the scars from the planters that were removed by prior owners.

**From:** [Mario Mongini](#)  
**To:** [Dan Rieden](#)  
**Cc:** [Allan Machielse](#); [Ignacio Oyuela](#); [Andrea](#)  
**Subject:** Re: [EXTERNAL] Mongini Elevations.pdf  
**Date:** Wednesday, October 5, 2022 2:12:07 PM  
**Attachments:** [Railing longfellow.pdf](#)  
[LUTEC Cuba longfellow final.pdf](#)

---

**This Message Is From an External Sender**

ATTENTION: This email was sent from an external source. Please be extra cautious when opening attachments or clicking links.

Mr. Rieden,

We evaluated two alternatives, one provided by Andersen and the other by Marvin. Any of these two will be chosen, based on the board decision.

Regarding the questions related to the security light, I want to make aware that we put the lights where it seemed that there were lights in the past.

Regarding the walls, that were covered by the planters removed before we purchased the house, will be cleaned with low pressure water or gentle acid-based cleaning. Nevertheless we will not address the fact that the brick used to patch this in will be different.

I am attaching the specs for the railings as well as the lights.

Best regards, Mario Mongini

**From:** [Allan Machielse](#)  
**To:** [Dan Rieden](#)  
**Cc:** [Mario Mongini](#); [Ignacio Oyuela](#); [Andrea](#)  
**Subject:** Re: Re: [EXTERNAL] Mongini Elevations.pdf  
**Date:** Wednesday, October 5, 2022 5:51:02 PM  
**Attachments:** [Mongini Elevations - Rev1.pdf](#)

---

**This Message Is From an External Sender**

ATTENTION: This email was sent from an external source. Please be extra cautious when opening attachments or clicking links.

Hi Dan,

Per our conversation this afternoon, I updated the elevations and color-coded them to better explain the proposal to the commissioners. We would like the commission's approval to use either the Andersen product or the Marvin product based on final pricing, as we'd discussed on the phone. I did confirm that both of these products are aluminum-clad wood windows. They are relatively equivalent products.

Allan Machielse, RA, NCARB

Design Office Manager

O: (313) 332-1299 | M: (810) 252-4197

1111 Bellevue, Ste. 201, Detroit, MI 48207



[www.virtuosodesignbuild.com](http://www.virtuosodesignbuild.com)

[www.infuzarchitects.com](http://www.infuzarchitects.com)

*The information contained in this transmission (including any attachments) is confidential and may be privileged. It is intended only for the use of the individual or entity named above. If you are not the intended recipient, dissemination, distribution, or copy of this communication is strictly prohibited. If you have received this communication in error, please erase all copies of this message and its attachments and notify me immediately.*

On Wed, Oct 5, 2022 at 2:36 PM Allan Machielse <[allan@infuzarchitects.com](mailto:allan@infuzarchitects.com)> wrote:

Dan,

If you look in the "Comments" column of the schedule, it indicates which windows are the Marvin Infinity Fiberglass windows (which will have the external grids added), which windows will be changed out in favor of new SDL wood windows (either Marvin or Andersen based on final pricing and availability), and which windows are historic era windows to be retained. I can try to clarify this further.

Allan Machielse, RA, NCARB

Design Office Manager

O: (313) 332-1299 | M: (810) 252-4197

1111 Bellevue, Ste. 201, Detroit, MI 48207



[www.virtuosodesignbuild.com](http://www.virtuosodesignbuild.com)

[www.infuzarchitects.com](http://www.infuzarchitects.com)

*The information contained in this transmission (including any attachments) is confidential and may be privileged. It is intended only for the use of the individual or entity named above. If you are not the intended recipient, dissemination, distribution, or copy of this*

**From:** [Mario Mongini](#)  
**To:** [Dan Rieden](#)  
**Cc:** [Allan Machielse](#); [Ignacio Oyuela](#); [Andrea](#)  
**Subject:** Re: [EXTERNAL] Mongini Elevations.pdf  
**Date:** Wednesday, October 5, 2022 2:12:07 PM  
**Attachments:** [Railing longfellow.pdf](#)  
[LUTEC Cuba longfellow final.pdf](#)

---

**This Message Is From an External Sender**

ATTENTION: This email was sent from an external source. Please be extra cautious when opening attachments or clicking links.

Mr. Rieden,

We evaluated two alternatives, one provided by Andersen and the other by Marvin. Any of these two will be chosen, based on the board decision.

Regarding the questions related to the security light, I want to make aware that we put the lights where it seemed that there were lights in the past.

Regarding the walls, that were covered by the planters removed before we purchased the house, will be cleaned with low pressure water or gentle acid-based cleaning. Nevertheless we will not address the fact that the brick used to patch this in will be different.

I am attaching the specs for the railings as well as the lights.

Best regards, Mario Mongini

Unauthorized use of this drawing set without written permission from Infuz Ltd is in violation of U.S. COPYRIGHT LAWS and will be subject to civil damages and prosecution.

Revision Schedule

#	Description	Date

SEAL

**NOT FOR CONSTRUCTION**

DATE SEALED

**MONGINI RESIDENCE**  
 PROJECT NUMBER: XXXXXXXXXXXXXXXX  
 2011 LONGFELLOW AVE.  
 DETROIT, MI 48206  
**MARIO MONGINI**  
 SHEET TITLE  
**PROPOSED EXTERIOR ELEVATIONS**

SHEET NUMBER

**A-3.0**

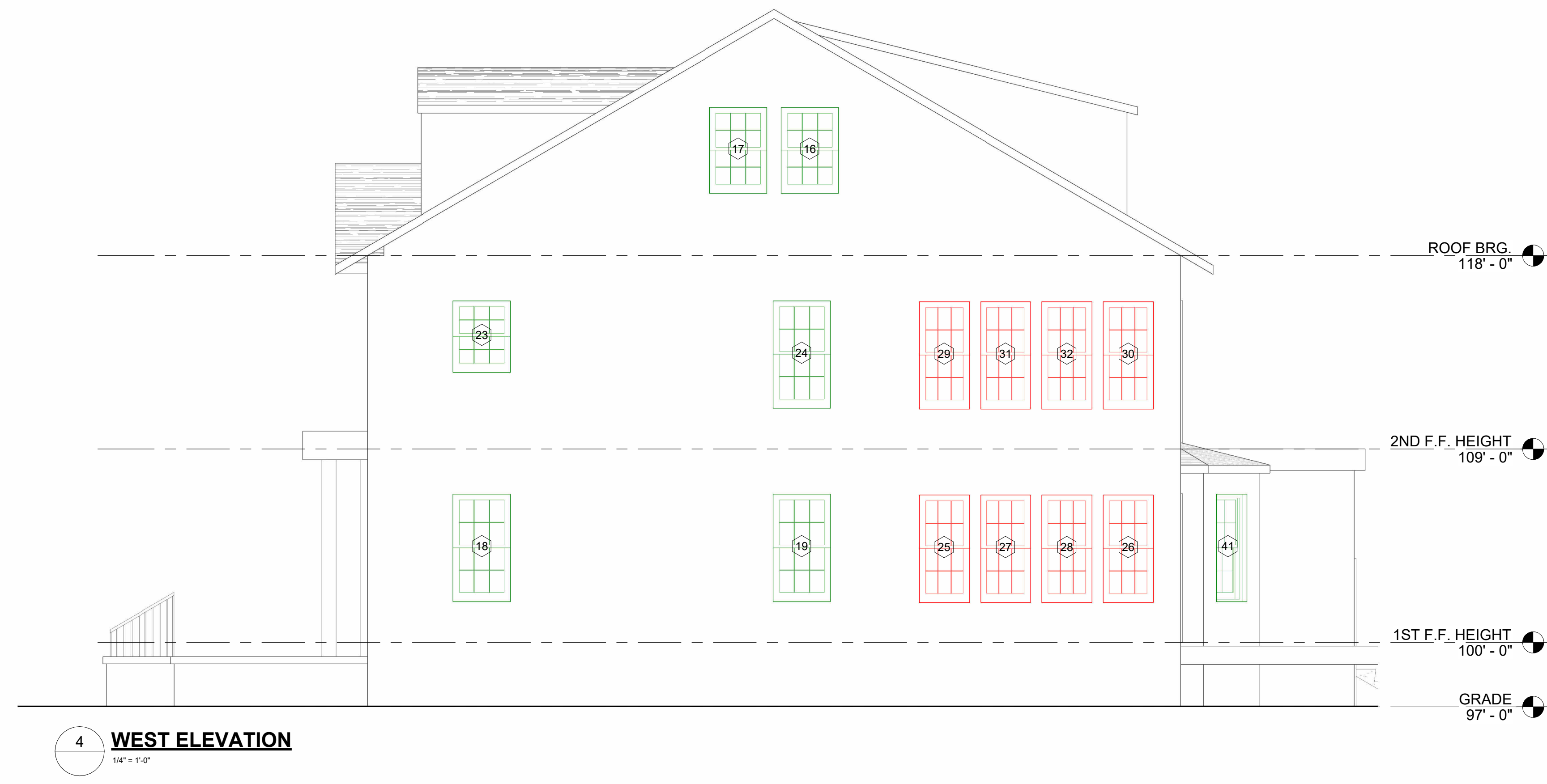

**4 WEST ELEVATION**  
 1/4" = 1'-0"



**3 SOUTH ELEVATION**  
 1/4" = 1'-0"



**2 EAST ELEVATION**  
 1/4" = 1'-0"



**1 NORTH ELEVATION**  
 1/4" = 1'-0"

WINDOW KEY	
BLUE	HISTORIC WINDOW TO REMAIN
RED	NEW ALUMINUM-CLAD WOOD WINDOW - MARVIN SIGNATURE ULTIMATE SERIES OR ANDERSEN E SERIES
GREEN	MARVIN INFINITY FIBERGLASS WINDOW WITH WOOD GRIDS ATTACHED TO EXTERIOR FACE OF GLAZING

NOTE: ARCHITECTURAL ELEVATIONS ARE SHOWN ONLY FOR WINDOW TYPE AND LOCATION. REFER TO WINDOW SCHEDULE FOR ADDITIONAL INFORMATION. DO NOT SCALE DRAWINGS.

Unauthorized use of this drawing set without written permission from Infuz Ltd is in violation of U.S. COPYRIGHT LAWS and will be subject to civil damages and prosecution.

**Revision Schedule**

#	Description	Date

SEAL

NOT FOR CONSTRUCTION

DATE SEALED

**MONGINI RESIDENCE**

PROJECT NUMBER: XXXXXXXXXXXXXXXX  
 2011 LONGFELLOW AVE.  
 DETROIT, MI 48206

MARIO MONGINI  
 SHEET TITLE

**SCHEDULES**

SHEET NUMBER

**A-8.0**

WINDOW SCHEDULE			
Mark	Approximate Width	Approximate Height	Comments
1	2' - 8"	5' - 0"	NEW ALUMINUM CLAD WOOD WINDOW
2	2' - 8"	5' - 0"	NEW ALUMINUM CLAD WOOD WINDOW
3	2' - 8"	5' - 0"	NEW ALUMINUM CLAD WOOD WINDOW
4	2' - 8"	5' - 0"	NEW ALUMINUM CLAD WOOD WINDOW
5	2' - 8"	5' - 0"	NEW ALUMINUM CLAD WOOD WINDOW
6	2' - 8"	5' - 0"	NEW ALUMINUM CLAD WOOD WINDOW
7	2' - 8"	5' - 0"	NEW ALUMINUM CLAD WOOD WINDOW
8	2' - 8"	5' - 0"	NEW ALUMINUM CLAD WOOD WINDOW
9	2' - 6"	4' - 0"	NEW ALUMINUM CLAD WOOD WINDOW
10	1' - 4"	4' - 0"	NEW ALUMINUM CLAD WOOD WINDOW
11	1' - 4"	4' - 0"	NEW ALUMINUM CLAD WOOD WINDOW
12	2' - 8"	5' - 0"	HISTORIC WINDOW TO REMAIN
13	2' - 8"	5' - 0"	HISTORIC WINDOW TO REMAIN
14	2' - 8"	4' - 0"	MARVIN INFINITY FIBERGLASS WINDOW WITH APPLIED EXTERIOR MUTIN
15	2' - 8"	4' - 0"	MARVIN INFINITY FIBERGLASS WINDOW WITH APPLIED EXTERIOR MUTIN
16	2' - 8"	4' - 0"	MARVIN INFINITY FIBERGLASS WINDOW WITH APPLIED EXTERIOR MUTIN
17	2' - 8"	4' - 0"	MARVIN INFINITY FIBERGLASS WINDOW WITH APPLIED EXTERIOR MUTIN
18	2' - 8"	5' - 0"	MARVIN INFINITY FIBERGLASS WINDOW WITH APPLIED EXTERIOR MUTIN
19	2' - 8"	5' - 0"	MARVIN INFINITY FIBERGLASS WINDOW WITH APPLIED EXTERIOR MUTIN
20	1' - 6"	2' - 0"	HISTORIC WINDOW TO REMAIN
21	1' - 6"	2' - 0"	HISTORIC WINDOW TO REMAIN
22	1' - 6"	2' - 0"	HISTORIC WINDOW TO REMAIN
23	2' - 8"	3' - 4"	MARVIN INFINITY FIBERGLASS WINDOW WITH APPLIED EXTERIOR MUTIN
24	2' - 8"	5' - 0"	MARVIN INFINITY FIBERGLASS WINDOW WITH APPLIED EXTERIOR MUTIN
25	2' - 4"	5' - 0"	NEW ALUMINUM CLAD WOOD WINDOW
26	2' - 4"	5' - 0"	NEW ALUMINUM CLAD WOOD WINDOW
27	2' - 4"	5' - 0"	NEW ALUMINUM CLAD WOOD WINDOW
28	2' - 4"	5' - 0"	NEW ALUMINUM CLAD WOOD WINDOW
29	2' - 4"	5' - 0"	NEW ALUMINUM CLAD WOOD WINDOW
30	2' - 4"	5' - 0"	NEW ALUMINUM CLAD WOOD WINDOW
31	2' - 4"	5' - 0"	NEW ALUMINUM CLAD WOOD WINDOW
32	2' - 4"	5' - 0"	NEW ALUMINUM CLAD WOOD WINDOW
33	2' - 4"	5' - 0"	NEW ALUMINUM CLAD WOOD WINDOW
34	2' - 4"	5' - 0"	NEW ALUMINUM CLAD WOOD WINDOW
35	2' - 4"	5' - 0"	NEW ALUMINUM CLAD WOOD WINDOW
36	2' - 4"	5' - 0"	NEW ALUMINUM CLAD WOOD WINDOW
37	1' - 6"	5' - 0"	NEW ALUMINUM CLAD WOOD WINDOW
38	1' - 6"	5' - 0"	NEW ALUMINUM CLAD WOOD WINDOW
39	1' - 6"	5' - 0"	NEW ALUMINUM CLAD WOOD WINDOW
40	1' - 6"	5' - 0"	NEW ALUMINUM CLAD WOOD WINDOW
41	2' - 0"	5' - 0"	MARVIN INFINITY FIBERGLASS WINDOW WITH APPLIED EXTERIOR MUTIN
42	2' - 8"	5' - 0"	MARVIN INFINITY FIBERGLASS WINDOW WITH APPLIED EXTERIOR MUTIN
43	2' - 0"	5' - 0"	MARVIN INFINITY FIBERGLASS WINDOW WITH APPLIED EXTERIOR MUTIN
44	2' - 0"	3' - 0"	MARVIN INFINITY FIBERGLASS WINDOW WITH APPLIED EXTERIOR MUTIN
45	2' - 8"	6' - 6"	HISTORIC WINDOW TO REMAIN
46	1' - 6"	6' - 6"	HISTORIC WINDOW TO REMAIN
47	1' - 6"	6' - 6"	HISTORIC WINDOW TO REMAIN
48	2' - 8"	3' - 4"	MARVIN INFINITY FIBERGLASS WINDOW WITH APPLIED EXTERIOR MUTIN
49	2' - 8"	3' - 4"	MARVIN INFINITY FIBERGLASS WINDOW WITH APPLIED EXTERIOR MUTIN
50	2' - 8"	3' - 4"	MARVIN INFINITY FIBERGLASS WINDOW WITH APPLIED EXTERIOR MUTIN
51	2' - 8"	3' - 4"	MARVIN INFINITY FIBERGLASS WINDOW WITH APPLIED EXTERIOR MUTIN
52	2' - 8"	3' - 4"	MARVIN INFINITY FIBERGLASS WINDOW WITH APPLIED EXTERIOR MUTIN
53	2' - 8"	3' - 4"	MARVIN INFINITY FIBERGLASS WINDOW WITH APPLIED EXTERIOR MUTIN
54	2' - 8"	3' - 4"	MARVIN INFINITY FIBERGLASS WINDOW WITH APPLIED EXTERIOR MUTIN
55	2' - 8"	5' - 0"	MARVIN INFINITY FIBERGLASS WINDOW WITH APPLIED EXTERIOR MUTIN
56	2' - 8"	5' - 0"	MARVIN INFINITY FIBERGLASS WINDOW WITH APPLIED EXTERIOR MUTIN
57	2' - 8"	4' - 0"	HISTORIC WINDOW TO REMAIN
58	2' - 8"	4' - 0"	HISTORIC WINDOW TO REMAIN
59	2' - 8"	4' - 0"	HISTORIC WINDOW TO REMAIN
60	2' - 8"	4' - 0"	HISTORIC WINDOW TO REMAIN

# J. Kaltz & Co.

730 East Nine Mile Rd.  
Ferndale, MI 48220  
1-800-466-8800  
Fax: 248-541-5231

3987 Brockton Dr., SE • Ste. C  
Kentwood, MI 49512  
1-800-466-6070  
Fax: 616-942-7627

www.jkaltzco.com

## PORCH AS OF AUG. 2015

2011 LONGFELLOW  
05 AUG. '22

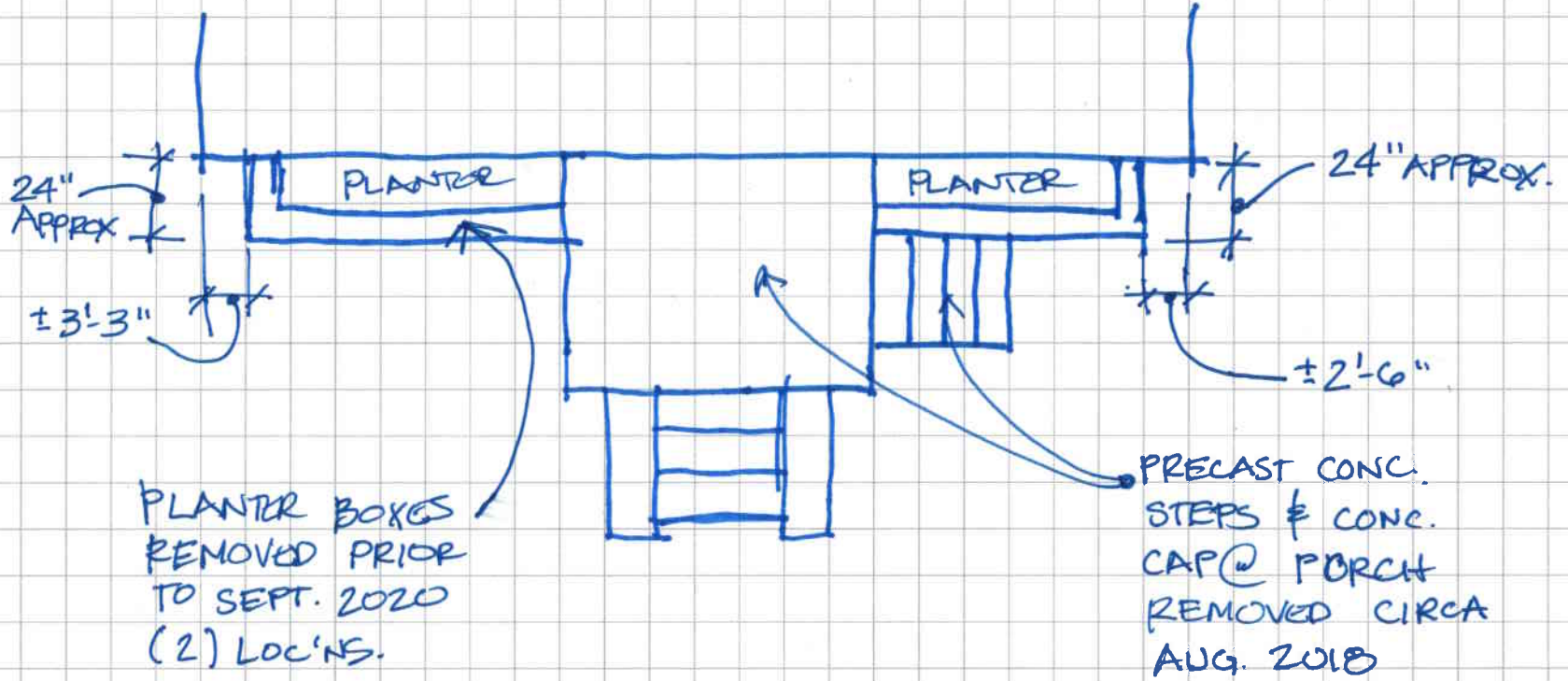

# J. Kaltz & Co.

730 East Nine Mile Rd.  
Ferndale, MI 48220  
1-800-466-8800  
Fax: 248-541-5231

3987 Brockton Dr., SE • Ste. C  
Kentwood, MI 49512  
1-800-466-6070  
Fax: 616-942-7627

www.jkaltzco.com

SUB

## EXISTING CONDITIONS

2011 LONGFELLOW  
05 AUG. '22

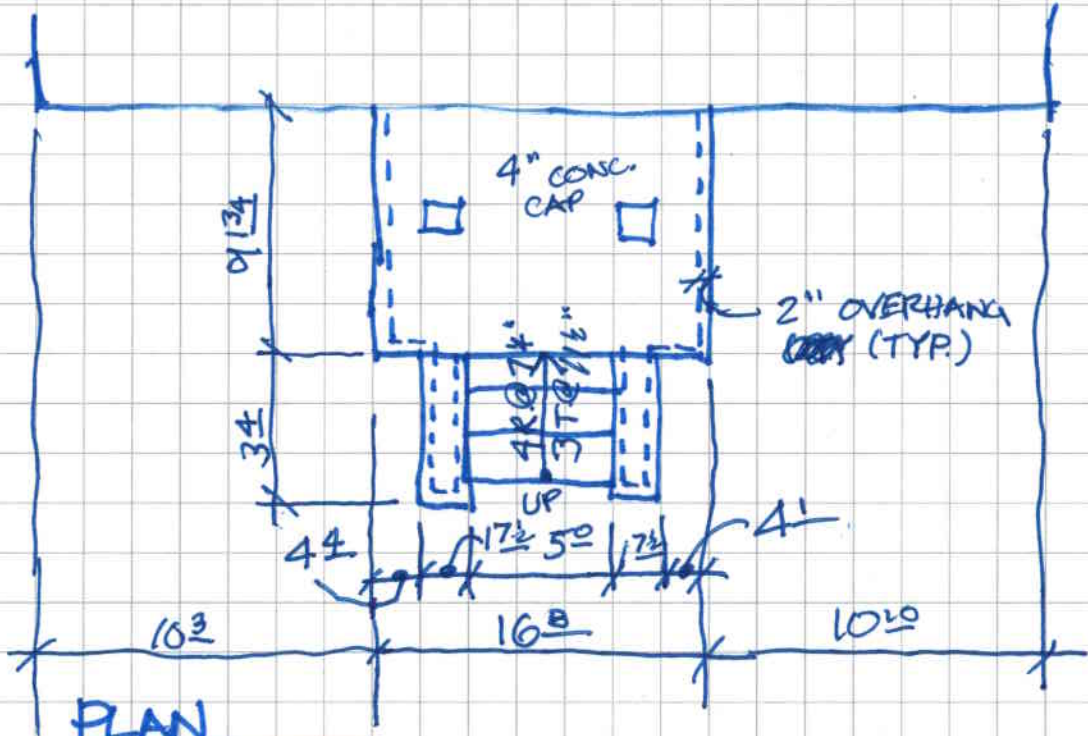

PLAN  
N.T.S.

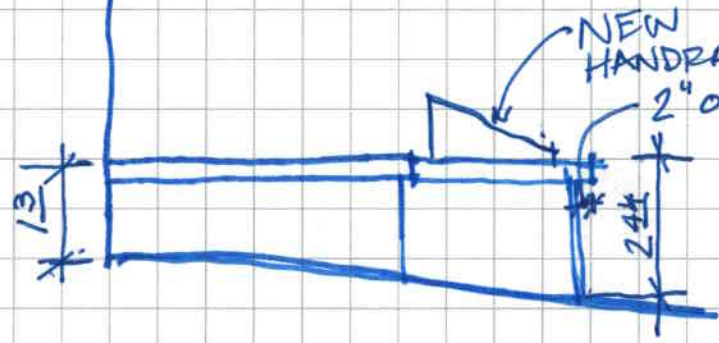

EAST ELEV'N.  
N.T.S.

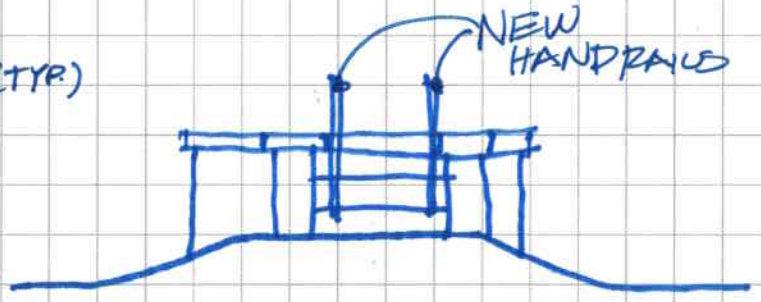

NORTH ELEV'N  
N.T.S.





Tools & Home Improvement > Building Supplies > Building Materials > Decking & Fencing > Railings & Pickets > Railings

**Purchased 2 times.**  
Last purchased Jul 24, 2022  
Size: 2FT | Color: Black | [View order](#)

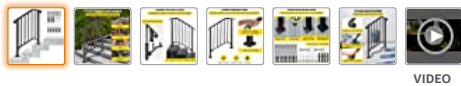

### Happybuy Handrails for Outdoor Steps, Fit 2 or 3 Steps Outdoor Stair Railing, Picket#2 Wrought Iron Handrail, Flexible Porch Railing, Black Transitional Handrails for Concrete Steps or Wooden Stairs

[Visit the Happybuy Store](#)  
616 ratings  
87 answered questions

List Price: ~~\$132.02~~  
Price: **\$120.92**  
FREE Returns  
You Save: **\$11.10 (8%)**

Buy more, save more:  
2 units **\$115.92** Save 12%  
5 units **\$111.92** Save 15% **LOWEST PRICE**

**Earn 5% Back** on this purchase when you pay with your **Amazon Business Prime American Express Card**.  
Eligible Prime membership required. Terms and cap apply.  
May be available at a lower price from **other sellers**, potentially without free Prime shipping.

Size: **2FT**  
1FT **2FT** 3 Feet 4FT

Color: **Black**

**Brand** Happybuy  
**Material** Iron  
**Color** Black  
**Item** 52 x 35 x 3 inches  
**Dimensions** LxWxH  
**Finish Type** Powder Coated

#### About this item

**\$120.92**

FREE Returns

FREE delivery **Friday, October 7.**  
Order within **10 hrs**

Deliver to Huapi - Grosse Point...  
48236

**In Stock.**

Quantity: **1**

Buying in bulk?

**Add to Cart**

Secure transaction

Sold by Amazon and Fulfilled by Amazon.

Return policy: **Eligible for Return, Refund or Replacement within 30 days of receipt**

**Shows what's inside.** Item often ships in manufacturer container to reduce packaging. If this is a gift, consider shipping to a different address.

**Add a Protection Plan:**  
 3-Year Protection for **\$25.40**  
 Add a gift receipt for easy returns

**Add to List**

New & Open Box (3) from **\$116.08**

**Other Sellers on Amazon**  
**\$159.99** **Add to Cart**  
& **FREE Shipping**  
Sold by: LOVSHARE

Have one to sell?

Sell on Amazon

- **[FOR 2 OR 3 STEPS]** - One Picket#2 Handrail for 2 or 3 steps. Intended to Span 2 Stair Risers – Measures 2 foot Post to Post (Unadjustable).
- **[REAL WROUGHT IRON]** - This handrail is constructed with real wrought iron that is durable and rustproof.
- **[EASILY SET UP & CLEAN]** - This kit includes everything you will need to attach the handrail to your concrete steps. Also, easy to clean for its powder coating surface.
- **[STEADY & DELICATE DESIGN]** - Designed with powder coating technology, it is constructed with stylish matte black. The handrail is strongly connected and welded.
- **[WIDE APPLICATION]** - Widely used for gardens, residential buildings, commercial office buildings, hotels, etc.

> See more product details



Serving low prices with virtual cooking lessons  
Amazon Explore [Browse now](#)

## How to Refinish Deck Railings

Items Recommended by This Old House



This Old House

Earns commissions

Duration: 2+ hours

Difficulty: Easy to moderate

[View full article](#)



FROGTAPE 240661 Multi-Surface Painter's Tape wi...

15,609

\$25.34



AmazonCommercial Plastic sheeting - 10x25ft - 6 Mi...

1,950

\$21.99



All Purpose Canvas Drop Cloth by CCS CHICAGO C...

9,656

\$17.95

## 4 stars and above

Page 1 of 26

Sponsored



CHR 5 Steps Outdoor Hand Rails for Steps, Black Wrought Iron Handrail Kit (4-5 Step...

579

#1 Best Seller  
**\$127.23**

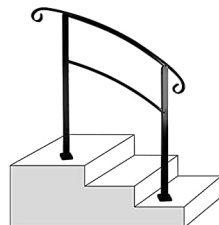

Cocopark High Quality 3-Step Adjustable Wrought Iron Handrail Railing Stair Rail fo...

98

**\$128.00**  
Save 5% with coupon



Metty Metal Outdoor Stair Railing, White Handrails for Outdoor Steps 2 Step Handrail...

252

**\$98.89**

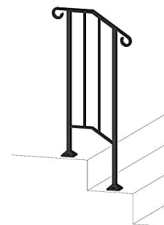

Iron X Handrail Picket #1 (Concrete Steps)

118

**\$348.00**



Handrails for Outdoor Steps, 3 Step Handrail Fits 1 to 3 Steps Mattle Wrought Iron H...

550

**\$99.99**  
\$94.99 with quantity discounts

## Customers frequently viewed

Page 1 of 20

Sponsored | Popular products in the last 7 days



CHR 5 Steps Outdoor Hand Rails for Steps, Black Wrought Iron Handrail Kit (4-5 Step...

579

#1 Best Seller

\$127.23



Happybuy 3-Step Transitional Handrail Fits 1 or 3 Steps Matte Stair Rail Wrought Ir...

38

Amazon's Choice

Decking Railings  
\$69.99



Metty Metal Outdoor Stair Railing, White Handrails for Outdoor Steps 2 Step Handrail...

252

\$98.89



Handrails for Outdoor Steps 3Ft Stair Handrail, Outdoor Stair Railing Fits 1 to 3...

501

\$93.07

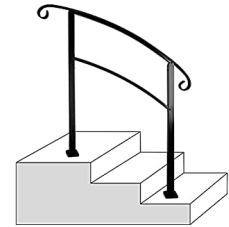

Cocopark High Quality 3-Step Adjustable Wrought Iron Handrail Railing Stair Rail fo...

98

\$128.00

Save 5% with coupon

### Special offers and product promotions

- [Amazon Business](#): Save time and money with your Amazon Business account. [Sign in now to see business-only prices.](#)

### Product Description

# VEVOR®

TOUGH EQUIPMENT & TOOLS, PAY LESS

## VEVOR®

# WROUGHT IRON HANDRAIL

Fit for 2 or 3 Steps  
Real Iron Material





# VEVOR<sup>®</sup>

## Features:



### Fit 2 to 3 Steps

As a great helper for your family members to go up and down the stairs, this wrought iron handrail fits 2 or 3 steps. It spans max 3 stair risers and measures 28"/71 cm post to post.

## Features:



### Flexible Height

With screws connection, this outdoor stair railing is height changeable to suit steps of different sizes. The max height for stairs is 14.6"/37 cm, flexible to meet your various needs.



### Real Wrought Iron

Our front porch hand rail is constructed with real wrought iron, ensuring it is rustproof and corrosion-proof. As a result, the handrail keeps a long lifespan under various weather conditions.

### EASY TO ASSEMBLE

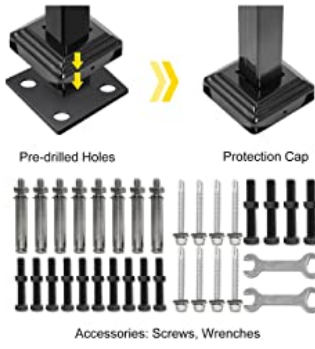

### Easy to Assemble

The handrails for concrete steps kit includes everything you need to attach the rails and posts to the stairs. It is simple to install and complete.

### ELEGANT & FASHION STYLE



### Elegant & Fashion Style

Designed with a powder coating surface, the railings for steps are easy to maintain and clean. The stylish and elegant appearance provides

### VERSATILE USES



### Versatile Uses

The outdoor railing for steps is suitable for home, garden, hotel, porch, and other places with stairs or steps. It serves as a support to improve security

Suggested Height:  
11.8 in / 30 cm  
Max Height:  
14.6 in / 37 cm

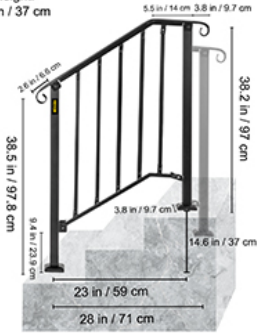

### Package Content

- 1 x Handrail
- 10 x M6 Bolts
- 4 x M8 Bolts



4 or 5 Steps



3 or 4 Steps



2 or 3 Steps



2 or 3 Steps



1 or 2 Steps



3 Steps

Material:	Real Iron Metal	Real Iron Metal	Real Iron Metal	Real Iron Metal	Real Iron Metal	Stainless Steel
Size:	4 or 5 Steps	3 or 4 Steps	2 or 3 Steps	2 or 3 Steps	1 or 2 Steps	3 Steps
Color:	Black	Black	Black	Black	Black	Black
	✓	✓	✓	✓	✓	✓
	✓	✓	✓	✓	✓	✓
	✓	✓	✓	✓	✓	✓
	✓	✓	✓	✓	✓	✓
	✓	✓	✓	✓	✓	✓

## Compare with similar items



**This item:**  
Happybuy Handrails for Outdoor Steps, Fit 2 or 3 Steps Outdoor Stair Railing, Picket#2 Wrought Iron Handrail, Flexible Porch Railing, Black Transitional Handrails for Concrete Steps or Wooden Stairs

\$120<sup>92</sup>

(616)

Add to Cart



SPACEUP Step Handrail Fit for 2 or 3 Steps Wrought Iron Handrail for Outdoor Steps Matte Black Stair Railings with Installation Kit

\$179<sup>99</sup>

(55)

Add to Cart



VEVOR Handrails for Outdoor Steps, Fit 3 or 4 Steps Outdoor Stair Railing, Picket#3 Wrought Iron Handrail, Flexible Porch Railing, White Transitional Handrails for Concrete Steps or Wooden Stairs

\$163<sup>13</sup>

(40)

Add to Cart



CHR Outdoor 3 Steps Handrail - Black Wrought Iron Handrail Kit (2-3 Step, Handrail)

#1 Best Seller

\$99<sup>97</sup>

(580)

Add to Cart



VEVOR Outdoor Stair Railing, Fits for 1-5 Steps Transitional Wrought Iron Handrail, Adjustable Exterior Stair Railing with Fence, Handrails for Concrete Steps with Installation Kit, Matte Black

\$149<sup>98</sup>

(26)

Add to Cart



VEVOR Outdoor Stair Railing, Fit 1 or 2 Steps Alloy Metal Handrail, Front Porch Flexible Transitional Handrail, Picket Step Rail with Installation Kit, for Concrete or Wooden Stairs, Black

\$89<sup>99</sup>

(14)

Add to Cart

Compare differences

Options

Sold By

Amazon

SPACEUP

Amazon.com

CR Handrail

tuorren

Amazon

Quantity discounts

See all discounts

—

—

—

—

See all discounts

Exclusive discounts offered to business customers who buy multiple units.

Color

Black

2-3 Step Railing

White

Handrail

Black

Black

Material

Iron

Wrought Iron

Iron

Metal

Wrought Iron

Stainless Steel, Wood

Size

2FT

2Ft

3 or 4 Steps

3 Steps

—

—

## Product information

Technical Details

Additional Information

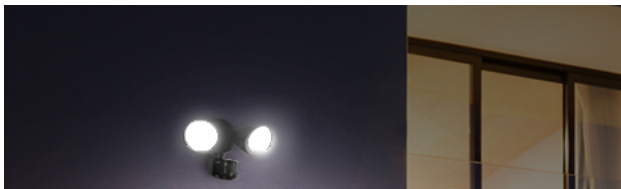

# LUTEC

Light Your Way Home

Founded in 1972

## Product Description

LIGHT YOUR WAY HOME

- 40+ years of history
- 800+ products patents worldwide
- 150+ countries covered
- 30+ brand agents worldwide
- 9 times design awards
- 9 design teams worldwide
- 5 factories worldwide
- 4 central warehouse worldwide

European Brand





German Designer Director  
Mr. Jeremy Morgan

WON AWARD FOR  
IF Design Award and Reddot

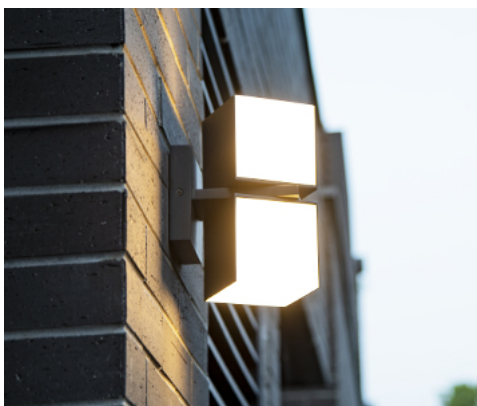

reddot award 2021  
winner





**LUTEC**

**REDDOT AWARD WINNER**

BRINGS YOU THE PEACE AND DELIGHT OF NIGHTTIME

LED rubik's cube wall lamp  
Two moveable heads  
Energy efficiency&long lasting

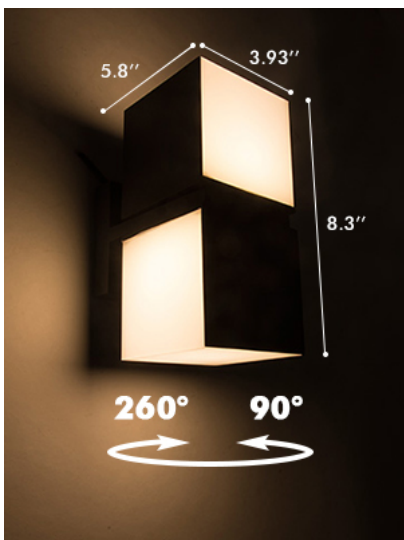

# LUTEC

### About LUTEC

LUTEC is a brand of the company Ningbo Utec, established in 1972. LUTEC is one of China's leading vertical integrated manufacturers of premium outdoor lighting and one of the world's leading producers of high quality affordable lighting. The name LUTEC is a quick and simplified way to say: "we at LUTEC, know how to design Lighting that is relevant for U and embrace our TECHNICAL background." The LUTEC brand provides the basis for a strong international network in outdoor lighting.

MEIUM EXTERIOR COASTAL WITH CLEAR PC



**ROTATABLE HEADS**  
The 2 light heads can be rotated over 350°, resulting in up-down or side light effects.



**4 GLOWING SURFACES**  
The wall light has 4 glowing surfaces which can provide multi-directional lighting to accentuate your indoor and outdoor places.



**INTERGRATED LED WALL LIGHT**  
Led integrated, You no longer need to change bulbs! We promise 5 years service for your rights and interests.

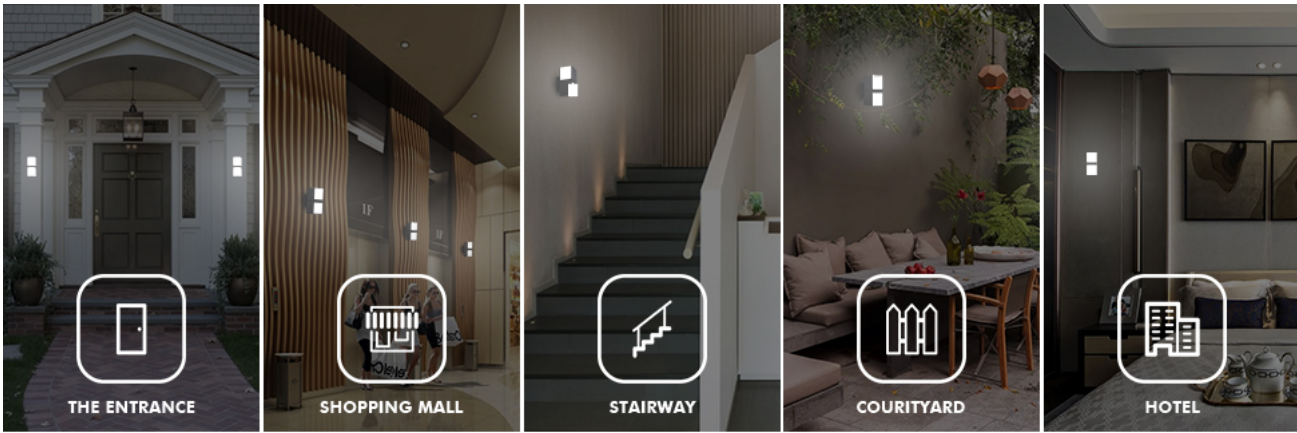



## Product information

### Technical Details

Brand	LUTEC
Color	Black
Material	Aluminum, Polycarbonate
Style	Modern
Light fixture form	Sconce
Room Type	Bedroom
Indoor/Outdoor Usage	Outdoor, Indoor
Power Source	Corded-electric
Product Dimensions	5.8"L x 3.93"W x 8.3"H
Light Source Type	LED
Shade Material	Aluminum
Shape	Square
Included Components	LED Lens
Light Direction	Adjustable
Item Package Quantity	1
Wattage	23 watts
Manufacturer	LUTEC
Part Number	1
Item Weight	3.54 pounds
Package Dimensions	9.21 x 6.22 x 4.61 inches
Country of Origin	China
Item model number	amzn.gr.5193805012-6PFYrD7ODnwHwkLJHN-LN
Switch Installation Type	Surfaces,Wall Mount
Batteries Required?	No
Luminous Flux	1100 Lumen
Color Temperature	3000 Kelvin

### Additional Information

ASIN	B08R8KKZVK
UNSPSC Code	39110000
Customer Reviews	<a href="#">1,288 ratings</a> 4.6 out of 5 stars
Best Sellers Rank	#17,079 in Patio, Lawn & Garden (See <a href="#">Top 100 in Patio, Lawn &amp; Garden</a> ) #79 in Wall Sconces #143 in Patio Wall Light Fixture #2,199 in Outdoor Décorative Lighting
Date First Available	December 24, 2020

### Warranty & Support

**Product Warranty:** For warranty information about this product, please [click here](#)







### Feedback

Would you like to [tell us about a lower price?](#)

## Related products with free delivery

Page 1 of 55

Sponsored ⓘ

 <p>LED Wall Pack Light 25W, 3000Lm 5000K Daylight (Dusk to Dawn Photocell Included) ET...</p> <p>128</p> <p><b>\$24.99</b></p>	 <p>LMP 4 Pack LED Square Up and Down Lights Outdoor Wall Light, Body in Aluminum Waterp...</p> <p>3,115</p> <p><b>\$118.40</b> (\$29.60/Count)</p>	 <p>LED Outdoor Wall Light, 3 Color Changing Outdoor Wall Sconce, Waterproof 8W Porch L...</p> <p>18</p> <p><b>\$53.50</b></p>	 <p>DAKAFUL LED Up and Down Lights Outdoor Wall Sconce, 2Pack Integrated Square outdoor...</p> <p>109</p> <p><b>\$56.99</b> (\$28.50/Count)</p>	 <p>LUTEC 1000 Lumen 3000K 45 LED Wall Light Dusk to Dawn, Modern Porch Light with Seed...</p> <p>1,157</p> <p><b>\$68.87</b></p>	 <p>LMP Du Outdoor Down \ Porch L</p> <p><b>\$89.9</b></p>
--	--	---	---	--	---



# Window Replacement Guide

INFINITY<sup>®</sup>

from MARVIN<sup>®</sup>

REPLACEMENT WINDOWS

*Built for life<sup>®</sup>*

# Get expert guidance

Depending on the age and style of your home, Infinity offers two window replacement methods. Your local Infinity partner will help you determine the best solution for your home, including addressing any concerns about water or structural damage. Both methods are designed for maximum efficiency and minimal disruption to your home.

### Insert replacement

With insert window replacement, new windows are easily installed into the existing frame. This is generally a quicker replacement solution because the existing trim and siding are not replaced.

### Full-frame replacement

Full-frame replacement requires taking out the existing damaged frame and trim. This window installation method offers the possibility of replacing your existing window with an entirely new style or larger window.



DOUBLE AND SINGLE HUNG



SLIDER



CASEMENT



AWNING

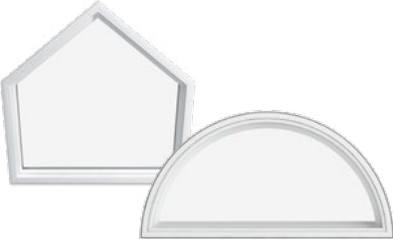

SPECIALTY SHAPES AND ROUND TOPS

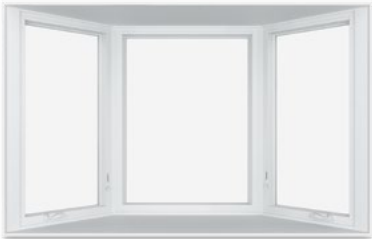

BAY



BOW

## Infinity Double Hung

### Unit Features

Infinity Double Hung: NDH

Infinity Double Hung Transom: NDHTR

Infinity Double Hung Picture: NDHP

#### Ultrex® Pultruded Fiberglass Frame:

- Frame thickness: 31/32" (25) head jamb, 31/32" (25), side jamb, 25/32" (20) sill, flat bottom sill with 8 degree bevel
- Frame depth: 2 7/8" (73)
- Exterior colors: Stone White, Sierra, Cashmere, Pebble Gray, Bahama Brown, Bronze, Ebony
- Interior colors: Stone White, Sierra, Ebony, Bronze, EverWood™

#### Ultrex® Pultruded Fiberglass Sash:

- Sash thickness: 1 3/8" (35)
- Different sash option allows unequal sash heights, unique lite cuts for each sash or different glazing in each sash
- Operable sash tilts to interior for cleaning or removal
- Sash are replaceable but cannot be re-glazed
- Exterior colors: Stone White, Sierra, Cashmere, Pebble Gray, Bahama Brown, Bronze, Ebony
- Interior colors: Stone White, Sierra, Ebony, Bronze, EverWood™

#### Hardware:

- Lock and keeper:
  - Mounted at the center of the top check rail or 12" (305) on center from either end on dual lock unit
  - Zinc die-cast
- Sash lift:
  - Factory drilled for a bottom sash lift
  - Single lock units receive single lift; dual locks unit receive double lifts
  - Zinc die-cast
- Balance system:
  - Coil spring block and tackle with nylon cord and fiber filled nylon clutch
  - Allows the sash to raise or lower from desired position
- Bottom sash tilt latches:
  - Spring loaded tilt latches attached to upper corners of sash and operated with a button on the lock for easy tilting and sash removal
  - Tilt latches are mounted to the window stile and hidden under the check rail cover for a clean look
- Top sash tilt latches:
  - Spring loaded tilt latches attached to upper corners of sash
  - Injection molded nylon - white, black or beige
  - Hidden from view in the frame header when window is closed
- Top sash hanger (fixed upper sash only):
  - Attached to the frame securing the top sash making it stationary
  - Metal stamped
  - Color: white or black
- Optional factory applied Window Opening Control Device
  - Available on all operable units
  - Color: white, black or beige
  - This device works in accordance to ASMT F2090-17 Standard Specification for Window Fall Prevention Devices with Emergency Escape (Egress) Release Mechanisms.

#### Weather Strip:

- Frame:
  - Jamb: foam filled bulb with flexible TPE skin
    - Color: white, black or beige
  - Parting stop: PVC with flexible hinged wand seal
    - Color: white, black or beige
- Sash:
  - Bottom sash: white, black or beige hollow foam bulb type
  - Check rail: white, black or beige, PVC with flexible hinged wand seal
- Stationary units:
  - Continuous, foam weather strip at perimeter of sash
  - Color: White, Black or Beige

## Unit Features

### Insect Screens:

- Full screen
- Optional half screen
- Extruded aluminum frame: 0.050" wall thickness
- Standard screen mesh material: charcoal fiberglass
- Optional screen mesh material: high transparency screen
- Corners are mitered and joined with an internal corner key, which are not visible
- Friction fit pins are integrated into the side of the screen
- Frame color: matches exterior frame color

### Glass:

- Glazing seal: silicone bedding on interior and exterior
- Standard glass is insulating Low E2 with Argon or air
- Optional glazing available: Low E1 with Argon or air, Low E3 with Argon or air, or Low E3/ERS with Argon or air, tempered, obscure
- Decorative glass options include Glue Chip, Rain, Reed, Narrow Reed, or Frost
- Decorative glass is not available with Low E1, Low E3/ERS, or STC/OITC
- Rain, Reed and Narrow Reed not available with SDL
- SDL available on Frost, annealed or tempered glass
- SDL available on Glue Chip, tempered glass required
- Insulating glass will be altitude adjusted with capillary tubes for higher elevations
- Argon gas is not available for elevations that require capillary tubes

### Simulated Divided Lites (SDL):

- 7/8" (22) or 1 1/8" (29) SDL bar (interior and exterior)
- 2 11/32" (30) simulated rail only (interior and exterior)
- Exterior color: matched to unit exterior
- Interior color: matched to interior
- Pattern: equal rectangular, cottage, prairie, check rail and oriel

### Gilles-Between-the-Glass (GBG):

- 23/32" (18) or 1" (25) contoured aluminum bar
- Exterior: Customer selection option available. All exterior color options.
- The exterior GBG color is designed to best match the unit exterior color when used with Low E glass. The use of different types of glazing options may alter the exterior GBG color appearance
- Interior color: White, Satin Taupe, Sierra, Bronze and Ebony
- Pattern: equal rectangular, cottage, prairie, check rail and oriel
- GBG's are not available with dual 4.7mm glass panes. Refer to OMS for availability.

*NOTE: GBG may not be available or may require tempered glass if the glass size is greater than 16 square feet or if the short side dimension is greater than 48". Please contact your local Infinity Retailer or Infinity Support at 800-372-1072 to determine if GBG is available for glass sizes exceeding these dimensions.*

# Infinity Double Hung

## Lite Options

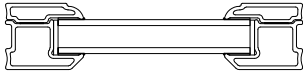

Insulating Glass

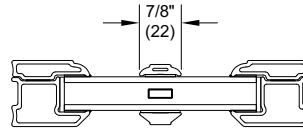

Insulating Glass  
7/8" SDL w/ spacer bar

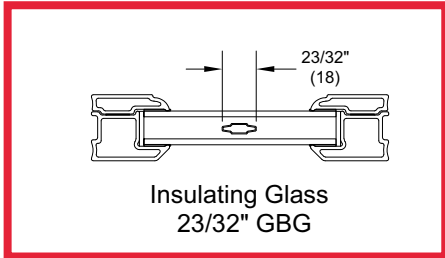

Insulating Glass  
23/32" GBG

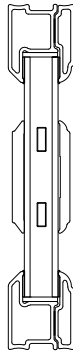

Insulating Glass  
SDL Simulated Rail  
w/spacer bar

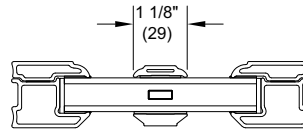

Insulating Glass  
1 1/8" SDL w/ spacer bar

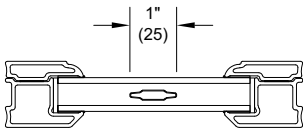

Insulating Glass  
1" GBG

**Minimum and Maximum Guidelines**

Minimum and Maximum Frame Size Guidelines - Standard Size												
Unit Type		Minimum Frame Size				Maximum Frame Size				Maximum Glass		
		Width		Height		Width		Height				
		in	mm	in	mm	in	mm	in	mm	Sash Size	Sq. Feet	Sq. Meters
NDH	Equal Sash	14 3/8	(365)	25 5/8	(651)	48	(1219)	96	(2438)	regular	13 45/64	1.27
NDH	Cottage Style	14 3/8	(365)	30 1/8	(765)	48	(1219)	72	(1829)	small	8 3/64	0.75
										large	13 27/64	1.25
NDH	Oriel Style	14 3/8	(365)	30 1/8	(765)	48	(1219)	96	(2438)	small	10 31/32	1.02
										large	18 9/32	1.70
NDHP NDHTR	Picture Transom	18	(457)	16 3/8	(416)	75	(1905)	75	(1905)	regular	30	2.79

Minimum and Maximum Frame Size Guidelines - Expanded Size												
Unit Type		Minimum Frame Size				Maximum Frame Size				Maximum Glass		
		Width		Height		Width		Height				
		in	mm	in	mm	in	mm	in	mm	Sash Size	Sq. Feet	Sq. Meters
NDH	Equal Sash	48 1/32	(1220)	25 5/8	(651)	54	(1372)	85	(2159)	regular	13 11/16	1.27
NDH	Cottage Style	48 1/32	(1220)	30 1/8	(765)	54	(1372)	60	(1524)	small	7 1/2	0.70
										large	12 1/2	1.16
NDH	Oriel Style	48 1/32	(1220)	30 1/8	(765)	54	(1372)	85	(2159)	small	10 15/16	1.02
										large	18 1/4	1.70

*NOTE: Fixed upper sash required on certain sizes. Contact Infinity Support for more information.*

*For Glue Chip and Frost, maximum short frame side is 63 1/4".*

*For Rain, Reed and Narrow Reed, vertical pattern orientation maximum frame width size 63 1/4".*

*For Reed and Narrow Reed, horizontal pattern orientation maximum sash height 61 1/8" for operating unit, 63 1/4" for transom and picture units.*

*Tempered glass may be required if the glass size is greater than 23 square feet. Please contact your local Infinity Retailer or Infinity Support at 800-372-1072 to determine available glass options on units exceeding this size.*

*Infinity Double Hung*

**Certified Sizes and Ratings**

Product	Air Tested to psf	Water Tested to psf	Design Pressure (DP)	Certification Rating	Max Overall Width		Max Overall Height	
					in	mm	in	mm
Infinity Double Hung	1.57	3.76	25	LC-PG25-H	54	(1372)	85	(2159)
Infinity Double Hung	1.57	4.6	30	LC-PG30-H	48	(1219)	96	(2438)
Infinity Double Hung Picture	1.57	4.5	30	LC-PG30-FW	72	(1829)	72	(1829)
	1.57	4.5	30	LC-PG30-FW	60	(1524)	75	(1905)
	1.57	4.5	25	LC-PG25-FW	75	(1905)	75	(1905)



## Infinity Double Hung

### STC/OITC Glass Values

STC/OITC ratings are shown in the chart below. Infinity's STC/OITC values are provided by third party ASTM testing and reports. The STC/OITC Upgrade option incorporates variable glass thickness or laminate (L) to increase STC/OITC performance and improve sound abatement.

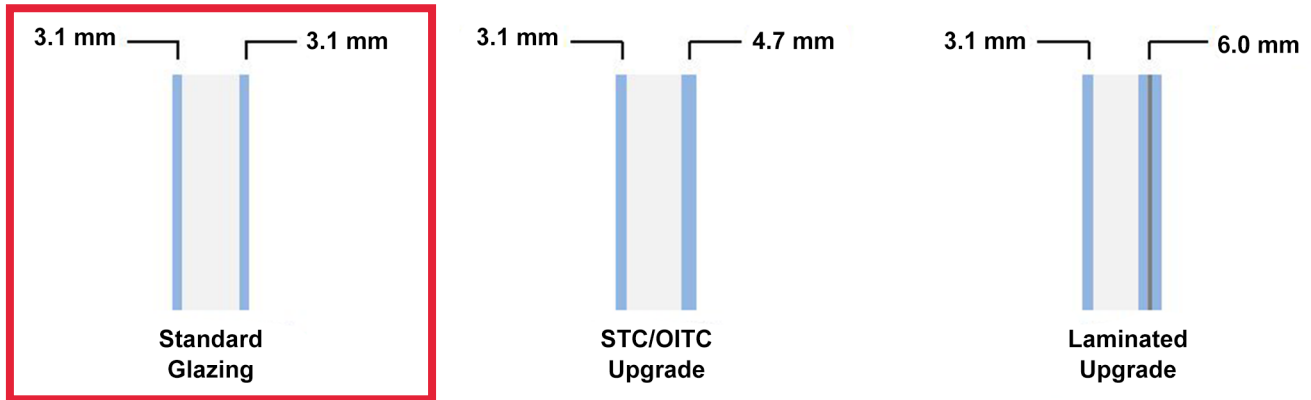

Product Type	Exterior Glazing	Airspace	Interior Glazing	STC	OITC
Full Frame Double Hung	1/8" (3.1)	15/32" (11.5)	1/8" (3.1)	26	22
	1/8" (3.1)	3/8" (9.8)	3/16" (4.7)	30	26
	1/8" (3.1)	5/16" (8.0)	1/4" (6.0L)	32	27
Full Frame Double Hung Picture	1/8" (3.1)	15/32" (11.5)	1/8" (3.1)	28	25
	1/8" (3.1)	3/8" (9.8)	3/16" (4.7)	31	27
	1/8" (3.1)	5/16" (8.0)	1/4" (6.0L)	33	28

*Infinity Double Hung*

**Section Details: Operator**

Scale: 3" = 1' 0"

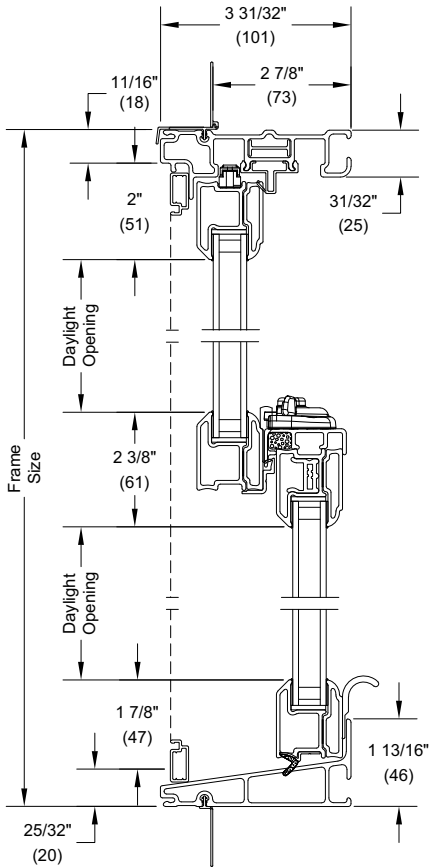

**Head Jamb and Sill  
NDH w/ Full Screen**

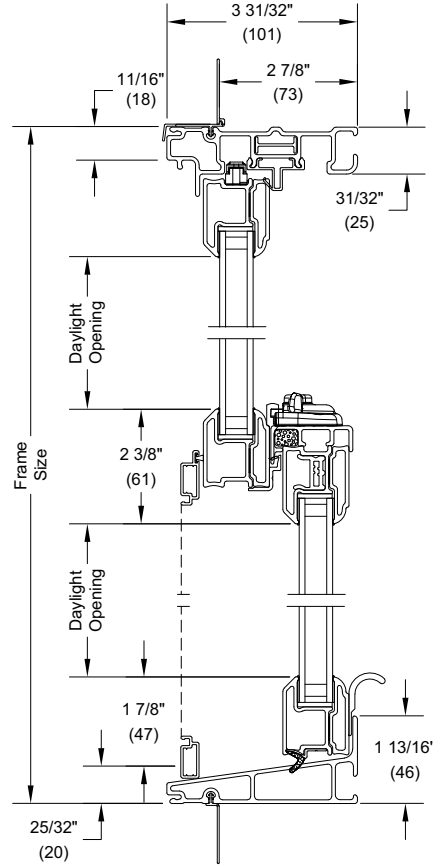

**Head Jamb and Sill  
NDH w/ Half Screen**

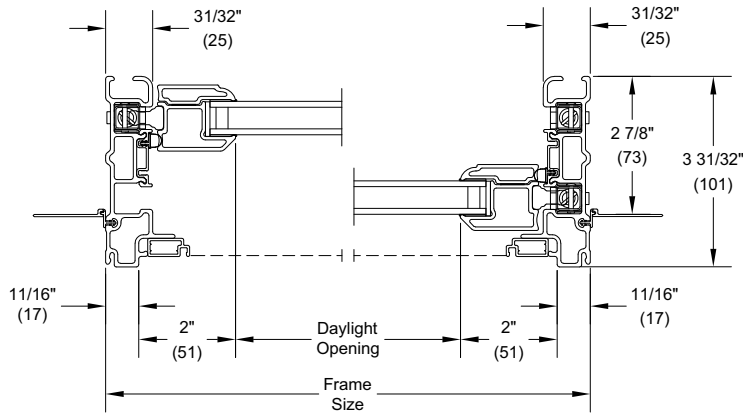

**Jamb**

*Infinity Double Hung*

**Section Details: Picture/Transom**

Scale: 3" = 1' 0"

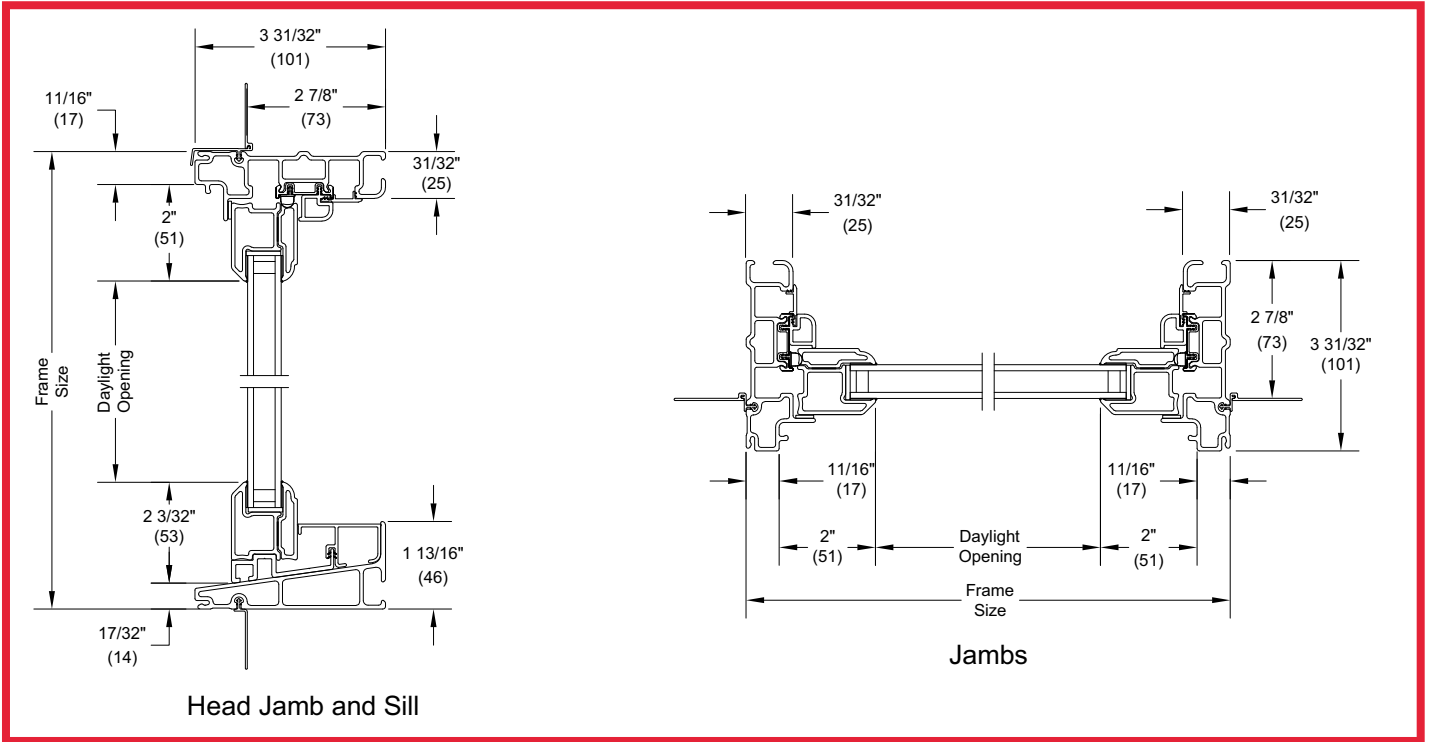



# Wood Grille Profiles

Please contact us toll free at  
855-318-5022 or  
orders@bigbluewindow.com  
for additional help.

## 7/8" Profiles

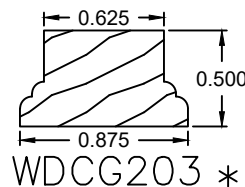
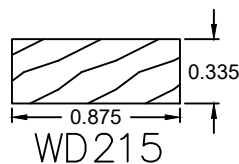
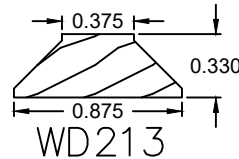
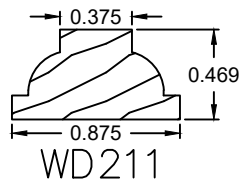
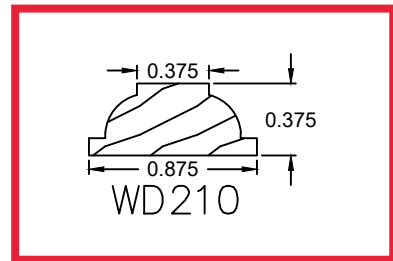
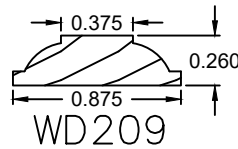
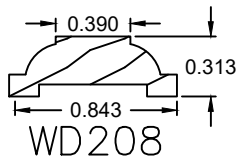
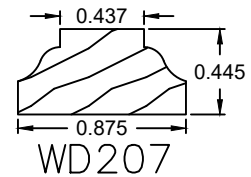
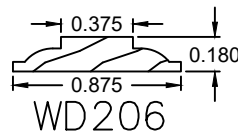
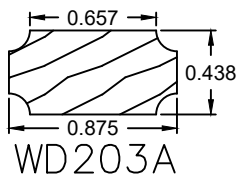

\* Currently no radius bars are available for this profile.

# Fastening Systems

## Concealed Clips



### For use with surround wood grilles

Metal clips that insert between the glass and the glazing bead (interior stop) and reveal a tension-mount clip designed to receive the surround profile of a full surround grille. The clips are completely concealed from view once the grille is installed.

## Push Pins & Grommets



### For use with surround wood grilles

Grommets are pre-drilled and installed into the surround perimeter at the factory. The push pins fit through the grommets. The grille is secured by pushing the pins into the wood sash or glazing bead.

## Slide Pins



### For use with non-surround wood grilles

Slide pins travel in channels that are pre-cut into the ends of each grille bar. The pin is pushed into the wood sash or glazing bead to secure the grille. For interior grilles only.

## 3M™ Dual Lock™

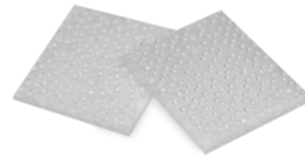

### For use with surround and non-surround wood grilles

Pre-cut interlocking tabs are applied by sticking the tabs to both the grille and glass. Specially designed mushroom heads keep the grille in place.

## Double-Sided Tape



### For use on SDL (Simulated Divided Lite) grilles

The tape is pre-applied to the grilles. The grilles are then applied directly (and permanently) to the glass. *Black only.*

**DOUBLE-SIDED VBH TAPE IS RECOMMENDED - THIS IS WHAT WINDOW MANUFACTURERS USE TO AFFIX SIMULATED DIVIDED LITES TO GLASS**

**Replacement fasteners are available for individual purchase on our website.**



# How to Measure

Please contact us toll free at  
855-318-5022 or  
orders@bigbluewindow.com  
for a additional help.

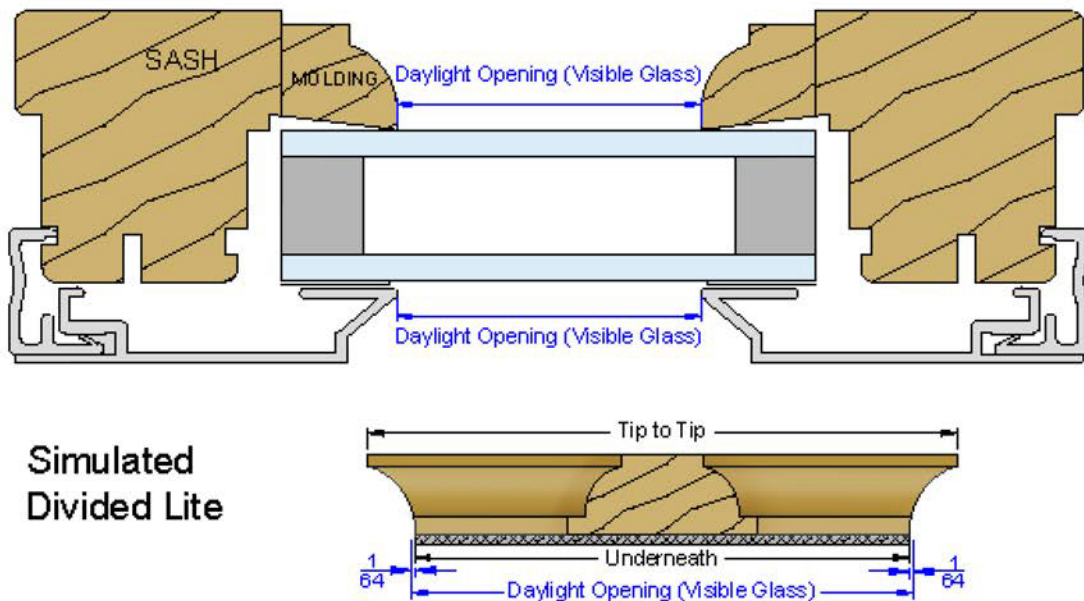

## How to Measure for Simulated Divided Lite (SDL) Grilles

Measurements must be taken on the inside and the outside of the glass.

- To measure **Daylight Opening (DLO)**, measure the visible glass, from stop to stop.
- To measure the **Tip-to-Tip** dimension, measure the longest part of the grille on the top of the profile (the portion that faces outward from the glass).
- To measure the **Underneath** dimension, measure the shortest part of the grille bar, on the bottom of the profile (the portion that touches the glass).

UNLIMITED POSSIBILITIES  
TO CREATE YOUR ORIGINAL

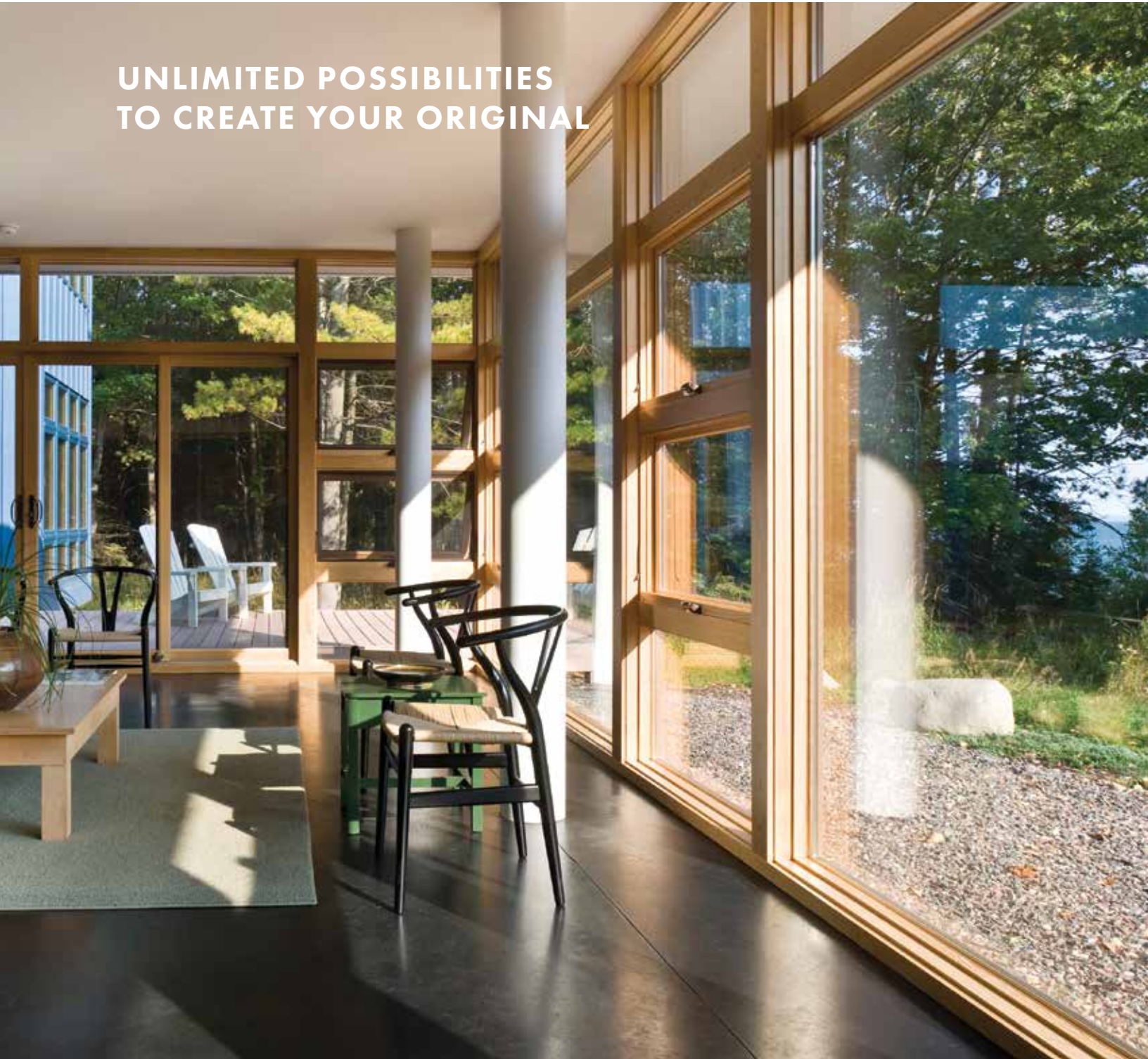

# DO YOU DREAM IN COLOR?

While our large selection of 50 exterior colors covers a lot of ground, inspiration comes in infinite hues. Let us match a paint chip, a photograph or a favorite work of art to bring your dream color into the light of day. Or, choose from a selection of anodized finishes for a rich, lustrous metallic appearance that cannot peel or flake and is not affected by sunlight.\*

## EXTERIOR COLORS



## 7 ANODIZED FINISHES

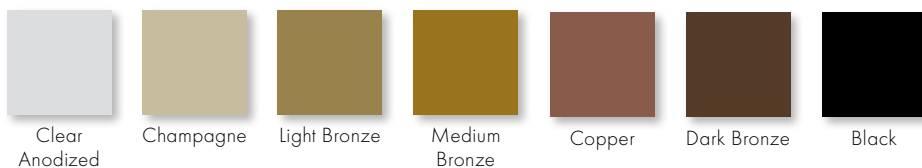

Design your window at  
[andersenwindows.com/design-tool](https://andersenwindows.com/design-tool)

## CUSTOM EXTERIORS OR 2-, 3- AND 4-TONE EXTERIORS

Choose a custom exterior color to get just the right color for your design. And, with our 2-, 3- and 4-tone color combinations, the sky's the limit. Mix and match up to four of our 50 exterior colors for a combination look that's all your own.



Colony white and black

## EXTERIOR TRIM

Choose exterior trim in either a flat casing, brick mould or sill nosing profile to add curb appeal to your home.



2" brick mould and 1 1/2" sill nose, shown on a casement window

\*Visit [andersenwindows.com/warranty](https://andersenwindows.com/warranty) for details. Printing limitations prevent exact color duplication. Please see your Andersen supplier for actual color samples.



# ARCHITECTURALLY AUTHENTIC GRILLES

We offer a variety of grille styles and patterns to choose from, or design your own with varying lines, curves and shapes.

## FULL DIVIDED LIGHT

Features permanent interior and exterior grilles with grille spacer bars between two panes of insulating glass. A traditional divided light look with modern energy efficiency.

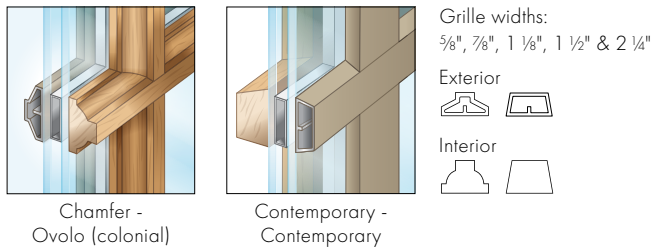

## SIMULATED DIVIDED LIGHT

An economical solution featuring permanent interior and exterior grilles without grille spacer bars.

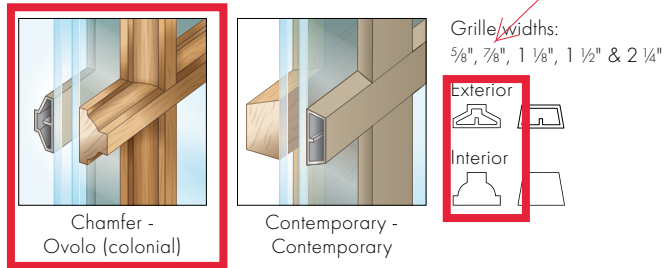

## REMOVABLE INTERIOR WOOD GRILLES

Removable interior wood grilles. Available with optional surround and an optional permanent exterior grille, shown to left below.

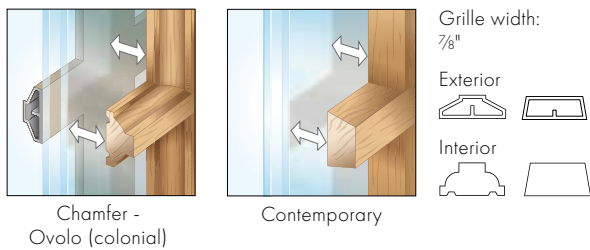

## FINELIGHT™ GRILLES-BETWEEN-THE-GLASS

Aluminum grilles conveniently placed between two panes of glass for easy cleaning inside and out.

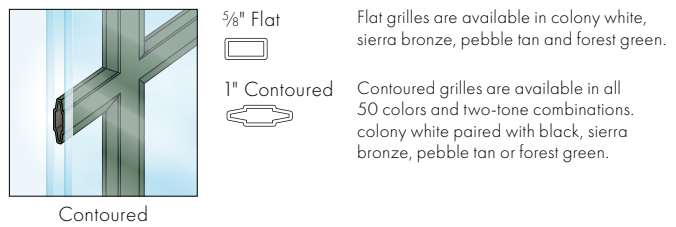

# SCREEN OUT THE INSECTS, NOT THE VIEW

E-Series insect screens let the beauty of the outdoors in, while keeping even small insects out. Choose from a wide selection of insect screen styles, including options that blend seamlessly with your window.

## TRUSCENE® INSECT SCREENS\*

TruScene insect screens for windows are made with a micro-fine stainless steel mesh that offers 50% more clarity than our conventional aluminum mesh insect screens. TruScene insect screens let in 25% more fresh air;† all while keeping out unwanted small insects.

## WOOD VENEER INSECT SCREENS

For a clean appearance, E-Series interior window insect screens can feature a wood veneer to blend into your window.

## RETRACTABLE INSECT SCREENS FOR WINDOWS AND PATIO DOORS

Retractable insect screens for casement and awning windows offer a sleek addition to any home. In place, the insect screen keeps insects out. When retracted, it provides a beautiful clear view.

For patio doors‡, retractable insect screens are built with an innovative color-matched housing that hides the insect screen when not in use. It's there when you need it and gone when you don't.



Retractable insect screen for casement and awning windows.

\*TruScene wood-veneered insect screens utilize a different frame profile than other E-Series wood-veneered insect screens.

\*\*TruScene insect screens let in over 25% more fresh air than standard Andersen fiberglass insect screens.

‡Retractable insect screens are available on hinged inswing, hinged outswing and gliding patio doors. See your Andersen supplier for details.

# THE MARVIN PORTFOLIO

The Marvin portfolio is organized into three product collections, each defined by degree of design detail, flexibility, and customization opportunities.

Curated solutions provide exceptional performance, energy efficiency, low maintenance, and long-lasting quality you can see, feel, and touch.

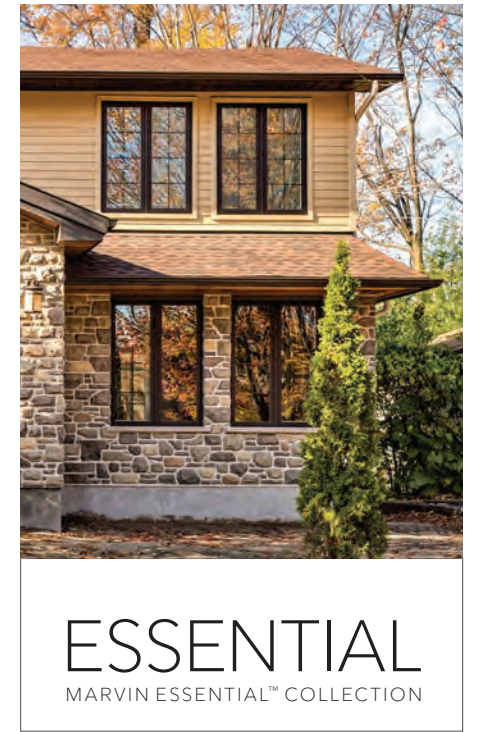

**SIZING**

Custom sized windows and doors built to your home's exact specifications

**DESIGN FLEXIBILITY**

The highest level of design flexibility with the most extensive offering of options

Wide range of design options with prompt delivery for quicker-turn projects

Tailored set of design options with accelerated delivery

**INTERIORS**

Wood interiors with six species options. Factory finish in White or Designer Black paint, six stains, clear coat, or primed for custom painting

Wood interiors. Factory paint in White or Designer Black, bare wood for painting or staining, or clear coat

Low-maintenance fiberglass interiors in White, Ebony, or Bronze

**EXTERIORS**

Long-lasting, low-maintenance exteriors with best-in-class finishes for superior durability

Long-lasting, low-maintenance exteriors with best-in-class finishes for superior durability

Extruded Aluminum (19 colors or custom color) or Wood exteriors (four species)

Extra durable Ultrex® fiberglass exteriors in six color options

**HARDWARE**

Extensive selection of window and door hardware including Gallery Hardware

Window and door hardware in six finish options  
Two door hardware styles

**SCREENS**

Stained/painted wood, or color matched aluminum surrounds

Stainable interior wood or color matched surrounds

Color matched surrounds

**+ OPTIONS**

Concealed sensors for security systems, Wash Mode

**COASTAL + WATERFRONT**

All Marvin windows and doors are well suited for coastal or waterfront areas, with special products and hardware specifically designed for hurricane zones

# EXTERIOR COLORS + MATERIALS

STONE WHITE

COCONUT CREAM

SIERRA WHITE

CASHMERE

PEBBLE GRAY

HAMPTON SAGE

CADET GRAY

CLAY

CASCADE BLUE

SUEDE

GUNMETAL

WINEBERRY

BRONZE

BAHAMA BROWN

EVERGREEN

EBONY

BRIGHT SILVER (PEARLESCENT)

COPPER (PEARLESCENT)

LIBERTY BRONZE (PEARLESCENT)

CUSTOM COLOR: ANY COLOR YOU WANT

Complement any project or design with our high-quality exterior options. Choose from extruded aluminum or wood.

## EXTRUDED ALUMINUM

**Extruded aluminum** is an extremely tough cladding that protects wood windows, mimics the profiles of wood, and provides superior durability.

Select a color from our palette of 19 durable extruded aluminum colors, including a spectrum of rich hues and three pearlescent finishes. If you have more specialized needs, we can work with you to create a custom color.



Ultimate Double Hung G2 window in Ebony

Ultimate Double Hung G2 window in Suede

## WOOD EXTERIORS

**Wood** is a premium material for windows and doors, offering classic aesthetic appeal, many options for customization, and design versatility.

We treat exposed millwork with a water repellent wood preservative to help it last longer. Choose from one of four exterior options. Each is ready to be finished to match your project's exacting requirements.

PINE

VERTICAL GRAIN  
DOUGLAS FIR

MAHOGANY

WESTERN RED CEDAR  
Exterior trim package only

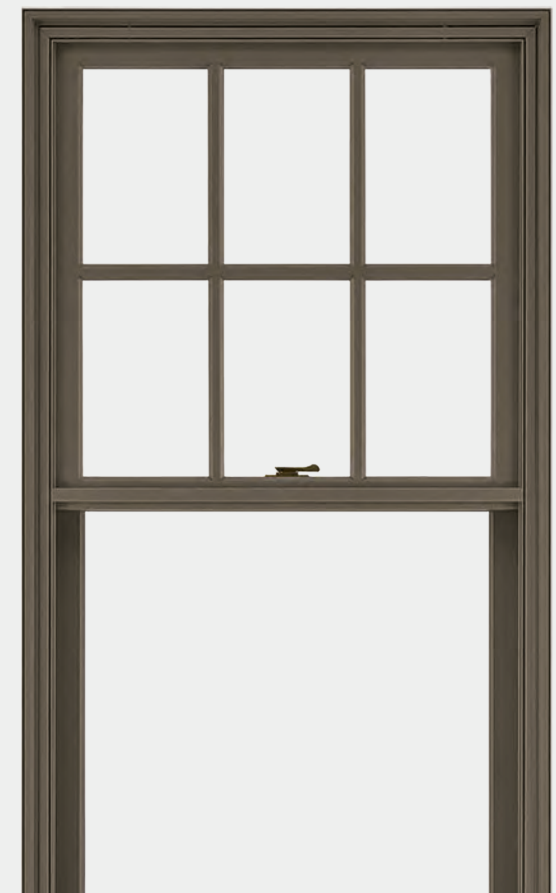

# DIVIDED LITES



Photo: Laury W. Glenn

Ultimate Sliding French door and Ultimate Double Hung G2 windows with Simulated Divided Lites



## Endless Design Possibilities

Our custom capabilities allow us to create almost any divided lite pattern to match your design style. Divided lites can feature an array of widths, unique profiles, rectangular or curved cuts, and more. Choose from an existing lite cut or specify custom divided lites according to a new design.

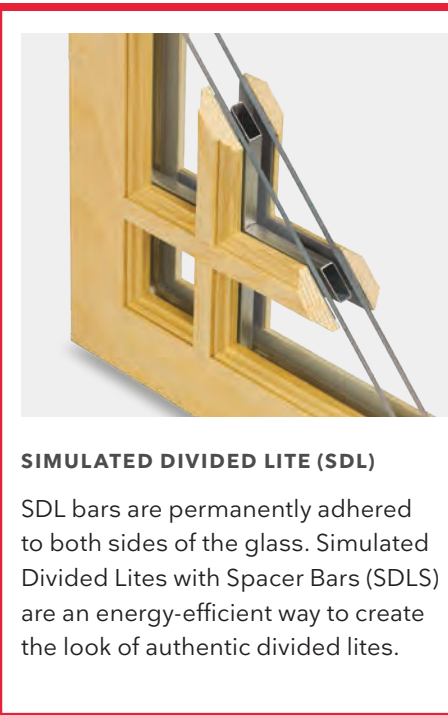

### SIMULATED DIVIDED LITE (SDL)

SDL bars are permanently adhered to both sides of the glass. Simulated Divided Lites with Spacer Bars (SDLS) are an energy-efficient way to create the look of authentic divided lites.



### AUTHENTIC DIVIDED LITE (ADL)

Separate panes of glass are glazed between bars—the way windows have been made since the beginning. Available exclusively with wood exterior units.

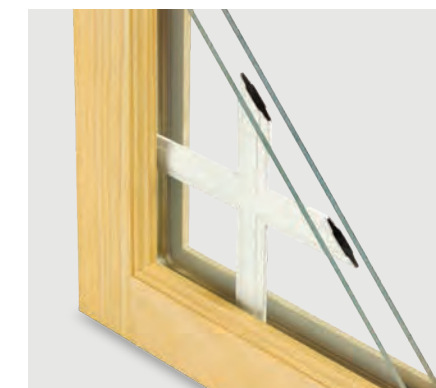

### GRILLES-BETWEEN-THE-GLASS (GBG)

Grilles are permanently installed between the glass panes. This low-maintenance grille offers the look of a divided lite pattern with the ease of cleaning just one pane of glass. Available with different interior and exterior colors.

### STICKING AND PROFILES

Sticking refers to the interior profiles of your wood window. Choose from the standard Ogee profile (used on traditional projects) or the optional clean, contemporary Square sticking.



Ogee



Square



Square sticking

### FIVE STANDARD BAR WIDTHS

Ogee:

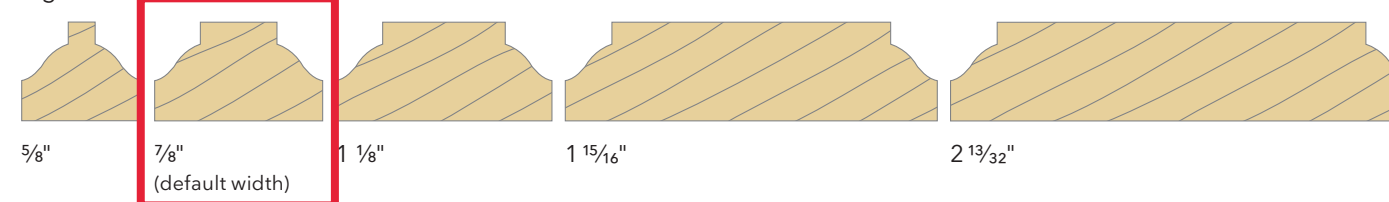

Square Sticking:

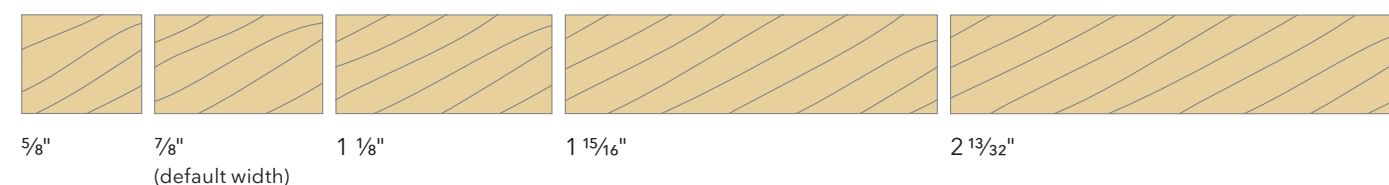

# GLASS

## DUAL PANE VS. TRIPLE PANE



### DUAL PANE

Our standard glazing is dual pane: two panes of glass with Low E coatings and insulated with argon gas. Compared to a single glass pane, dual pane glass cuts heat loss significantly because of the insulating space between the glass layers.



### TRIPLE PANE

Triple Pane glazing provides three panes of glass with Low E coatings. Two glass spaces are insulated with argon gas between the panes.

### TRIPLE PANE: IS IT RIGHT FOR YOU?

While Marvin triple pane windows are engineered for long-lasting energy efficiency, not all windows are made the same. Simply having three panes of glass doesn't necessarily mean a triple pane window is more energy efficient. Glass coatings, the type of gas used in the spaces between the glass, the design of the window, the materials used, and how well it is installed all play a role in achieving the overall energy efficiency. Consider the energy efficiency of the entire window, not just the number of panes.

A poorly designed or installed window, or a window made with inferior materials like vinyl, may not be energy efficient regardless of the number of panes of glass. Materials shrink and expand with cold/heat cycles and seals can begin to fail. Once seals fail, the energy efficiency the window claimed when it was new becomes greatly reduced. Consider your home's unique needs before assuming that triple pane, or tripane, is always the best solution.

Visit [marvin.com/energyratings](https://marvin.com/energyratings) to view detailed performance ratings for all Marvin products.

## COATINGS & ENERGY EFFICIENCY

Low E coatings are a microscopically thin, virtually invisible metallic layer on the glass surface that help manage the amount of heat either radiated through a window or reflected away from it. Marvin products are offered with a variety of Low E coating options for thermal performance best suited for your heating and cooling needs.

The national ENERGY STAR® program recognizes products that meet strict energy efficiency guidelines to suit climates in different areas of the country. No matter where you are located, we offer energy efficient solutions that meet or exceed ENERGY STAR guidelines.

Visit [marvin.com/energy](https://marvin.com/energy) for more information.

<b>LOW E1</b>	Single layer of metallic coating, which reduces heat loss to the outside while allowing the highest levels of solar heat into a room. Generally used in Northern climates where heating is prioritized over cooling.
<b>LOW E2</b>	Double layer of metallic coating. Provides year-round performance and comfort, and works well in most geographic regions and climates where a mix of heating and cooling is required.
<b>LOW E3</b>	Triple layer of metallic coating provides the most protection against solar heat gain (warmth from the sun). Most commonly used in climates where sun exposure is intense and cooling is a priority.
<b>LOW ERS</b>	A high-performance insulating glass option that features a Low E coating on the Room-Side glass together with a coating of Low E2 or Low E3 on the second glass surface. This option is designed to reflect radiant heat back into the room. It is not recommended for some northern zones as condensation is more likely to occur.

## DECORATIVE + SPECIALTY GLASS OPTIONS

Glass goes beyond energy efficiency. Decorative and privacy glass, and even specialty glass that provides additional sound reduction, can be paired with thermal performance options for a window or door that is perfect for your home.

## DECORATIVE GLASS

Decorative glass options on Ultimate windows and doors are offered with your choice of Low E coatings for energy efficiency and your own unique style.

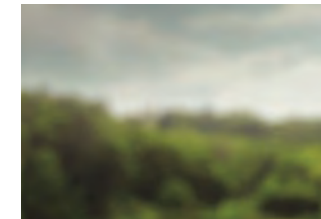

BRONZE TINT

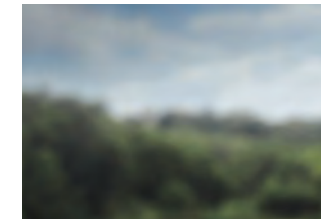

GRAY TINT



GREEN TINT



BEVELED



OBSCURE



FLEMISH



GLUE CHIP

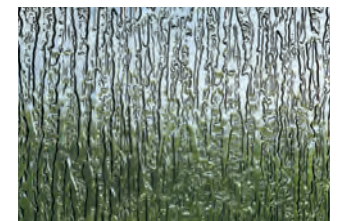

RAIN

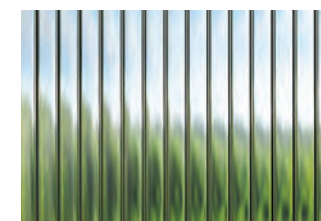

REEDED

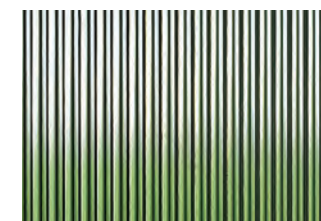

NARROW REED



AQUALITE



WHITE LAMINATED



SANDBLASTED



LEADED



V-GROOVE

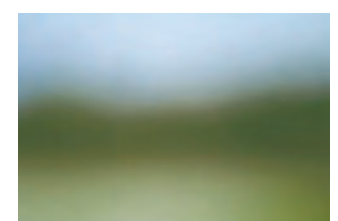

FROST

## SPECIALTY GLASS

Our specialty glass options include glazing for unique project requirements like sound reduction, high altitudes, Sea Turtle Conservation Codes, and California fire zones. We also offer laminated glass in products designed specifically for hurricane zones.

# DIVIDED LITES

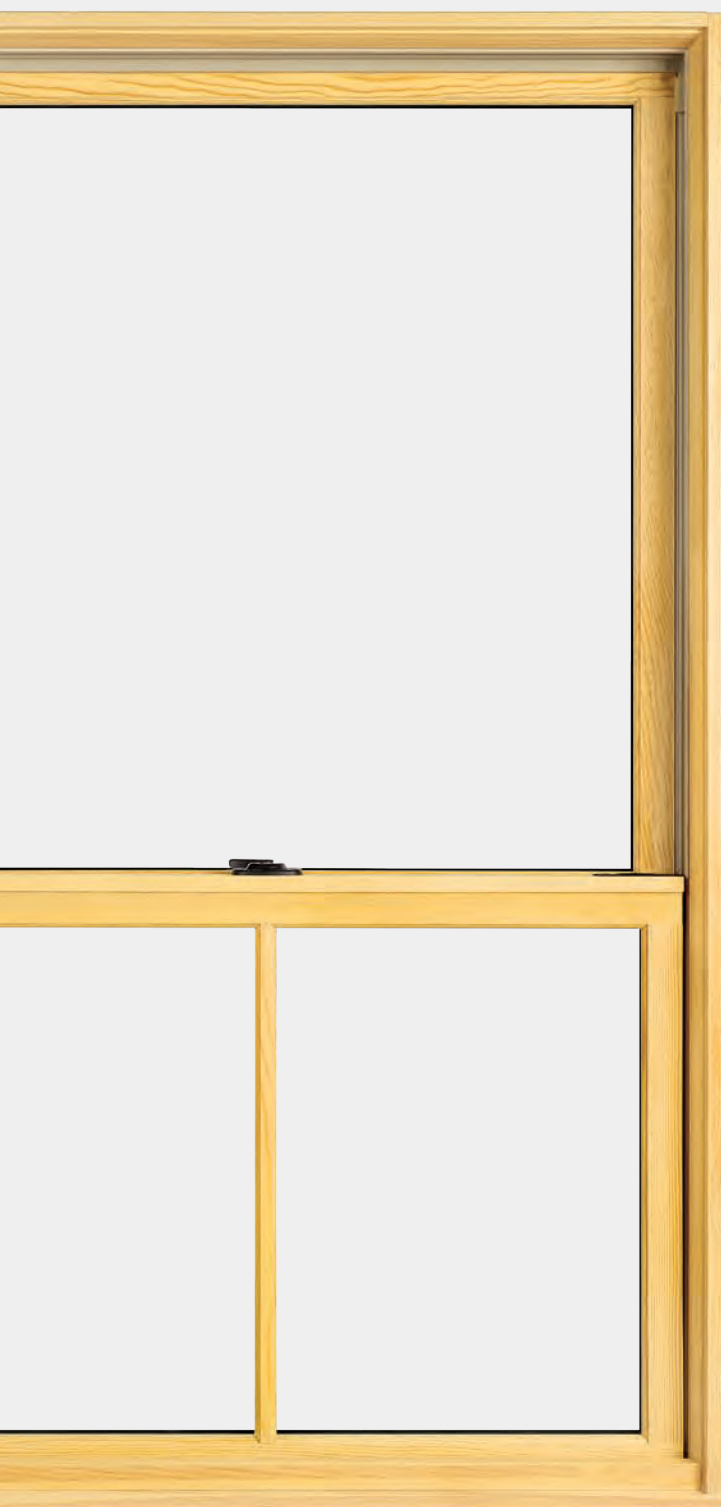

### SIMULATED DIVIDED LITE (SDL)

A simulated divided lite (SDL) is an energy-efficient way to create the look of authentic divided lites. SDL bars are permanently adhered to both sides of the glass. Spacer bars can be installed between the bars inside the glass, creating the look of individual panes.

- Available on Elevate products



### GRILLES-BETWEEN-THE-GLASS (GBG)

Low-maintenance grilles offer the look of a divided lite pattern with the ease of cleaning just one pane of glass. Exterior colors match Ultrex® fiberglass exteriors, and a selection of interior colors match or complement interiors.

- Available on both Elevate and Essential products



### SIMULATED CHECKRAIL

The simulated checkrail is the perfect solution when your home style calls for the look of a double hung window, but operation, egress, or performance demand another solution. Essentially, it gives a casement window the look of a double hung.

With custom placement anywhere on the window and paired with 7/8" divided lite bar patterns above and below, this option offers wonderful flexibility for creating a unique look that's perfect for your home. Available on Elevate Casement, Awning, and Glider windows and all Elevate doors.

- Available on Elevate products

### PATTERNS

These illustrations offer a sampling of Simulated Divided Lite (SDL) patterns that can be selected on Elevate windows and doors. Enjoy exceptional design flexibility by combining standard 7/8" bars with the 2 1/32" Simulated Checkrail.

