

# DHDC #22-7850

## APPROVAL DOCUMENT – POST AT WORK LOCATION

CITY OF DETROIT  
HISTORIC DISTRICT COMMISSION

2 WOODWARD, SUITE 808  
DETROIT, MICHIGAN 48226

6/29/2022

### CERTIFICATE OF APPROPRIATENESS

Mark Crowley  
1814-1820 Church  
Detroit, MI

**RE: Application Number 22-7850; 1814-1820 Church; Corktown Historic District  
Project Scope: Replace windows**

Dear Applicant,

At the Special Meeting that was held on June 22, 2022, the Detroit Historic District Commission (“DHDC”) reviewed the above-referenced application. Pursuant to Section 5(1) of the Michigan Local Historic District Act, as amended, being MCL 399.205 (1) and Sections 21-2-73/21-2-78 of the 2019 Detroit City Code; the DHDC hereby issues a Certificate of Appropriateness (“COA”) for the following work, effective on 6/28/2022, as it meets the Secretary of Interior’s Standards for Rehabilitation and the district’s Elements of Design:

- Replace three existing windows with three, Ultimate G2 Marvin double-hung aluminum-clad wood windows (one-over-one), color: bronze, to include two on the side/east elevation one at a rear/north elevation dormer

Please retain this COA for your files and post it at the subject property until work is complete. It is important to note that approval by the DHDC does not waive the applicant's responsibility to comply with any other applicable ordinances or statutes. If you have any questions regarding the foregoing, please contact staff at 313-224-1762 or [hdc@detroitmi.gov](mailto:hdc@detroitmi.gov).

For the Commission:



Audra Dye  
Detroit Historic District Commission

## **1814-1820 Church St. Window Replacement Appropriateness**

### **BSEED Permit Application Plan**

#### **Scope of Work**

Note: This certificate of appropriateness and permit application is being made to correct a “stop work” order issued by BSEED on 03-30-2022 by Inspector Thomas Kuhn. (See slide of the notice included in photos.) Two of the following three windows at issue were in the process of being installed on the day the order was issued. The one that has yet to be replaced is non-historic as it was part of an HDC approved attic conversion addition done in 2001.

- Removal of three original double-hung windows and replace with double-hung pine, bronze extruded aluminum-clad, double-pane, insulated, energy efficient Ultimate G2 Marvin double-hung window inserts.
- The first floor, 1814 Church, dining room windows that were replaced on the east wall, were original to the house that was built in 1901. Wooden then aluminum storms were added sometime later during the history of the house. The condition of double-hung originals as seen in accompanying photos are with significant decayed wood, non-functioning window weight systems, mostly inoperable for opening and closing, with several layers of paint, much of it lead based, with acid-etched and cloudy single-pane windows, all of which make the Marvin replacements the most cost effective, energy efficient, ambient noise reducing and environmentally responsible option.
- Each of these two 121 year-old first floor, east wall, 1814 Church, dining room windows have a total measurement of  $33\frac{3}{4}''$  x  $77\frac{7}{8}''$  inside the frame. See attached diagrams for complete original dimensions of both historic windows and sashes.

- The 21 year-old third floor double-hung bathroom window on the NW dormer of 1820 Church has yet to be replaced. It measures 37½" x 60¼". The Marvin wood, aluminum clad double-hung window currently in place was installed with others that were approved as appropriate by HDC in 2001 during the attic conversion. This window and frame has warped to where it is inoperable and air and water seeps through failing seals. See attached diagram in slides for the complete dimensions of this window.
- The finished opening dimensions of all three windows will remain as they are now with no alterations to original sills, casings, jambs, frames, exterior and interior moulding, and other frame detail and profiles. This will retain the same original historic look of the original 1901 structure of the house as well as of the 2001 attic conversion.



1814-1820 Church, South/Front



1814-1820 Church, North/Back



1814-1820 Church, East



1814-1820 Church, East



1814-1820 Church, West





1814-1820 Church, NW Corner



1814 Church, Old Double Hung Top Sash



1814 Church, Old Double Hung Bottom Sash



1814 Church, Old Double Hung Sashes



1814 Church, Old Alum. Storm Style East



1814-1820 Church, Double-Hung Marvin Clad  
Interior



1814-1820 Church, Double Hung Marvin Clad  
Exterior

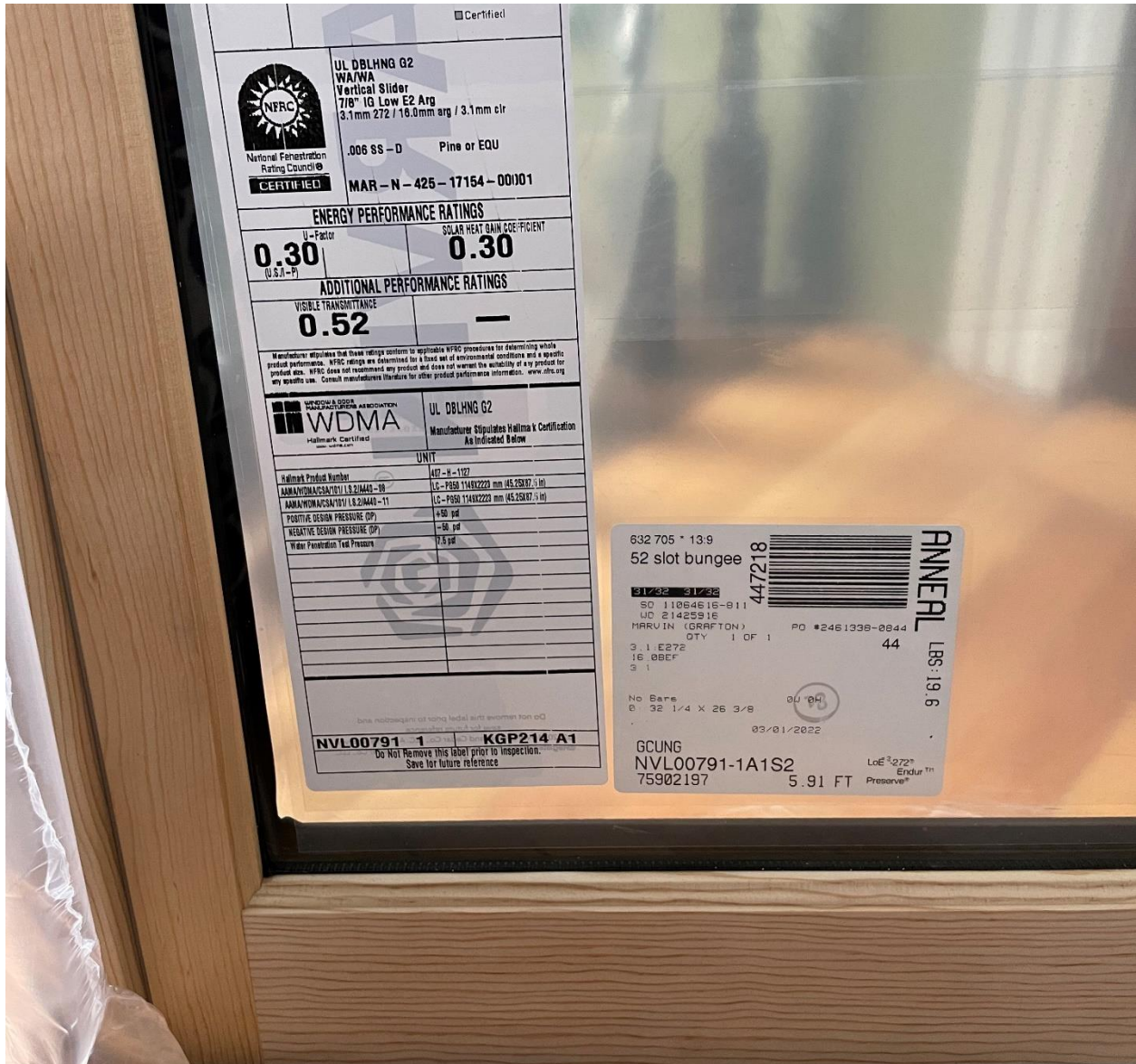

1814-1820 Church, Energy Specs





1814 Church, newly installed, east wall



1820 Church, Current Interior,  
3<sup>rd</sup> floor, NW dormer

## Important Safety Information

### Factory Applied WOCD Ultimate Double Hung G2

#### ATTENTION

INSTALLER: Leave this safety information for the current or future occupant.

*NOTE: This safety information is for Ultimate Double Hung and Single Hung G2 product. When installed and used as directed, the Window Opening Control Device meets the requirements of ASTM F2090-17.*

#### IMPORTANT

When the window opening control device (WOCD) is properly installed and engaged, no space shall exist at the lowest opening portion of the window that would permit the passage of a rigid sphere measuring 4.0 in. (102 mm) in diameter. See Figure 1.

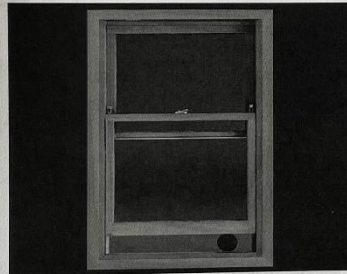

Figure 1

#### WARNING!

##### No Window Rescue Above 75 Feet (6th Floor)

- Fire rescue ladder may not reach beyond 75 feet (6th Floor).
- Do not rely on being rescued from windows above 75 feet (6th Floor). Follow building fire escape plan.

#### WARNING!

##### Blocks Escape in Fire and Emergency Unless Released

- Need to properly operate release mechanism to open the window opening control device by:
- To disengage the window opening control device, push orange dots to depress levers. Both devices on the sash must be depressed to open window for egress. See Figure 2.
- To reset the window opening control device, close the window sash fully. The control device will automatically reset itself once the window sash has been opened past the control device and closed. See Figure 3.
- Never apply padlocks or devices that require a key or tool to unlock them to the release mechanism of the window opening control device(s) (WOCD(s)).

#### WARNING!

##### Possible Fall Hazard

- This window opening control device(s) (WOCD(s)) is designed to protect against accidental operation of windows by children five years and younger.
- This window opening control device(s) (WOCD(s)) is not a substitute for attentive supervision of all young children.
- Keep window opening control device(s) (WOCD(s)) properly engaged unless needed for use in an emergency.

#### WARNING!

##### Possible Fall Hazard

- Young children may fall out of the window if the opening control device (WOCD) is not installed correctly.
- Install the device so that a rigid 4 inch (102mm) diameter sphere does not pass through any space at the lowest opening portion in the window opening after the window opening control device (WOCD) is in place.

MARVIN 

2019-08-26  
19915409

Marvin Brochure



## FEATURES OF THE ULTIMATE WOOD DOUBLE HUNG WINDOW

- Available in heights up to 8 feet or widths up to 4 feet
- Multiple design options and woods available to match historical aesthetics and design requirements
- Also available as a round top, single hung, stationary transom or picture window
- Unique wash mode allows cleaning of both sides of glass from indoors
- Available with IZ3 coastal/hurricane certification
- CE certified

Marvin Brochure

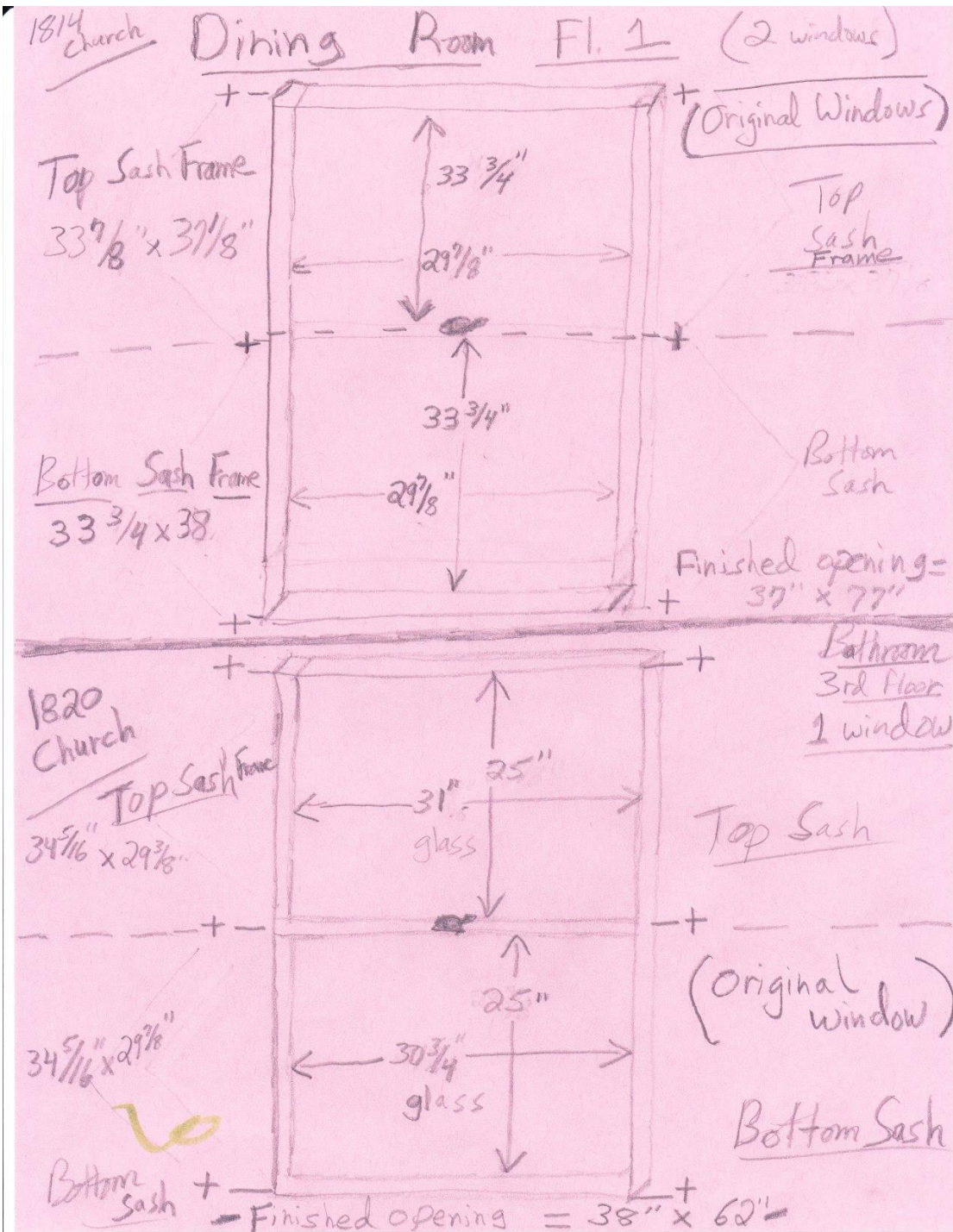

1814-1820 Church Original Dimensions

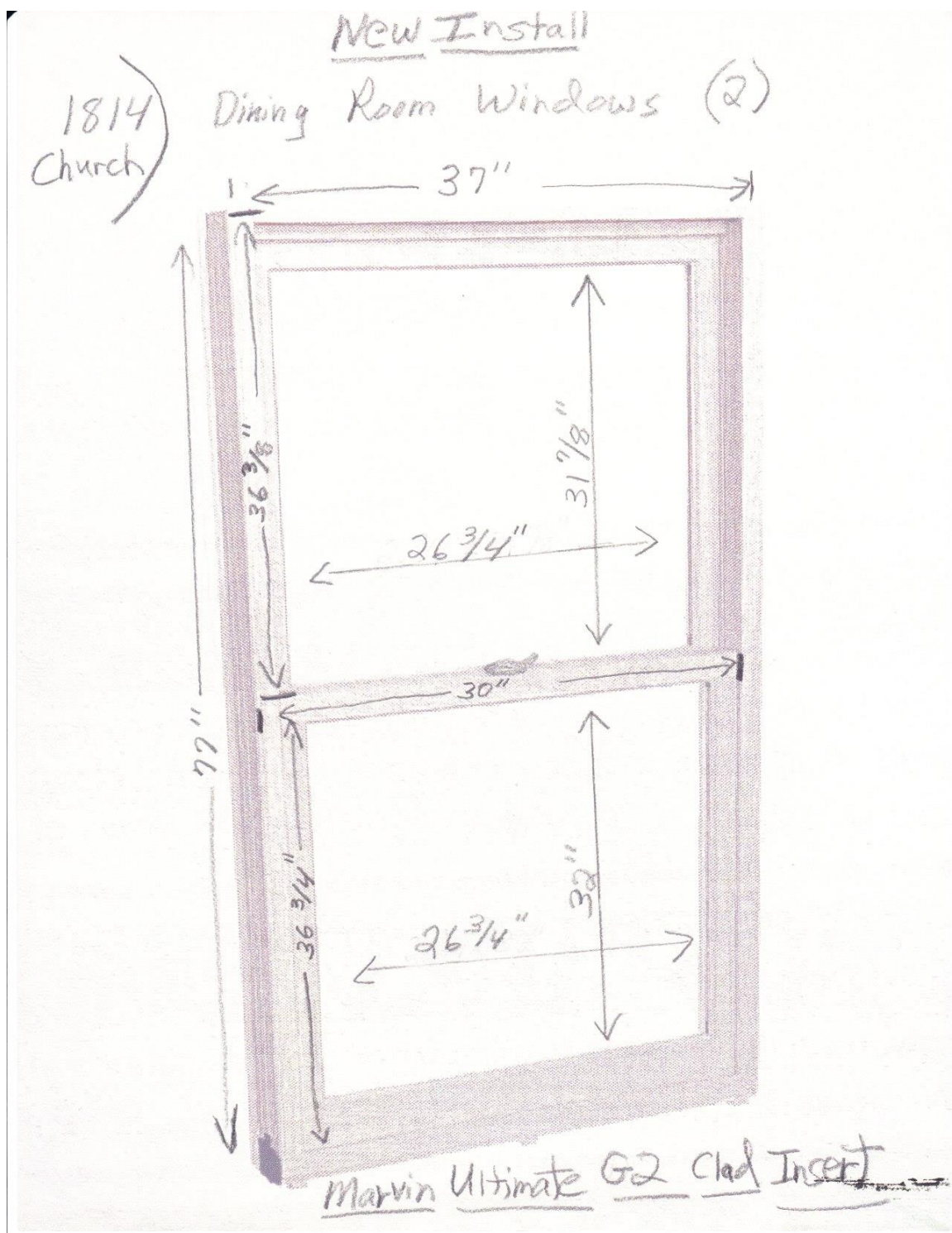

1814 Church, East Wall Replacement  
Dimensions

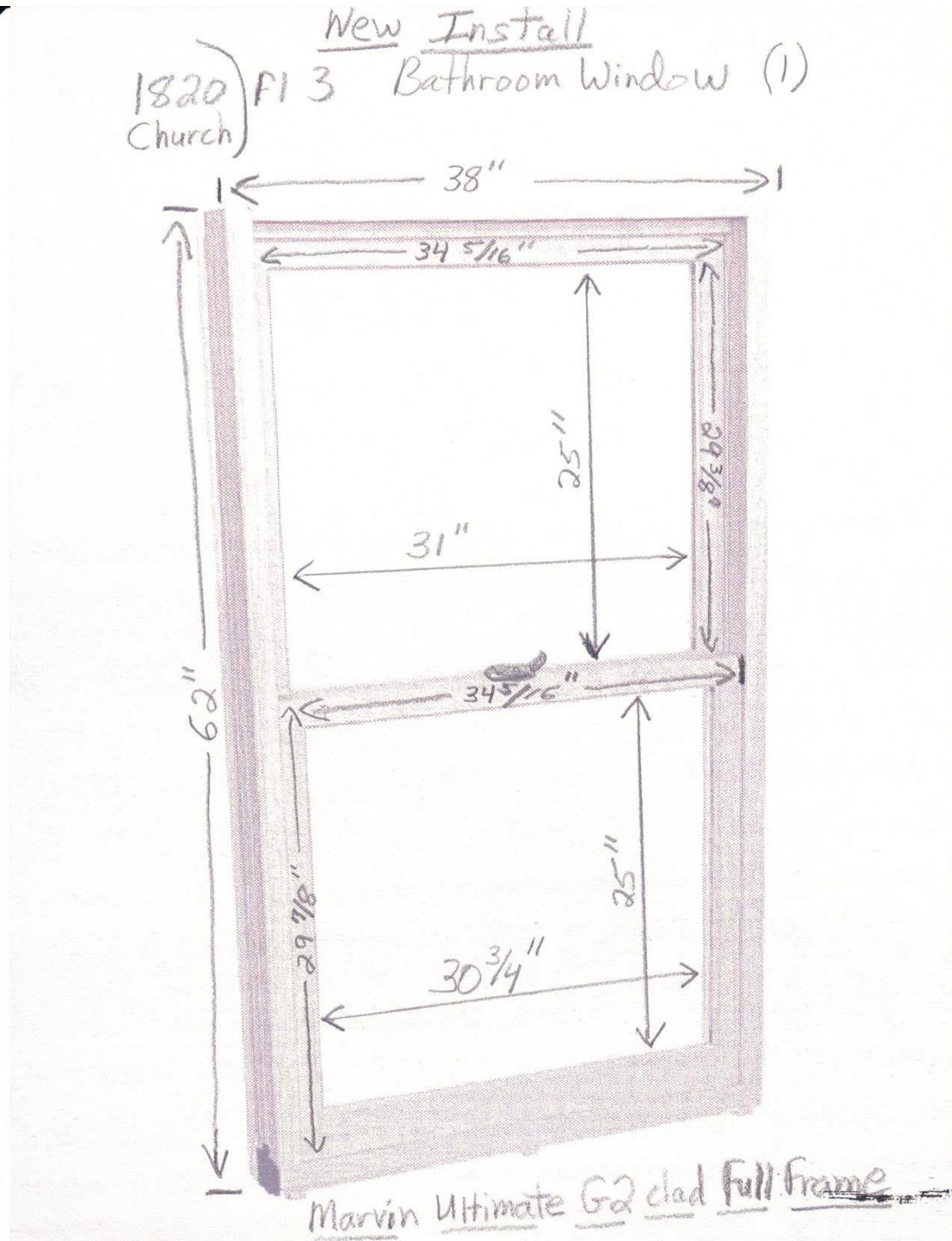

1820 Church, Third Floor NW Dormer  
Replacement Dimensions