

TOTAL BUILDING SCOPE FOOTPRINT: 27,700 sf

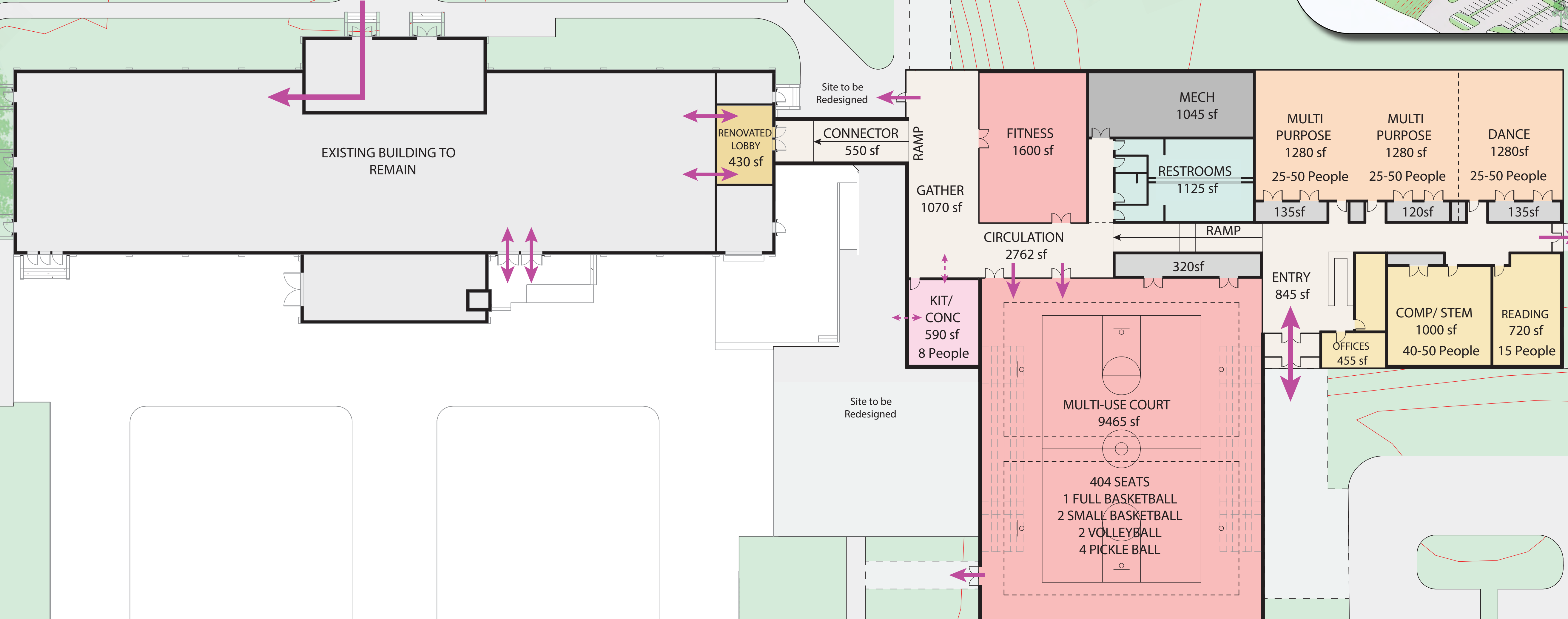

CIRCULATION/SHARED SPACE	
ENTRY	845 SF
CIRCULATION	2763 SF
CONNECTOR	546 SF
GATHER	1070 SF

OFFICE/LAB SPACES	
COMPUTER	1008 SF
OFFICES	457 SF
READING	718 SF
KITCHEN	590 SF

RECREATION SPACES	
FITNESS	1596 SF
MULTI-USE COURT	9464 SF

FLEX SPACES	
DANCE	1307 SF
MULTIPURPOSE	1341 SF
MULTIPURPOSE	1307 SF

SUPPORT SPACE / STORAGE	
RESTROOMS	1124 SF
MECH	1045 SF
GYM STORAGE	320 SF
STORAGE	135 SF
STORAGE	118 SF
STORAGE	135 SF
STORAGE	58 SF

Total Interior Areas	25946 SF
Gross Area	27700 SF

