

CITY OF DETROIT  
**CLARK PARK**

COMMUNITY OPEN HOUSE 3  
14 NOV 2019

HamiltonAnderson



# DESIGN SCHEDULE

## ENGAGEMENT MEETINGS

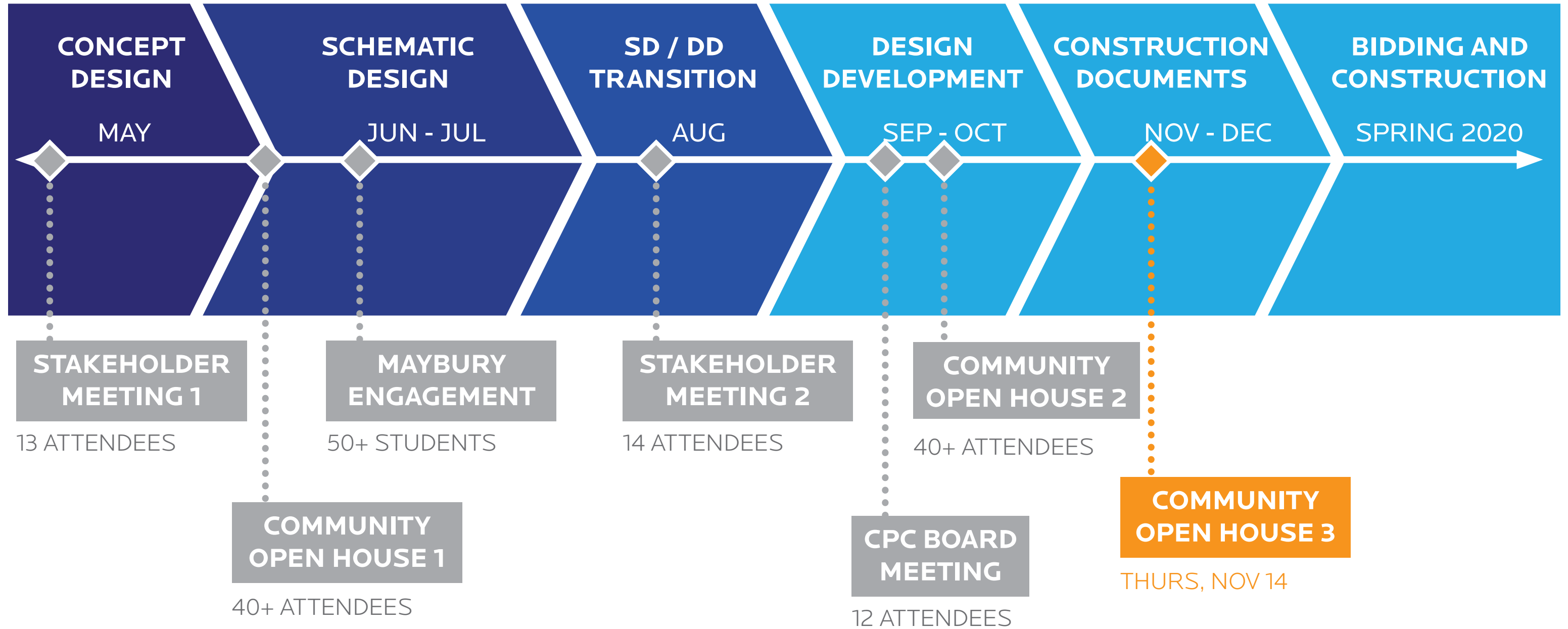

# DESIGN ZONES

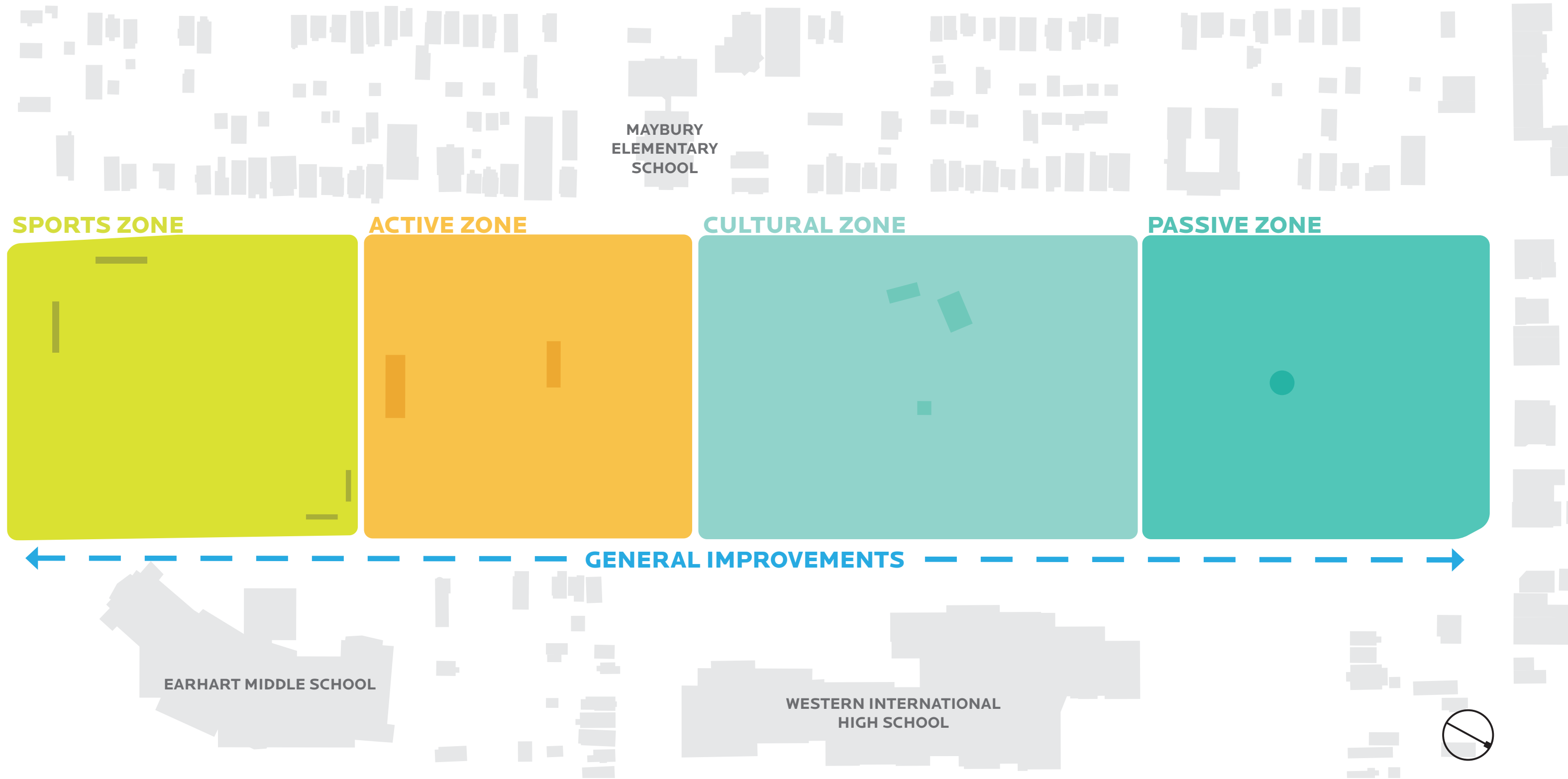

# CLARK PARK MASTER PLAN



# SPORTS ZONE MASTER PLAN

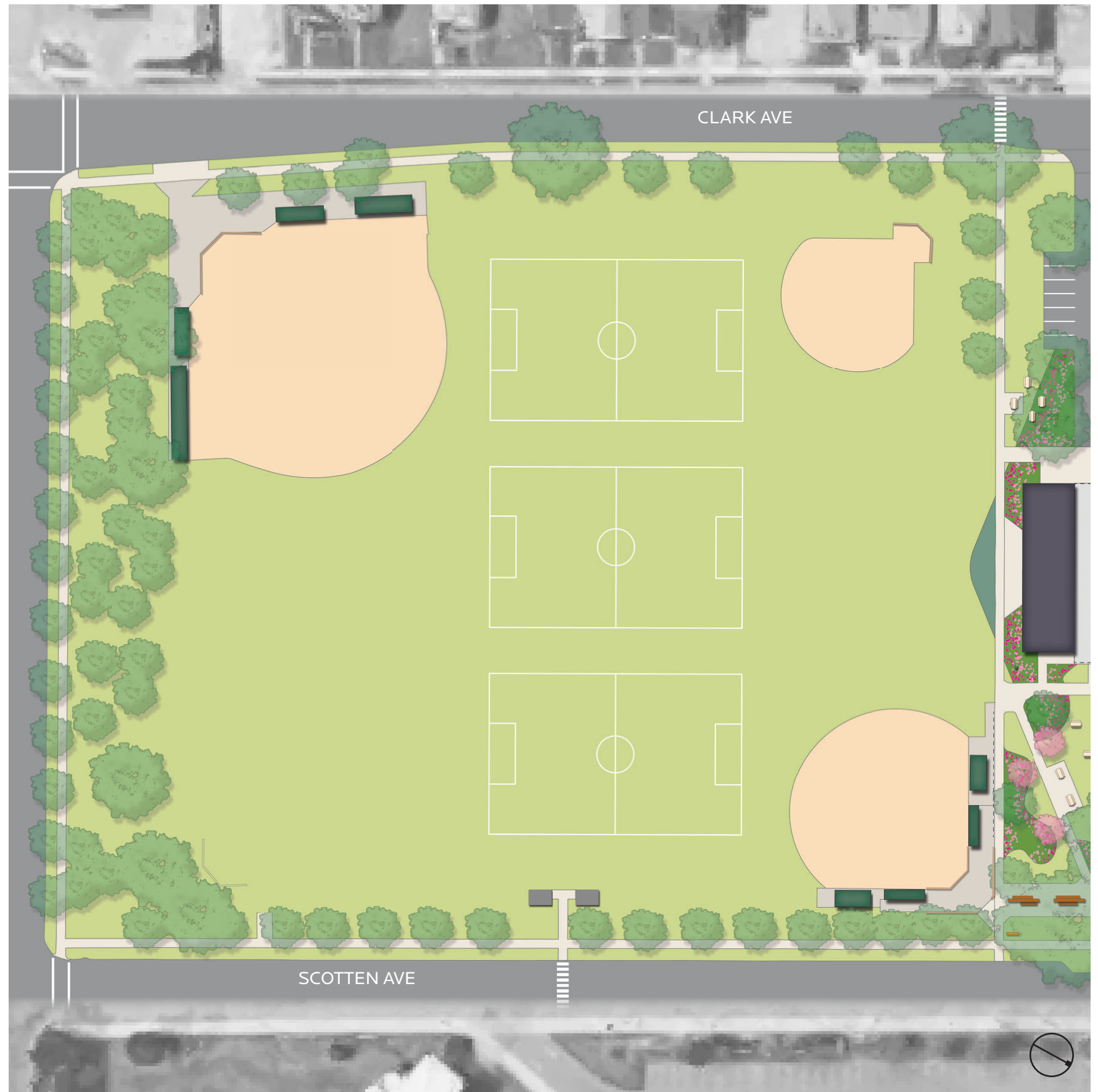

# SPORTS ZONE BUY-IN VOTING

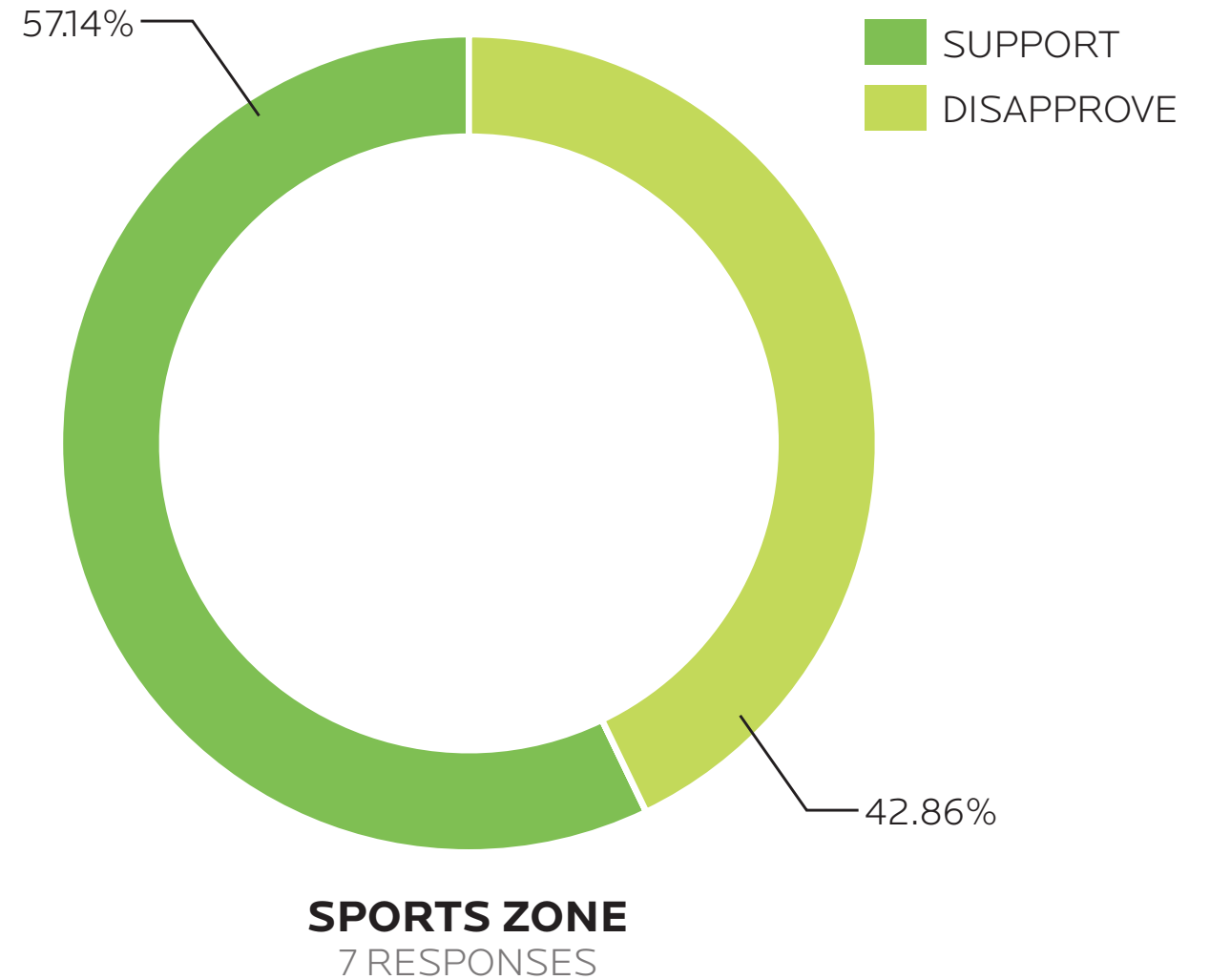
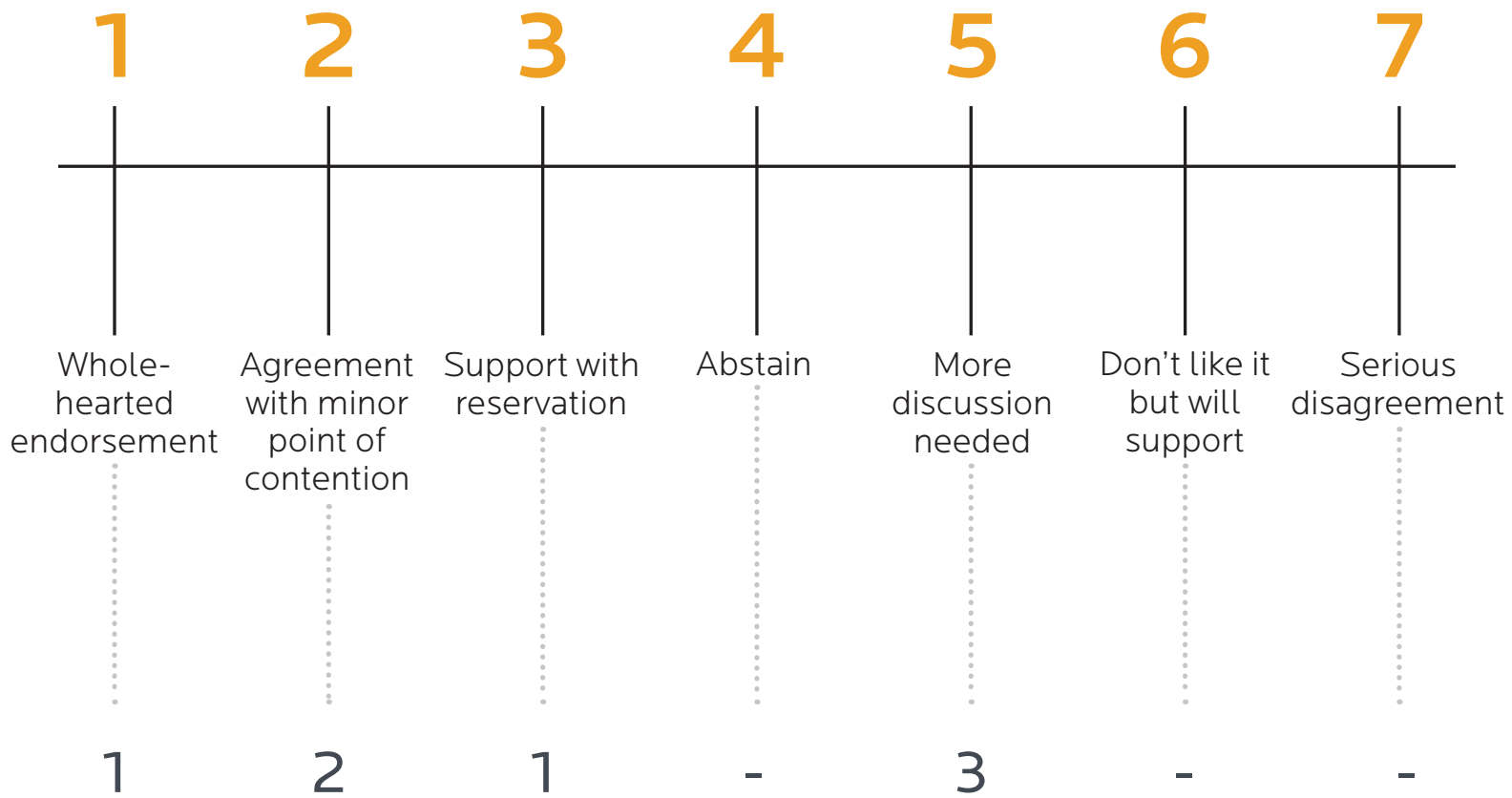

- (2) Field lighting would be great for fall / early spring sports
- (5) Don't want aggregate in softball fields (want red dirt); field drainage (losing the dirt to the traveling [team] dugout); want moat for fields; better secure Scotten fence; concern about the tree canopy along Fischer; paved area SE of tennis courts
- (5) Not sure about "rain garden" in front of Center at drain; sidewalk in front of center needs repitching to stop water collection

# SPORTS ZONE PHASE I PLAN

- DENSIFY TREE BUFFER
- SOCCER PRACTICE FIELDS
- ENHANCE ENTRY SEQUENCE
- INSTALL RAIN GARDEN**
- REPAIR FIELDS AND DUGOUTS
- IMPROVE SIDEWALK ALIGNMENTS

**\$15,000**

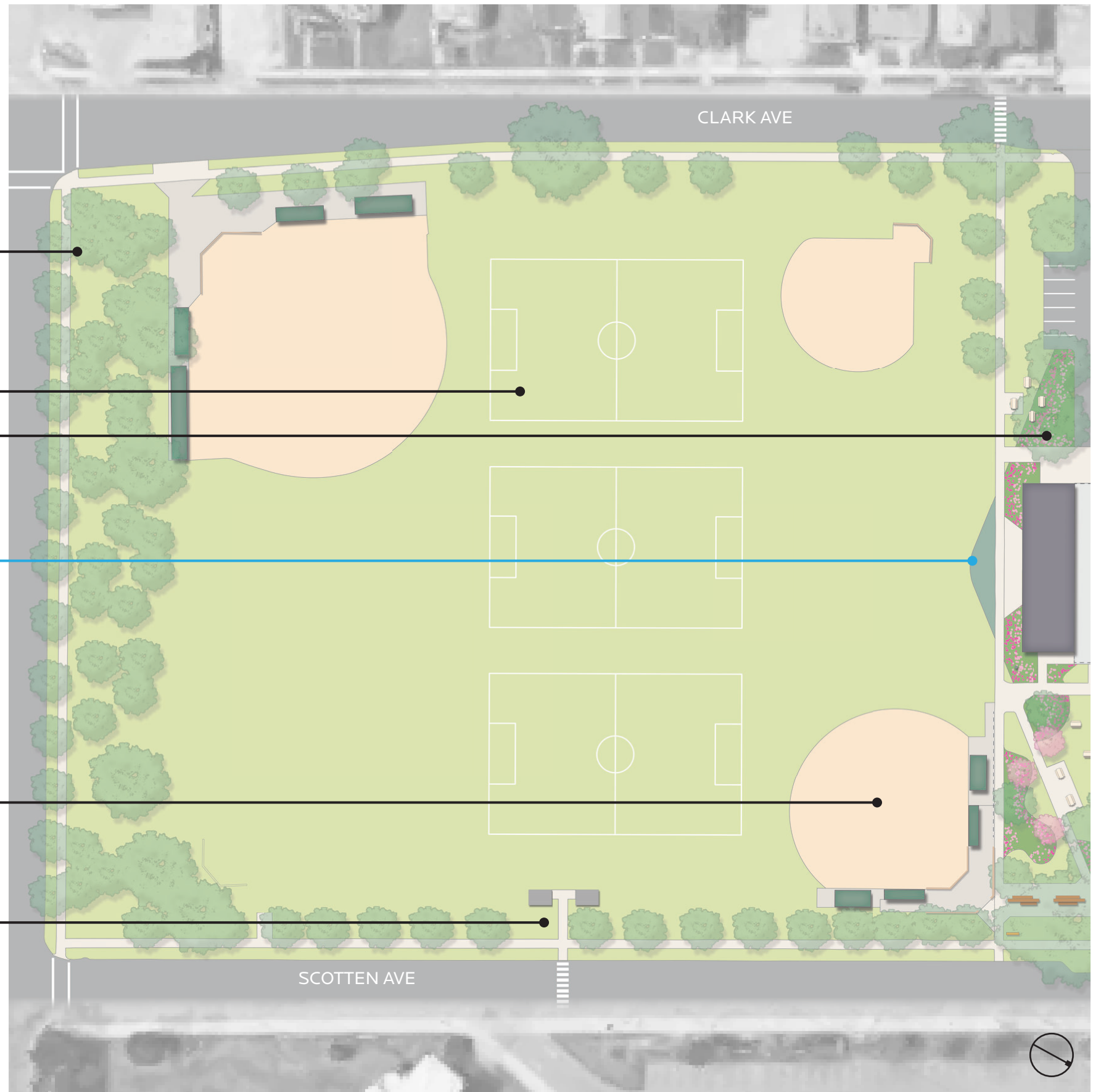

# MAIN ENTRANCE MASTER PLAN

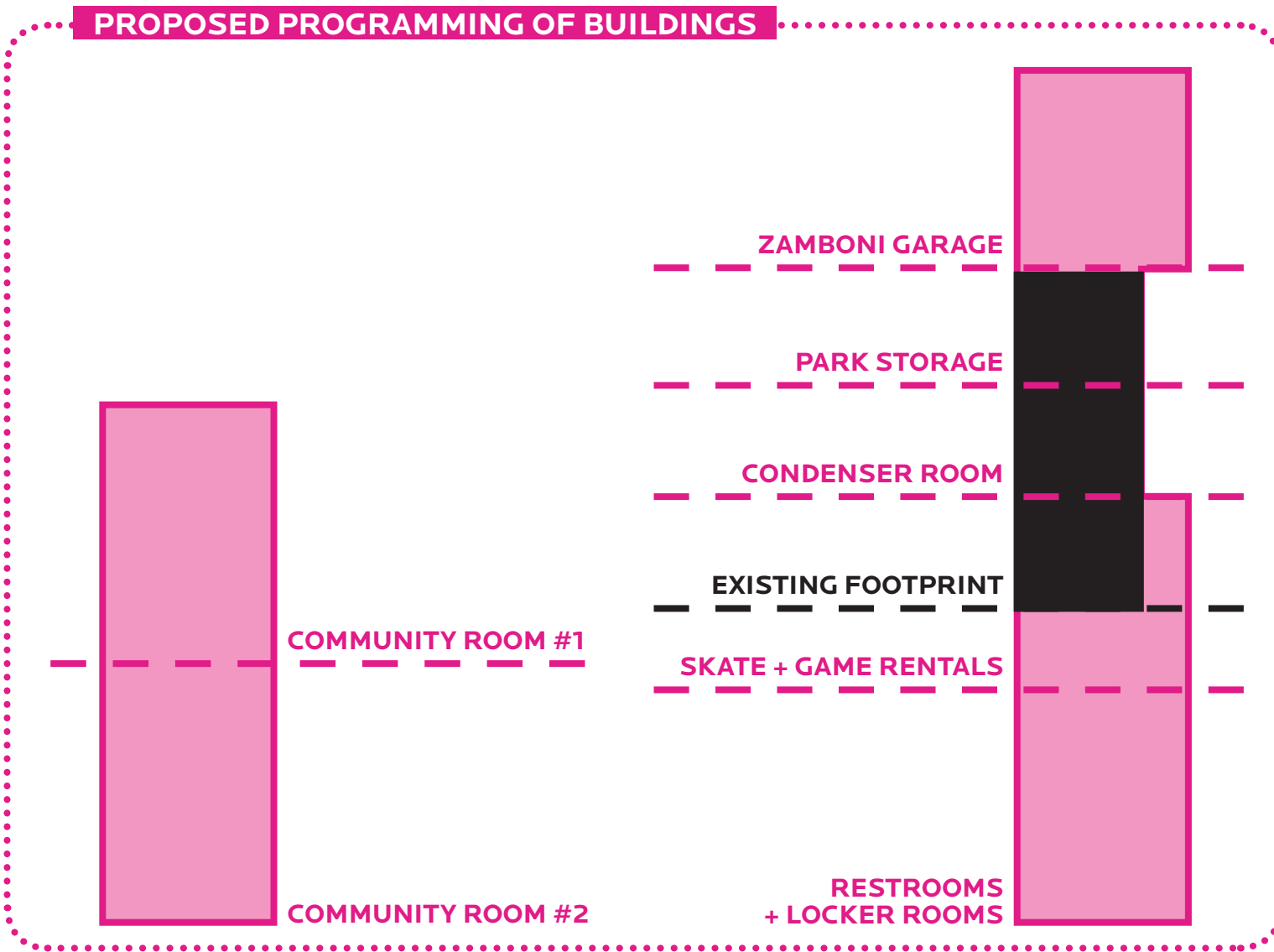



# MAIN ENTRANCE BUY-IN VOTING

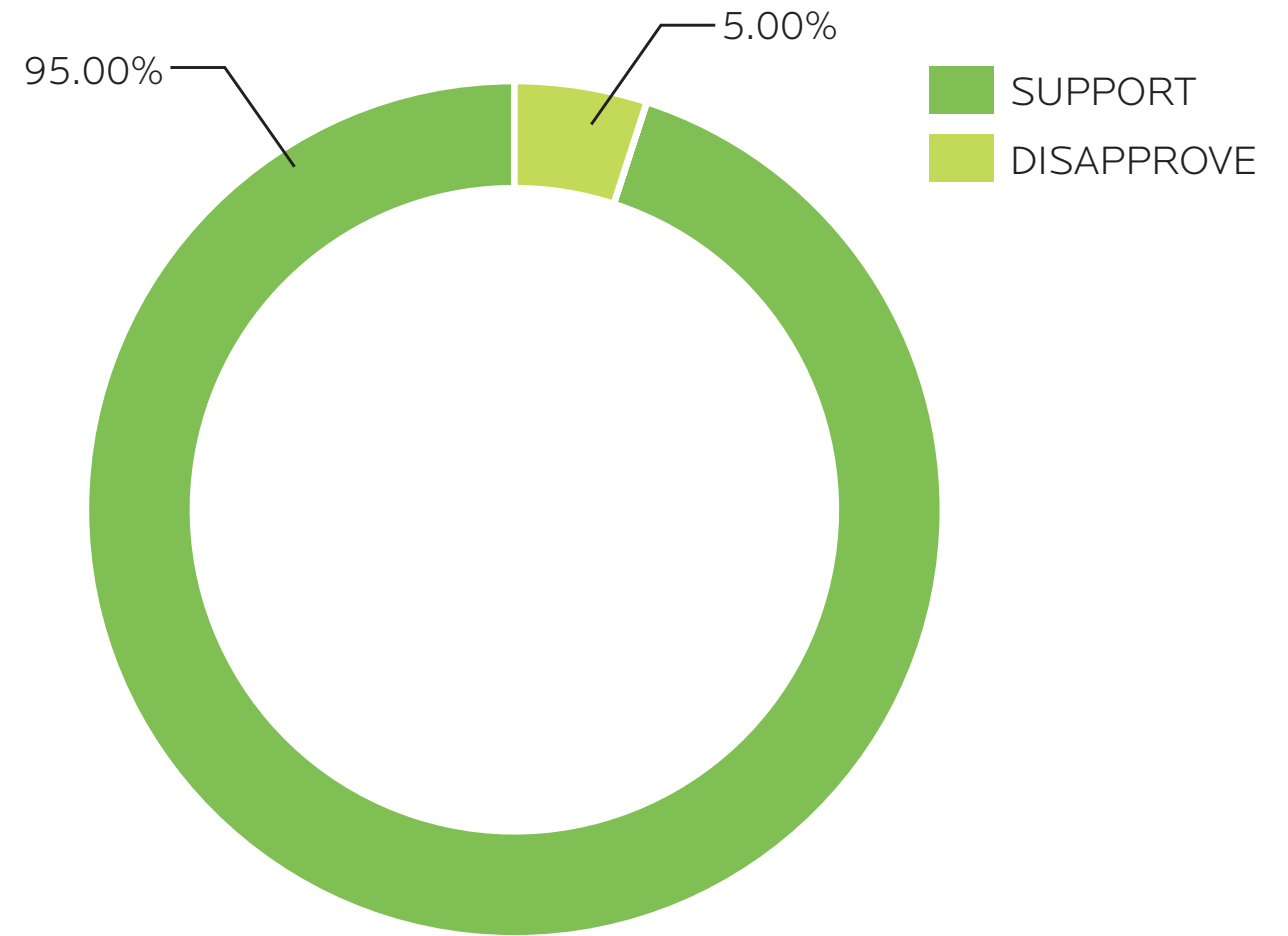
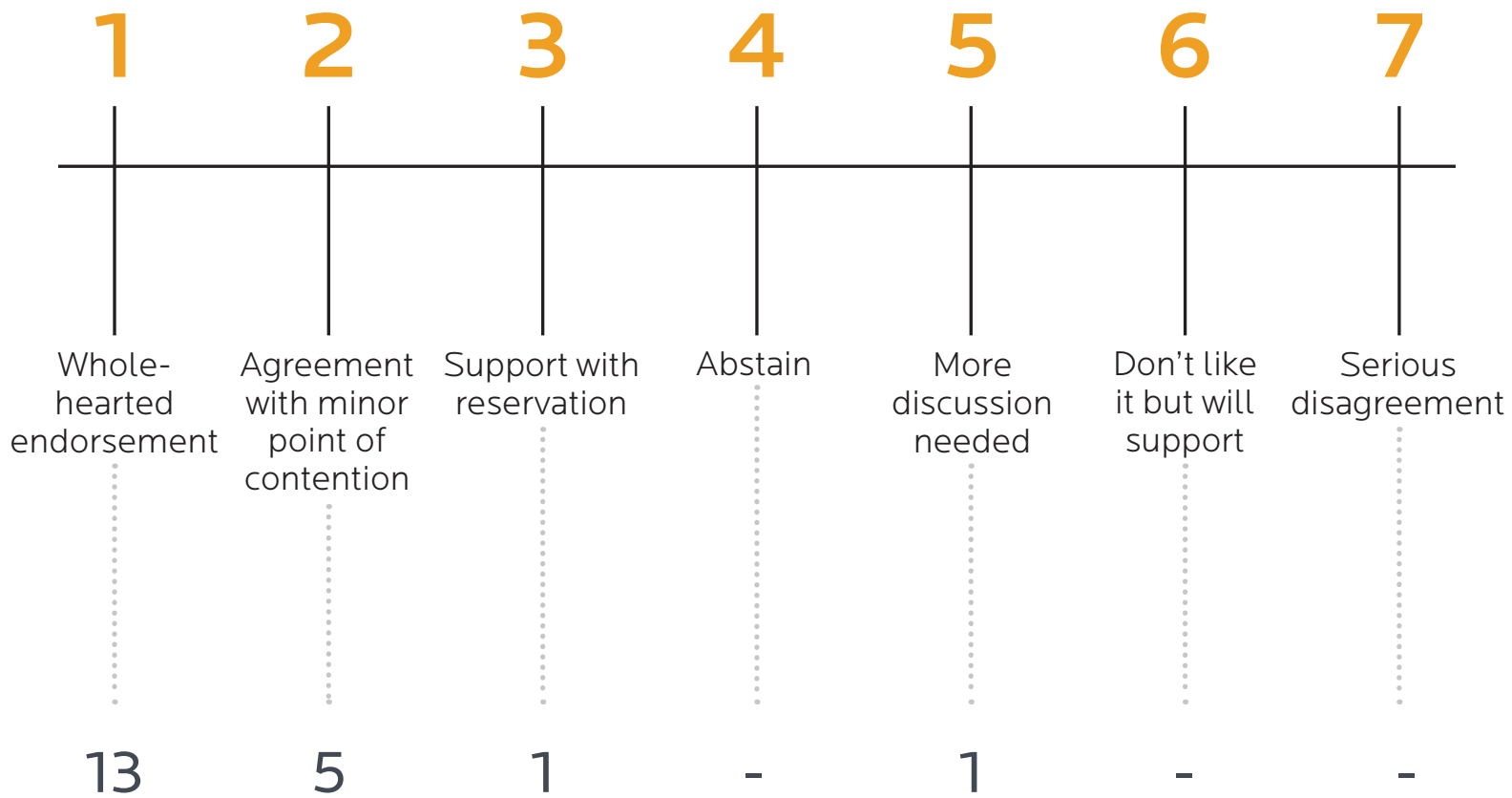

**MAIN ENTRANCE**  
20 RESPONSES

- (1) I like the new auxiliary building
- (1) Need a lot more room for meetings, etc.
- (1) Definitely need more room - love it!
- (1) I highly suggest we move forward with this project due to the fact we utilize this building all year round.
- (2) One way into parking lot, one way out!
- (2) Appreciate widening of the parking lot to allow better ingress / egress. Also, locker room concept should go on north end of rink, not in current CPC center.
- (2) Would like even bigger
- (5) Physical space references needed for CPC Team; no new parking lot encroaching into green spaces off of driveway
- (-) Downspouts; snake from drain GSI

# MAIN ENTRANCE PHASE I PLAN

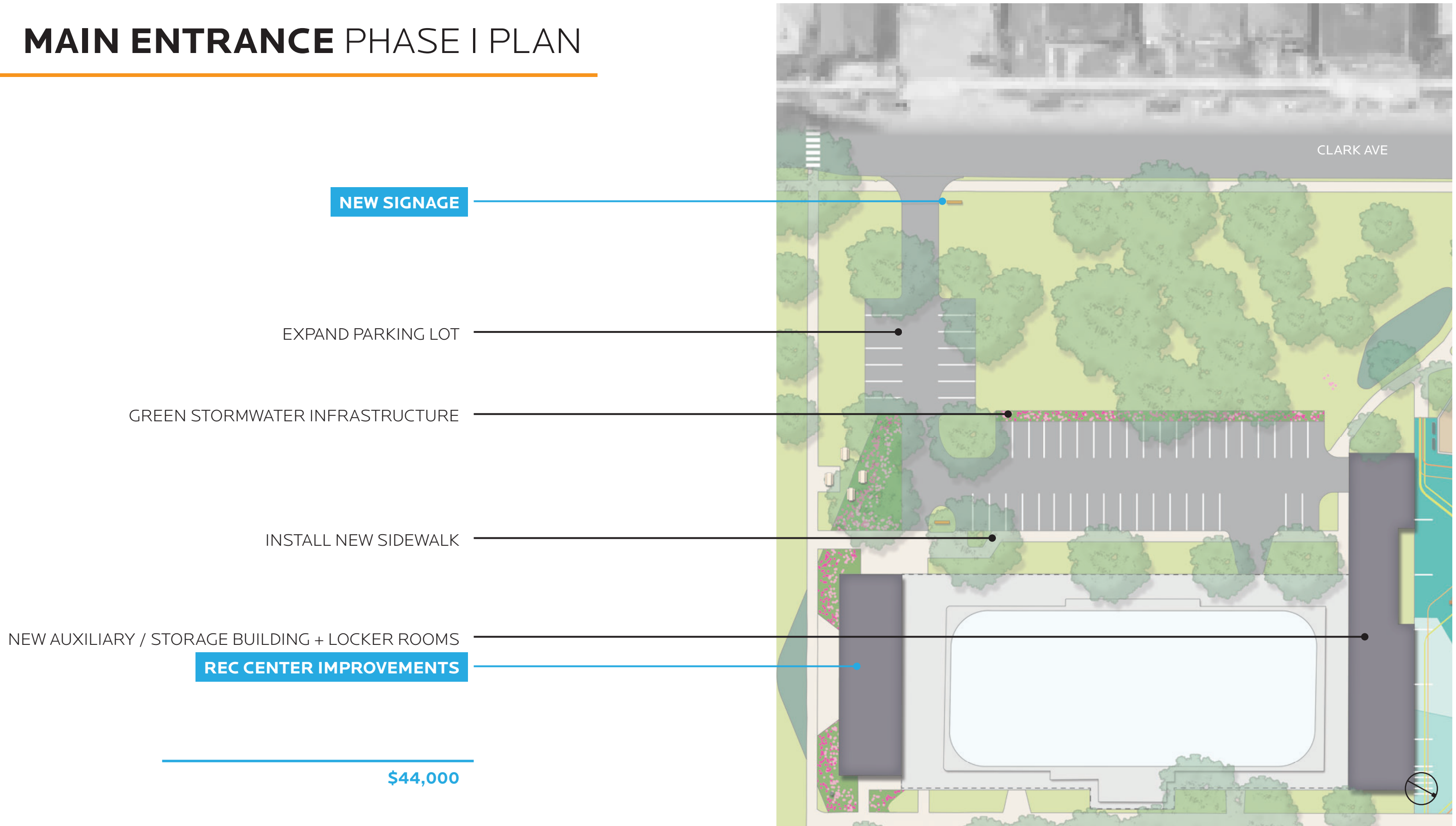

# MULTI-USE COURTS MASTER PLAN



**PROPOSED SURFACING AND ACTIVITIES**

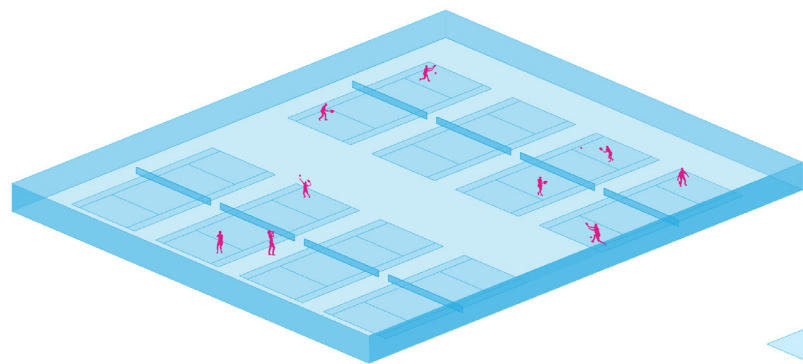

**BEFORE — FENCING CREATES BARRIER**

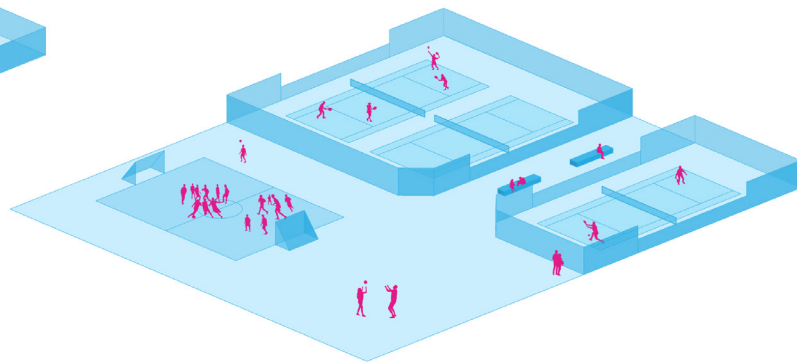

**AFTER — LAYOUT ALLOWS FOR FLEXIBILITY**

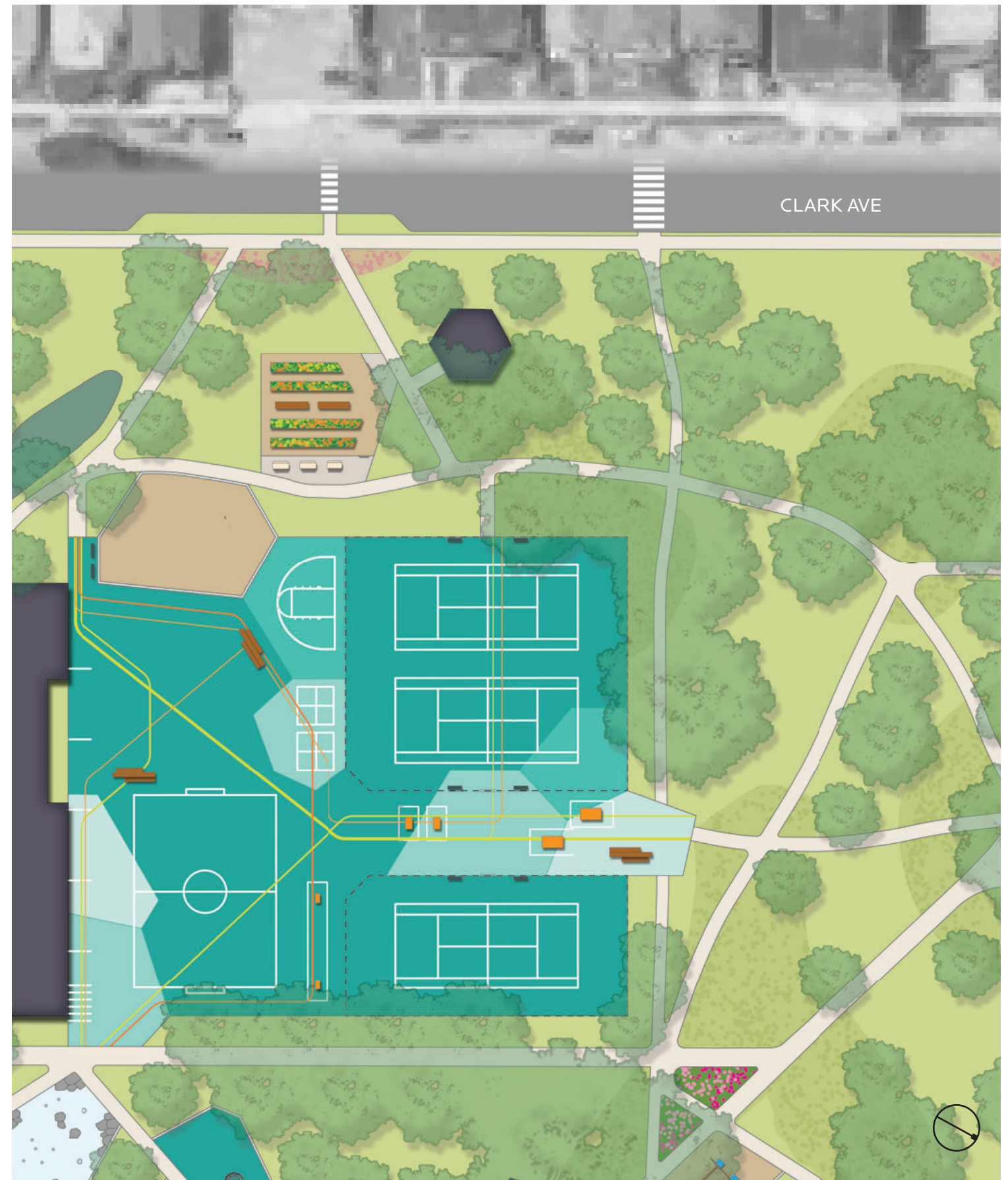

# MULTI-USE COURTS BUY-IN VOTING

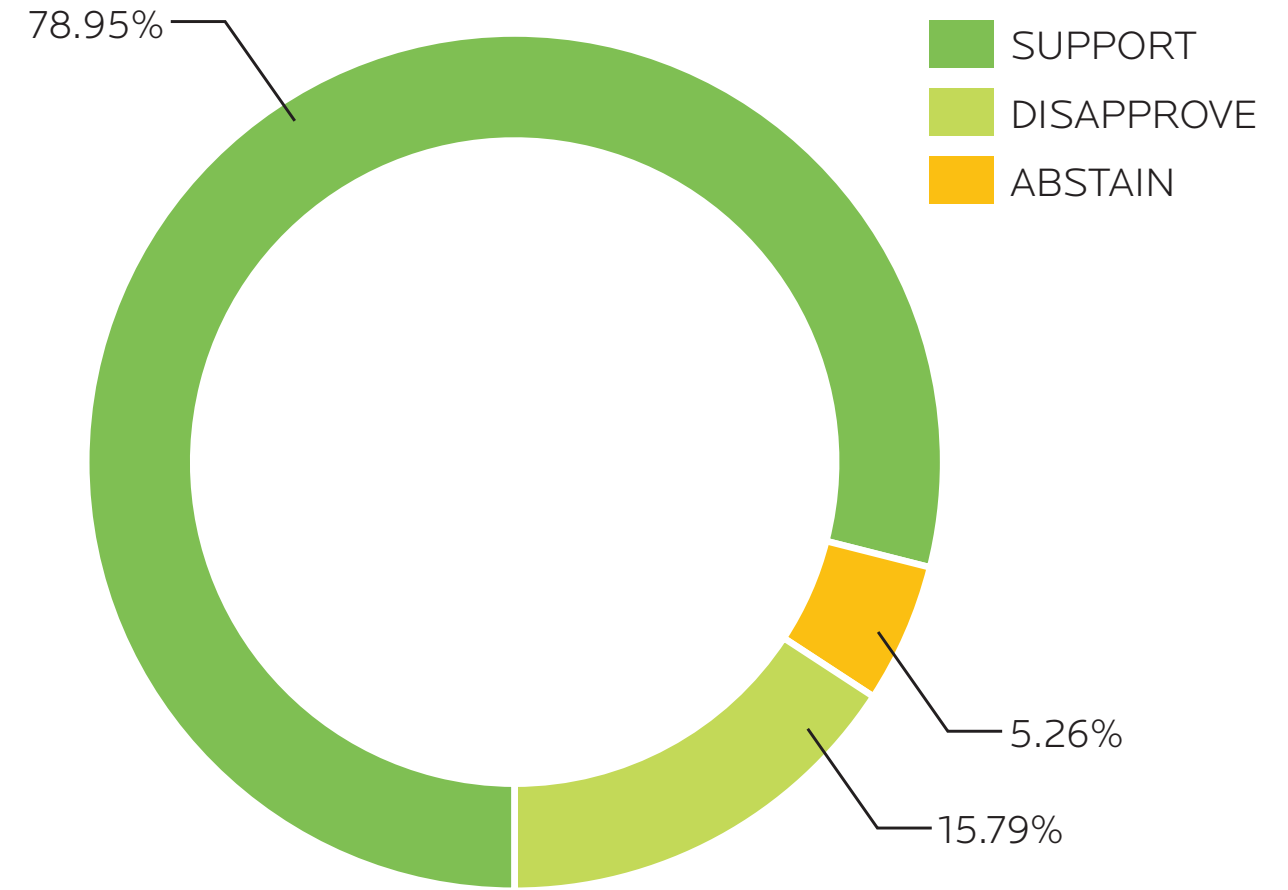
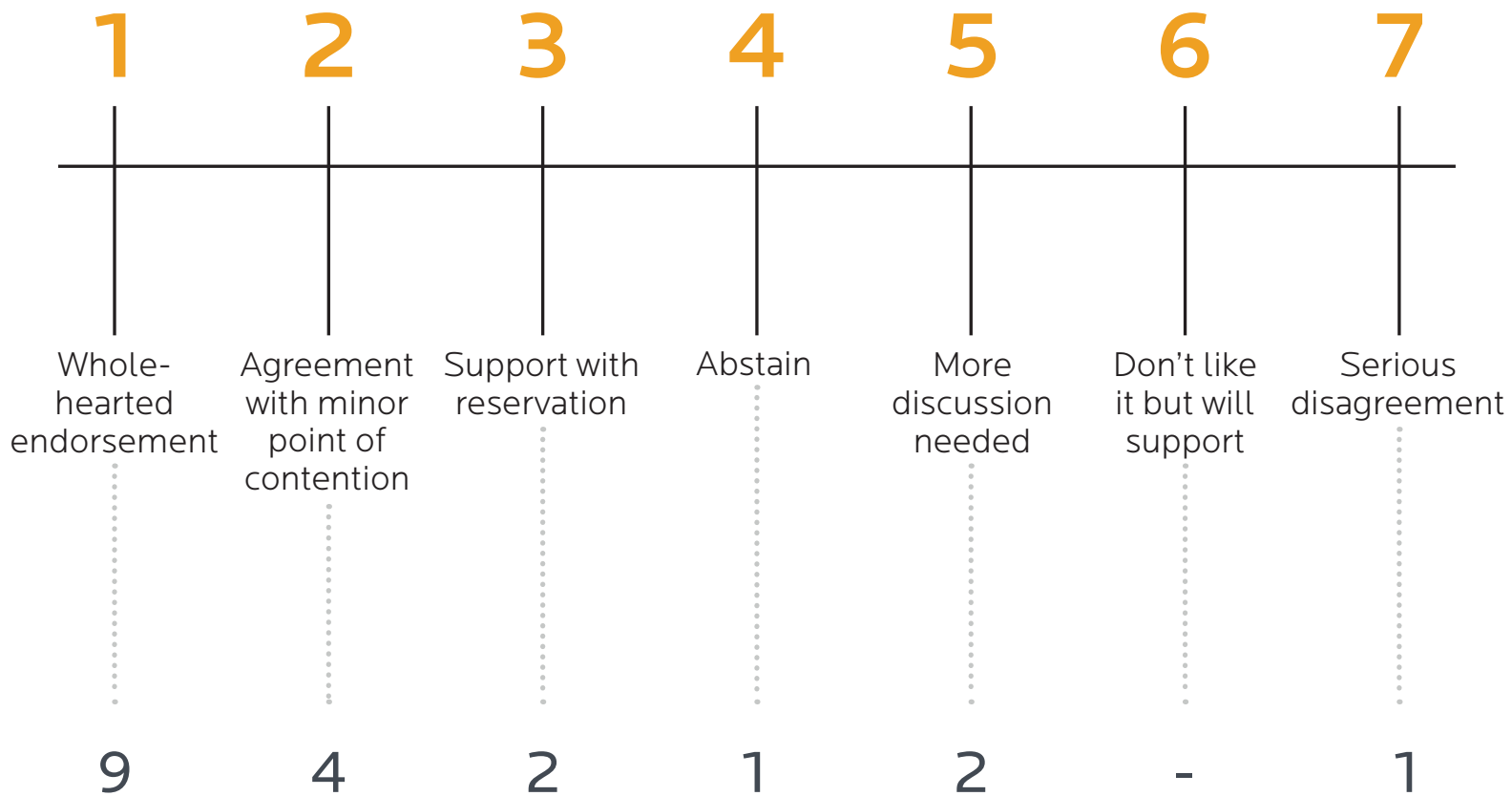

**MULTI-USE COURTS**  
19 RESPONSES

- (1) Wading pool area to be used for lawn games i.e. lawn bowling, horseshoes, lend out booth - its somewhat marked off
- (2) Tennis courts should be locked at night / what is plan to replace concrete? NYC replaces every few years. Where will the \$ come from?
- (2) Low fence around court (prevent 4-wheelers)
- (2) Reclaim for green space area - nice to add a skate park?
- (2) Would be cool to see more intentionality around area where wading pool is, something in addition to grass. Addition of volleyball nets is an easily installable accessory [on] one tennis courts would be great.
- (3) Need to ensure fencing for tennis
- (5) [more discussion needed] about bldg. improvements; courts + wading pool details; auxiliary bldg.

# MULTI-USE COURTS PHASE I PLAN

- NEW PICNIC SHELTER
  - RELOCATE COMMUNITY GARDEN
  - EXERCISE EQUIPMENT
  - RECLAIM OPEN / GREEN SPACE
  - MULTI-USE COURTS WITH CHILL ZONE
  - NEW PATHWAY ALIGNMENTS
- \$563,000

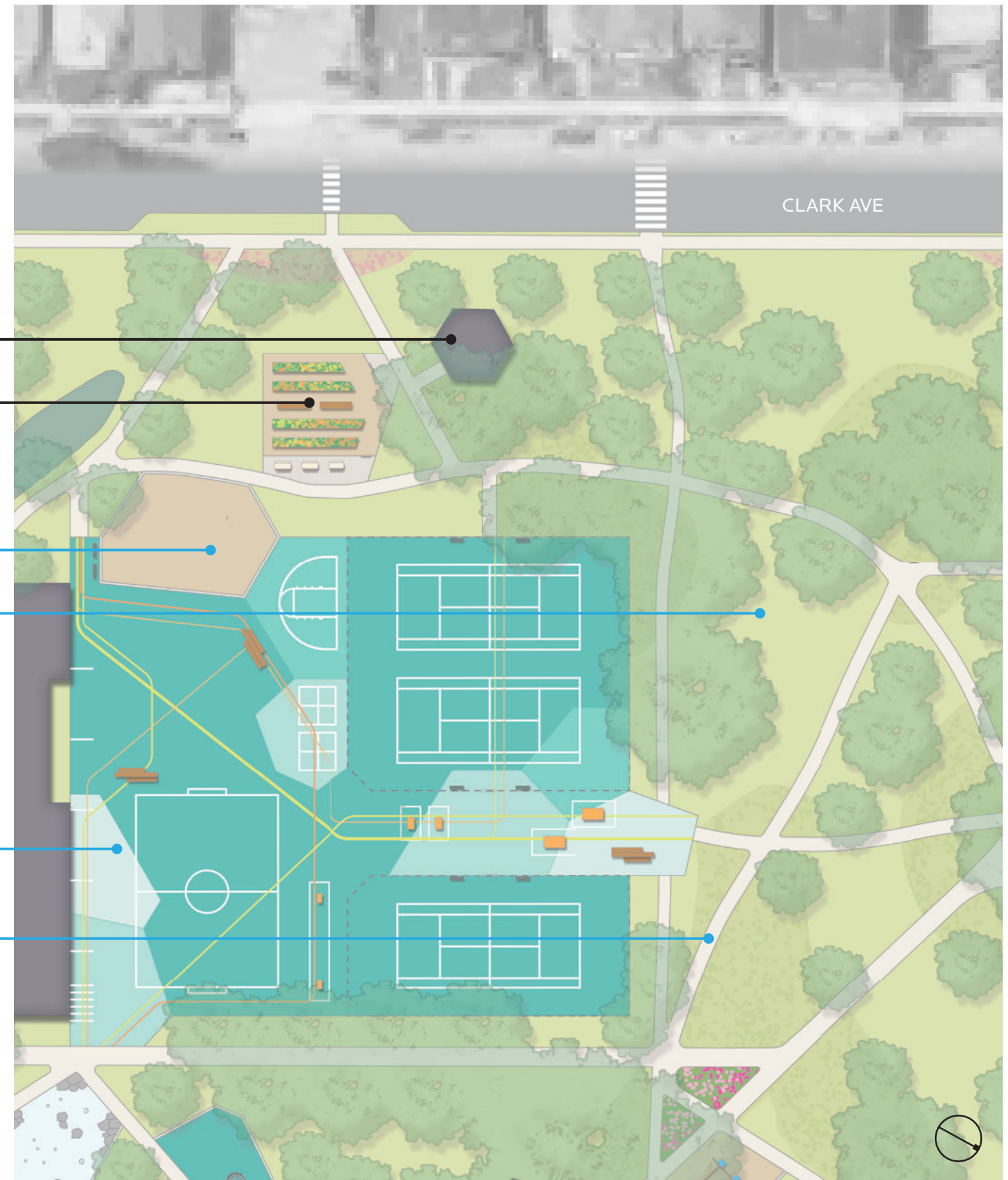

# SCOTTEN EDGE MASTER PLAN



# PLAYGROUND BUY-IN VOTING

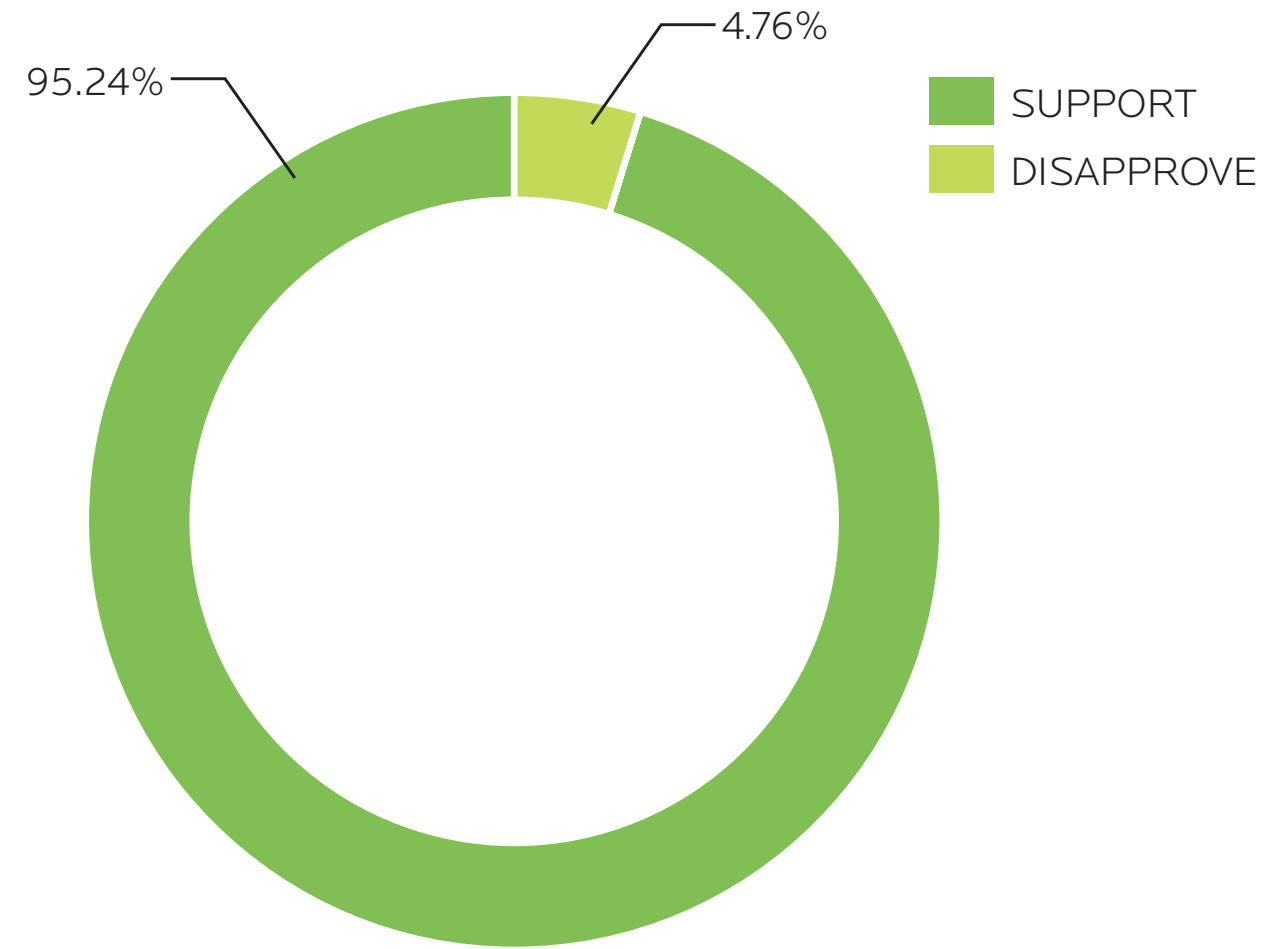
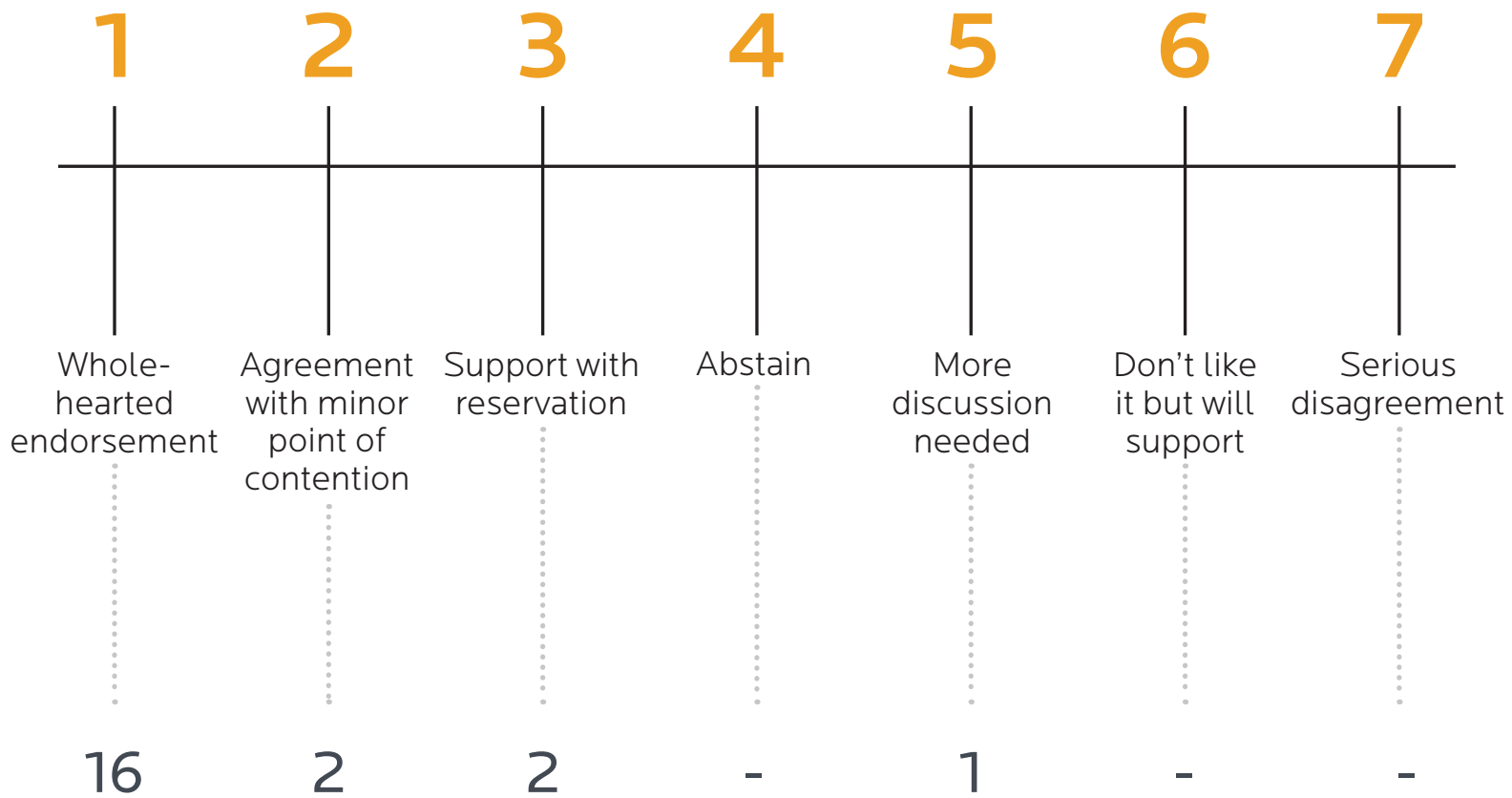

## PLAYGROUND + SPLASH PAD 21 RESPONSES

- (1) [add] rock climbing
- (1) Very nice! Need more water fountains
- (1) Please have playscape for young kids + creative play!
- (1) [heart] wooden climbing structures & natural play equipment (logs, boulders)
- (1) Splash pad + tree fort!!!
- (1) Seesaw (x2)
- (2) CPC Board Member
- (2) Need swings and classic kid toys; Ella Fitzgerald Park new stuff underutilized
- (3) What is the flooring? What will be done to prevent the homeless from bathing in the water feature? There are a lot of homeless in the area!
- (-) Seesaw

# SCOTTEN EDGE PHASE I PLAN

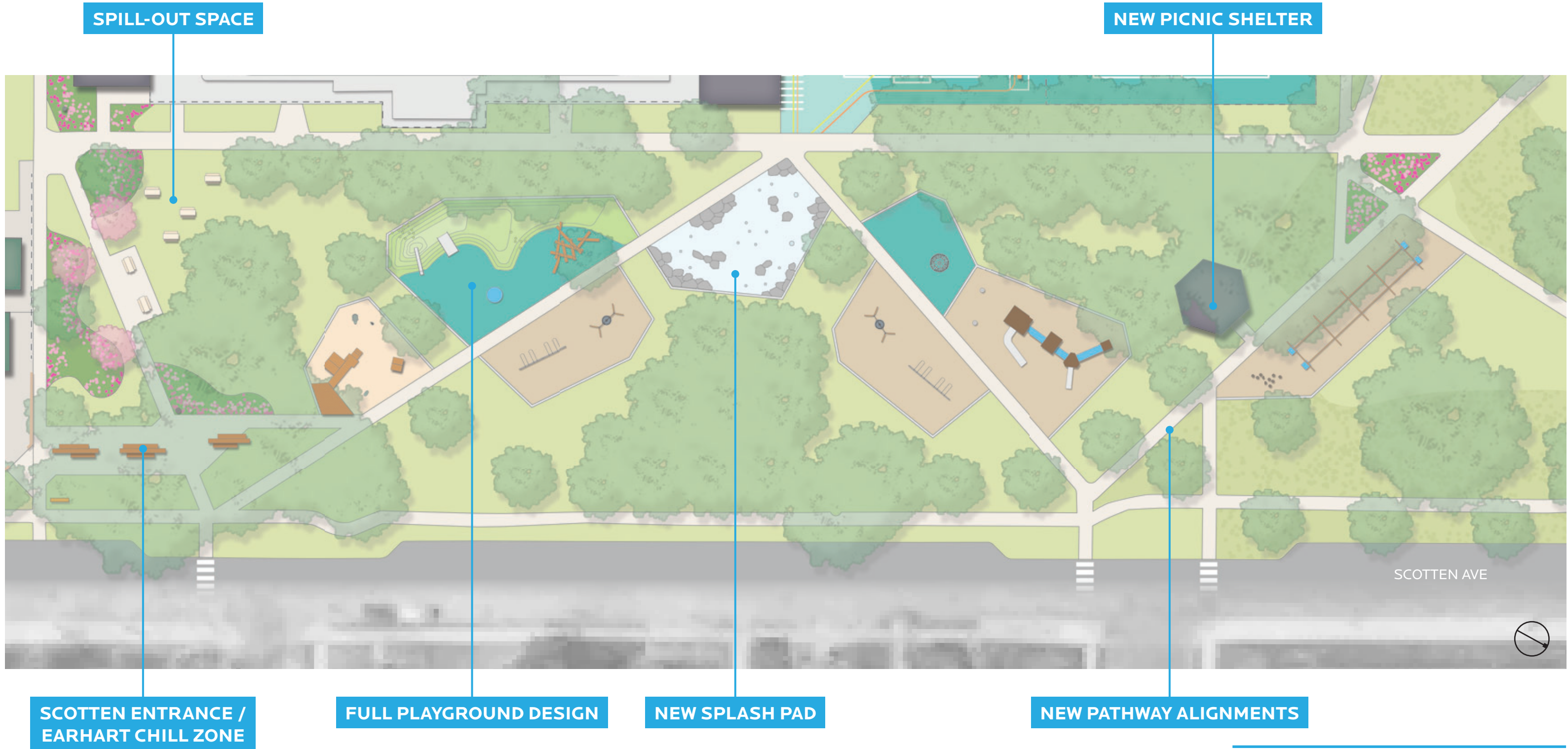

\$1,362,500



# CULTURAL ZONE MASTER PLAN



RESTORED PAVILION AND TOOL SHED WITH FAMILY PLAZA



HISTORIC AND EXISTING CONDITIONS OF BUILDINGS



# CULTURAL CENTER BUY-IN VOTING

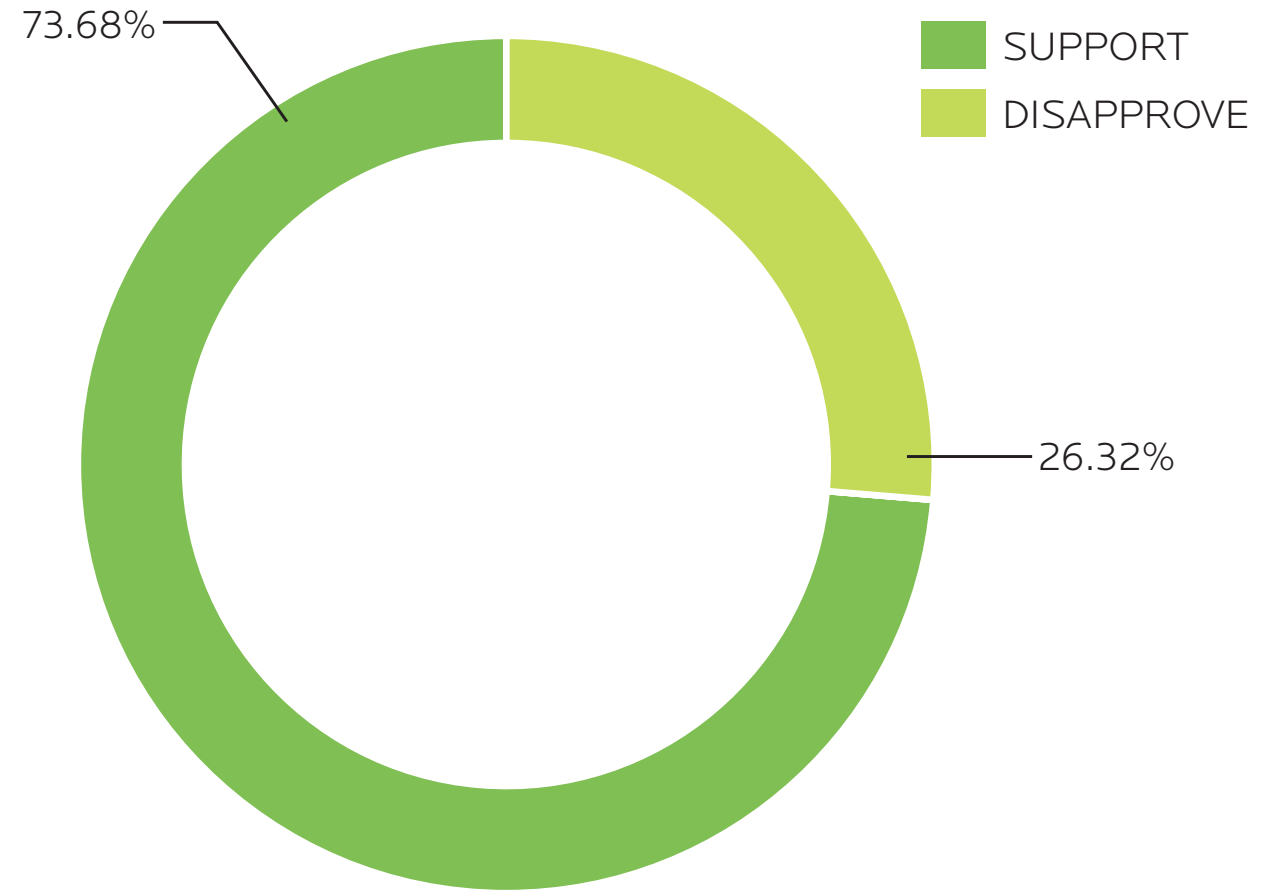
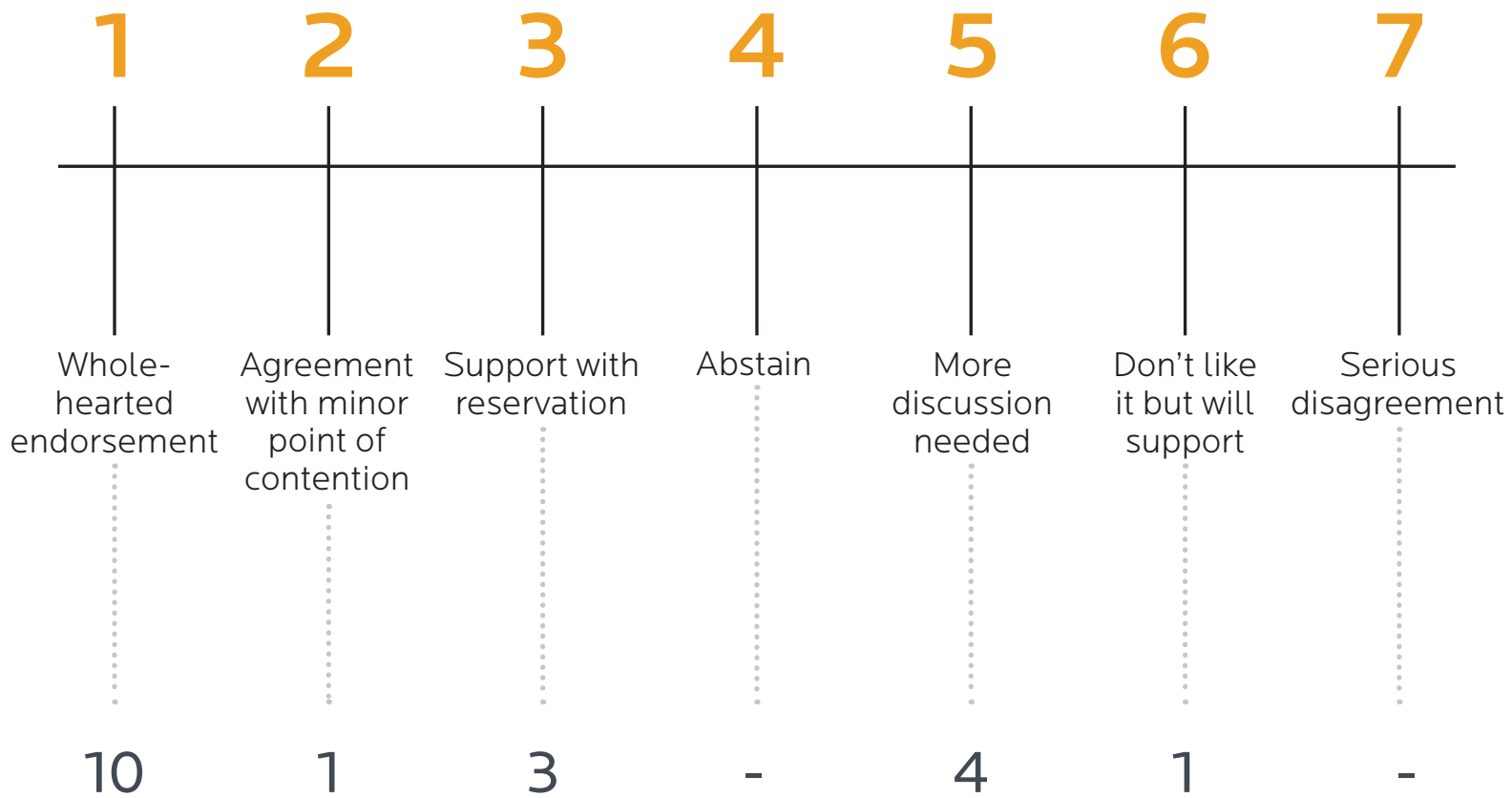

**CULTURAL CENTER**  
19 RESPONSES

- (1) Endorsement of restoration of pavilion, but not doing it in stages. I worry that it won't be secure. It should be done first.
- (1) Current amphitheater needs cover / shade. We have to cancel events for rain :( lighting would be great too!
- (1) NEED BATHROOMS!
- (1) Yay for bathrooms & preserving old buildings
- (3) Good to expand stage - making it more versatile for entertainment, maybe live plays for students
- (3) Big ice rink too intimidating for families w/ small children. Would like to use area by pavilion in winter for skating for families with small children.
- (3) Long-term for me, not short-term
- (5) I think all of these things look beautiful but I'm not sure that the park and its staff have the capacity to manage and maintain the additional infrastructure for the long term future.
- (5) [previous circled 3, then crossed out] The hill is an issue.
- (5) Improve existing parking in front of existing small brick building; yes = mothball + prevent water and open when funds can fully renovate + use year-round with A/C + heating; not open temporarily for homeless + negative behavior access.

# WHS ENTRANCE BUY-IN VOTING

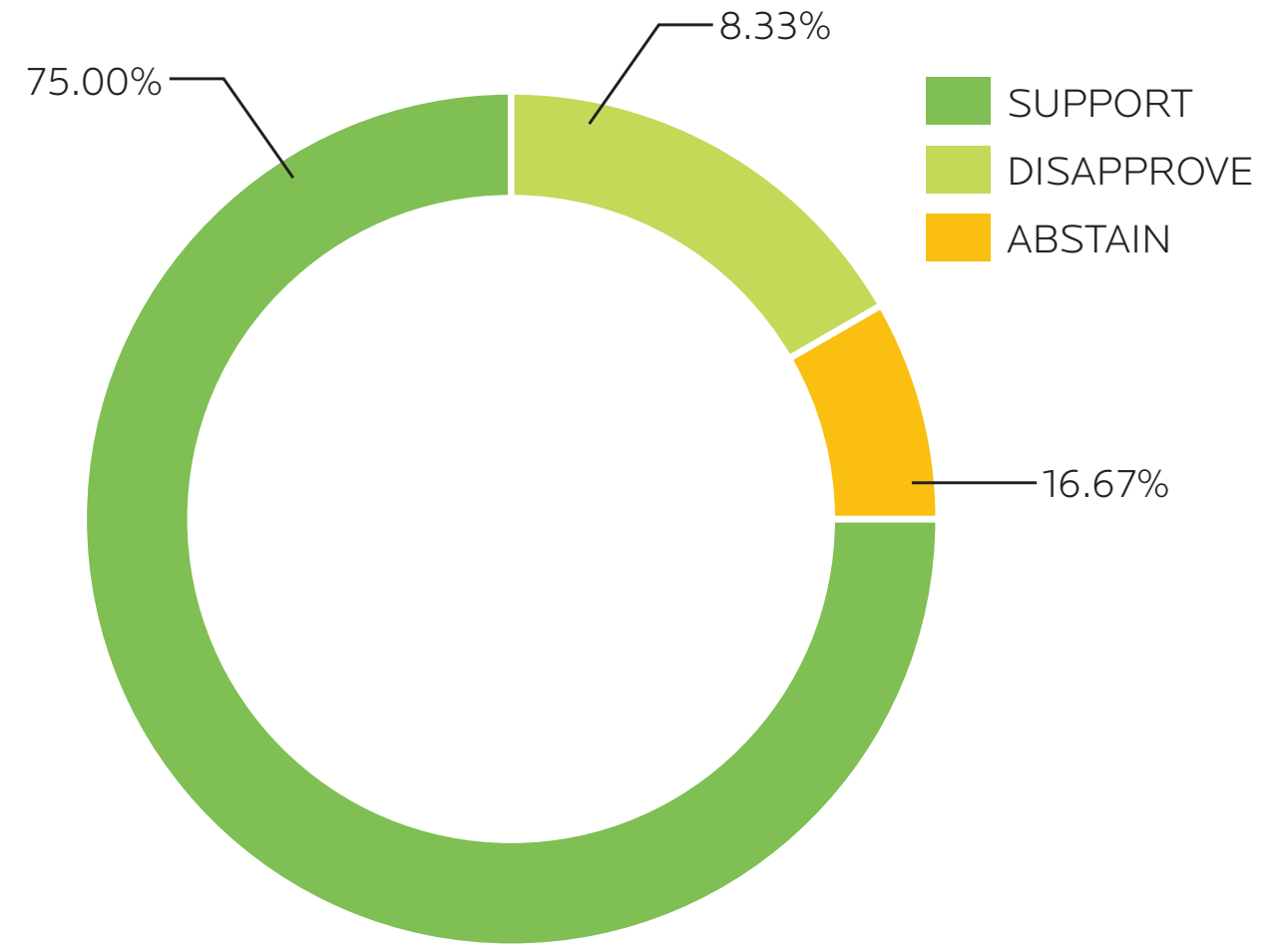
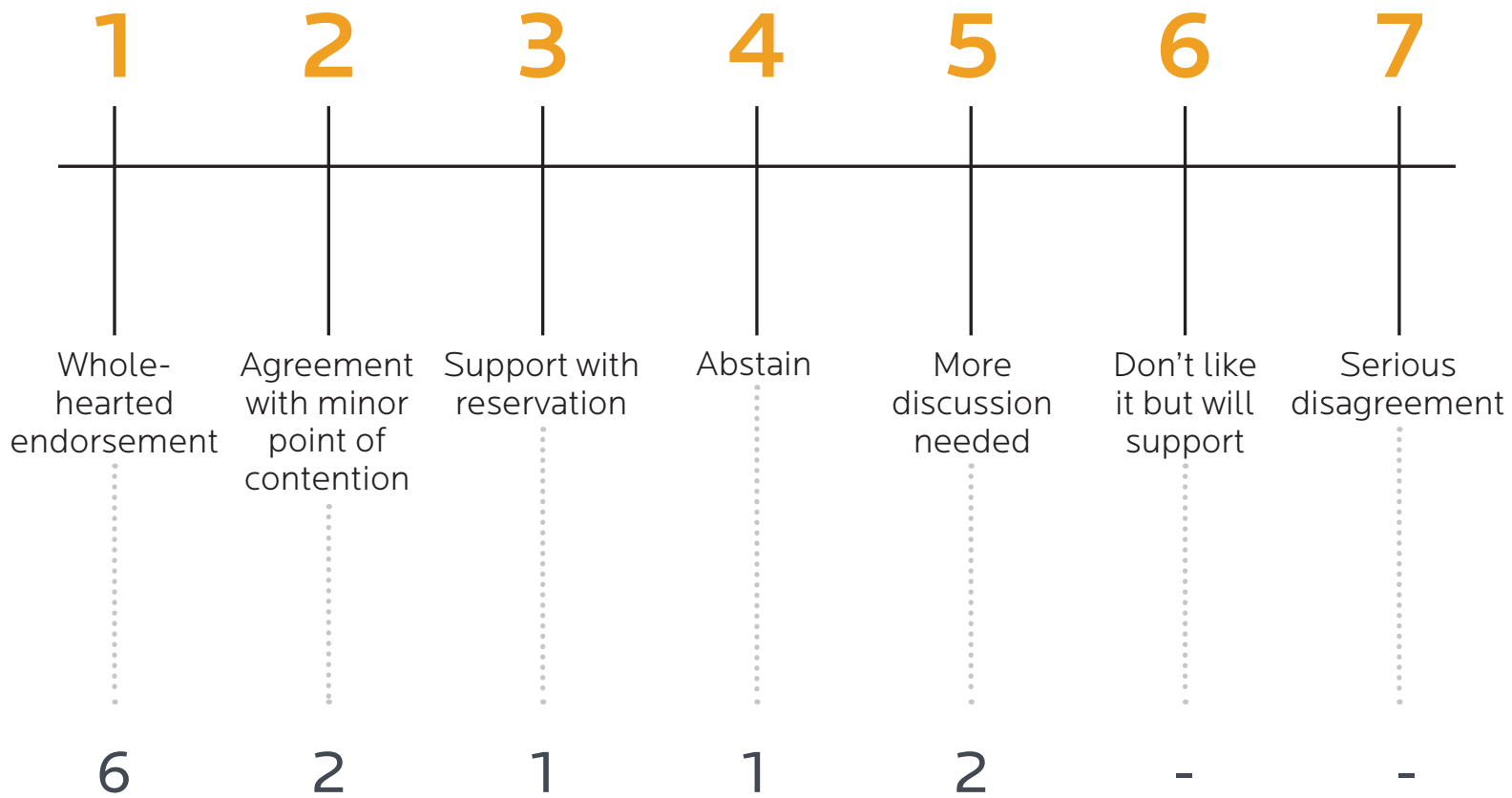

**WESTERN HS ENTRANCE**  
12 RESPONSES

- (1) CPC Board Member
- (2) Since playground is here, this and Scotten / Earhart REALLY matter
- (5) [Would] like to see more ideas.
- (5) Be more creative; no more concrete! Delineate the space in a natural way w/ perennial plantings, low lying shrubs w/ black iron benches & black iron picnic tables under woodchips.

# CULTURAL ZONE PHASE I PLAN

- LANDSCAPE IMPROVEMENTS
  - RELOCATE SERVICE PARKING LOT
  - RESTROOMS, STORAGE AND CONCESSIONS
  - EXTERIOR UPGRADES + MOTHBALL**
  - RESTORE PAVILION
  - PARTIAL RESTORATION**
  - AMPHITHEATER IMPROVEMENTS
  - STAGE IMPROVEMENTS**
  - RENTAL SPACE / VENUE
  - EXTERIOR UPGRADES + MOTHBALL**
  - PATIO + GARDEN**
  - WESTERN HIGH SCHOOL ENTRANCE
  - NEW PICNIC SHELTER**
- 
- \$758,000

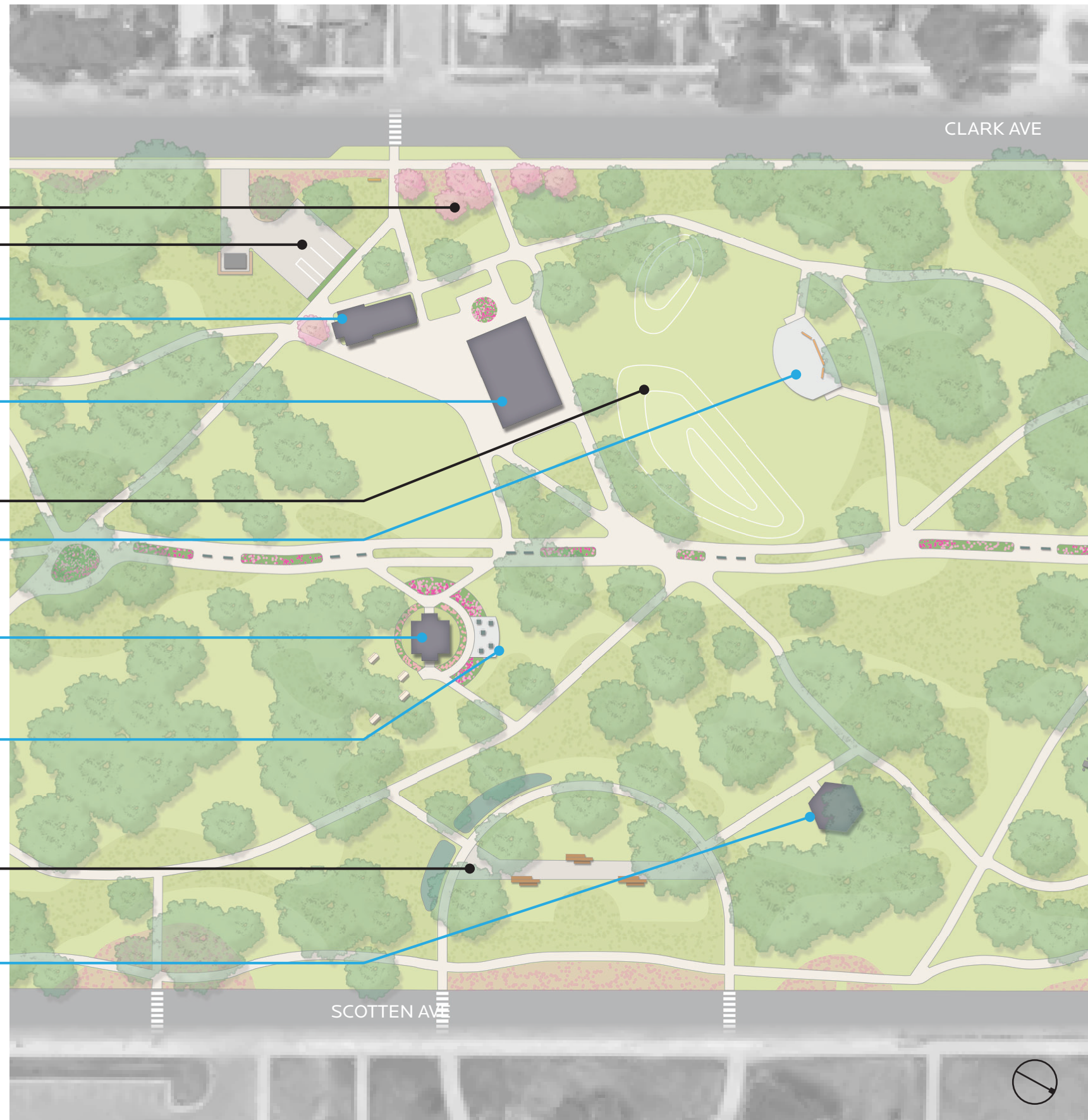

# PASSIVE ZONE MASTER PLAN



# VERNOR EDGE BUY-IN VOTING

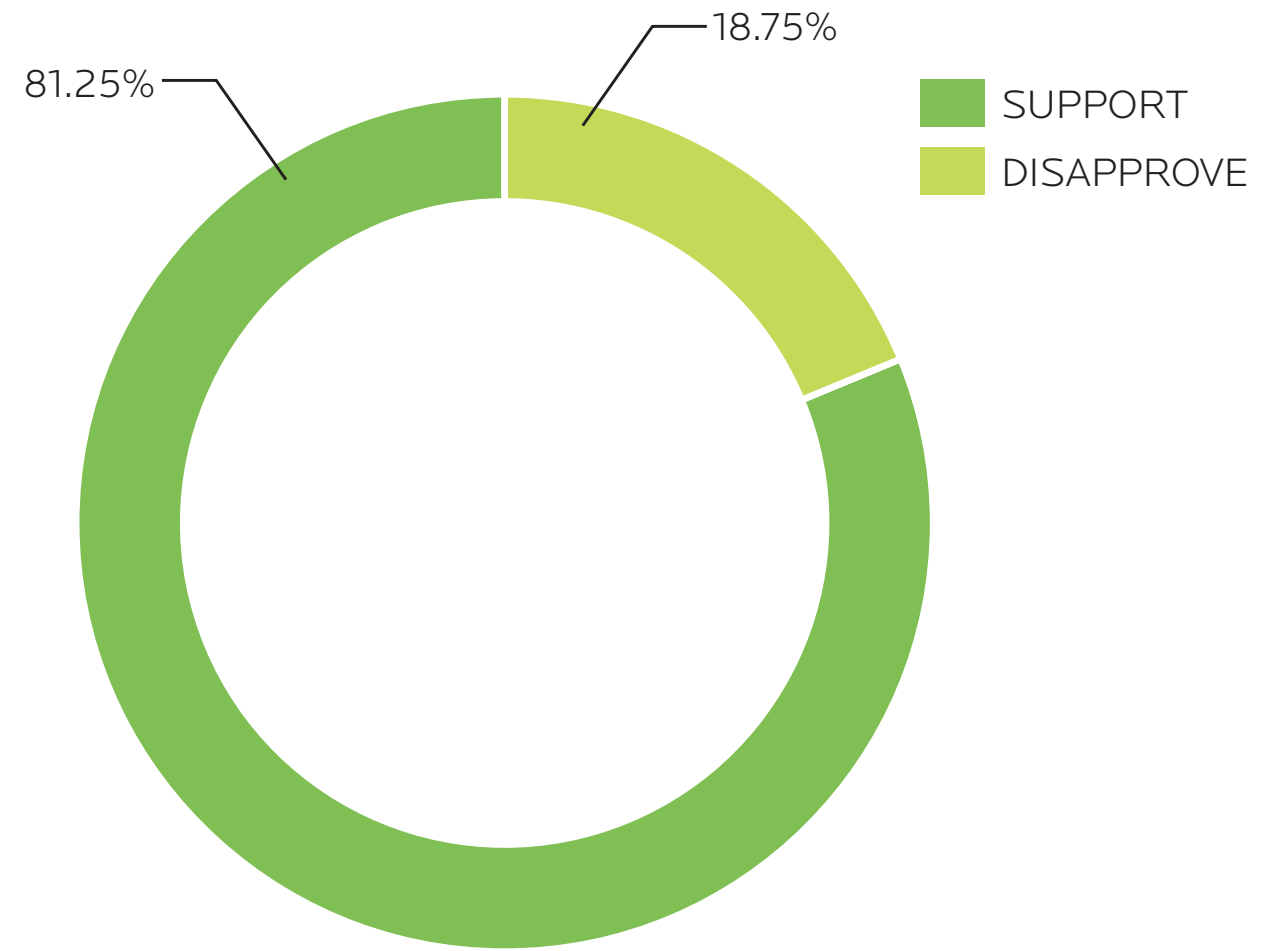
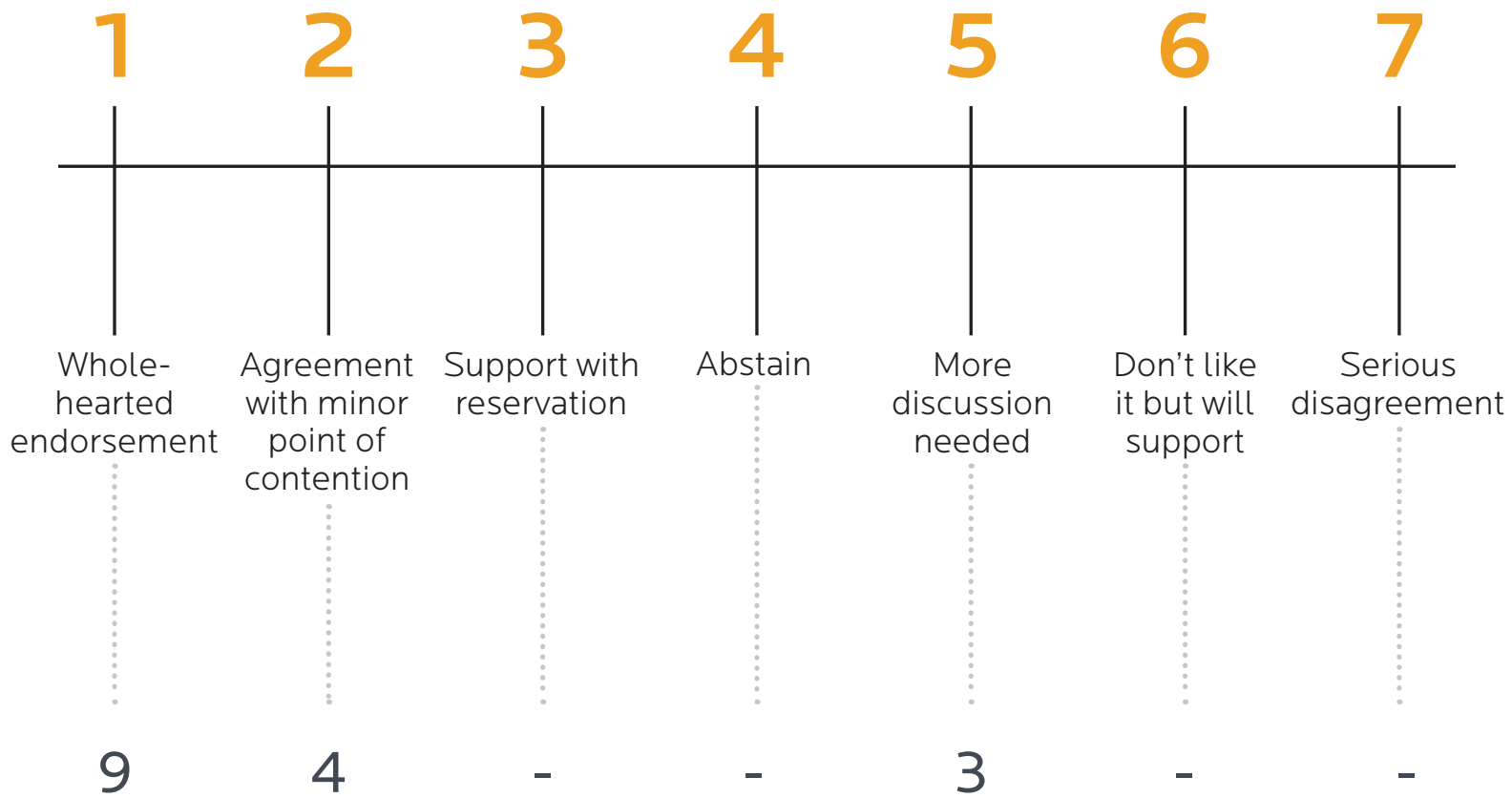

## VERNOR STREETSCAPE 16 RESPONSES

- (1) Very nice :)
- (1) CPC Board Member
- (1) BEAUTIFUL!
- (1) Love this idea
- (2) Crosswalks on Vernor
- (2) What about pedestrian island? Speed bumps?
- (2) Need crossing @ Clarkdale
- (5) Like the concept, however (Clarkdale) the street leading to the park needs safe crossing
- (5) More space for turning congested area
- (5) Physical spacial references needed for CPC team; there are 2 mosaic tile artistic benches created by local artists & WHS students & Cranbrook students that need to be incorporated

# PASSIVE ZONE PHASE I PLAN

CIRCUIT PATHWAY CONNECTIONS

TREE REPLACEMENT STRATEGY

HISTORIC FOUNTAIN / REFLECTIVE SPACE

RESTORE CONNECTION

VERNOR STREETScape + PLAZA

\$426,000

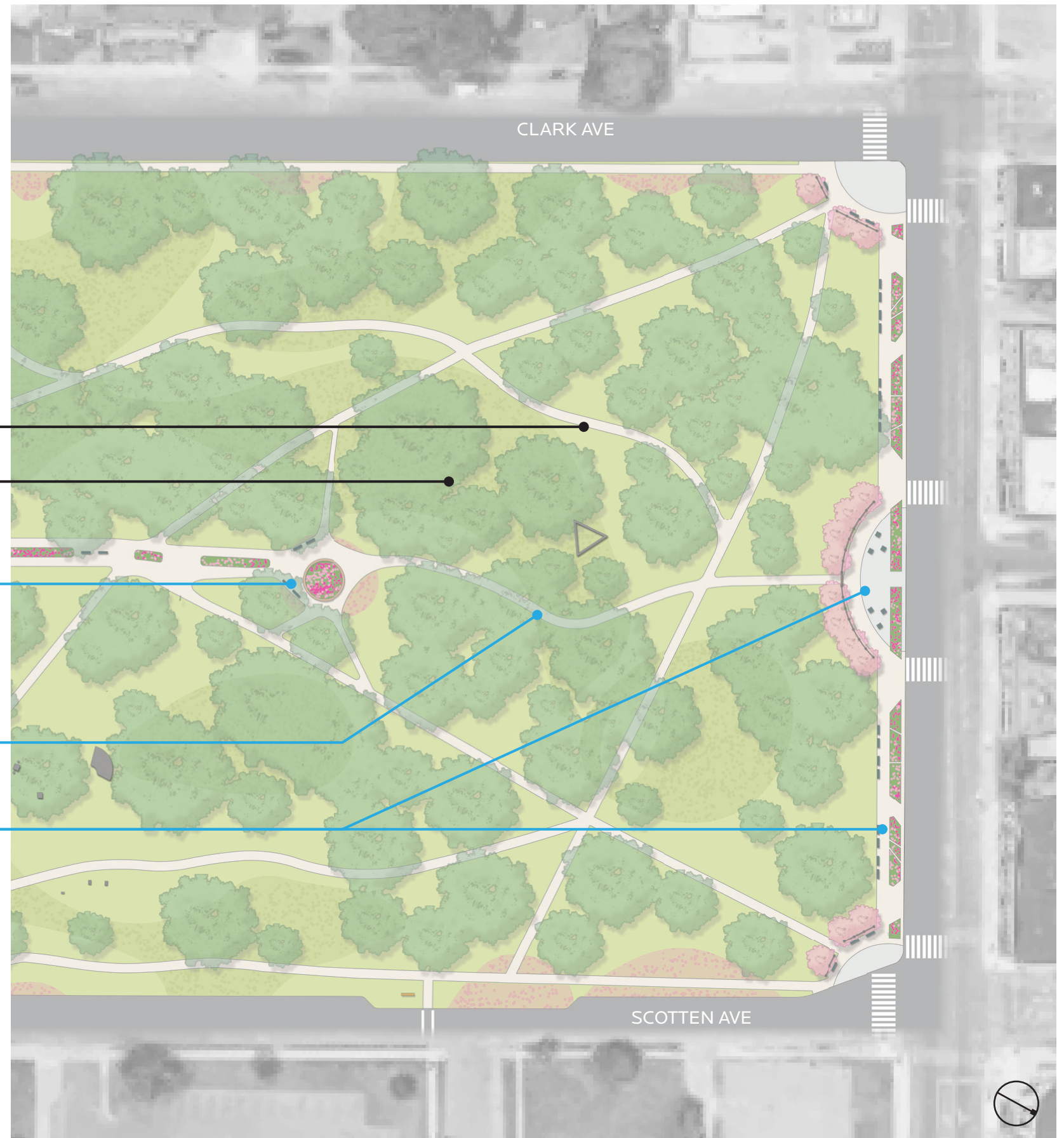

# PATHWAYS MASTER PLAN

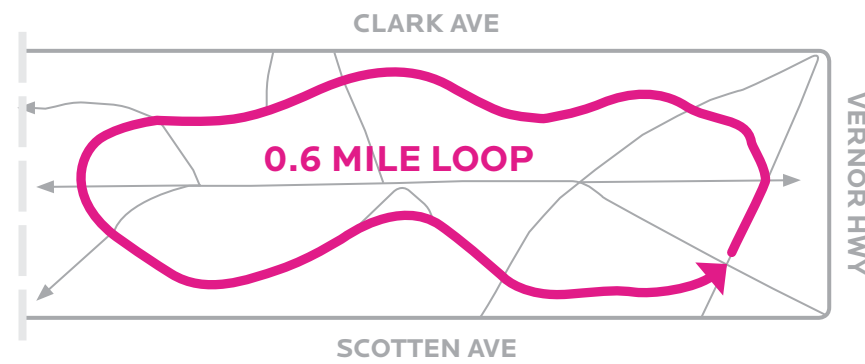
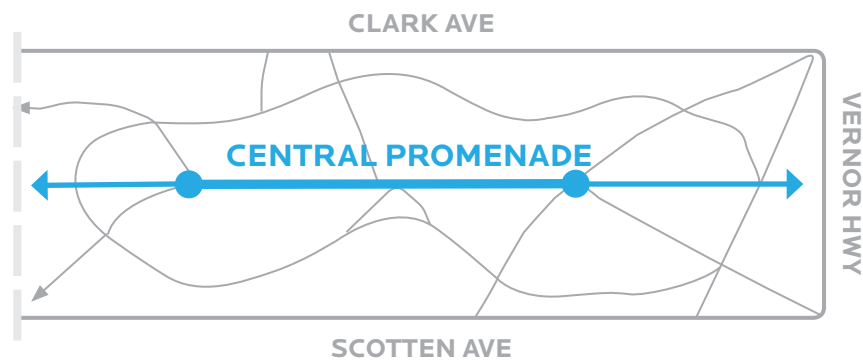
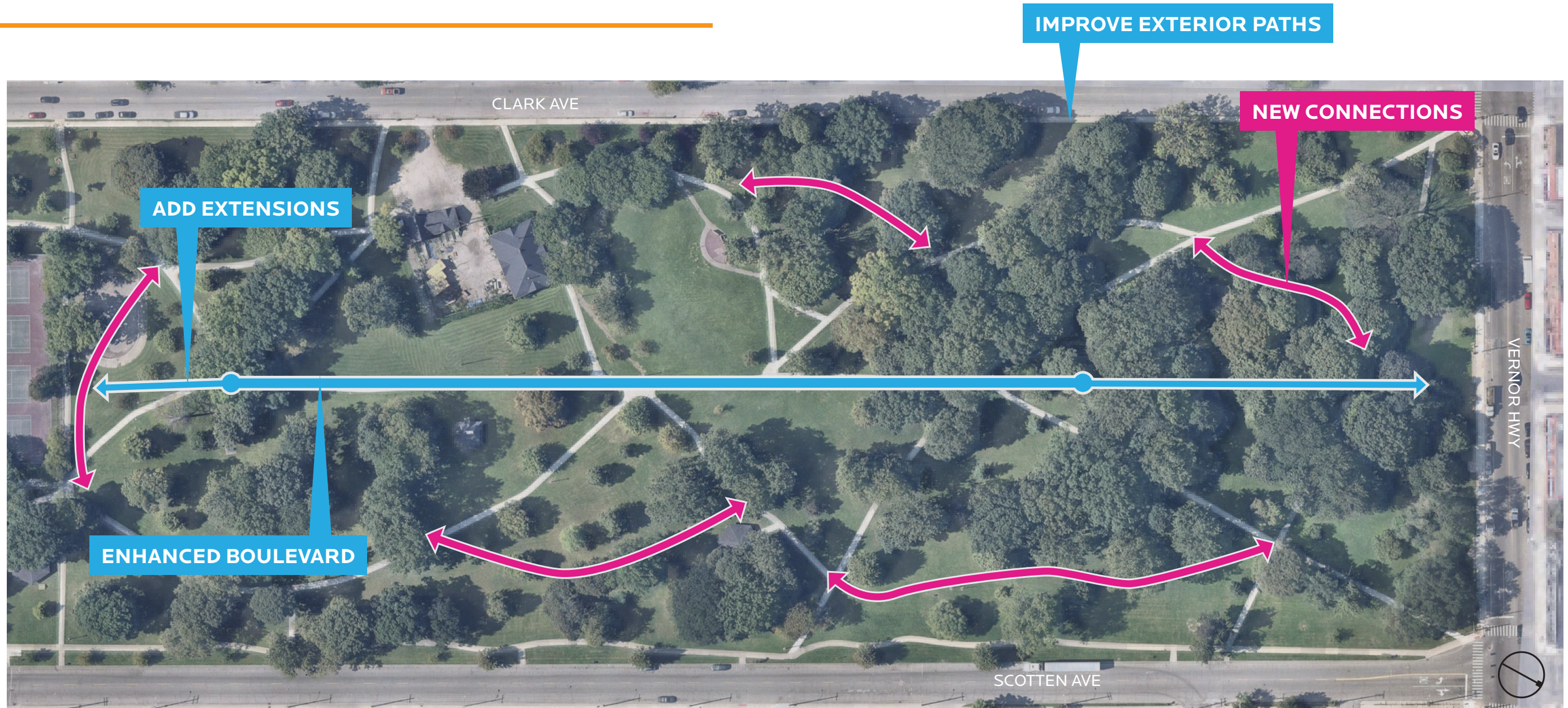



# PATHWAYS BUY-IN VOTING

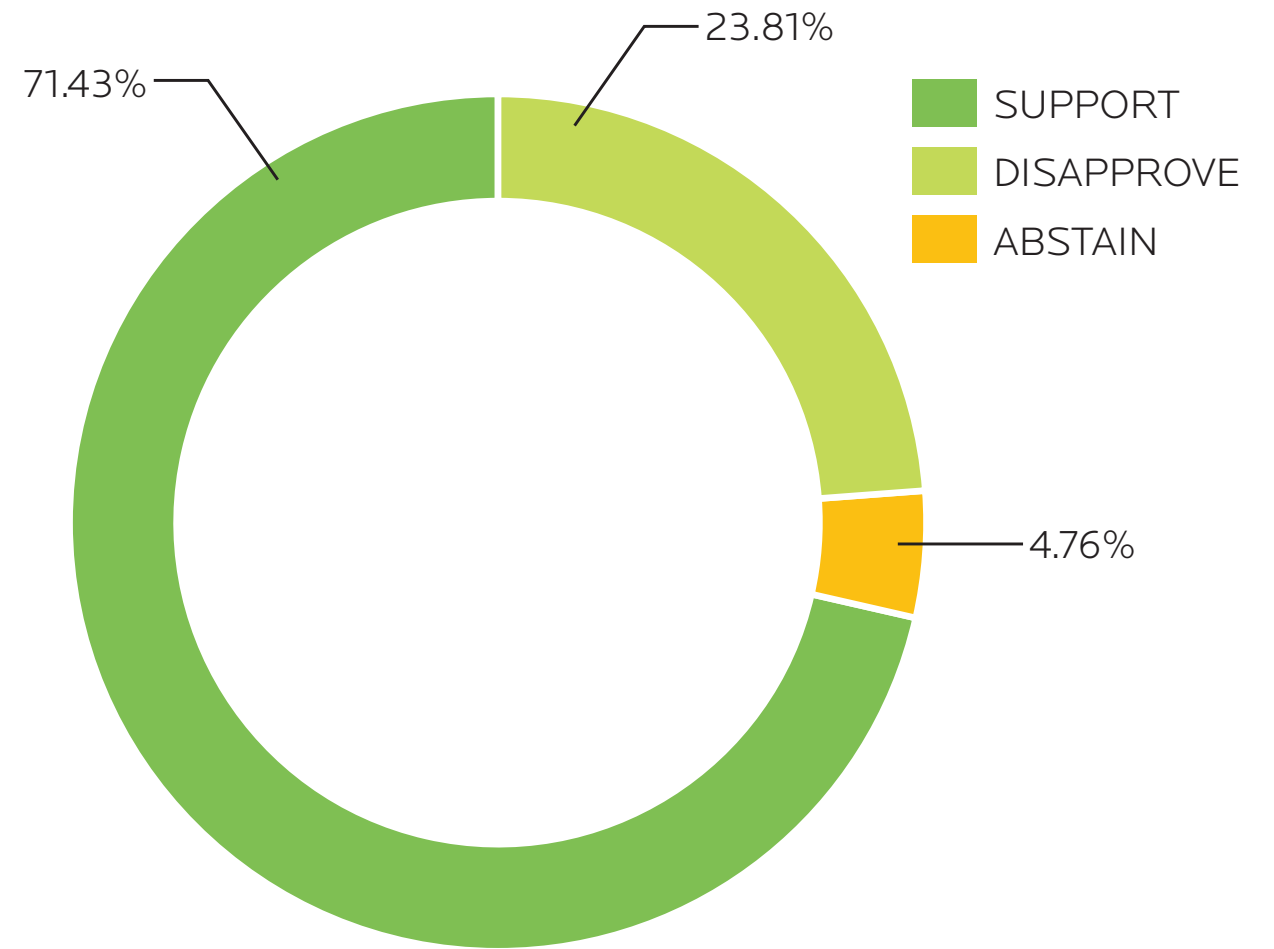
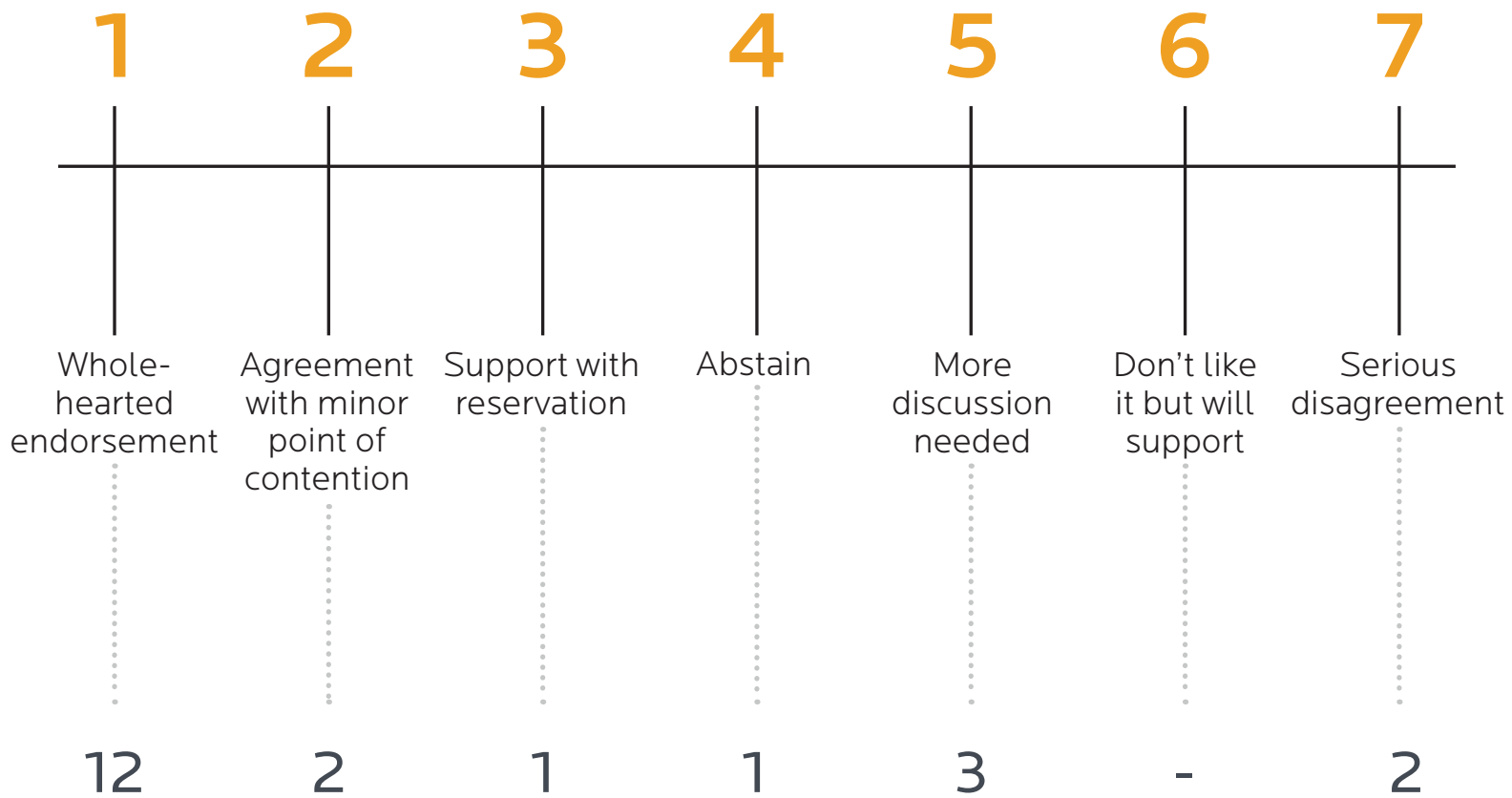

**PATHWAYS**  
21 RESPONSES

- (1) I agree!
- (2) Some non-paved paths for running ... nicer on the knees :) (they can be adjacent to paved)
- (3) Concern about more concrete paths in passive zone
- (4) Like the loop but not the pathway [boulevard?]
- (5) CPC Board Member
- (5) Needs more sidewalks outside not inside
- (5) Yes to widening outside
- (7) No widening inside
- (7) No additional concrete, no additional hardscaping; no widening "inside" pathways; only widen 5.5' sidewalk around perimeter of CP to 7 ft. wide towards city berm

# PATHWAYS PHASE I PLAN

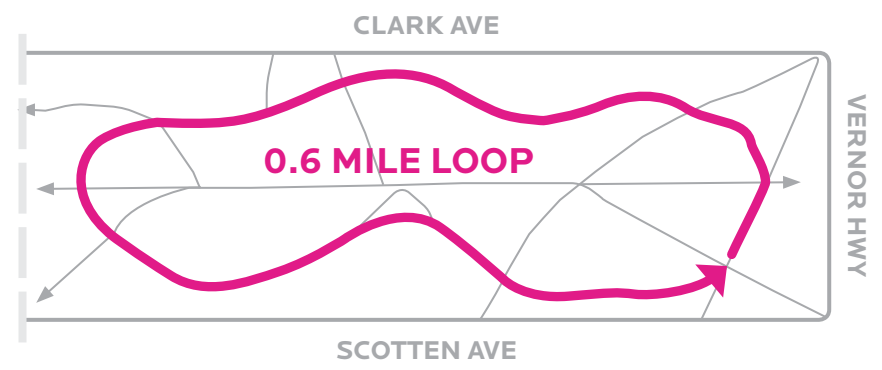
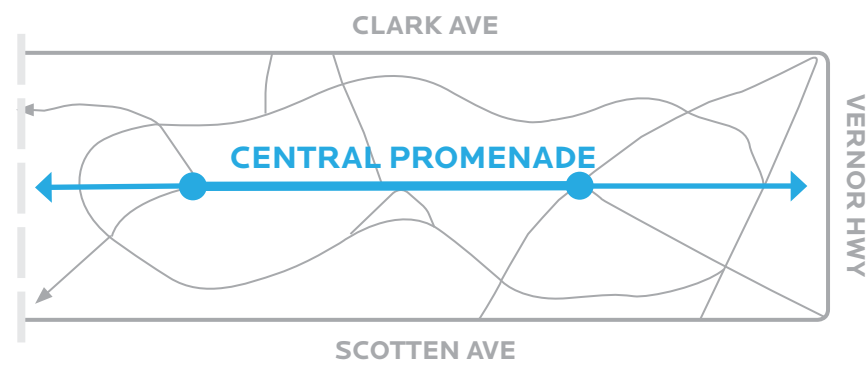
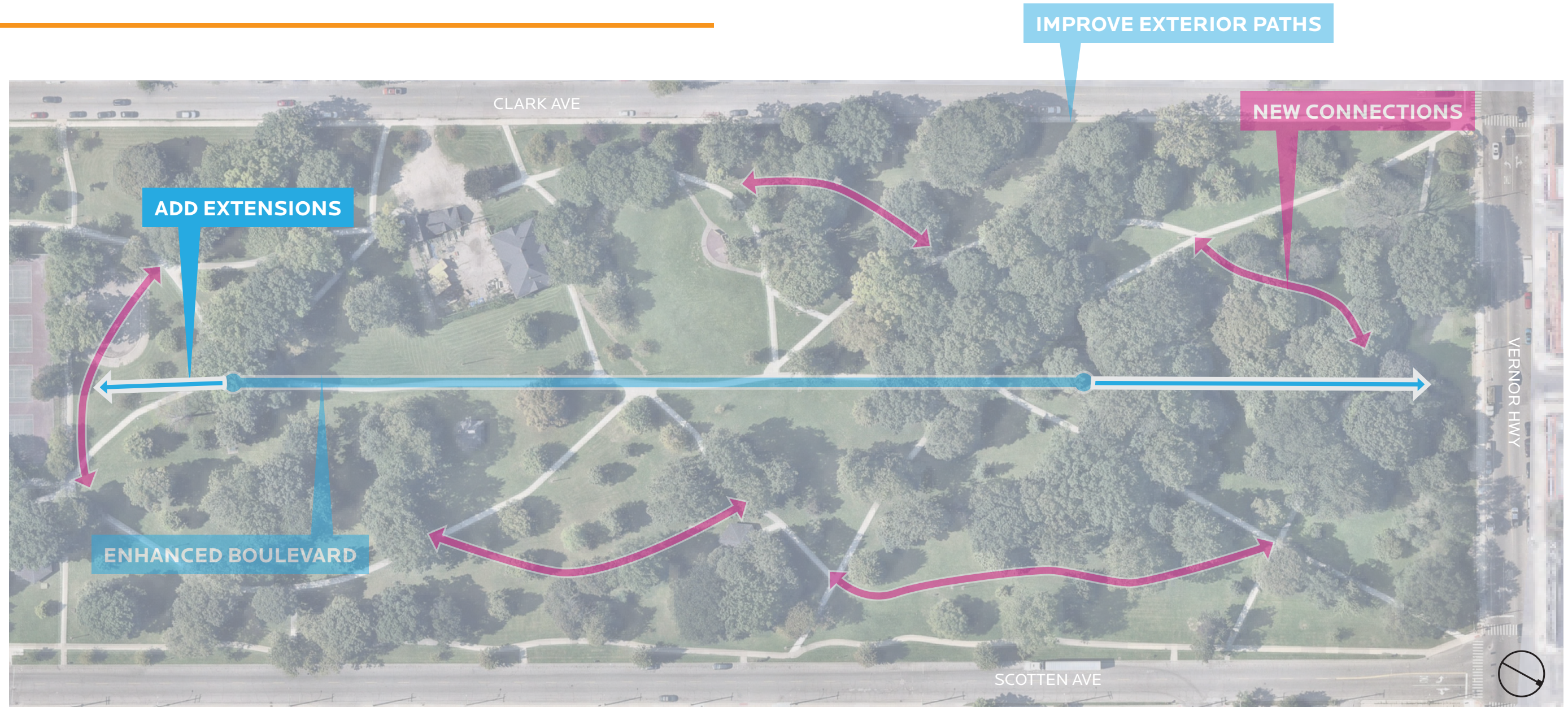

COST IN PREVIOUS TOTALS

# LANDSCAPE MASTER PLAN



RENDERING OF PROPOSED GROUNDCOVER



HISTORIC PHOTOS OF ORNAMENTAL PLANTINGS



# LANDSCAPE BUY-IN VOTING

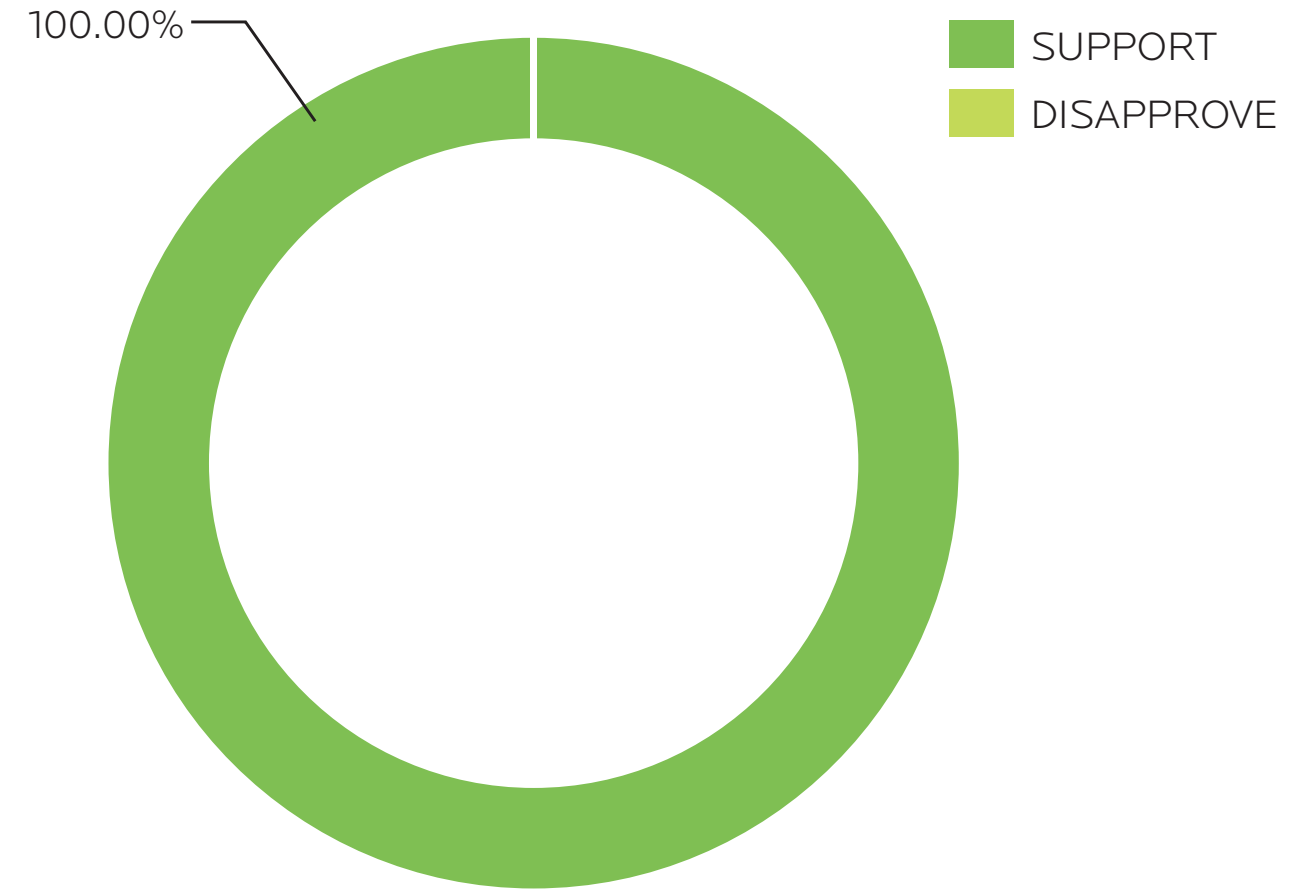
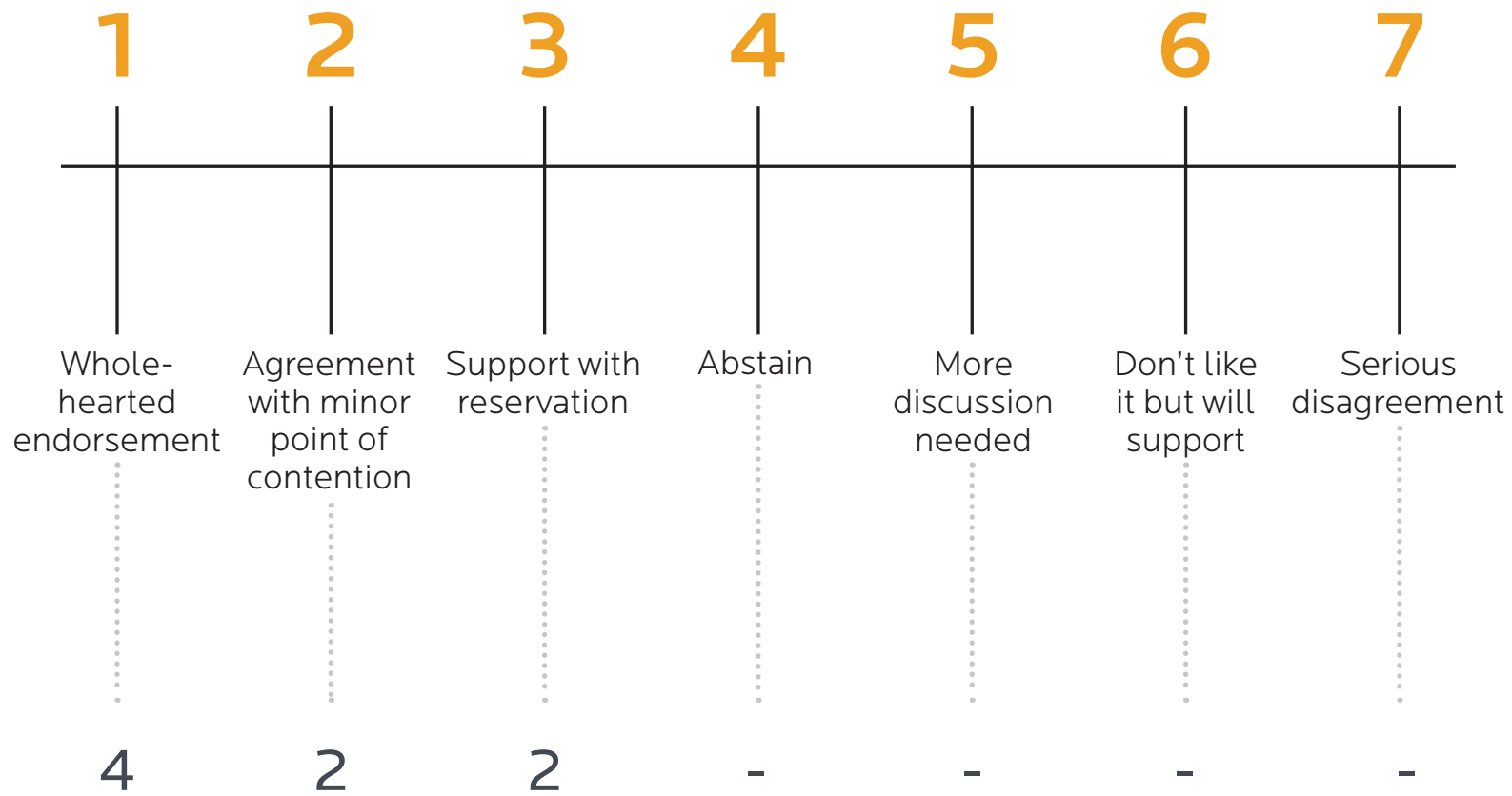

**LANDSCAPE ENHANCEMENTS**  
8 RESPONSES

- (2) Unclear poster; current planters intended
- (3) They're fine but not a priority for me
- (-) Harvest any removed trees - save resources for community

# LANDSCAPE MASTER PLAN

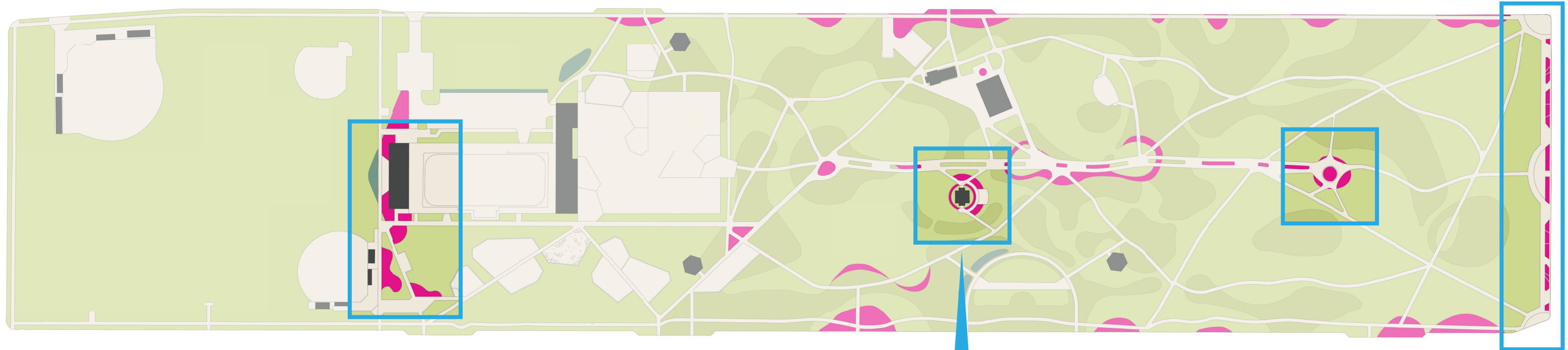

SELECTIVE PERENNIAL /  
ORNAMENTAL PLANTINGS



RENDERING OF PROPOSED GROUNDCOVER

COST IN PREVIOUS TOTALS

# TREE HEALTH MASTER PLAN

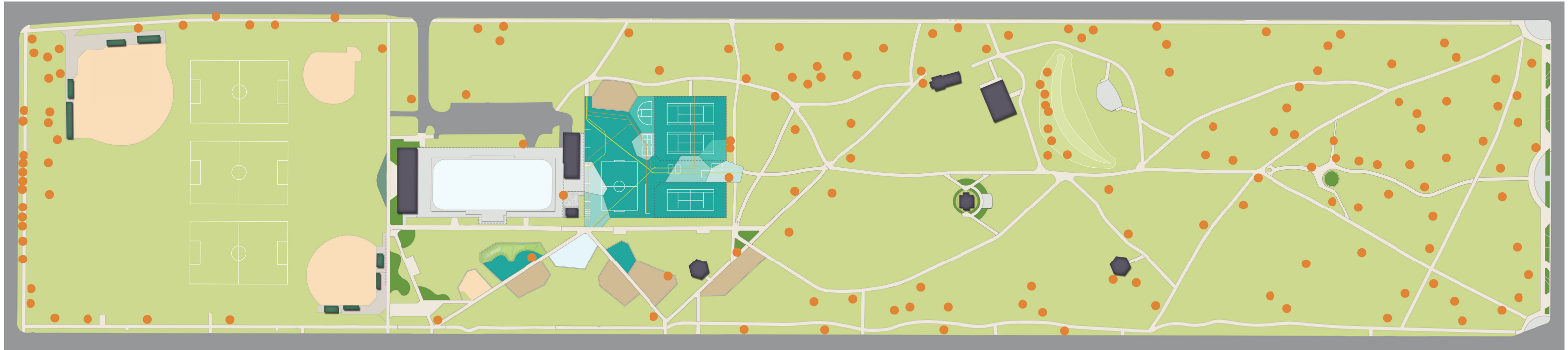

# TREE HEALTH BUY-IN VOTING

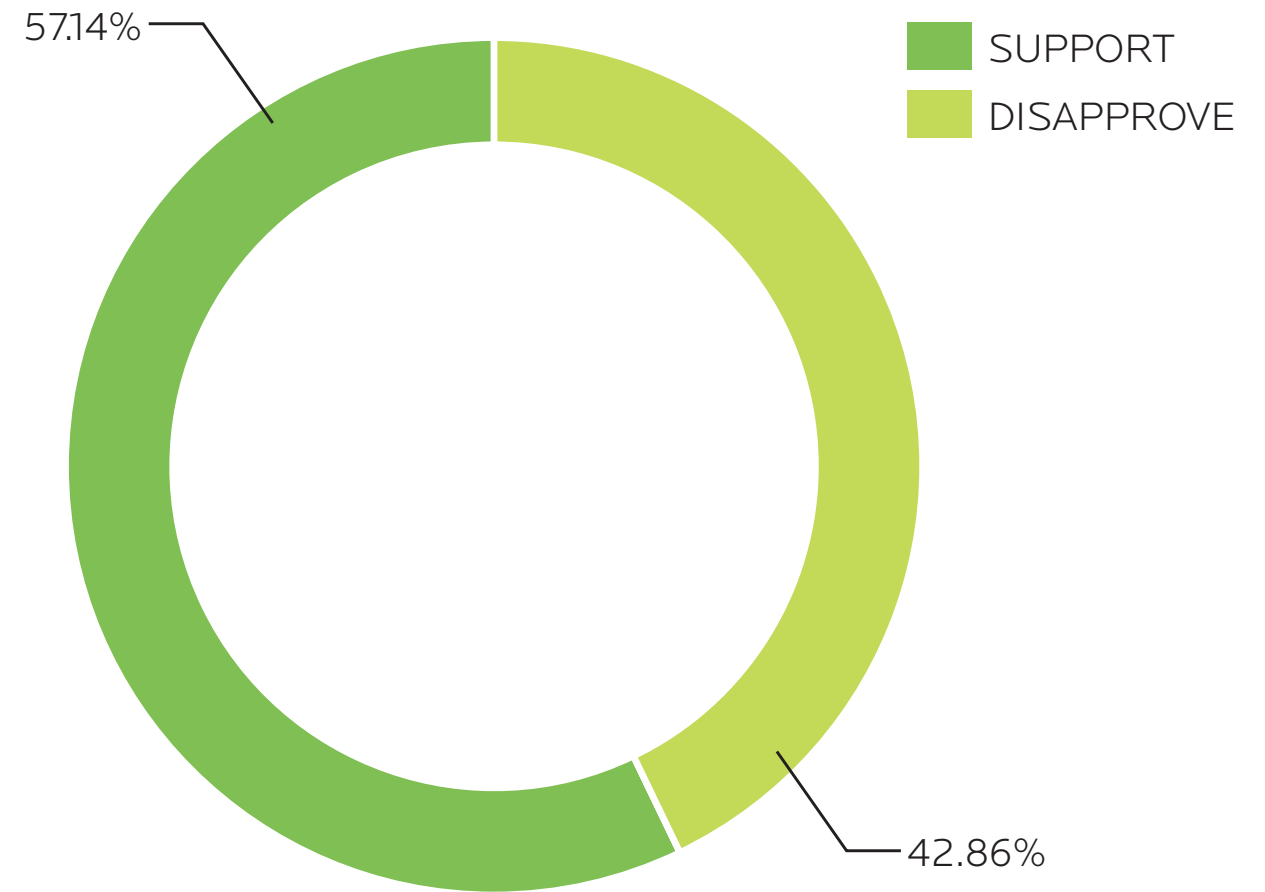
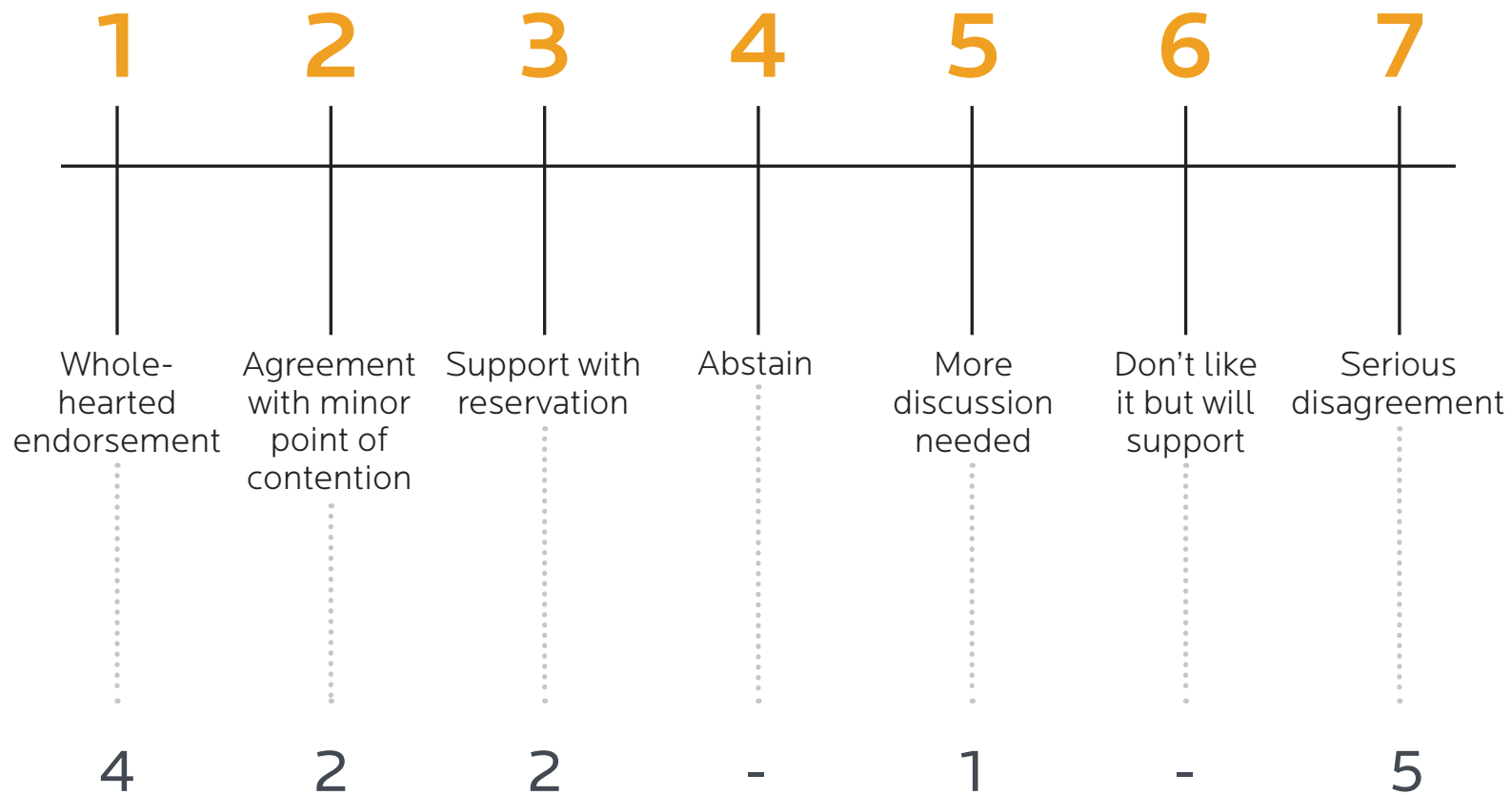

**TREE HEALTH**  
14 RESPONSES

- (1) Healthy forest is a high priority!
- (1) But do not remove trees unless confirmed they are diseased
- (5) Need examples of parks where the naturalized areas work in such a small (1 block wide) park area. Not opposed but am concerned it will look like overgrown grass (i.e. ugly)
- (7) We should not be taking all of these trees down. Of course, if tree is a hazard and is about to fall that is different but we don't want the open area w/o shade and tree cover
- (7) Build up the current canopy
- (7) No wiping out of Norway Maples
- (7) No taking out of Norway Maples. CPC Board Member
- (7) Please keep Norway Maples

# TREE HEALTH PHASE I PLAN

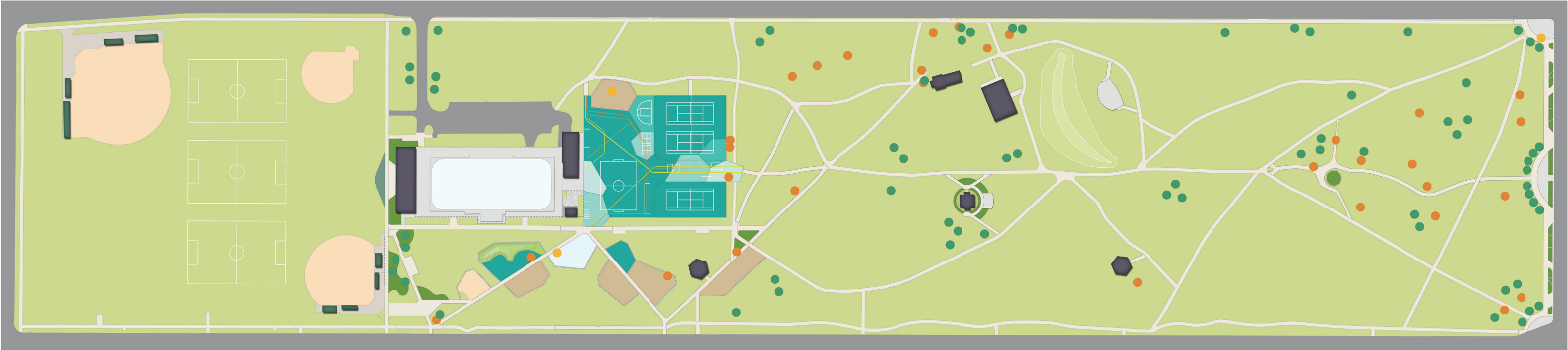

- (32) INVASIVE / FAILING TREES DESIGNATED BY ARBORIST
- (2) NON-INVASIVE TREES IMPACTED BY PH I DESIGN
- (60) TREES ADDED THROUGH PH I DESIGN

COST IN PREVIOUS TOTALS



# COMMUNITY PRIORITIZATION

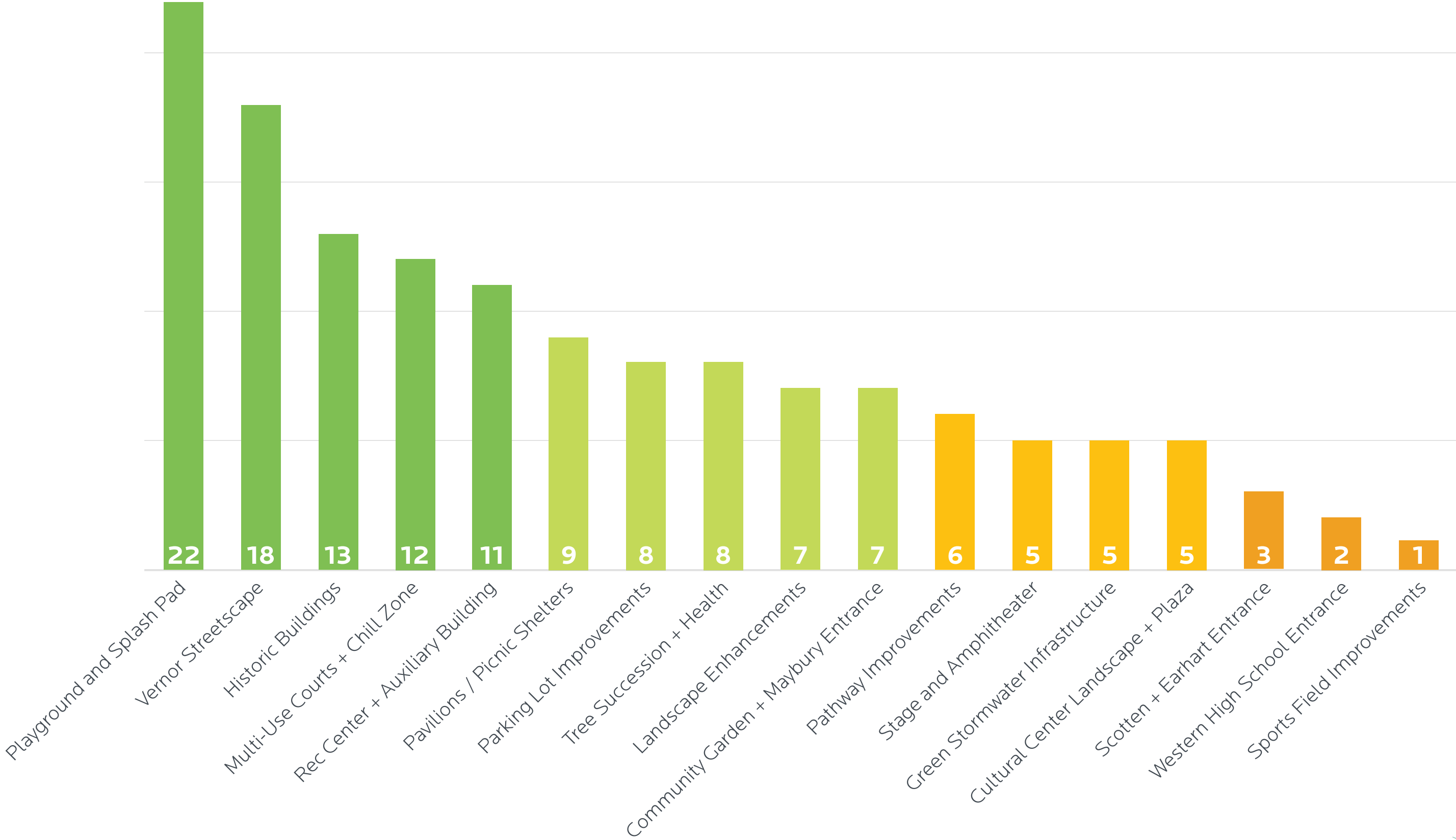

# PHASE I PRIORITIZATION

---

## SPORTS ZONE

- RAIN GARDEN

## ACTIVE ZONE

- REC CENTER IMPROVEMENTS
- SCOTTEN ENTRANCE / EARHART CHILL ZONE
- PLAYGROUND + SPLASH PAD
- NEW PICNIC SHELTER
- MULTI-USE COURTS + CHILL ZONE
- RECLAIMED GREEN / OPEN SPACE

## CULTURAL ZONE

- STAGE IMPROVEMENTS
- MOTHBALL HISTORIC RESTROOMS (PART I)
- RENOVATING HISTORIC PAVILION (PART I)
- LANDSCAPE IMPROVEMENTS
- NEW PICNIC SHELTER

## PASSIVE ZONE

- TREE REPLACEMENT STRATEGY (PART I)
- HISTORIC FOUNTAIN REFLECTIVE SPACE
- VERNOR STREETScape + PLAZA

## PATHWAYS

- EXTENSIONS TO CENTRAL SPINE
- CONSOLIDATING + REPLACING

---

**\$3,153,500**

# PHASE I IMPROVEMENT PLAN

