

CLARK PARK IMPROVEMENTS - SNF

This document summarizes the upcoming improvements to Clark Park, which will be put out for public bid. *We are fairly confident we can afford most of these items, but until final pricing is in we do not know exactly what will be installed.* The bid will be out soon into the new fiscal year, which begins in July. The bid process takes 2-3 months, but we should have an indication on pricing well before the entire process is through. Some site prep and construction may take place this fall, with the bulk of the project being completed next year. While COVID 19 has drastic and far reaching impacts on all of our lives, we as a Clark Park group are fortunate in that the only real impact to this project is the delay in the construction timeline.

The improvements are generally localized to three areas of the park: the playground, the tennis courts, and the edge of the park along Vernor. All three of these areas will receive a complete removal and renovation. There is also planned improvements to the existing park buildings, including complete exterior restorations to the mens and womens restroom, and the warming shelter. Other improvements to the park include: minor repairs to the rec center, a replacement pavilion near Western Highschool, electrical improvements to the stage, tree maintenance, a rain garden near the rec center, as well as more historic benches throughout the park.

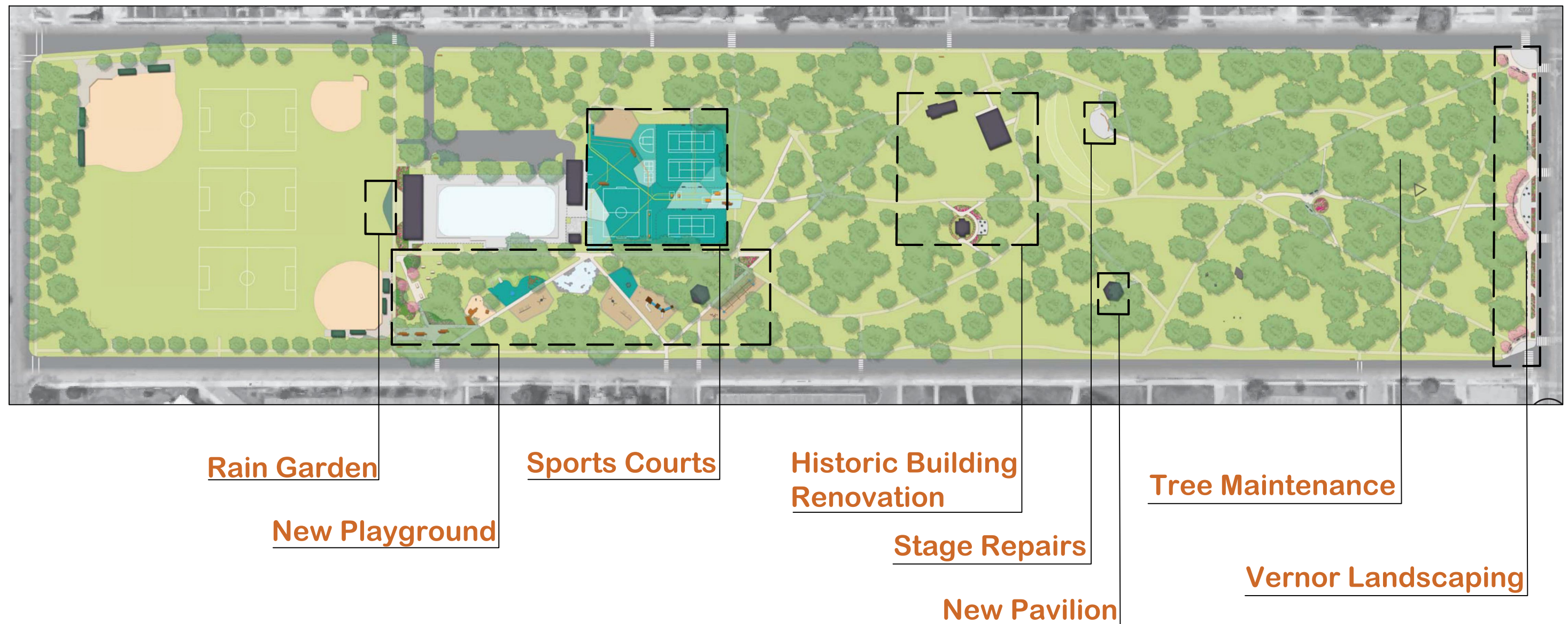

CLARK PARK IMPROVEMENTS - PHASE 1 SCOPE

The improvements to Clark Park were determined through several years of community engagement. Originally, the park was targeted as part of the Strategic Neighborhood Fund during the West Vernor Framework Plan. From this plan, approximately 2.5 million dollars were directed to Clark Park for construction. SNF, Invest Detroit, Bridging Communities, and others all generously contributed to this pool of funding.

Once the funds were identified, in May of 2019, a design kick off meeting was held to find how to best apply this money. The General Services Department (GSD) facilitated these discussions, and proudly stands behind the process and overall design outcome. This process sought to gain input from as many different voices as possible. The Clark Park Coalition, nearby schools, neighbors, businesses, and many others provided input. The plan is also guided by expertise from landscape architects, engineers, historical architects, arborists, and others from the construction industry, as well as the experience of GSD on what works and is used in Detroit parks. In total, the process consisted of great ideas and compromise which produced a plan that will build upon, preserve, and enhance the wonderful public space at Clark Park.

Please see the text below which summarizes the full scope of improvements being put to public bid.

PLAYGROUND and SPLASH PAD

The biggest piece of this project will be the installation of a completely new playground. Existing equipment is in fair to poor condition, and it is wise to use this opportunity to reinvest in the youth of the neighborhood. The playground will be a unique combination of climbing structures, topography, ground components, and water.

The scope includes:

- Removal of existing equipment
- Installation of ADA accessible play mound
- ADA Accessible ground components
- Custom Tree House Play Structure
- Zip Line
- Sand Play area for small children
- Splash Pad
- Replacement Pavilion

MULTI SPORTS COURTS

The existing tennis courts in the park are in poor condition and need to be replaced. Also, tennis requires a large area which ultimately cannot accommodate many users. This project will reimagine this space, and provide several different activities with pedestrian routes around and through the courts.

The scope includes:

- Removal and replacement of all existing asphalt
- Three tennis courts (only fence will be around these courts)
- Pickleball
- New pedestrian access from both North-South and East-West
- Futsal Court
- Yard Games like ping pong and bag toss
- One basketball hoop with free throw and 3 point line
- Outdoor fitness equipment

TREE MAINTENANCE

The tree canopy at Clark Park is the defining characteristic of the space. When John Persons Clark made arrangements for the City to take the park, he stipulated that the area be parkland forever. To honor this agreement, maintenance is necessary to ensure the future of the trees. While the area may seem natural, the conditions are far from native. The dense urban environment, constant ground mowing, and lack of tree plantings makes this a crucial time for human intervention.

The scope includes:

- Removal of 34 trees. This includes damaged and diseased trees. It also includes the removal of less desirable trees which are interfering with the growth of the native hardwoods.
- Tree pruning where necessary
- Installation of 100+ trees

VERNOR EDGE LANDSCAPING

The northern edge of the park, along Vernor, can be described as the front entrance to Clark Park. The current conditions along this edge is not poor or dilapidated, but does not mesh with the grand splendor of the interior of the park. The plain urban sidewalk will be replaced with a true entry to the park, which will include extensive landscaping, entry arches, and small seating areas that will compliment the surrounding business.

The scope includes:

- Removal of existing sidewalk
- Installation of perennial plants in place of sidewalk
- New sidewalk, same size as existing, behind perennial beds.
- Entry plazas and gathering areas
- 'Clark Park' entry arches

Building Improvements

Clark Park is home to 4 impressive historic buildings. The rec center is the base for the Clark Park Coalition, and is well used. The other 3 buildings are unused and in poor condition. This project will provide minor improvements to the rec center, and full exterior renovations of the mens restroom, womens restroom, and warming shelter. The restroom interiors will be renovated in a second phase to provide public restrooms, and the warming shelter will be available for permitted and public use.

OTHER IMPROVEMENTS and CHANGES

- Electrical upgrades to the stage
- More benches and picnic tables throughout the park
- Replacement of the pavilion near Western HS.
- Removal of the pavilion near Vernor and Clark
- A rain garden near the rec center
- Drinking fountain
- Grills
- Solar Power Stations
- Demolition of the wading basin
- Site grading to fix drainage issues, where possible.
- Removal of the community garden. (A more suitable location within the park has been identified, if interest in the garden resumes).